



TopGas[®]
Wall Hung Condensing Gas Boiler

Hoval

Technical Data
Output range 35 to 80 kW

4213024/00 - 05/14

Subject to modifications

Description

TopGas condensing boiler with Hoval UltraClean®

combustion system for high efficiency/low NOx operation:

The Hoval TopGas® condensing boiler meets both environmental and economical demands by coupling high efficiency with low emissions. It features the Hoval UltraClean® combustion system with pre-mix down firing burner. This advanced burner is fundamental to the boiler achieving efficiencies of up to 109.7% net, NOx levels as low as 18 mg/kWh and CO as low as 9 mg/kWh.

Premix modulating burner operation:

With a turndown ratio of up to 5.1:1 the modulating burner ensures optimum load matching and peak seasonal performance. The pre-mix burner automatically adjusts the air/gas mixture for optimal proportions for the variable output range. The pre-mix burner is suitable for either natural gas or propane operation.

Applications:

TopGas® condensing boilers are suitable for closed central heating and domestic hot water primary supply systems. The condensing operation also makes them suitable for underfloor heating installations which require lower flow/return temperatures. A range of matched calorifiers and Hoval pressurisation units are available. Hoval approved flue kits are available ex-stock to assist with site installation.

Low acoustic power and pressure levels:

The TopGas® is surprisingly quiet. A variable speed fan and a sophisticated noise containment system ensure up to 50% lower noise emissions.

Easy maintenance guaranteed:

Numerous, well thought out details ensure low operating costs and high convenience of maintenance in the TopGas®. All the components are easily accessible, simple to clean and can be rapidly and cheaply replaced in the event of a fault.

Controls/TopTronic® Room Station type RS-OT:

The control panel is ergonomically designed for ease of operation and is housed within the front of the boiler casing, space is also included for an optional TopTronic®T controller. An electronic control module controls all the safety aspects of the burner together with modulation control, temperature display, fault diagnostics, integrated frost protection and pump overrun. Adding an external TopTronic® room station RS-OT with outdoor and calorifier sensor allows the boiler to control a directly compensated heating circuit and a calorifier primary pump.

TopTronic®T controllers:

A TopTronic®T controller can control a boiler circuit, mixed circuit and calorifier primary pump simultaneously. Up to five boilers can be linked together to provide sequence control. Additional features such as an extra mixed circuit, solar and solid fuel can be added with optional software keys.

Greater efficiency through modulation:

The controls of the TopGas® adapt the output of the burner on a smooth curve to match the required heat demand. Through modulating operation, the downtimes of the burner are significantly reduced. This means that loss of cooling is reduced, thus saving energy, and the working life of the boiler is increased because the burner is not constantly firing at full rate. Due to the less frequent starting of the burner, the peak emissions which occur in the starting and shutdown phase of the burner are substantially reduced so lowering the environmental impact.

BMS control:

The operation of each boiler can be controlled via a 0-10V input signal (by the addition of an optional interface module). This allows control of either the burner firing rate or the boiler operating temperature set point.

Low impact on the environment:

Through the revolutionary UltraClean® combustion system, emissions from the TopGas® meet the strictest target and limit values for emissions anywhere in the world.

Assembly and delivery:

TopGas® (35-80) boilers are supplied fully assembled and cased.

Concentric flue parts:

A range of concentric flue parts are available to suit all needs ranging from wall terminals to straights and bends (see the accessories section). All items finished white RAL 9016.

TopGas® (35-60) boilers are **SEDBUK** rated for natural gas firing.

Technical data

TopGas® (35-80)

Type		(35)	(45)	(60)	(80)	
• Nominal output 80/60 °C with natural gas	kW	6.0-31.8	10.0-41.0	11.7-55.3	15.8-72.4	
• Nominal output 40/30 °C with natural gas	kW	6.8-35.0	11.1-45.0	12.8-60.7	17.3-80.0	
• Nominal output 80/60 °C with propane gas ¹	kW	6.6-31.9	10.8-41.0	13.1-54.9	19.5-72.4	
• Nominal output 40/30 °C with propane gas ¹	kW	7.3-35.2	11.9-45.0	14.1-60.3	21.6-80.0	
• Nominal inout with natural gas	kW	6.4-33.0	10.6-42.5	12.2-57.3	16.5-75.0	
• Nominal input with propane gas ¹	kW	7.0-33.2	11.4-42.5	13.6-56.9	20.0-75.0	
• Working pressure heating max./min.	bar	3.0 / 1.2	3.0 / 1.2	3.0 / 1.2	4.0 / 1.2	
• Working temperature max.	°C	85	85	85	85	
• Boiler water capacity	l	4,5	4,5	6,0	10	
• Min. water flow rate	l/h	300	350	470	800	
• Boiler weight (without water, incl. casing)	kg	83	83	89	107	
• Standard efficiency (DIN 4702, part 8)	40/30 °C	%	109.1 / 98.3	109.0 / 98.2	109.0 / 98.2	109.4 / 98.6
	75/60°C	%	106.1 / 95.6	106.0 / 95.5	106.0 / 95.5	106.1 / 95.6
• Heat lossrate at 70°C	Watt	95	95	120	95	
• Standard emission rate	Nitrogen oxides	mg/kWh	30.0	30.0	35.0	18.0
	Carbon monoxide	mg/kWh	9.0	11.0	13.0	27.0
• Content of CO ₂ in the exhaust gas max./min. output	%	9.0 / 8.8	9.0 / 8.8	9.0 / 8.8	9.0 / 8.8	
• Dimensions		See table of dimensions				
• Connections	Flow/return	Inches	Rp 1 ¼"	Rp 1 ¼"	Rp 1 ¼"	Rp 1 ¼"
	Gas	Inches	R ¾"	R ¾"	R ¾"	R ¾"
	Flue gas/ combustion air Ø	mm	C80/125	C80/125	C80/125	C100/150
• Gas flow pressure min./max.						
Natural gas	mbar	18-50	18-50	18-50	18-50	
Liquid gas ¹	mbar	37-50	37-50	37-50	37-50	
• Gas connection value at 0 °C / 1013 mbar:						
Natural gas E - (Wo = 15,0 kWh/m ³) H _u = 9,97 kWh/m ³	m ³ /h	3.3	4.3	5.8	7.5	
Propane gas ² (H _u = 25,9 kWh/m ³)	m ³ /h	1.27	1.64	2.21	2.90	
• Operating voltage	V/Hz	230/50	230/50	230/50	230/50	
• Control voltage	V/Hz	24/50	24/50	24/50	24/50	
• Min./max. electrical power consumption	Watt	29/62	29/66	30/102	23/130	
• Stand-by electrical consumption	Watt	13	13	13	7	
• IP rating (integral protection)	IP	40	40	40	20	
• Acoustic power level						
- Heating noise (EN 15036 part 1) (room air dependent)	dB(A)	61	63	63	63	
- Exhaust noise is radiated from the mouth (DIN 45635 part 47) (room air dependent/room air independent)	dB(A)	63	66	66	66	
• Acoustic pressure level (depending on installation conditions)	dB(A)	49	51	51	53	
• Condensate quantity (natural gas) at 40/30 °C	l/h	3.1	4.0	5.4	7.1	
• pH value of the condensate		ca. 4.2	ca. 4.2	ca. 4.2	ca. 4.2	
• Values for flue calculation						
Temperature class		T120	T120	T120	T120	
Flue gas mass flow	kg/h	54.8	70.6	95.1	124.5	
Flue gas temperature with operating conditions	80/60 °C	°C	69	75	79	79
Flue gas temperature with operating conditions	40/30 °C	°C	47	52	49	49
Volume flow rate combustion air	Nm ³ /h	41.3	53.1	71.6	95.5	
Excess pressure for combustion air/ flue gas system	Pa	95	115	140	140	
Maximum draught / depression at flue gas outlet	Pa	- 50	- 50	- 50	- 50	

¹ TopGas® can also be operated with propane/butane (liquid gas) mixtures.

TopGas® condensing boilers are suitable for closed central heating and domestic hot water primary supply systems.

Ventilation

For installations not exceeding 70 kW total nominal input (net) refer to BS5440-2:current edition.

For installations over 70 kW total nominal input (net) both high and low level ventilation is required, this should be calculated to BS6644:current edition

Technical data

Boiler-flow resistance TopGas® (35-60)

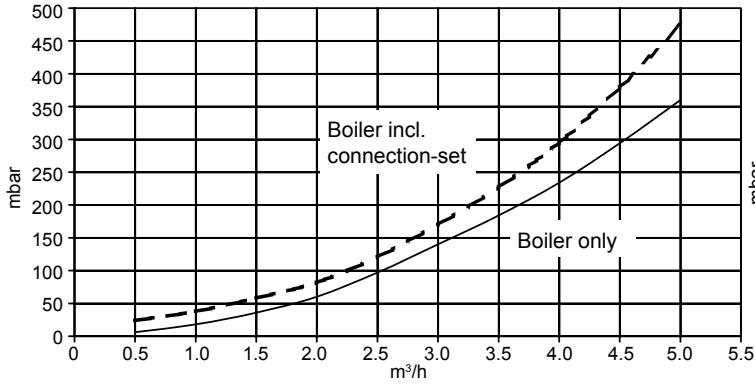

Boiler-flow resistance TopGas® (80)

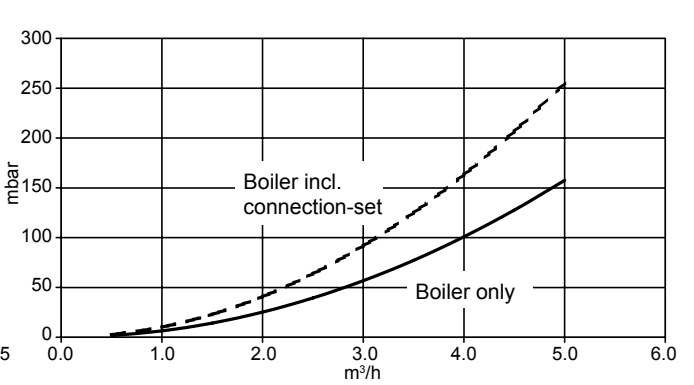

Maximum residual overpressure TopGas® (35-60) with connection set AS32-TG/M13-2

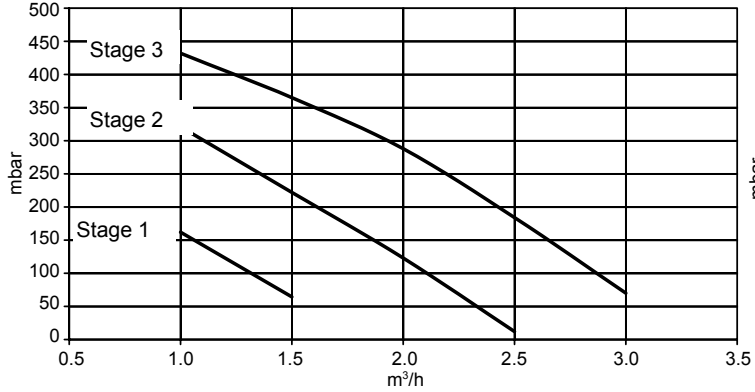

Maximum residual overpressure TopGas® (80) with connection set AS32-TG/M14-2

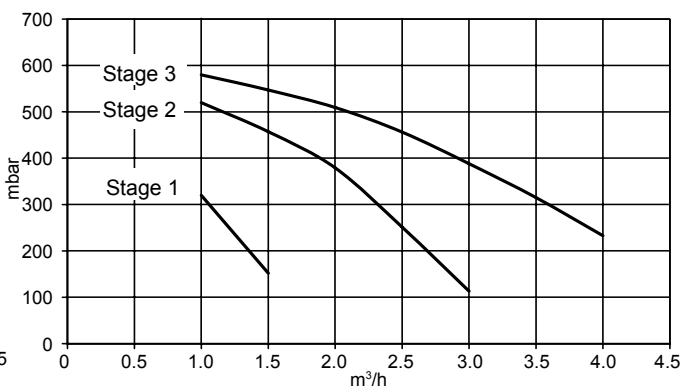

Maximum residual overpressure TopGas® (35-60) with connection set AS32-TG/M14-2

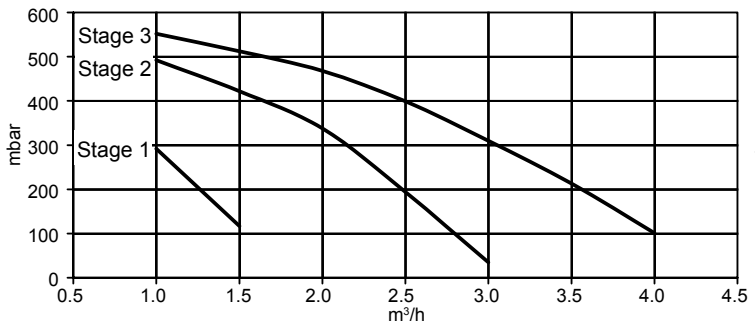

Maximum residual overpressure TopGas® (80) with connection set AS32-TG/M15-2

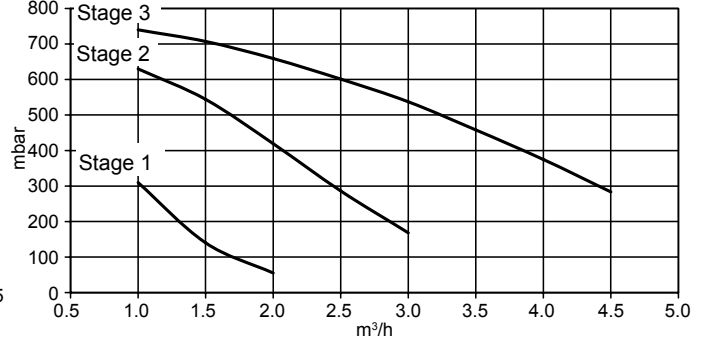

Maximum residual overpressure TopGas® (35-60) with connection set AS32-TG/M15-2

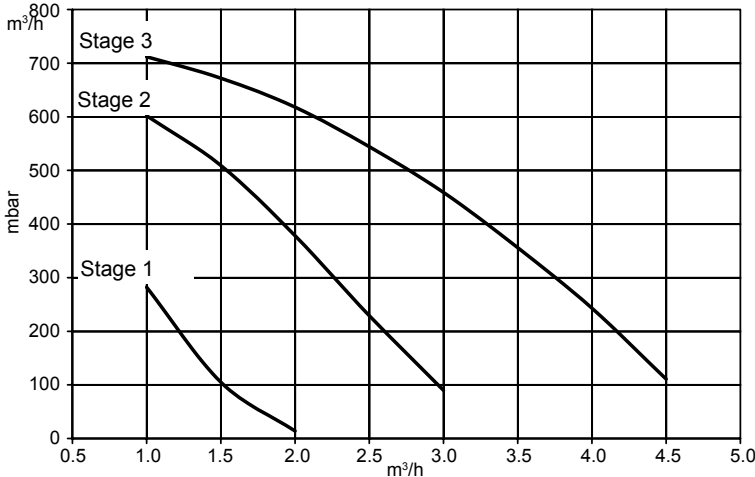

m³/h = Volume flow rate
mbar = Flow resistance

Dimensions

TopGas® (35 - 60)

(All Measurements in mm)

Clearances

- Right/Left 50mm
- Space to ceiling dependent on the flue gas system (450mm with Hoval horizontal wall terminal kit)
- Front 500mm

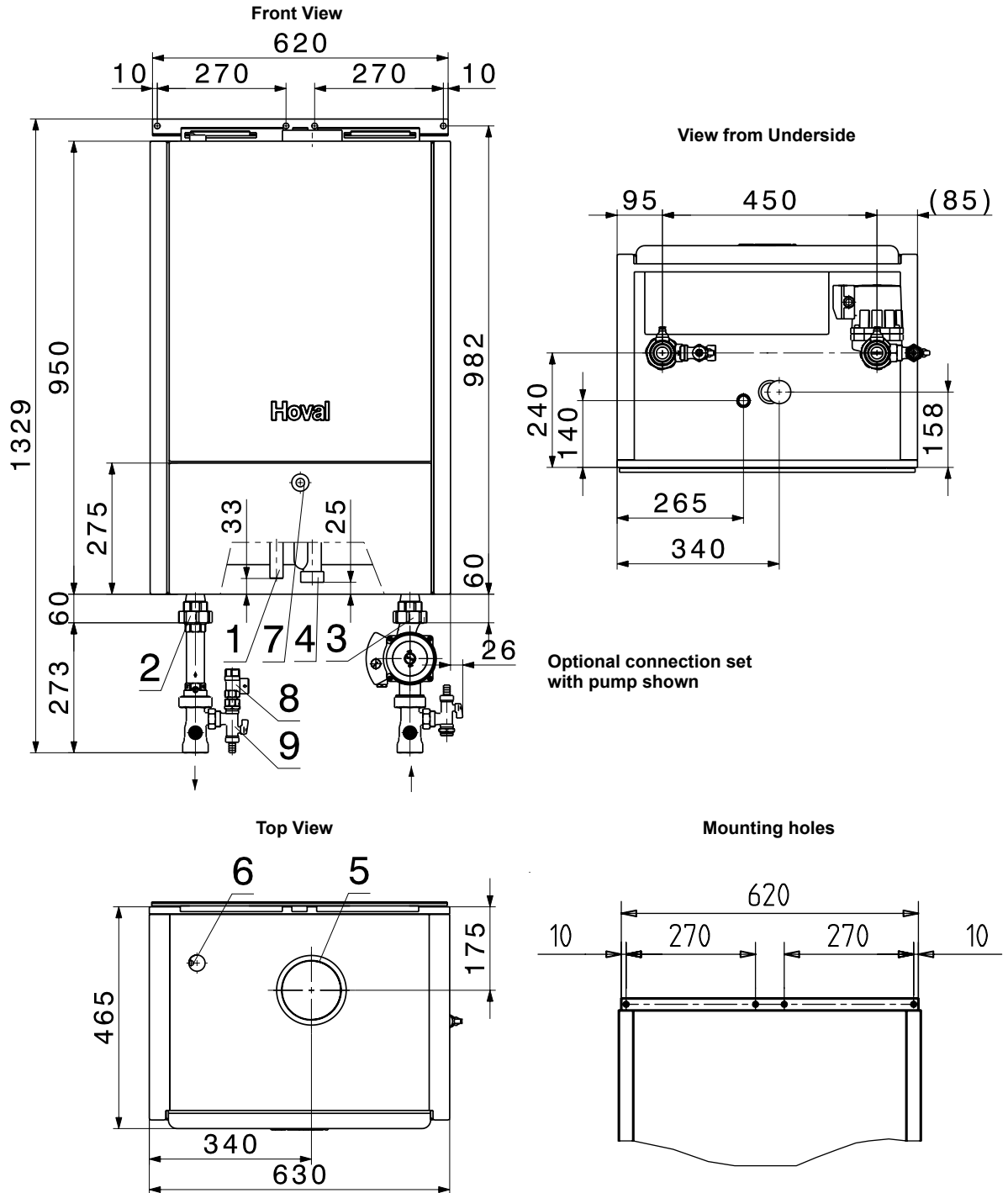

Optional connection set with pump shown

TopGas® (35-60) boilers are supplied fully assembled and cased

- | | |
|--|---|
| 1 Gas connection R ¾" | 6 Automatic air vent |
| 2 Flow G 1¼" | 7 Hinged control panel cover |
| 3 Return G 1¼" | 8 Safety valve (optional, see connection set) |
| 4 Condensate drain DN 32 | 9 Drain valve (optional, see connection set) |
| 5 Concentric flue connection DN 80/125 | |

Dimensions

TopGas® (80)

(Measurements in mm)

Clearances

- Right/Left 50mm
- Space to ceiling dependent on the flue gas system (300mm with Hoval horizontal wall terminal kit)
- Front 500mm

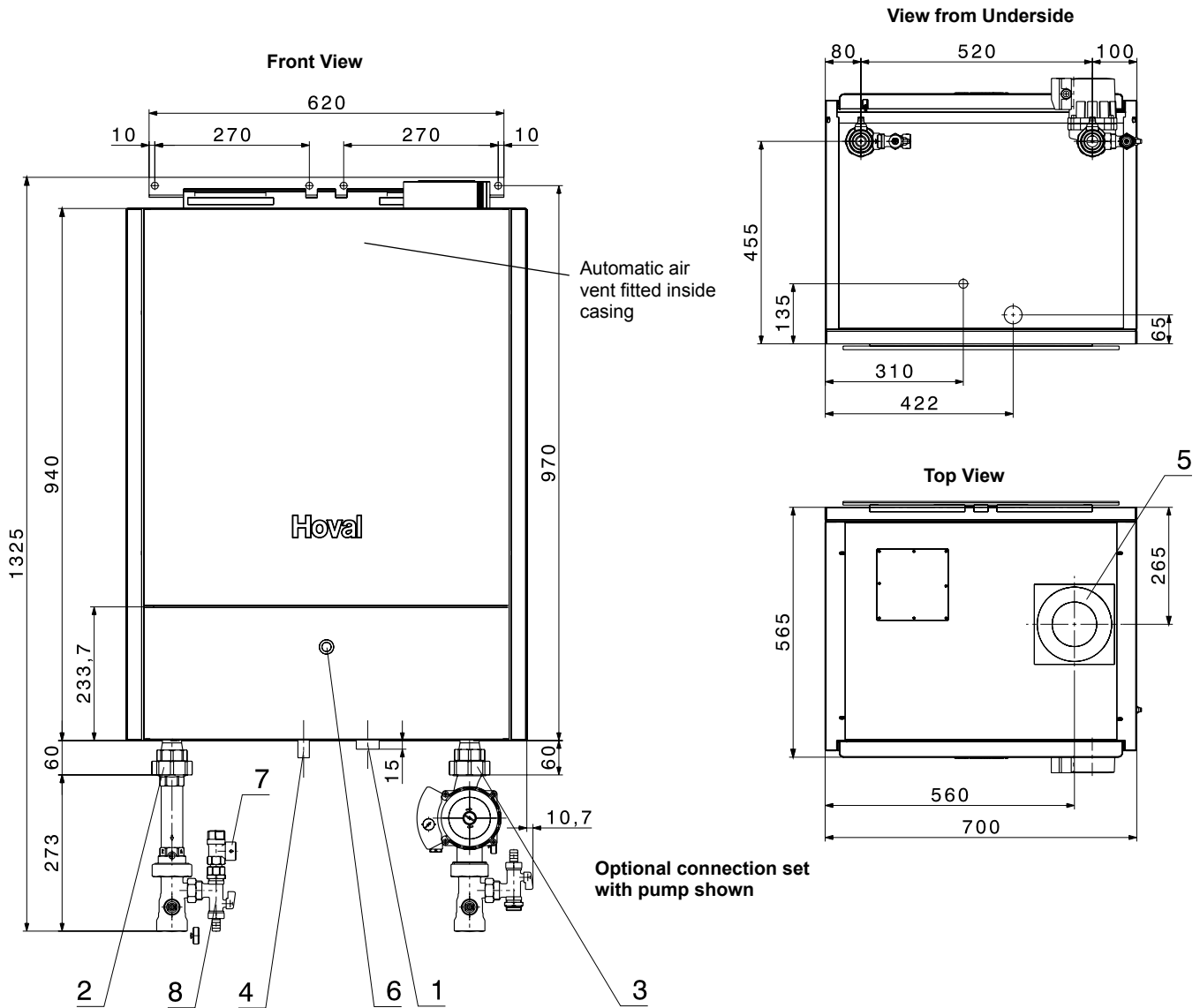

TopGas® (80) boilers are supplied fully assembled and cased

- 1 Gas connection R 3/4"
- 2 Flow R 1 1/4"
- 3 Return R 1 1/4"
- 4 Condensate drain DN 40
- 5 Concentric flue connection DN 100/150mm
- 6 Hinged control panel cover
- 7 Safety valve (optional, see connection set)
- 8 Drain valve (optional, see connection set)

Accessories

TopTronic Room Station RS-OT



For one heating circuit without mixed operation.
Weather dependent flow temperature control with outside temperature sensor AF 120, water heater sensor TF 25 / 12K and overridable room temperature sensor. Can be implemented as a room temperature control without outside sensor. Cannot be installed in the boiler control panel. Maximum distance (cable length) from boiler is 50 metres.

Part No.
6015 199

TopTronic regulator set ZN3

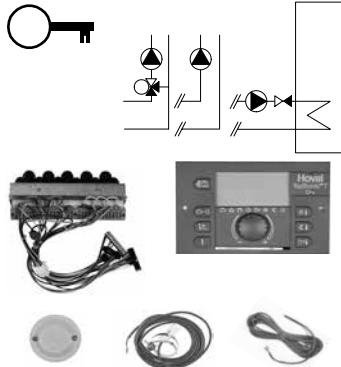

Can be installed within the basic boiler control panel N4.1
Consists of:
Heating regulator Hoval TopTronic®T/N for
- 1 mixed circuit
- 1 heating circuit without mixing operation
- Domestic hot water loading circuit
- Outdoor sensor AF200
- Flow Sensor VF204 with 4m cable.
- 1 immersion sensor KVT20/5/6 for calorifier with 5m cable.
- Cable set ZN3 for connecting the heating regulator TopTronic®T/ N within the boiler control panel.

6015 212

Accessories for Heating regulator TopTronic®T



Room station RS-T
For remote control of circuits. Includes room sensor, information and advanced program keys. Maximum distance (cable length) from boiler is 50 metres.

2022 237



Remote control RFF-T
For simple remote control of circuits. Includes room sensor, simple program keys and temperature adjustment. Maximum distance (cable length) from boiler is 50 metres.

2022 239



Additional outdoor sensor AF 200
For one mixing circuit or for average value (2 outdoor temperature sensors possible per TopTronic®).

2022 995



Immersion sensor KVT 20/5/6S
With 5m cable and plug (excludes pocket).

6012 687



Surface temperature sensor VF204S
Usable as flow or return sensor with 4m cable and plug.

6012 688

**Flow temperature limit thermostats available as below.
For underfloor heating (1 per heating circuit) 15-95°C,
differential 6K.**



Clamp-on thermostat RAK-TW1000.S
Thermostat with strap, without cable and plug.

242 902

Clamp-on thermostat RAK-TW1000.S
Thermostat with strap, 4m long cable and plug.

6015 000



Immersion thermostat RAK-TW1000.S SB 150
Thermostat with brass nickel-plated ½" pocket x 150mm long.

6010 082

Accessories

Accessories for Heating regulator TopTronic®T

Part No.



Key-Module for Hoval TopTronic®T for additional functions.
 Key-Module consists of:
 Function key for plugging into TopTronic®T with necessary sensors and electrical connections.
Only one Key-Module is possible per TopTronic®T.

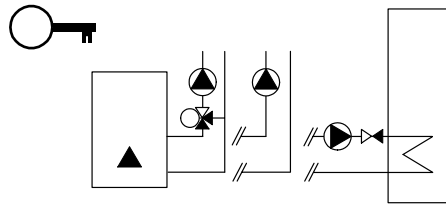

Standard functions already included in TopTronic®T.
 - 1 mixing circuit
 - 1 heating circuit without mixing operation
 - Domestic hot water loading circuit

Functions of Key-Modules:

Key-Module	2 mixing circuits	solid fuel buffer vessel	Solar
①	●		
②		●	
③			●
④	●	●	
⑤	●		●
⑥		●	●
⑦	●	●	●

- +

①

Key-Module 1
For 2 mixing circuits.
Function key 1, 1 flow sensor, 2 loose plugs.

6012 154
- +

②

Key-Module 2
For solid fuel / buffer vessel installation. Function key 2, 3 immersion sensors, 4 loose plugs.

6012 155
- +

③

Key-Module 3
For solar plants.
Function key 3, 1 collector panel sensor, 1 calorifier sensor, 4 loose plugs.

6012 156
- +

④

Key-Module 4
For 2 mixing circuits and solid fuel / buffer vessel installation.
Function key 4, 1 flow sensor, 3 immersion sensors, 6 loose plugs.

6012 157
- +

⑤

Key-Module 5
For 2 mixing circuits and solar plants.
Function key 5, 1 flow sensor, 1 collector panel sensor, 1 calorifier sensor, 6 loose plugs.

6012 158
- +

⑥

Key-Module 6
For solid fuel / buffer vessel installation and solar plants.
Function key 6, 1 collector panel sensor, 4 immersion sensors, 6 loose plugs.

6012 159
- +

⑦

Key-Module 7
For 2 mixing circuits, solid fuel / buffer vessel installation and solar plants.
Function key 7, 1 flow sensor, 1 collector panel sensor, 4 immersion sensors, 8 loose plugs.

6012 160

Sensor type
 Immersion / calorifier sensor: TypeKVT 20/5/6
 (Length = 5m) without immersion sleeve.
 flow sensor : Type VF204S with plug
 collector sensor : Type PT1000 (Silicon)

Consult Hoval for specific applications

Accessories

External TopTronic®T

Part No.



- Heating regulator Hoval TopTronic®T/N
- 1 mixed circuit
 - 1 heating circuit without mixing operation
 - Domestic hot water loading circuit

2022 223



- Control panel WG1
- Plastic casing with clear cover
 - Light grey
 - 6.3 amp fuse and terminals
 - 365mm x 320mm x 160mm

6012 598

or



- Control panel MSK
- Plastic casing
 - Dark grey
 - 281mm x 94mm x 93mm

6012 508

BMS module



BMS Module 0-10V GLT
Module for control of boiler by a building management system using 0-10V signals.

6015 195

- For the control of firing rate or setpoint and interrogation of firing rate or setpoint (single boiler).
- For the control of setpoint only and interrogation of firing rate and setpoint on first boiler (a single BMS Module 0-10V GLT is required with up to five boilers sequenced by TopTronic).
- For the control of setpoint only and interrogation of firing rates and setpoints on individual boilers (BMS Module 0-10V GLT is required per boiler with up to five boilers sequenced by TopTronic).

Consisting of: BMS-Module and transformer.
Only for use with optional TopTronic.



External casing SB-GE to accommodate the above 0-10V module.

6013 063

- Light grey
- 250mm x 175mm x 100mm



BMS Module 0-10V OT
Module for control of boiler by a building management system using 0-10V signals.

6016 725

- For the control of firing rate or setpoint.
- Can be used without TopTronic.



BMS Module - MODBUS
Module for control of boiler by a building management system using modbus protocol.

6014 389

- For the control of firing rate or setpoint and interrogation of various parameters (single boiler).
 - For the control of setpoint only and interrogation of various parameters on up to five boilers (a single BMS Module MODBUS is required with up to five boilers sequenced by TopTronic).
- Only for use with optional TopTronic.

Accessories

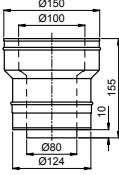
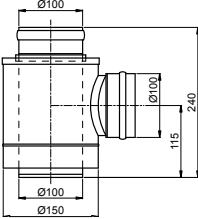
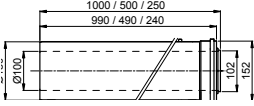
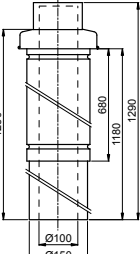
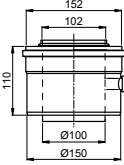
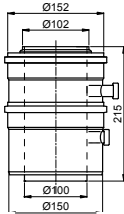
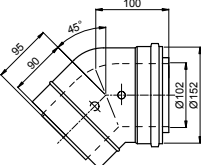
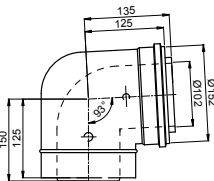
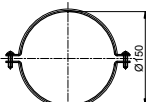
		Part No.
	80/125 to 100/150 adapter (TopGas 35-60)	2042417
	Connection C100/150 to 2xE100PP	2015244
	For separate routing of flue gases and combustion air.	
	Recommendation: If the air inlet is near a noise sensitive place (window of bedroom, terrace etc.) we recommend the use of a sound absorber on the air inlet.	
	1000mm extension (including support bracket)	2042409
	500mm extension (including support bracket)	2042408
	250mm extension	2042407
	Vertical terminal (black) with cap	2042404
	Vertical terminal (black) with cap (including support bracket)	
	Vertical adapter	2042406
	Complete with 2 sample points.	
	Vertical adapter	2042415
	Complete with condensing drain connection, siphon kit and 2 sample points.	
	45° elbow	2042411
	90° elbow	2042410
	Support bracket	2042414

Accessories

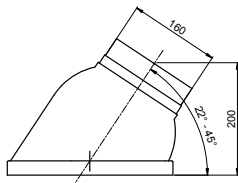

Lead pitched roof flashing

2042412

(to suit roof angle 25-45 degrees)

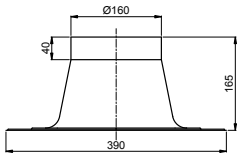

Aluminium flat roof flashing

2042413

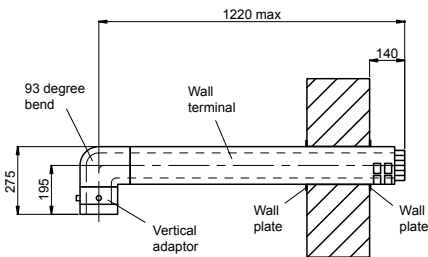

Wall terminal kit (for horizontal discharge)

2042405

Comprises of vertical adaptor, 93 degree elbow, 2 wall plates, horizontal wall terminal and 80/125 to 100/150 adaptor. Max dimension can be extended by use of extension pieces.

80/125 to 100/150 adaptor (part not required for TopGas® 80) 2042417

All items finished white RAL 9016

Flue design TopGas® 35-80

- An adaptor with sample points must be used (fitted to the boiler flue outlet connection).
- The flue gas is very cool and saturated with moisture so there will be very little or no buoyancy to pull the gases up the chimney.
- The burner fan assists with the evacuation of the flue gases so there may be slight pressurisation of the flue.
- It is permissible for the condensate from the flue system to drain back through the boiler.
- Horizontal flue sections must be inclined back to the boiler (3° minimum) to prevent condensate remaining in the flue.
- Flues must be designed to meet all current regulations / standards.
- See Technical data section for flue gas mass flow rates, temperatures, usable fan overpressure and ventilation requirements.
- The tables below are for guidance only.

Maximum flue lengths

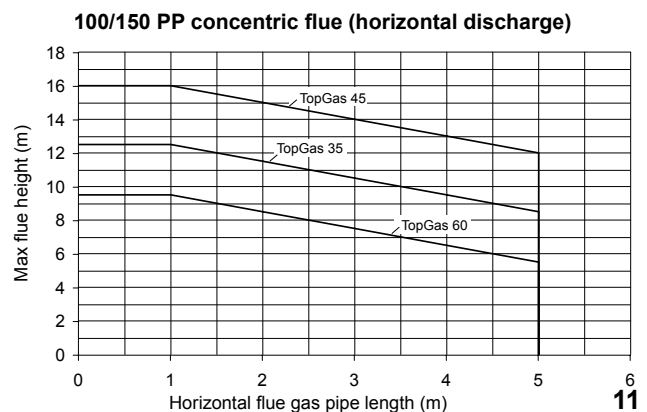
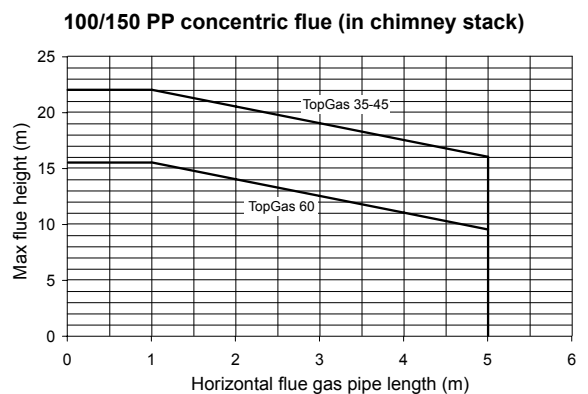
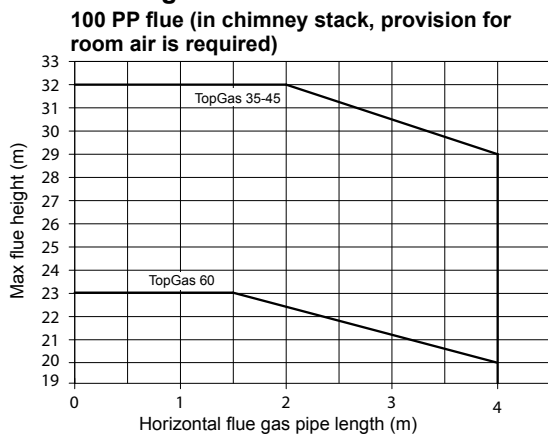

The above figures include for one 93 degree bend. Additional 93 degree bends will have the effect of reducing the length by 2.5 metres and 45 degree bends will reduce the length by 1.5 metres. The flue lengths stated will have no effect on the boiler output.

Accessories

Motorised mixing valves

Part No.



Type H3G/NR 230-20 B, 110°C
 Three-way valve made of cast iron
 Connections with internal thread.
 - Motorized 230 V
 - 3 wire control

DN	kvs ¹	
1 3/4"	8	6003 894
1"	12	6003 895
1 1/4"	18	6003 896
1 1/2"	28	6003 897
2"	44	6003 898



Type H3F/NR 230-20 B, PN 6, 110°C
 Three-way valve made of cast iron
 Without counter flanges.
 - motorized 230 V
 - 3 wire control

DN	kvs ¹	
40	44	6003 904
50	66	6003 905
65	100	6003 906
80	150	6003 907



NR230-20 B actuator to suit the above 245 209

¹ Flow quantity in m³/h on a pressure loss of 1 bar.

Larger sizes of motorised valves are available on request.

Low loss header

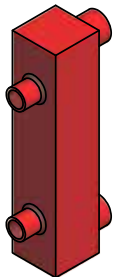

TopGas 35-60 single boiler low loss header
 Single TopGas 35-60 boiler low loss header complete with 1" BSP connections on the inlet and 1 1/2" BSP on the outlet. 2057320

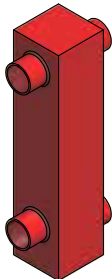

TopGas 80 single and two boiler low loss header
 Single TopGas 80 boiler or two boiler low loss header complete with 2 1/2" BSP connections on both the inlet and on the outlet. 2057322

Accessories

Connection set and pump



Connection set AS32-TG

6012 948

For circulation pump mounted on the return connection.

consisting of:

Return:

Isolating valve R 1 ¼" with gland nut 2". Side outlet branch with drain cock and G ¾" connection for expansion vessel.

Flow:

Extension G 2" x L=180mm with integrated non-return valve. Isolating valve R 1 ¼" with gland nut 2". Side outlet branch with safety valve (3 bar) and drain cock.

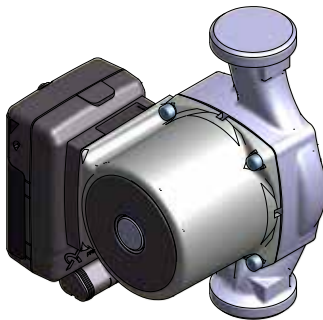

6.5. Boiler Circulating pump

Separate individual boiler A-rated circulating pump.

Grundfos UPML 32-95 180 AUTO single phase pump with G2" connections.

A 2m long electrical lead (with Molex connector) is available to connect the pump to the boiler.

UPML 32-95 180 AUTO pump

2056729

Electrical connection lead

2056730

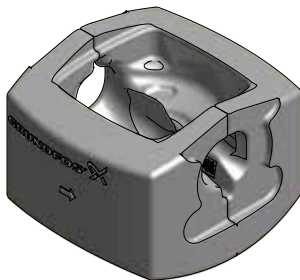

6.6. Pump insulation cover

Two piece insulation cover for Grundfos UPML 32-95 180 AUTO pump

2056817

Liquid gas conversion

Liquid gas conversion kits

TopGas® 35	619 568
TopGas® 45	619 568
TopGas® 60	619 568
TopGas® 80	6020 114

Gas filter



Fine gas filter with pressure test point before and after the filter (diameter. 9mm)
Pore width of the filter element <50 µm
Max. pressure difference 2.5 mbar
Max. inlet pressure 100 mbar

Type	Connection	
70612/6B	Rp ¾"	2007 995
70602/6B	Rp 1"	2007 996

Typical Hydraulic Schematics

- TopGas® (35 - 80) with**
 - Free standing calorifier
 - Direct heating circuit

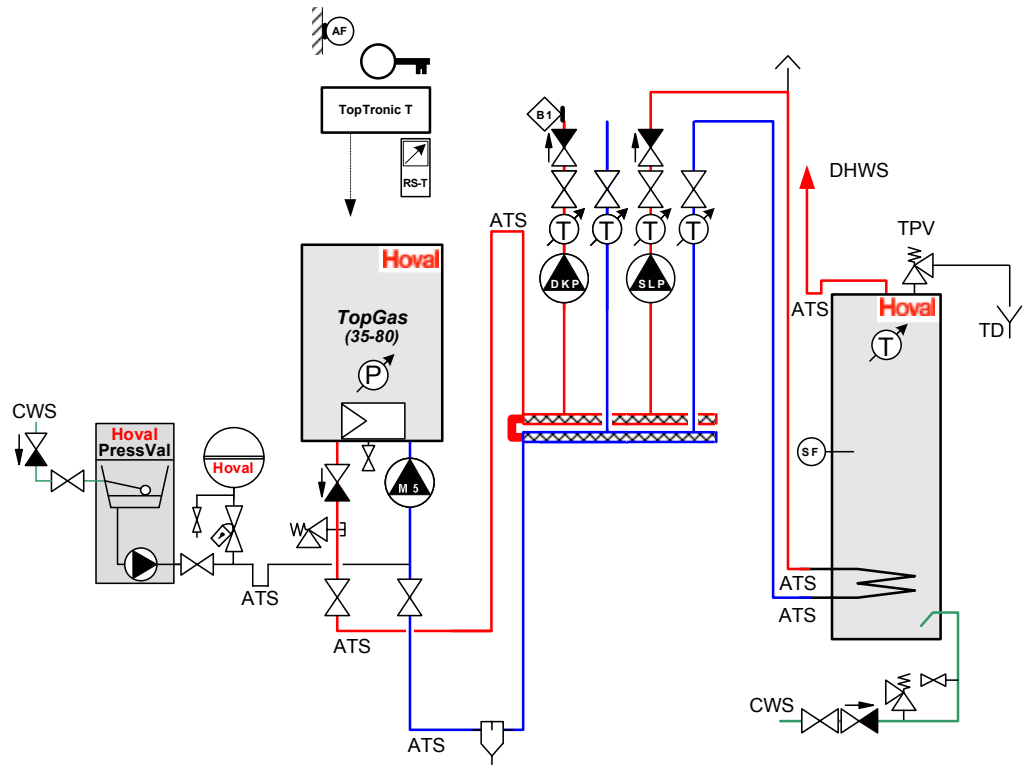

- TopGas® (35 - 80) with**
 - Free standing calorifier
 - Direct heating circuit
 - 1 or 2 mixed heating circuits

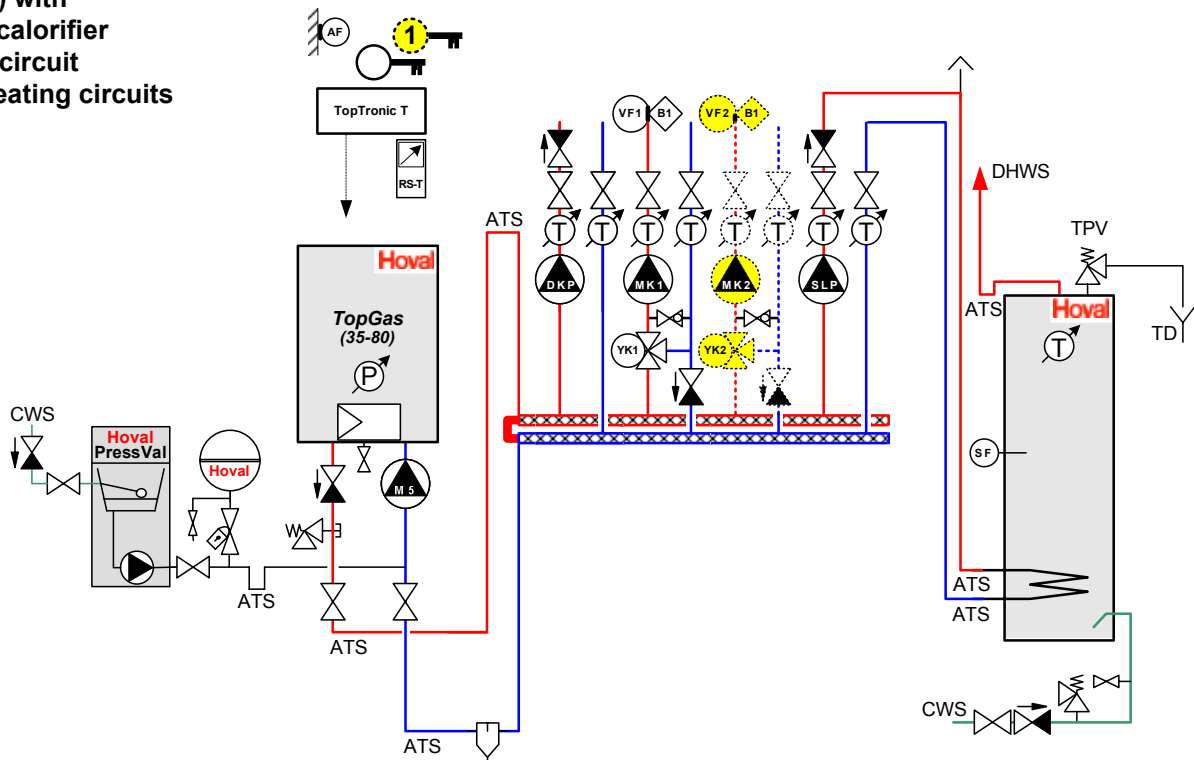

Notice :

- This hydraulic schematic just shows the basic principle. The installation must be in accordance with local regulations.
- With underfloor heating an over temperature thermostat has to be installed.
- Anti thermal siphon dip has to be installed.

RS-T	Room station	MK1	Pump mixed circuit 1
AF	Outdoor sensor	MK2	Pump mixed circuit 2
VF1	Flow sensor 1	DKP	Pump for heating circuit without mixing operation
VF2	Flow sensor 2	SLP	Calorifier loading pump
SF	Calorifier sensor	M5	Boiler pump
B1	Flow temperature thermostat (series connection with pump)	YK1	Actuator mixed circuit 1
MK1	Pump mixed circuit 1	YK2	Actuator mixed circuit 2
MK2	Pump mixed circuit 2	ATS	Anti-thermal siphon dip to prevent gravity circulation
DKP	Pump for heating circuit without mixing operation	TPV	Temperature and pressure relief valve
SLP	Calorifier loading pump	TD	Tundish to drain
B1	Flow temperature thermostat (series connection with pump)		

Typical Hydraulic Schematics

- 2 x TopGas® (35 - 80) with
- Free standing calorifier
- 2 or 4 mixed heating circuits
- Low loss header or plate heat exchanger

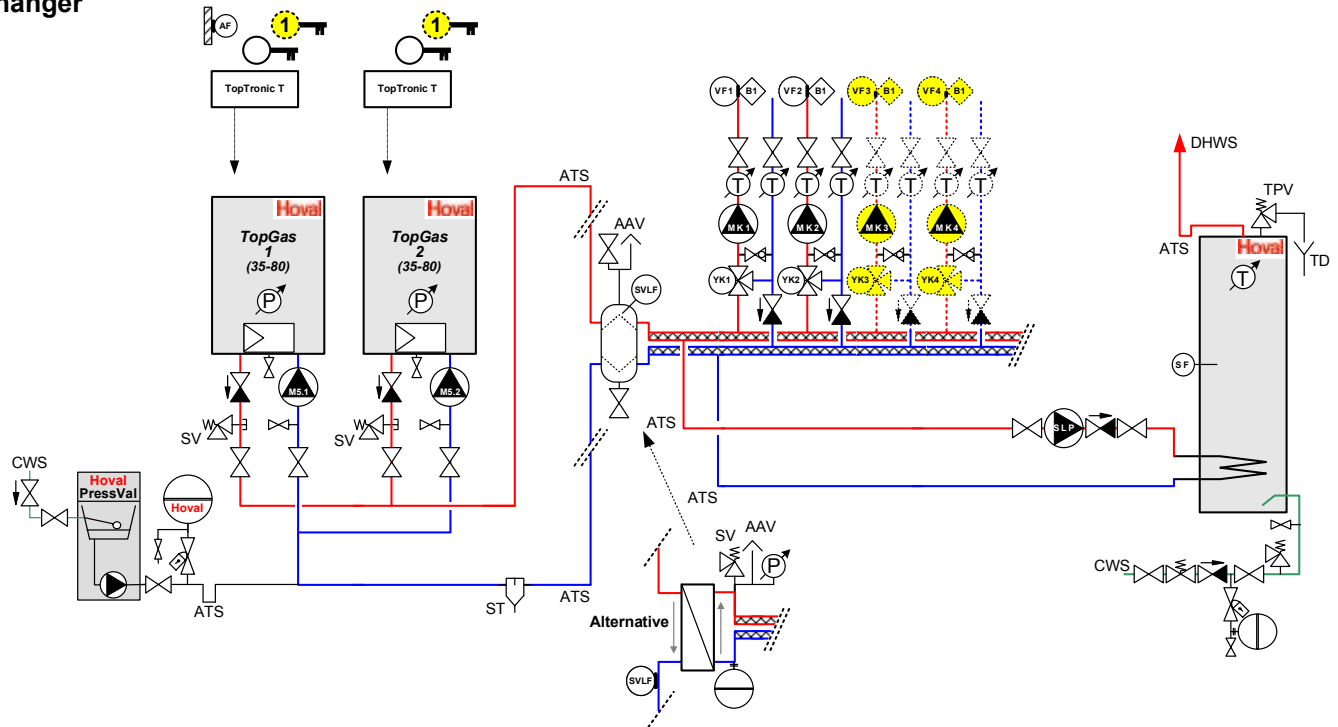

Notice :

- This hydraulic schematic just shows the basic principle. The installation must be in accordance with local regulations.
- With underfloor heating an over temperature thermostat has to be installed.
- Anti thermal siphon dip has to be installed.

RS-T	Room station	MK1	Pump mixed circuit 1
AF	Outdoor sensor	MK2	Pump mixed circuit 2
VF1	Flow sensor 1	DKP	Pump for heating circuit without mixing operation
VF2	Flow sensor 2	SLP	Calorifier loading pump
SF	Calorifier sensor	M5	Boiler pump
B1	Flow temperature thermostat (series connection with pump)	YK1	Actuator mixed circuit 1
MK1	Pump mixed circuit 1	YK2	Actuator mixed circuit 2
MK2	Pump mixed circuit 2	ATS	Anti-thermal siphon dip to prevent gravity circulation
DKP	Pump for heating circuit without mixing operation	TPV	Temperature and pressure relief valve
SLP	Calorifier loading pump	TD	Tundish to drain
B1	Flow temperature thermostat (series connection with pump)	SVLF	Total flow sensor



All TopGas® boilers can be commissioned by our dedicated service team.

For annual servicing of TopGas® boilers and other equipment please contact our Hoval service department

e-mail: service@hoval.co.uk
 direct dial: 01636 593413 or 593435

An expert partner



One-stop shopping

With us you can easily incorporate gas, oil, heat pump, solar, CHP, or biomass energy solutions into your heating system.



Technical advice

We are happy to assist you and your planning partners in developing intelligent systems, allowing you to take advantage of our expertise and the experience of our specialists.



After sales

For specialist commissioning and maintenance of your Hoval equipment, contact our service and spares department.

Hoval Ltd
Northgate
Newark-on-Trent
Nottinghamshire
NG24 1JN
United Kingdom

Phone 01636 672 711
Fax 01636 673 532
email boilersales@hoval.co.uk
www.hoval.co.uk

4213024/00 - 05/14

Responsibility for energy and environment

Hoval follows a policy of continued improvement and reserves the right to change specifications without notice.

Hoval