

AXO Body Anchor Fixing Systems - Introduction

- Direct fixing in to concrete walls with expansion bolts. Indirect fixing on to sub channel systems with hex bolts.
- Three dimensional adjustability - Quick and easy fixing.
- Installation at horizontal and vertical joints.
- Optimum static performance and low engineering for higher loads and larger projection sizes.
- Recommended projection sizes up to 260 mm and loads up to 1300 N.

AXO1
Body Anchor



AXO2
Body Anchor



AXO3
Body Anchor



AXO4
Body Anchor



HRS3
Restraint Anchor



HZTA
Telescope Anchor



Three dimensional adjustability

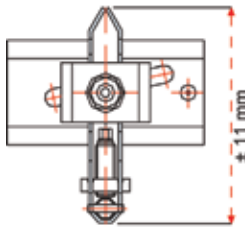

1) Vertical adjustment is provided through the body space. The anchor is fixed onto the bolt through the wedge washer and the lock washer at the desired level.

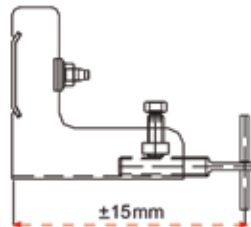

2) Adjusting the projection size by simply moving the adjustable arm without rotating. The adjustable arm is safely fixed to the anchor body with the lock nut and hex bolt.

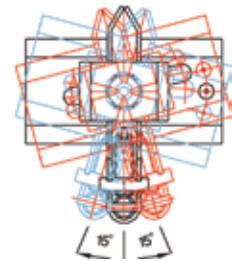

3) Adjusting the anchor left and right is provided by sliding the body up to 15 degrees left or right.

Installation at horizontal joints

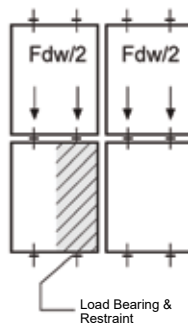

Installation at vertical joints

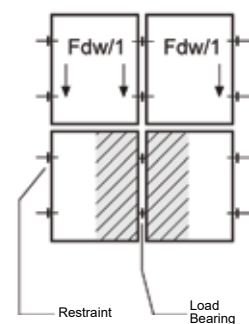

- Suitable for concrete walls. Anchors are fixed on to concrete walls with expansion bolts.
- Projection sizes between 60 and 260 mm and loads up to 1300 N.
- In horizontal installation, slabs are pinned on the bottom and upper sides. The anchors act as load bearing, carrying half the weight of the slabs above. Anchors also act as restraint holding the slabs below and restraining against wind suction and pressure.
- In vertical installation, slabs are pinned at the left and right sides. The anchors on the bottom are load-bearing anchors carrying the whole weight of the slab. Half the weight of the slab on the left and half the weight of the slab on the right. The anchors on the top are restraint anchors holding the slabs and restraining against wind suction and pressure.
- Three dimensional adjustability allows quick and easy installation.
- The design and structural calculations of these anchors are made in our technical department. Special design and manufacturing can be made for the requirements of the project.

AXO Body Anchor Fixing Systems - Installation Details

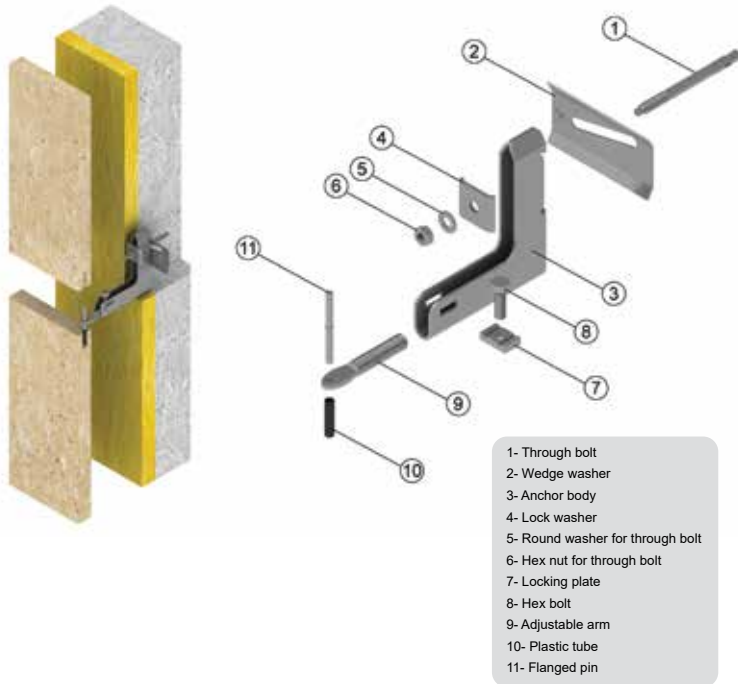

Adjustable Arm Variations

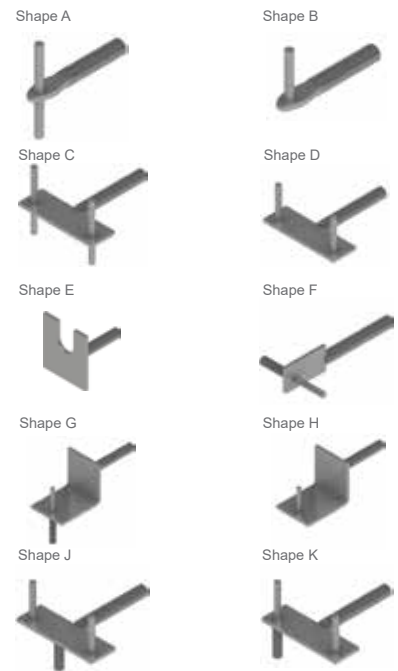

Installation at horizontal joints



AXO4
Body Anchor



Elevation view



Section a-a

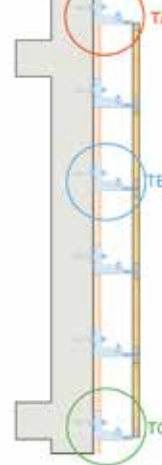

Installation details



Installation at vertical joints



HRS3 Restraint Anchor

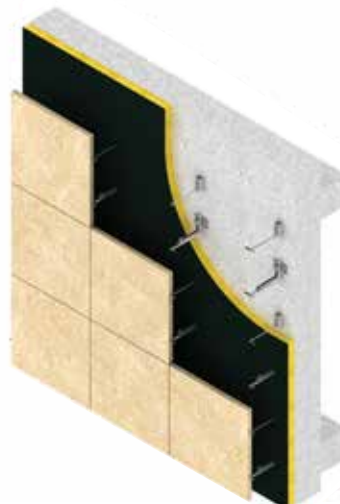

Elevation view

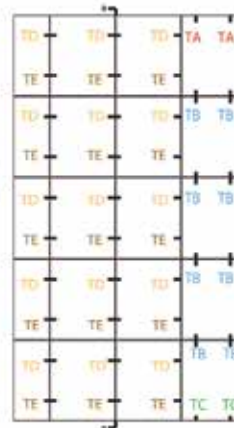

Section a-a

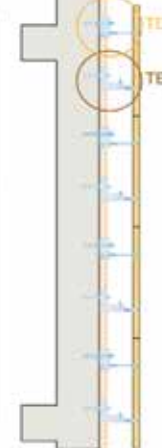

Installation details

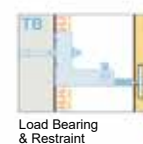
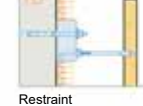

AXO4
Body Anchor

BA Body Anchor - Product Details



LGA TEST REPORT
No : BBW 0541135-01
Date : 09.05.2005

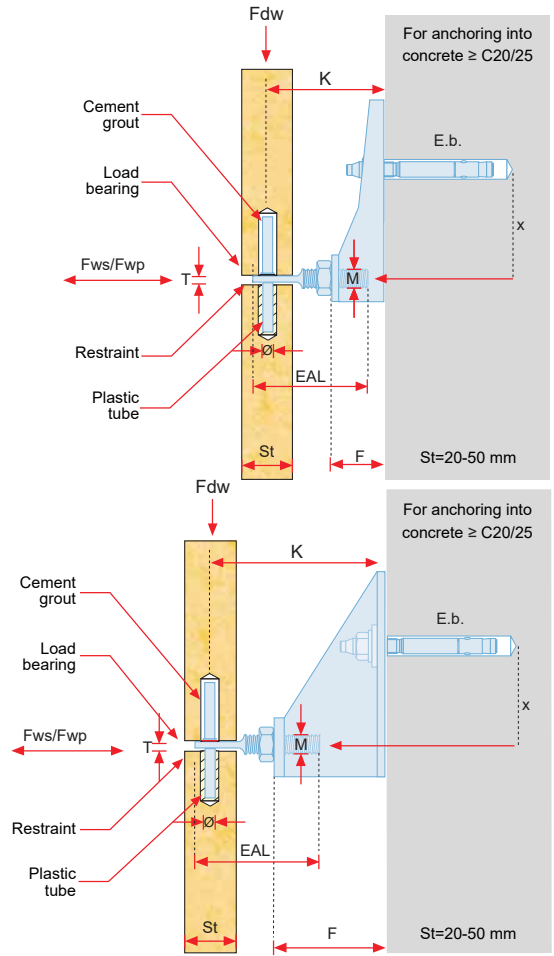
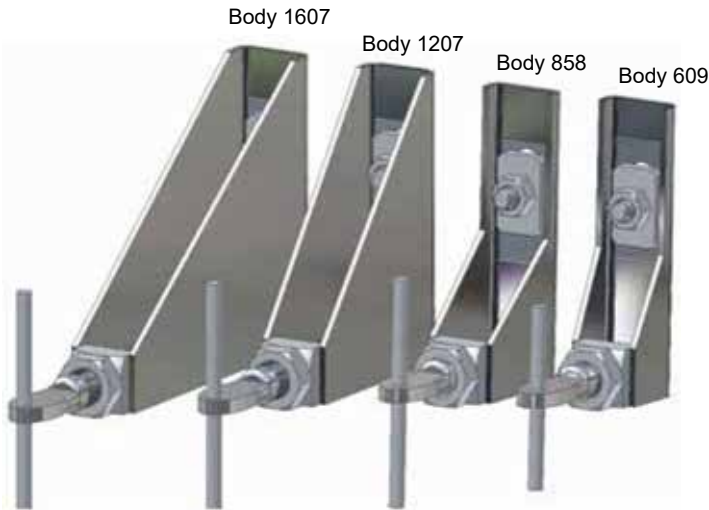

Product Code	Technical Details													
	Projection	Min. Projection	Max. Projection	Dead Load	Forming Size	Wind-Pressure	Wind-Suction	Expansion Bolt Size	Pin Size	Adj. Arm Metric Size	Adj. Arm Flat Thickness	Adj. Arm Length	X Size	
	K (mm)	K - (mm)	K + (mm)	Fdw (N)	F (mm)	Fwp (N)	Fws (N)	E.b. (mm)	Ø (mm)	M (mm)	T (mm)	EAL (mm)	x (mm)	
BA-609 BODY 1	60	50	75	900	28	1100	770	M8X80	5	M12	4.5	70	50	
BA-858 BODY 2	85	70	100	800	46	700	700					70		
BA-1207 BODY 3	120	95	135	700	75	650	650					80		
BA-1607 BODY 4	160	145	175	700	115	600	600					80		

- Material : Stainless Steel 1.4301 (A2) & 1.4401 (A4).
- Table above is prepared according to LGA test results.
- Loads stated are characteristic resistance loads.
- Bolts are provided separately.
- Test results are available upon order.

BA Body Anchor

- Load bearing & restraint
- Three dimensional adjustability
- Fastened on to load bearing walls with expansion bolts and on to channels with set screws
- Projection sizes between 60 and 160 mm
- Suitable for horizontal & vertical joints

- Loads up to 900 N
- Stone thicknesses 20-50 mm

Product Code Description

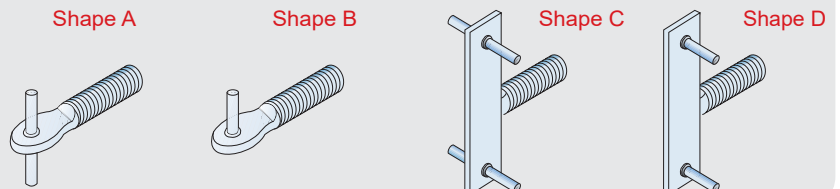
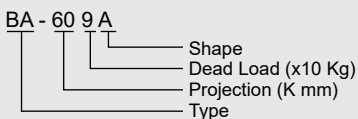

AXO1 & AXO2 Body Anchor - Product Details

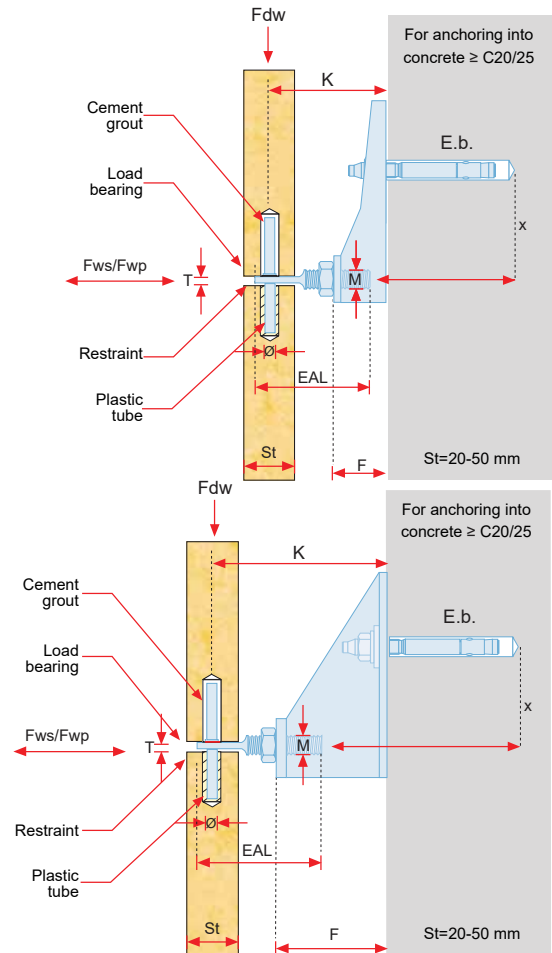

Product Code	Technical Details												
	Projection	Min. Projection	Max. Projection	Dead Load	Forming Size	Wind-Pressure	Wind-Suction	Expansion Bolt Size	Pin Size	Adj. Arm Metric Size	Adj. Arm Flat Thickness	Adj. Arm Length	X Size
	K (mm)	K - (mm)	K + (mm)	Fdw (N)	F (mm)	Fwp (N)	Fws (N)	E.b. (mm)	Ø (mm)	M (mm)	T (mm)	EAL (mm)	x (mm)
AXO1-705	70	55	85	500	20	780	546	M8X80	5	M12	4.5	80	50
AXO1-1105	110	95	125		60								
AXO1-7013	70	55	85	1300	20	2028	1419	M10X90	6	M16	6	80	50
AXO1-11013	110	95	125		60								
AXO2-1505	150	135	165	500	100	780	546	M8X80	5	M12	4.5	80	50
AXO2-15013	150	135	165	1300	100	2028	1419	M10X90	6	M16	6		

- Material : Stainless Steel 1.4301 (A2) & 1.4401 (A4).
- Table above is prepared according to Eurocode standard.
- Loads stated are working resistance loads.
- Other sizes are available for production upon request.
- Bolts are provided separately.
- Structural calculations are available upon order.

AXO1 & AXO2 Body Anchor

- Load bearing & restraint
- Three dimensional adjustability
- Fastened on to load bearing walls with expansion bolts and on to channels with set screws
- Projection sizes between 70 and 150 mm
- Suitable for horizontal & vertical joints

- Loads up to 1300 N
- Stone thicknesses 20-50 mm

Product Code Description

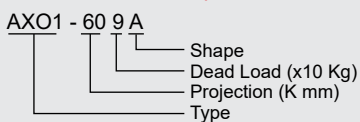

Shape A

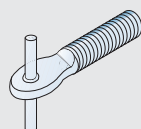

Shape B

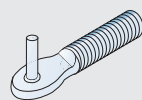

Shape C

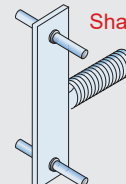

Shape D

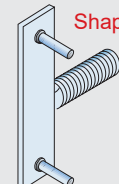

AXO3 Body Anchor - Product Details

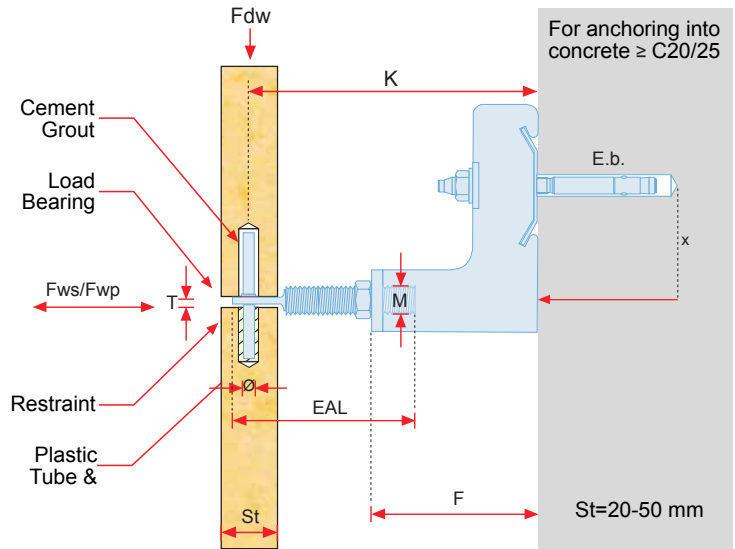

Product Code	Technical Details													
	Projection	Min. Projection	Max. Projection	Dead Load	Forming Size	Wind-Pressure	Wind-Suction	Expansion Bolt Size	Pin Size	Adj. Arm Metric Size	Adj. Arm Flat Thickness	Adj. Arm Length	X Size	
	K (mm)	K - (mm)	K + (mm)	Fdw (N)	F (mm)	Fwp (N)	Fws (N)	E.b. (mm)	Ø (mm)	M (mm)	T (mm)	EAL (mm)	x (mm)	
AXO3-2005	200	180	220	500	155	780	546	M8X120	5	M12	4.5	80	75	
AXO3-2205	220	200	240		175									
AXO3-2405	240	220	260		195									
AXO3-2605	260	240	280		215									
AXO3-2009	200	180	220	900	155	1430	1000	M10X130	6	M14	5.5	80	75	
AXO3-2209	220	200	240		175									
AXO3-2409	240	220	260		195									
AXO3-2609	260	240	280		215									
AXO3-20013	200	180	220	1300	155	2028	1419	M12X145	6	M16	6	80	80	
AXO3-22013	220	200	240		175									
AXO3-24013	240	220	260		195									
AXO3-26013	260	240	280		215									

- Material : Stainless Steel 1.4301 (A2) & 1.4401 (A4).
- Table above is prepared according to Eurocode standard
- Loads stated are working resistance loads.
- Bolts are provided separately.
- Structural calculations are available upon order.

AXO3 Body Anchor

- Load bearing & restraint
- Three dimensional adjustability
- Fastened on to load bearing walls with expansion bolts and on to channels with set screws
- Projection sizes between 200 and 260 mm
- Suitable for horizontal & vertical joints

- Loads up to 1300 N
- Stone thicknesses 20-50 mm

Product Code Description

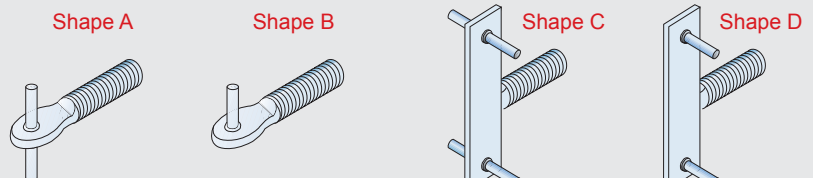
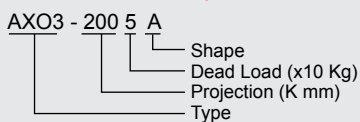

AXO4 Body Anchor - Product Details

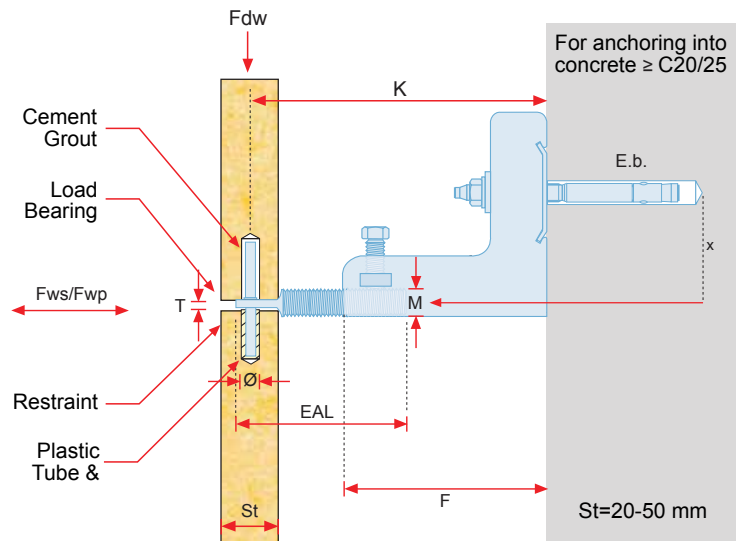

Product Code	Technical Details													
	Projection	Min. Projection	Max. Projection	Dead Load	Forming Size	Wind-Pressure	Wind-Suction	Expansion Bolt Size	Pin Size	Adj. Arm Metric Size	Adj. Arm Flat Thickness	Adj. Arm Length	X Size	
	K (mm)	K - (mm)	K + (mm)	Fdw (N)	F (mm)	Fwp (N)	Fws (N)	E.b. (mm)	Ø (mm)	M (mm)	T (mm)	EAL (mm)	x (mm)	
AXO4-1605	160	140	180	500	115	780	546	M8X120	5	M12	4.5	100	75	
AXO4-1805	180	160	200		135									
AXO4-2005	200	180	220		155									
AXO4-2205	220	200	240		175									
AXO4-2405	240	220	260		195									
AXO4-2605	260	240	280	215										
AXO4-1609	160	140	180	900	115	1430	1000	M10X130	6	M14	5.5	100	75	
AXO4-1809	180	160	200		135									
AXO4-2009	200	180	220		155									
AXO4-2209	220	200	240		175									
AXO4-2409	240	220	260		195									
AXO4-2609	260	240	280	215										
AXO4-16013	160	140	180	1300	115	2028	1419	M12X145	6	M16	6	100	80	
AXO4-18013	180	160	200		135									
AXO4-20013	200	180	220		155									
AXO4-22013	220	200	240		175									
AXO4-24013	240	220	260		195									
AXO4-26013	260	240	280	215										

- Material: Stainless Steel 1.4301 (A2) & 1.4401 (A4).
- Table above is prepared according to Eurocode standard.
- Loads stated are working resistance loads.
- Other sizes are available for production upon request.
- Bolts are provided separately.
- Structural calculations are available upon order.

AXO4 Body Anchor

- Load bearing & restraint
- Three dimensional adjustability
- Fastened on to load bearing walls with expansion bolts and on to channels with set screws
- Projection sizes between 160 and 260 mm
- Suitable for horizontal & vertical joints

- Loads up to 1300 N
- Stone thicknesses 20-50 mm

Product Code Description

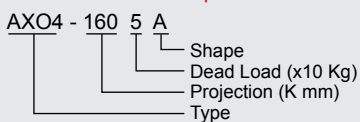

Shape A

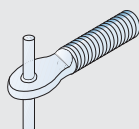

Shape B

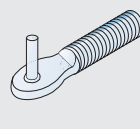

Shape C

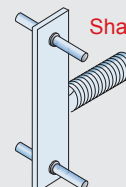

Shape D

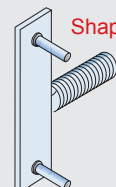

HRS3 Restraint Anchor - Product Details

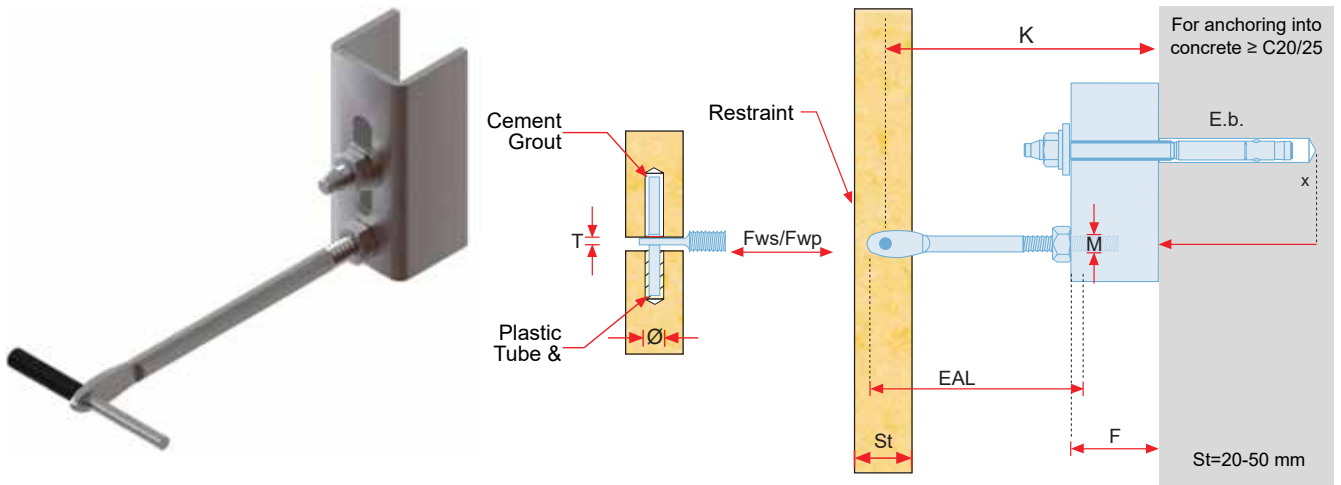

• Available in sizes to fit the projection range of all AXO anchors.

Product Code	Technical Details											
	Projection	Min. Projection	Max. Projection	Forming Size	Wind-Pressure	Wind-Suction	Expansion Bolt Size	Pin Size	Adj. Arm Metric Size	Adj. Arm Flat Thickness	Adj. Arm Length	X Size
	K (mm)	K - (mm)	K + (mm)	F (mm)	Fwp (N)	Fws (N)	E.b. (mm)	Ø (mm)	M (mm)	T (mm)	EAL (mm)	x (mm)
HRS03-60	60	40	80	25	2028	1419	M8X80	5	M8	3	70	30
HRS03-80	80	60	100								90	
HRS03-100	100	80	120	32							100	
HRS03-120	120	100	140								120	
HRS03-140	140	120	160	140								
HRS03-160	160	140	180	40							160	
HRS03-180	180	160	200								170	
HRS03-200	200	180	220	50							190	
HRS03-220	220	200	240								210	
HRS03-240	240	220	260	220								
HRS03-260	260	240	280	240								

- Material: Stainless Steel 1.4301 (A2) & 1.4401 (A4)
- Table above is prepared according to Eurocode standard
- Loads stated are working resistance loads
- Other sizes are available for production upon request
- Bolts are provided separately
- Structural calculation reports are available upon order

HRS3 Restraint Anchor

- Load bearing & restraint
- Three dimensional adjustability
- Fastened on to load bearing walls with expansion bolts and on to channels with set screws
- Projection sizes between 60 and 260 mm
- Suitable for horizontal & vertical joints

- Loads up to 2028 N
- Stone thicknesses 20-50 mm

Product Code Description

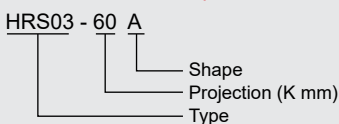

Shape A

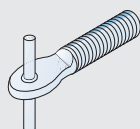

Shape B

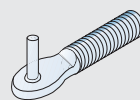

Shape C

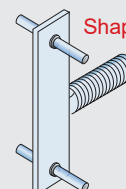

Shape D

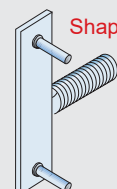

HZTA Telescope Anchor - Product Details

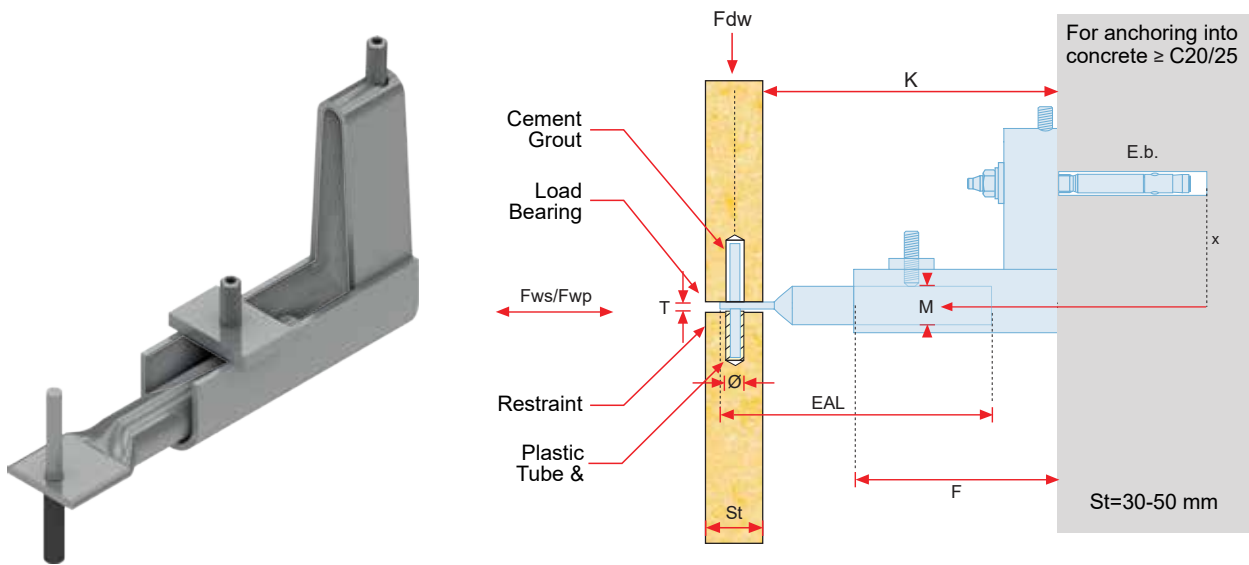

Product Code	Technical Details													
	Projection	Min. Projection	Max. Projection	Dead Load	Forming Size	Wind-Pressure	Wind-Suction	Expansion Bolt Size	Pin Size	Adj. Arm Dia.	Adj. Arm Flat Thickness	Adj. Arm Length	X Size	
	K (mm)	K - (mm)	K + (mm)	Fdw (N)	F (mm)	Fwp (N)	Fws (N)	E.b. (mm)	Ø (mm)	M (mm)	T (mm)	EAL (mm)	x (mm)	
HZTA-15011	150	135	165	1100	90	1300	1300	M10	6	Ø21,3	4	132	75	
HZTA-18011	180	165	195		120									
HZTA-21011	210	195	225		150									
HZTA-24011	240	225	255		180									
HZTA-27011	270	255	285		210									
HZTA-30011	300	285	315	240										

- Material: Stainless Steel 1.4301 (A2) & 1.4401 (A4).
- Table above is prepared according to Eurocode standard.
- Loads stated are working resistance loads.
- Other sizes are available for production upon request.
- Bolts are provided separately.
- Structural calculations are available upon order.

HZTA Telescope Anchor

- Load bearing & restraint
- Three dimensional adjustability
- Fastened on to load bearing walls with expansion bolts and on to channels with set screws
- Projection sizes between 150 and 300 mm
- Suitable for horizontal & vertical joints

- Loads up to 1100 N
- Stone thicknesses 30-50 mm

Product Code Description

HZTA - 150 11

— Dead Load
— Projection (K mm)
— Type

Shape A

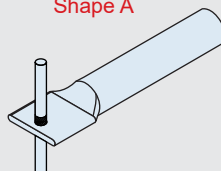

Shape B

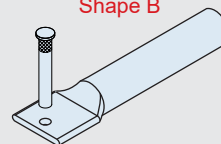

AXO Body Anchor - Special Application Details



Body anchor with welded plate with two pins. Used for stone installation with single anchor. This type used for installation of reveals with maximum width of 25 cm.



Body anchor with welded shims and HB09 execution. With this type of anchor, stone panels are supported from the rear surface using HB09 bolts instead of from the edges using pins.



Body anchor with welded plate and riveted nut. A feature of HZ05 which is chosen for the fine adjustment of the projection by spinning or rotating the riveted nut while pins are set on the stone.



Special Designs

Body anchors are used for stone installation around columns.

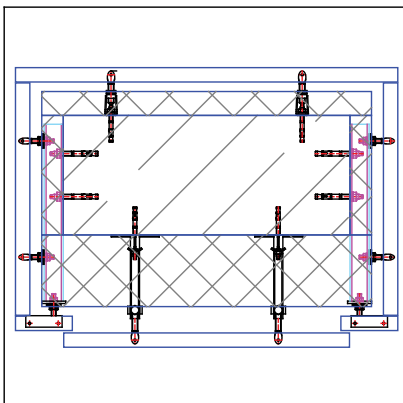

Body anchors are used to form an oval column in natural stone.

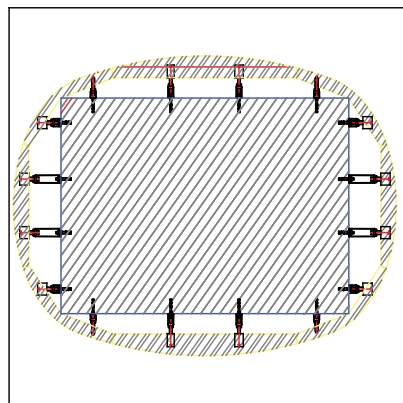

Body anchors used for installation of parapet area.

