

Note: This drawing is intended to illustrate the correct application of Alumasc products only. All other elements are shown indicatively and it is not the intention to detail building construction.

File: 662054.dwg

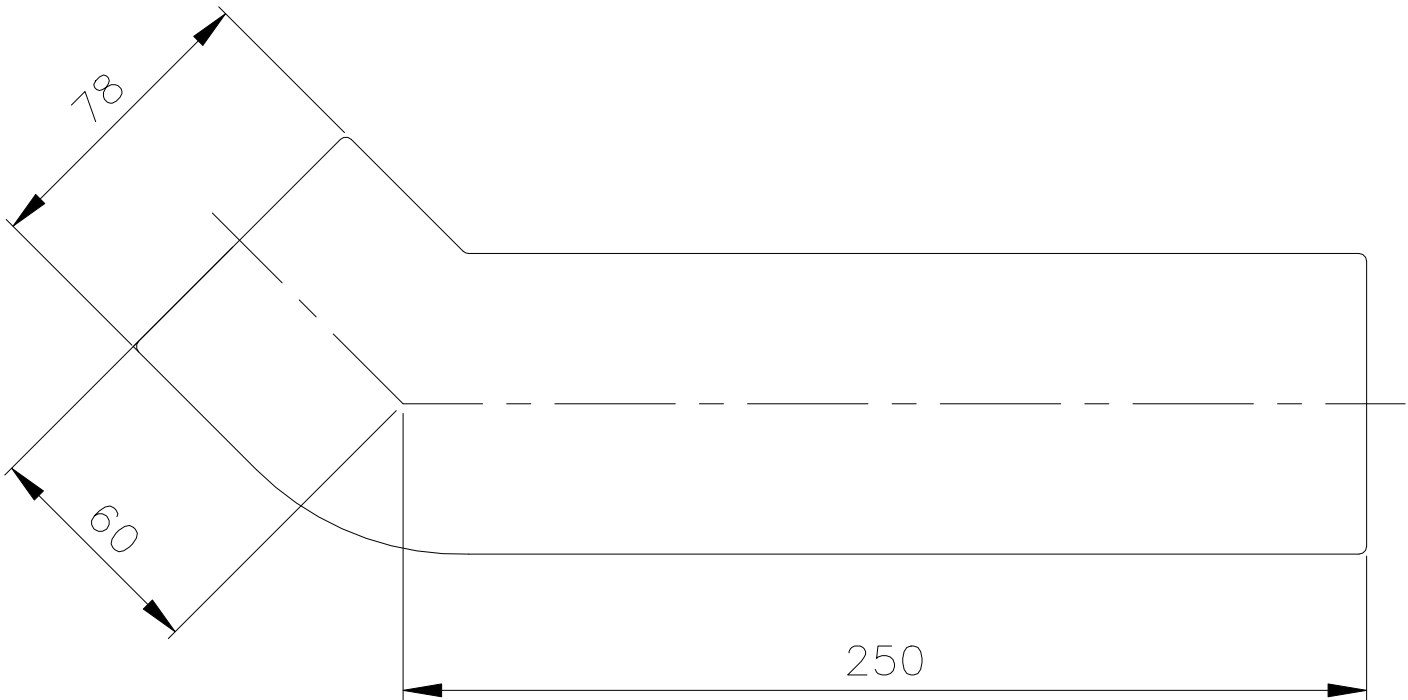

HARMER SML SOCKETLESS SOIL AND WASTE SYSTEM

	<b>ALUMASC EXTERIOR BUILDING PRODUCTS LTD</b> White House Works, Bold Road, Sutton St Helens, Merseyside, WA9 4JG, UK Telephone: +44 (0)1744 648400 Facsimile: +44 (0)1744 648401 Website: <a href="http://www.alumascdrainage.co.uk">www.alumascdrainage.co.uk</a> E-mail: <a href="mailto:technical@alumasc-exteriors.co.uk">technical@alumasc-exteriors.co.uk</a>		<b>Drawing title:</b> <b>70 BEND WITH SPIGOT 45°</b>	© Copyright reserved	
	Detail is valid only when approved by the Architect / Contractor concerned		<b>Drawing No:</b> 662054		<b>Scale:</b> 1:2 @ A4
			<b>Revision:</b> A		<b>Date:</b> AUG 10