

Dimensional Details

Fleet Horizontal Boilers

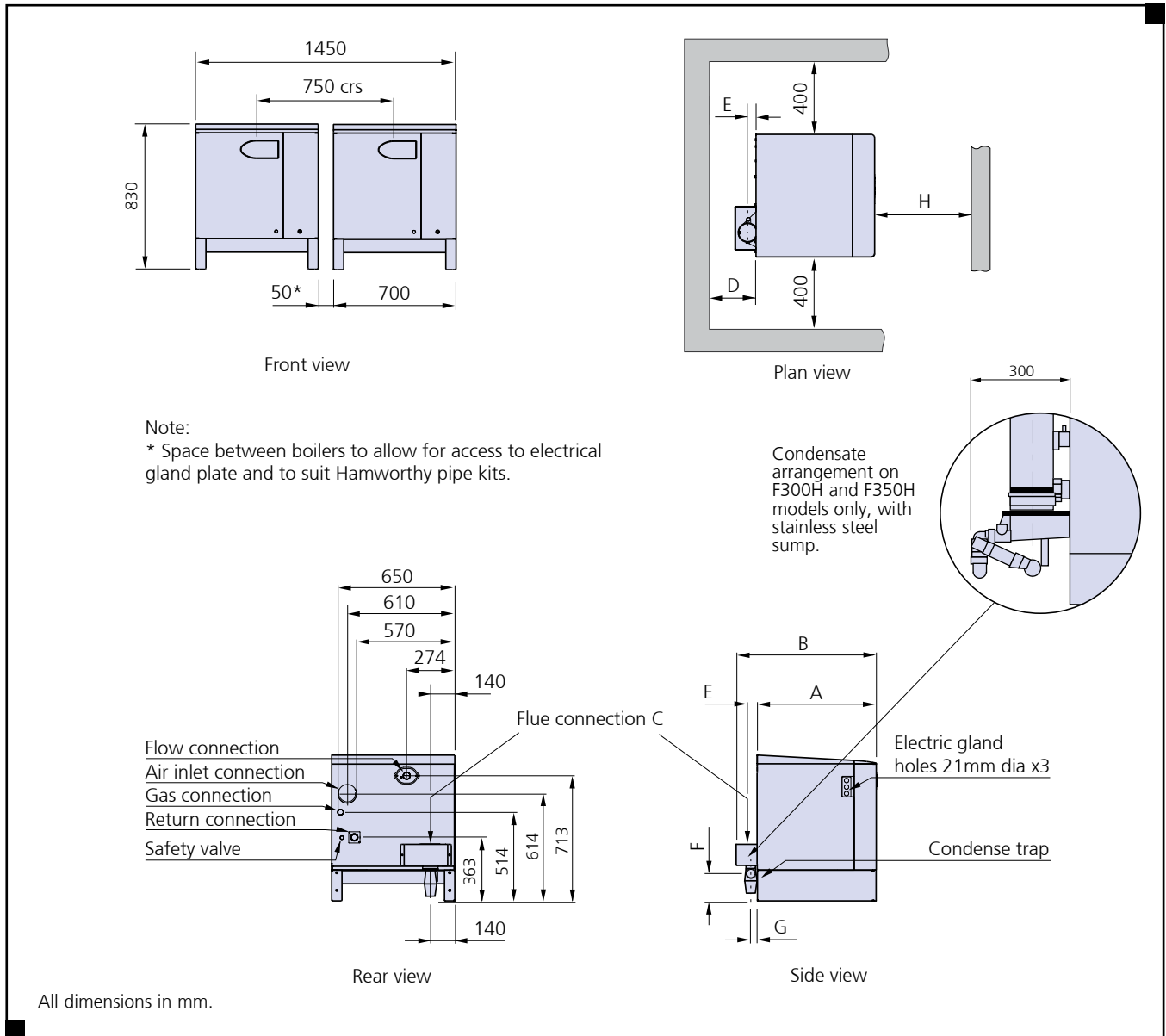

Model	Dimension	F40H	F50H	F60H	F70H	F85H	F100H	F125H	F150H
Casing depth	A				580				680
Flue depth	B				700				800
Flue diameter	C*					100			
Clearance - Rear	D**					250			
Flue Centreline	E					50			
Condense Centreline	F					150			
Condense Centreline	G					25			
Maintenance clearance - minimum	H					450			

C* – the boiler flue connection may be suitable for use with concentric flue systems or twin duct flue systems. For full details of flue options see pages 26 to 35

D** when using Hamworthy pipe kit, otherwise, 450mm.

Dimensional Details

Fleet Horizontal Boilers

Optional Room Sealed Flue Layout

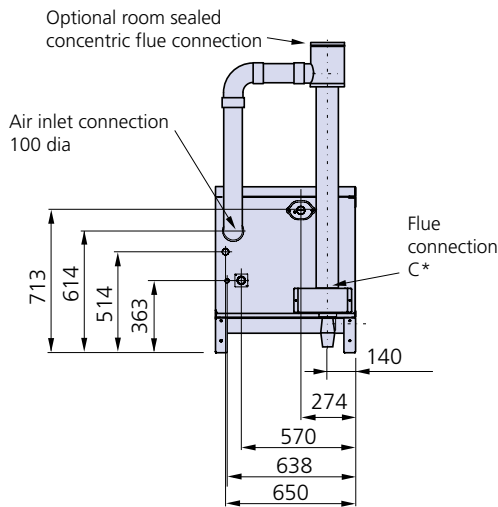
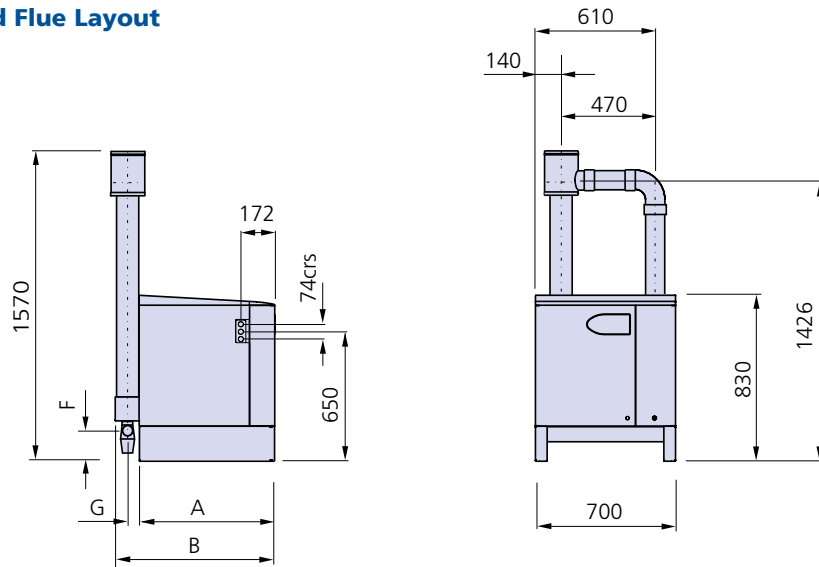

All dimensions in mm.

Note:

The location of the optional room sealed flue connection is shown to accommodate the Fleet Horizontal pipe kit, which is positioned above the boiler casing. If this pipe kit is not being used, then the height of the connection can be reduced.

For full details of flue systems for Fleet Horizontal boilers, refer to pages 26 to 35.

Model	Dimension	F175H	F200H	F250H	F300H	F350H
Casing depth	A		950			1145
Flue depth	B		1100			1325
Flue diameter	C*		130			130
Clearance - Rear	D**		250			400
Flue Centreline	E		50			100
Condense Centreline	F		150			220
Condense Centreline	G		25			275
Maintenance clearance - minimum	H			600		

C* the boiler flue connection may be suitable for use with concentric flue systems or twin duct flue systems. For full details of flue systems, refer to pages 26 to 35

D** when using Hamworthy pipe kit

Dimensional Details

Fleet Horizontal Boiler Pipe Kits – for Boiler Models F40H to F150H

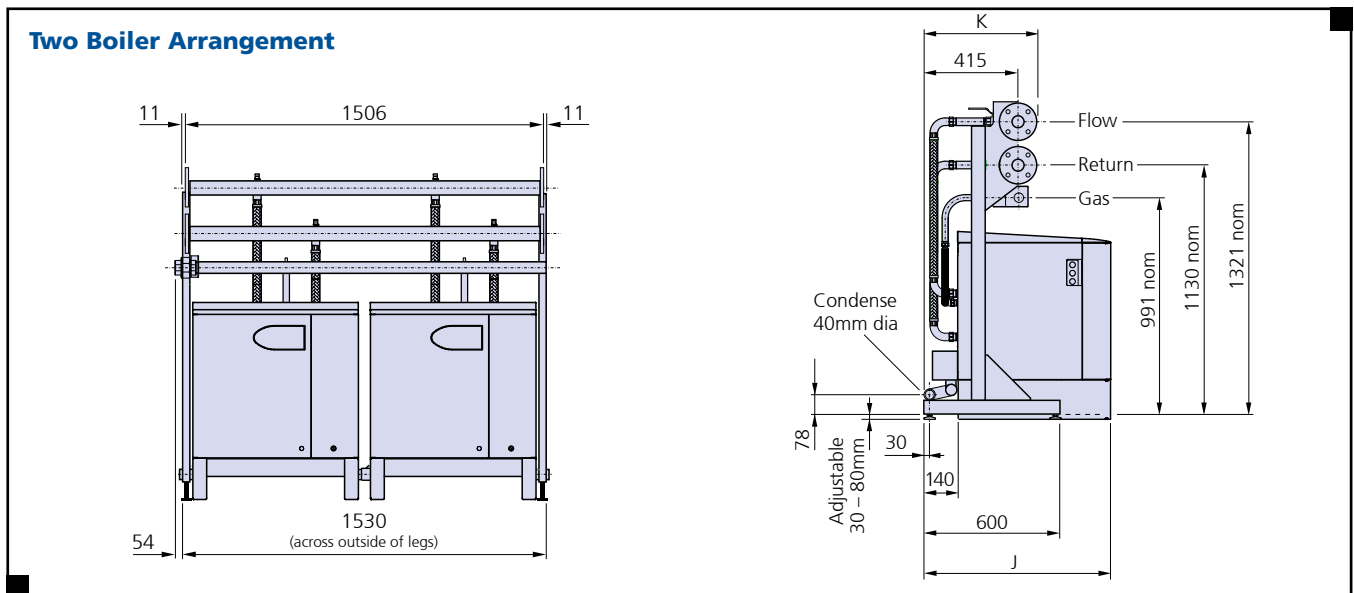
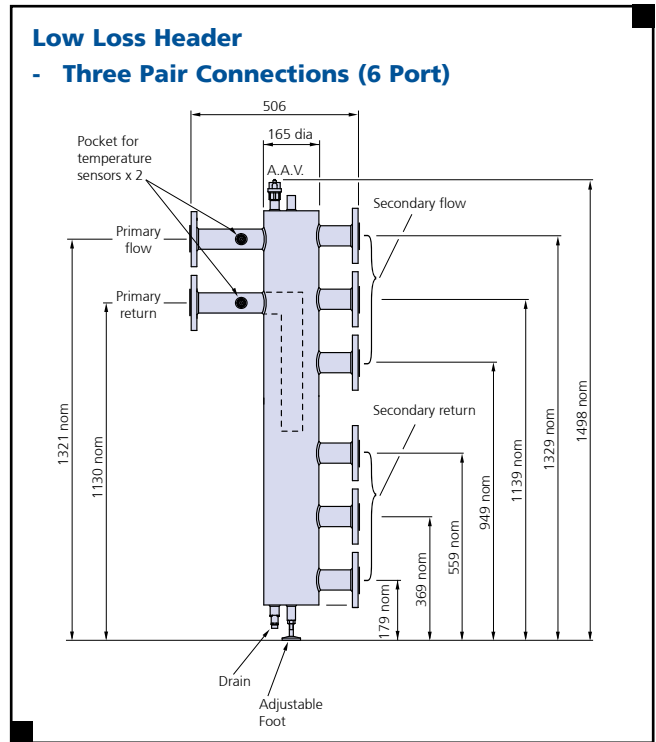
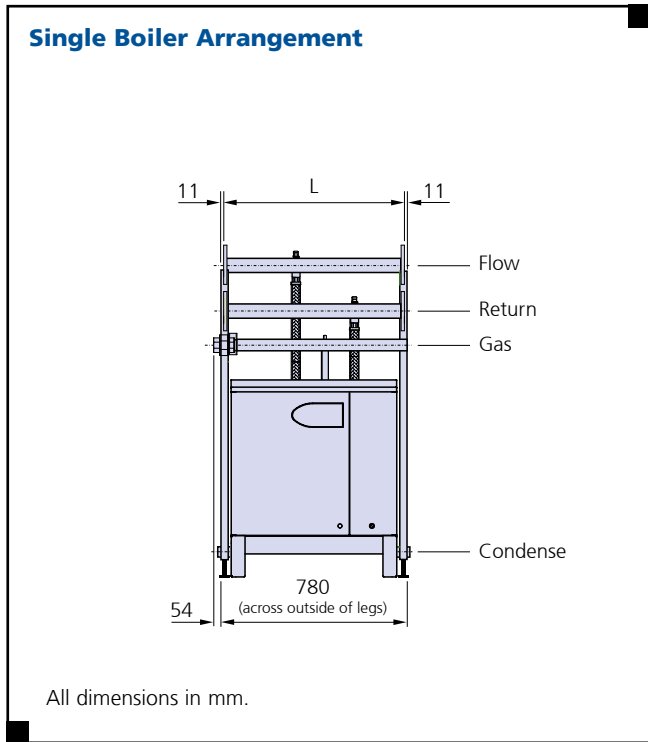

Model	Dimension	F40H	F50H	F60H	F70H	F85H	F100H	F125H	F150H
Overall depth	J				725			825	
Header depth	K				498			508	
Width	L				756			760	
Flow					DN50 - PN16			DN65 - PN16	
Return					DN50 - PN16			DN65 - PN16	
Gas					R1½"			R2"	

Dimensional Details

Fleet Horizontal Boiler Pipe Kits – for Boiler Models F40H to F150H

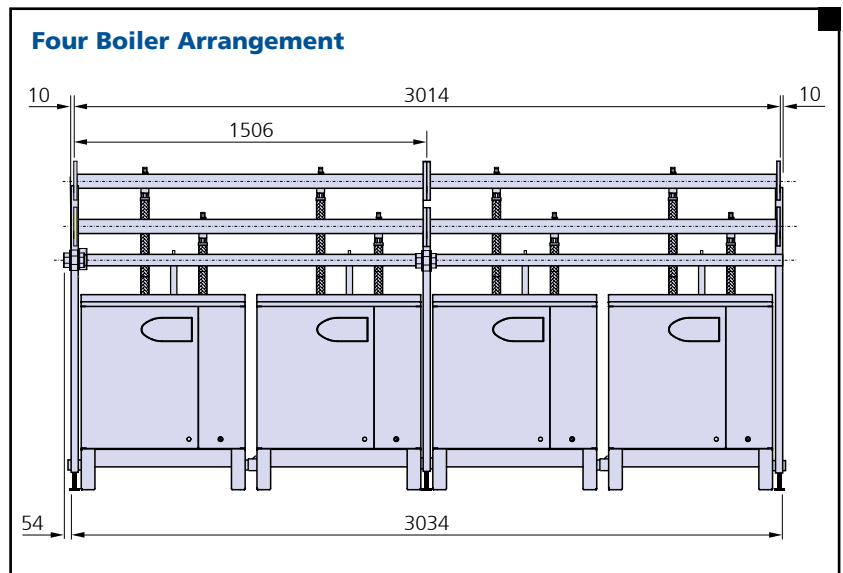
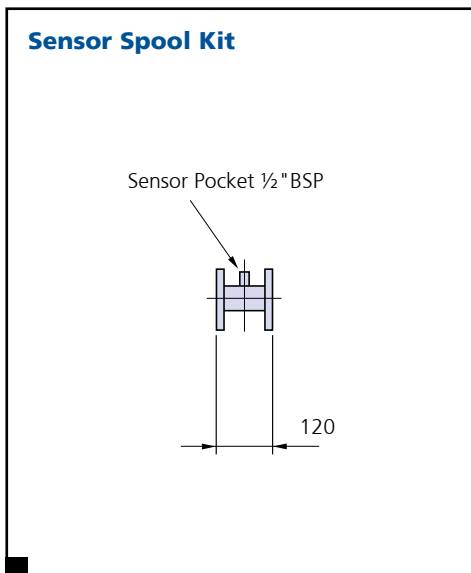
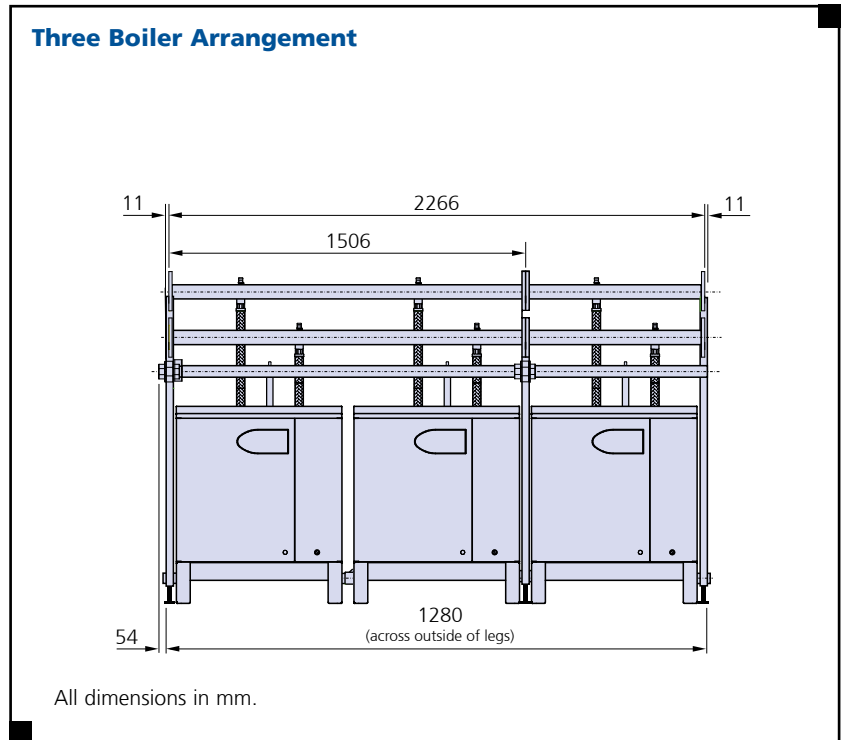
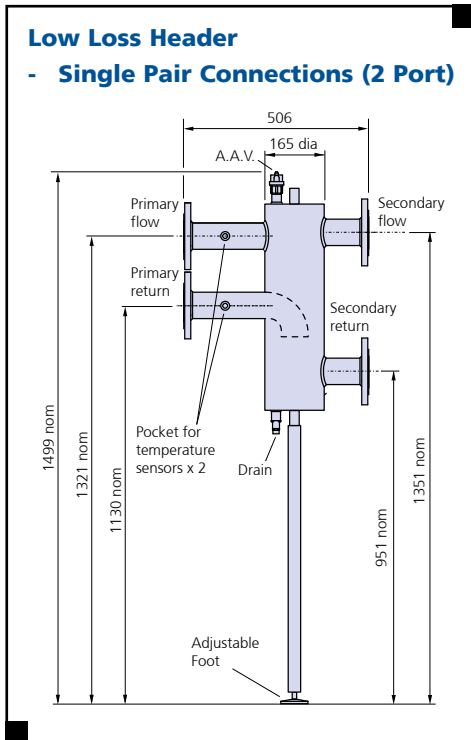

Notes:

1. Pipe work is supported on a freestanding frame and the boilers will be installed between the frames. Frame sets are supplied as a single boiler set or two boiler set, for connecting together on site.
2. System pipe connections can be made to either end of the pipe kit. Blanking flanges provided.
3. Low loss headers can be fitted to either end of the pipe kit.
4. Sensor spool kit comprises a pair of spool pieces for flow & return connections, and these can be fitted to either end of the pipe kit.
5. If low loss headers are used, then a sensor spool is not required.

Dimensional Details

Fleet Horizontal Boiler Pipe Kits – for Boiler Models F175H to F350H

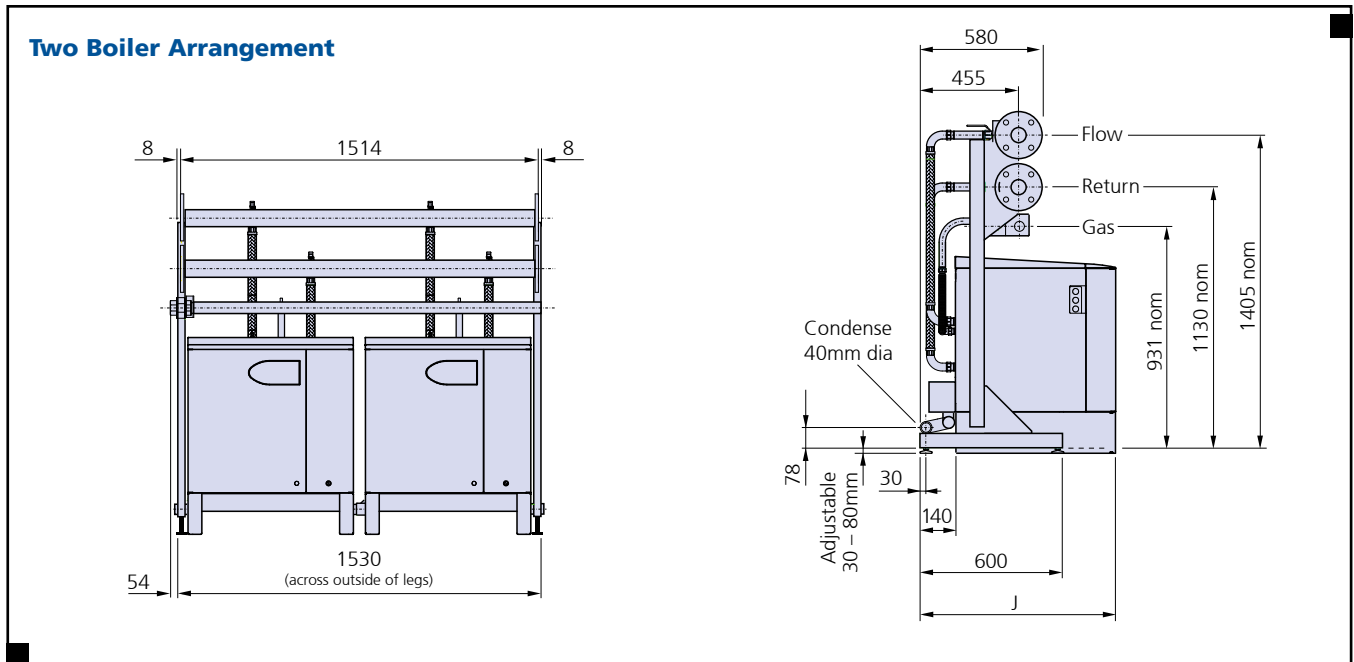
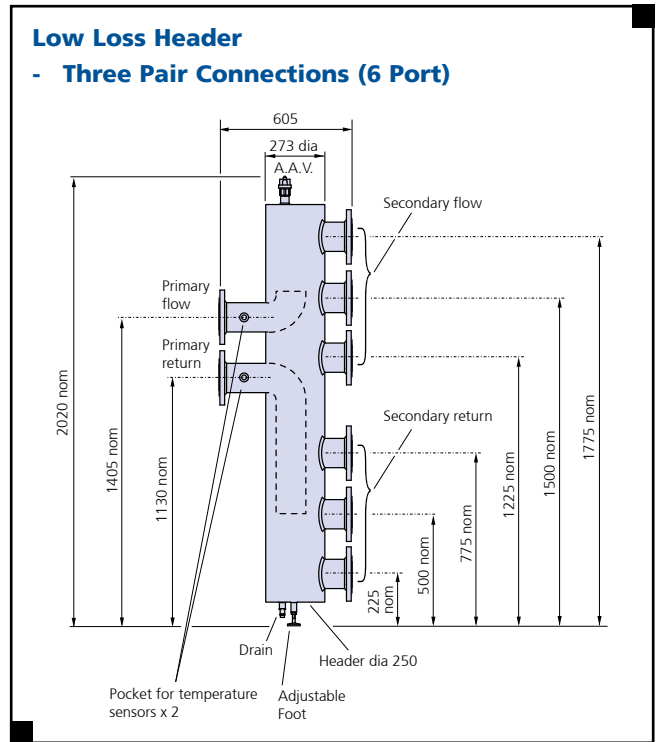
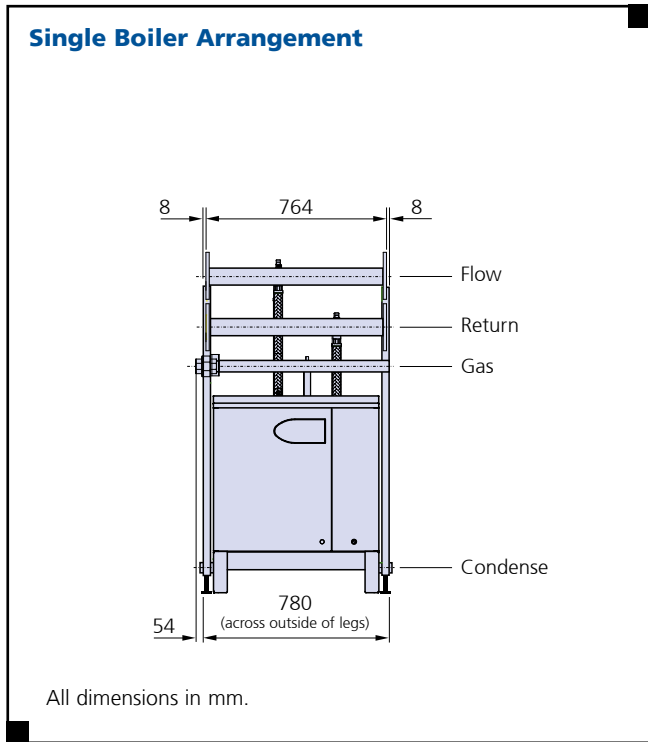

Model	Dimension	F175H	F200H	F250H	F300H	F350H
Overall depth	J	1127			1322	
Flow		DN125 - PN16				
Return		DN125 - PN16				
Gas		R2½"				

Dimensional Details

Fleet Horizontal Boiler Pipe Kits – for Boiler Models F175H to F350H

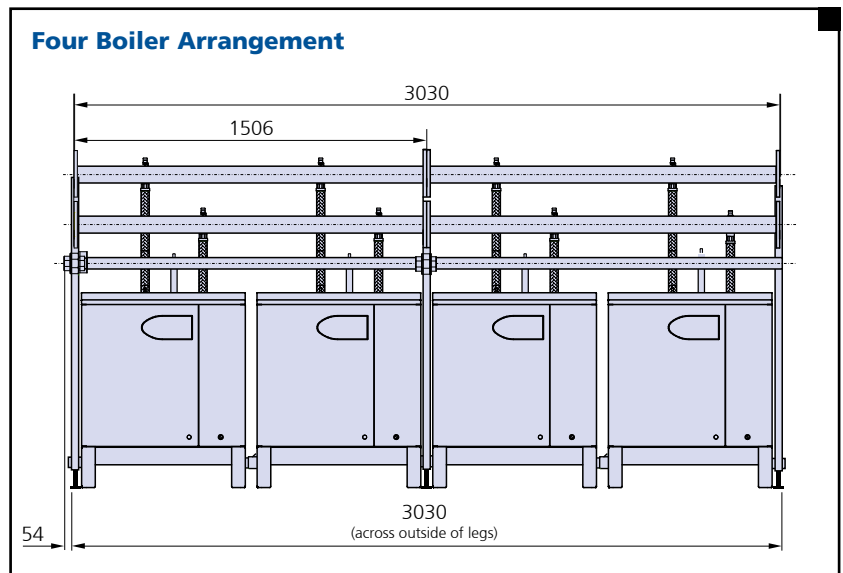
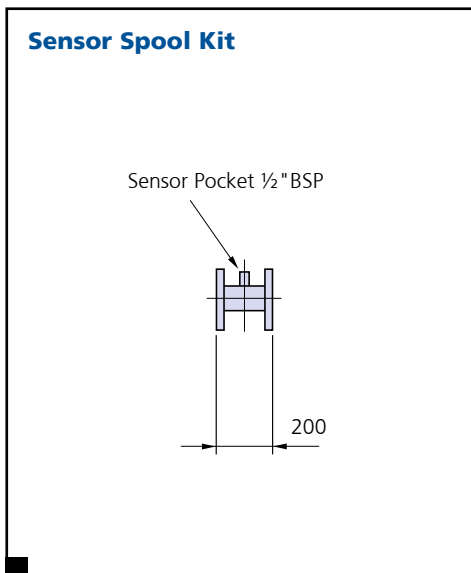
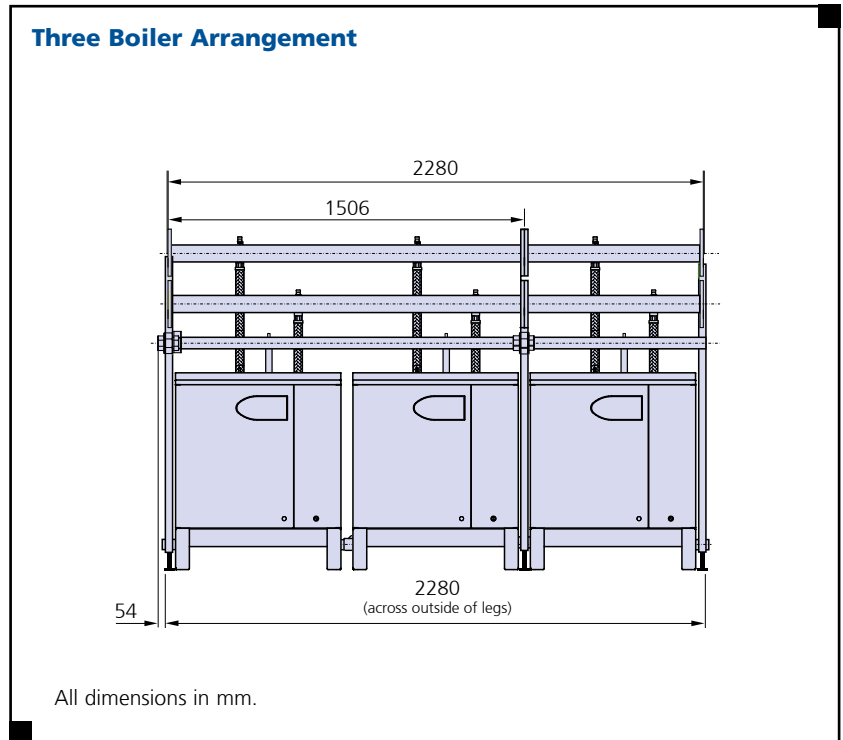
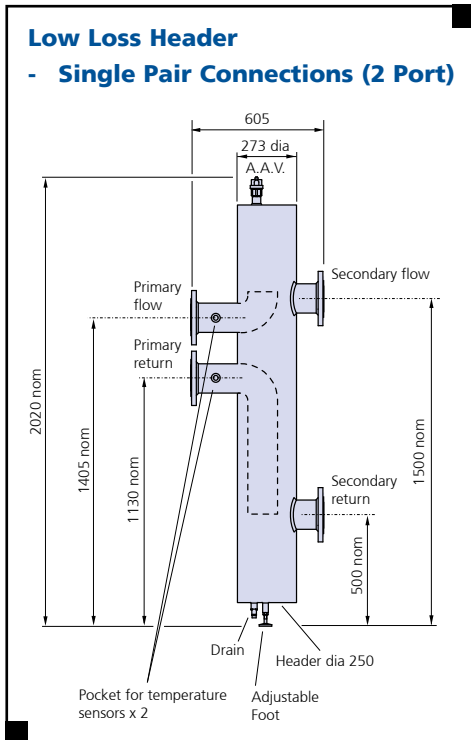

Notes:

1. Pipe work is supported on a freestanding frame and the boilers will be installed between the frames. Frame sets are supplied as a single boiler set or two boiler set, for connecting together on site.
2. System pipe connections can be made to either end of the pipe kit. Blanking flanges provided.
3. Low loss headers can be fitted to either end of the pipe kit.
4. Sensor spool kit comprises a pair of spool pieces for flow & return connections, and these can be fitted to either end of the pipe kit.
5. If low loss headers are used, then a sensor spool is not required.