

Cable tray hook



End fixing specifically designed for cable trays.

PRODUCT INFORMATION

- Fits cable trays from 100 mm to 300 mm wide
- Can be attached to both holes and slots of cable trays
- For supporting up to 45 kg of load, with a 5:1 safety factor
- Comes as a ready-to-use kit with GripplE Y-Fit hanger (No. 2) or Y-Fit accessory (No. 2)
- Available in lengths of 1 m, 2 m and 3 m



INSTALLATION

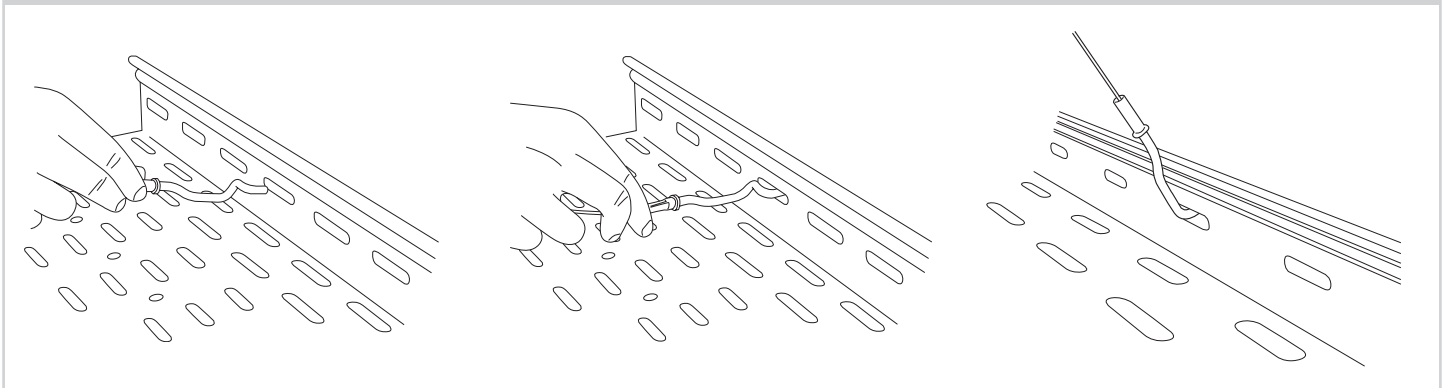

PRODUCT DIMENSIONS

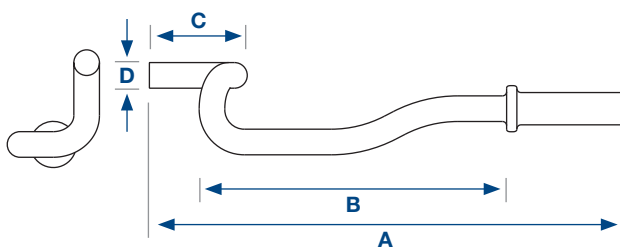

For use with No.2 wire rope only (45 kg)

Dimension	Size (mm)
A	92
B	60
C	19
D	5

IMPORTANT INFORMATION

1. Construction materials and conditions vary on different sites. If it is suspected that the base material has insufficient strength to achieve a suitable fixing, contact GripplE Ltd. The responsibility for judgement of base material strength lies with the installer, and not with GripplE Ltd.
2. The information and recommendations given herein are believed to be correct at time of writing. The data has been obtained from tests done under laboratory, or other controlled conditions and it is the users responsibility to use the data given in light of conditions on site, taking account of the intended use of the products concerned.
3. Whilst GripplE Ltd can give general guidance and advice, the nature of GripplE products means that the ultimate responsibility for selecting the correct product for a particular application must lie with the customer.
4. All products must be used, handled and applied in accordance with current product instructions and manufacturers recommendations for use, published by GripplE Ltd.
5. GripplE's policy is one of continuous development and innovation. We therefore reserve the right to alter specifications, etc. without notice.