



Catenary Solutions

For suspending M&E services,
HVAC and Signage



Introduction

When it comes to services, there isn't always a practical anchoring point available; it's often impossible to hang directly from a purlin or drill straight into the soffit. The revolutionary Gripple Catenary System engineers new solutions, maximising your potential with minimum effort.

Removing the need for strut, brackets and other excess materials, catenaries are substantially lighter, significantly reducing the loads imposed on a structure. Not only do they help you save on material costs, catenaries improve health and safety too, reducing the risk of injury from cutting and time spent working at heights.

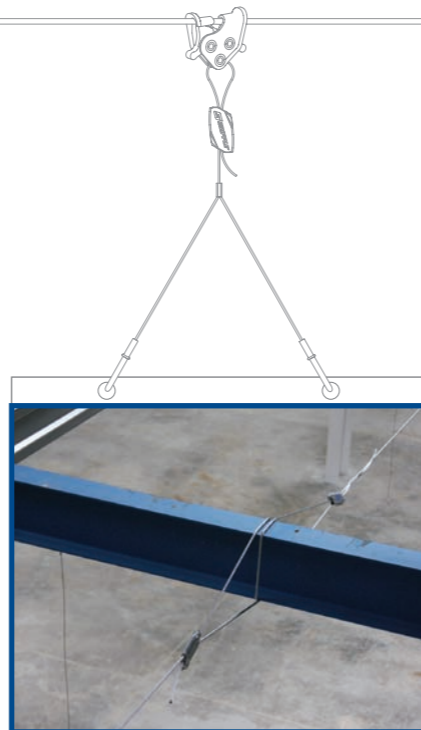

Concept

Gripple Catenary Kits create secure, overhead spans by running high strength cables horizontally between two fixing points. This opens up new options and is made even easier by the Gripple C-Clip. An innovative, twist-on device for hanging anywhere along the wire, the C-Clip can be fitted retrospectively, and offers complete control of both vertical and horizontal positioning.

Installed substantially faster and adjusted considerably easier, catenaries can be used to hang all manner of services in places that would otherwise be impossible.

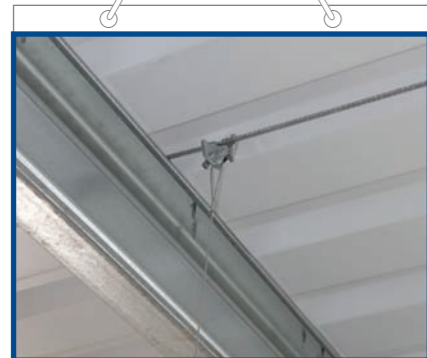

Catenary Kit Advantages

- Up to 6 times faster than channel and brackets
- Eliminates sawing
- Reduces time spent working at heights
- Aesthetic and lighter than strut
- Easy to store and handle on-site
- More environmentally friendly, CO₂ reduction

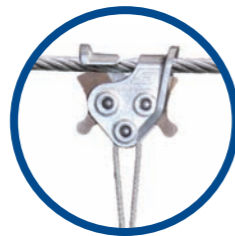

C-Clip Advantages

- Up to 10 times faster to install
- Allows horizontal and vertical adjustment
- Cams lock solidly in place even at angles up to 60°
- 3 mm and 6 mm versions available
- Ready-to-use kit
- Can be fitted retrospectively

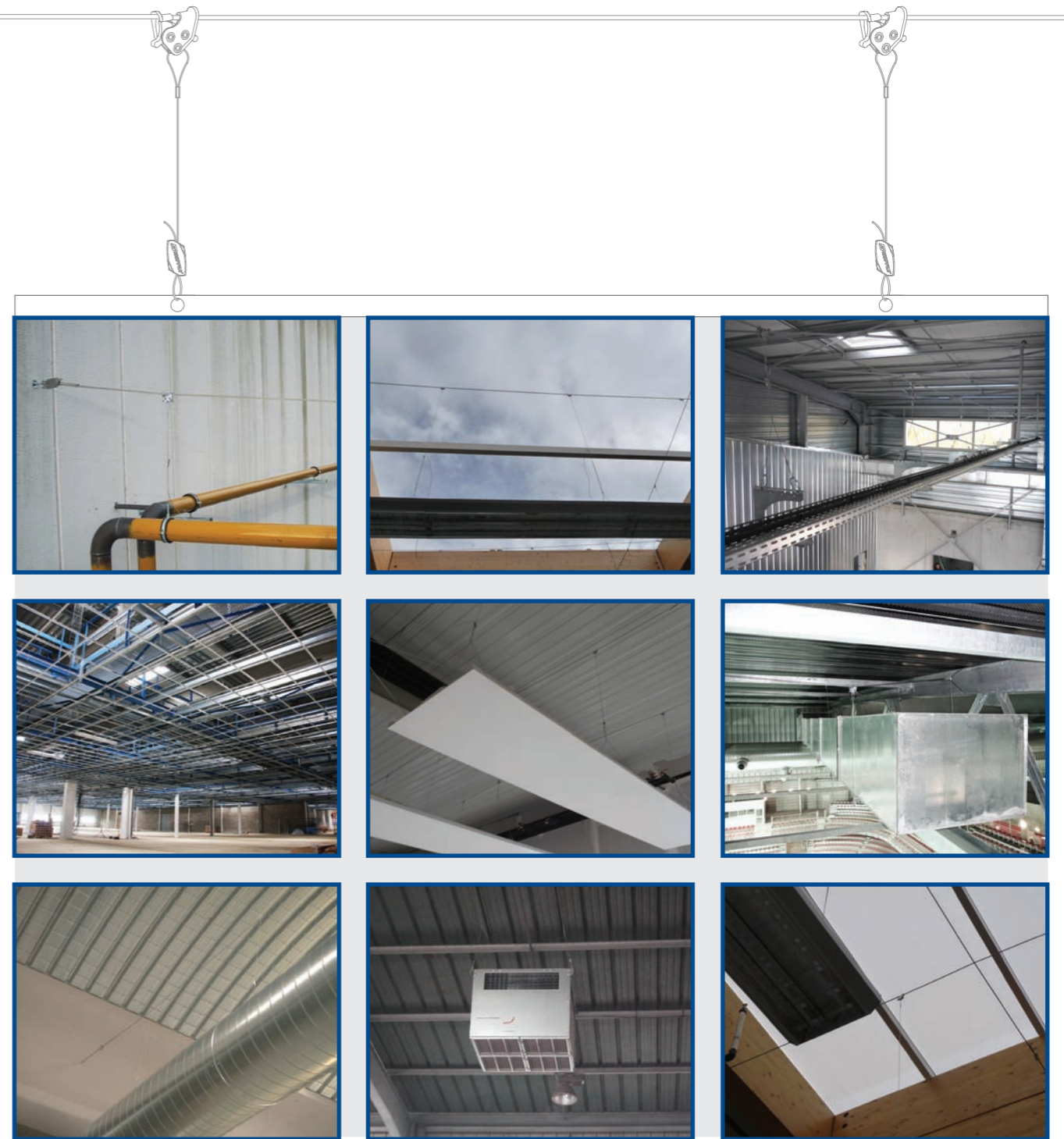

Busbar, **Trunking**, Cable Tray, Basket and Ladder, **Spot Lights**, Strip Lighting, **Pipe Work**, Spiral, Rectangular and Oval Ductwork, **Fabric Ductwork**, Plenum Boxes, **Chilled Beams**, Air-Conditioning Units, **Radiant Panels**, Suspended Ceilings, **Acoustic Baffles**, Signage, **Decorations**

Heavy Duty Catenaries

6 mm Catenary Kit and 6 mm C-Clip

The Gripple Heavy Duty Catenary system is ideal for suspending M&E and HVAC services, or where a long catenary span is required.

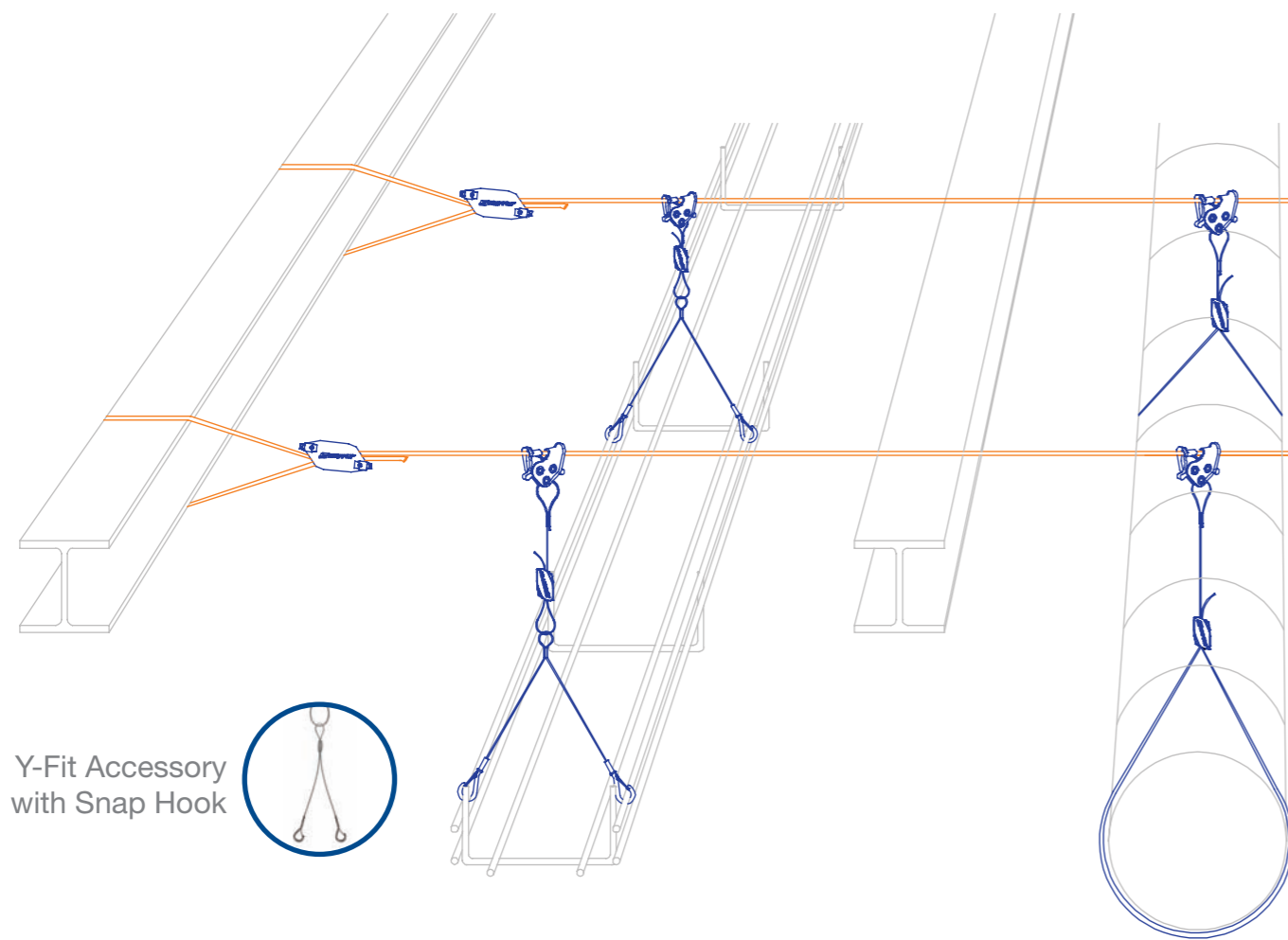
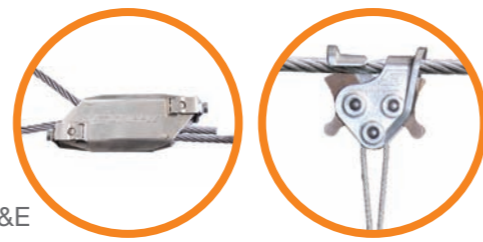

Y-Fit Accessory with Snap Hook

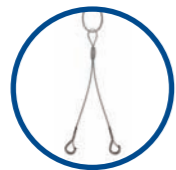

Light Duty Catenaries

3 mm Catenary Kit and 3 mm C-Clip

The Gripple Light Duty Catenary system is ideal for suspending lightweight electrical services, fabric ductwork and signage.

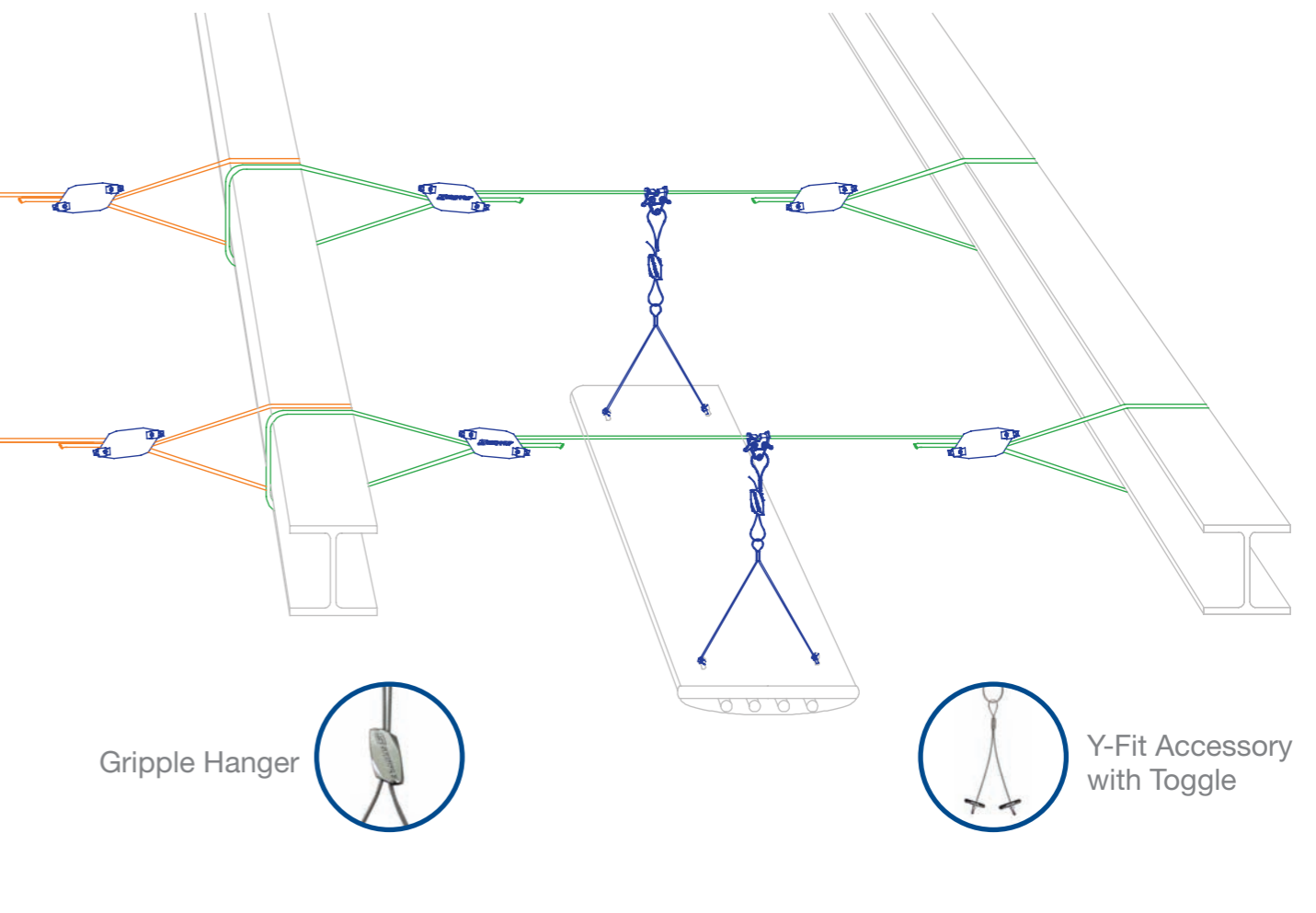
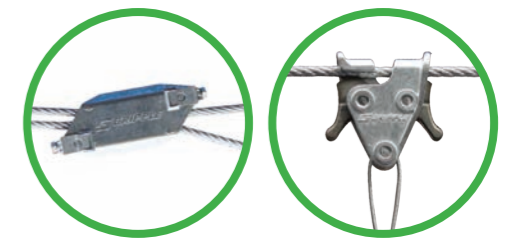

Gripple Hanger



Y-Fit Accessory with Toggle



Catenary Kit

Length	6 mm (0 - 100 kg*)
5 m	6MM-LOCK-2-5M-PACK
10 m	6MM-LOCK-2-10M-PACK
20 m	6MM-LOCK-2-20M-PACK
30 m	6MM-LOCK-2-30M-PACK
40 m	6MM-LOCK-2-40M-PACK

C-Clip

Length	6 mm (0 - 45 kg*)
1 m	HF02-1M-CCLIP-6MM
2 m	HF02-2M-CCLIP-6MM
3 m	HF02-3M-CCLIP-6MM
5 m	HF02-5M-CCLIP-6MM
10 m	HF02-10M-CCLIP-6MM

* Safety factor 5:1

Catenary Kit

Length	3 mm (0 - 30 kg*)
5 m	3MM-LOCK-2-5M-PACK
10 m	3MM-LOCK-2-10M-PACK
20 m	3MM-LOCK-2-20M-PACK
30 m	3MM-LOCK-2-30M-PACK
40 m	3MM-LOCK-2-40M-PACK

C-Clip

Length	3 mm (0 - 10 kg*)
1 m	HF01-1M-CCLIP-3MM
2 m	HF01-2M-CCLIP-3MM
3 m	HF01-3M-CCLIP-3MM
5 m	HF01-5M-CCLIP-3MM
10 m	HF01-10M-CCLIP-3MM

* Safety factor 5:1

Installation Guidelines

3 mm / 6 mm Catenary

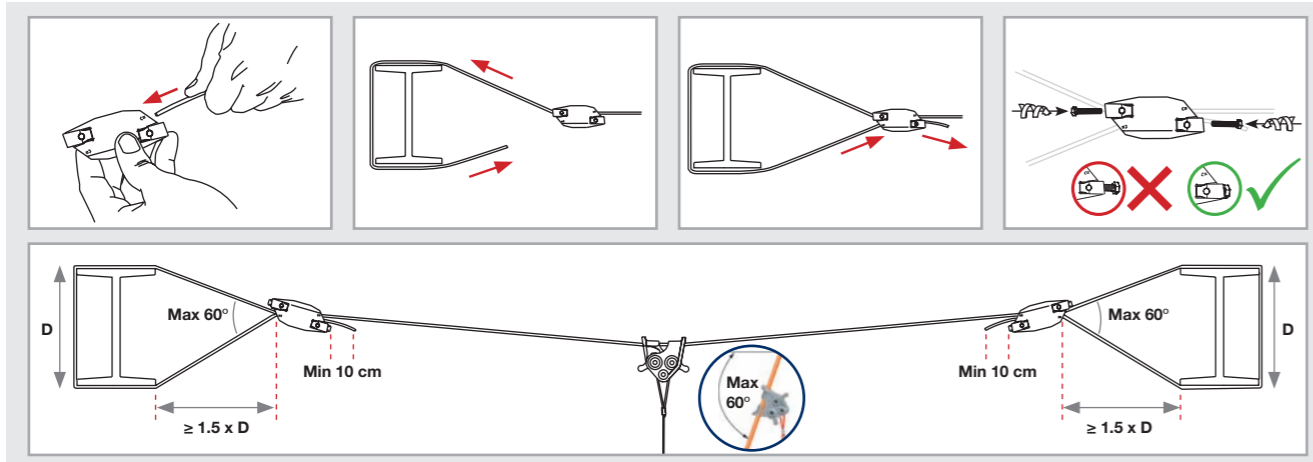

Ensure a distance of at least 1.5 times the height of the beam is left between the Gripper Lockable and the structure. Do not exceed an angle of 60°.

3 mm / 6 mm C-Clip

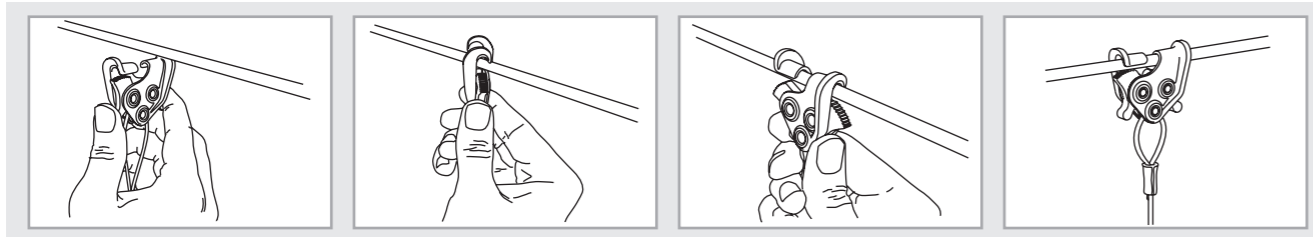

Never suspend at an angle in excess of 60° from horizontal.

Torq Tensioning Tool

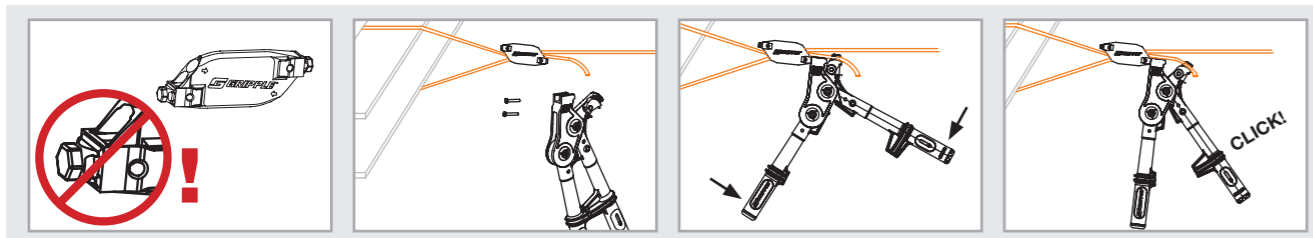

Use the tool to tension the wire-ropes before the locking screws have been inserted and tightened, and before a load has been applied to the catenary wire.

GF Bracket

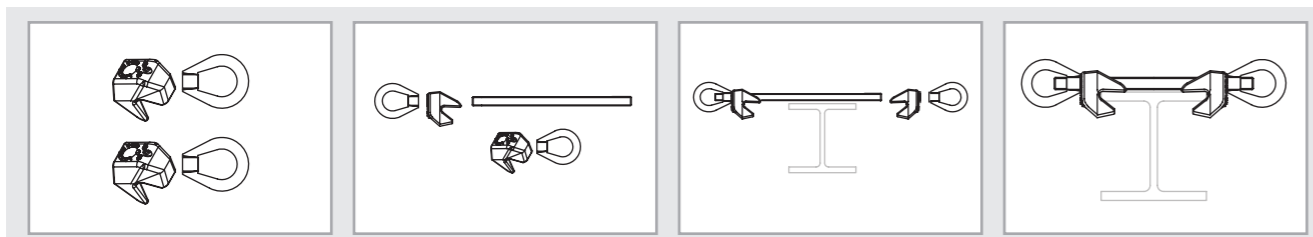

Threaded rod is not provided with this product.

Technical View

The following graphs show the load capacity of 6 mm and 3 mm Catenary Kits, assuming maximum loads are applied. T_0 indicates the tension applied to each beam.

Select your catenary length to find the corresponding sag range. Green indicates that a low stress is placed on the structure, amber may show some structural stress, and the red zone should be avoided at all times. If more information or a site visit is required, please contact your Gripper Area Sales Manager.

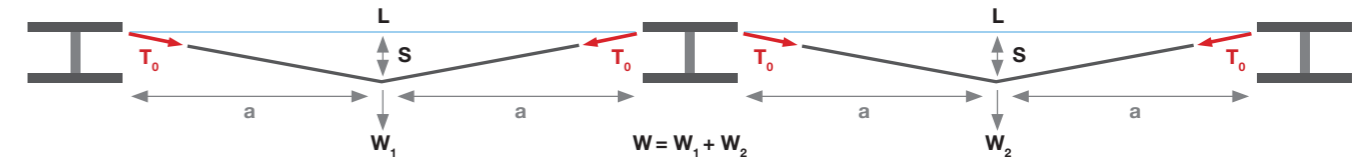

6 mm Catenary (W = 100 kg)

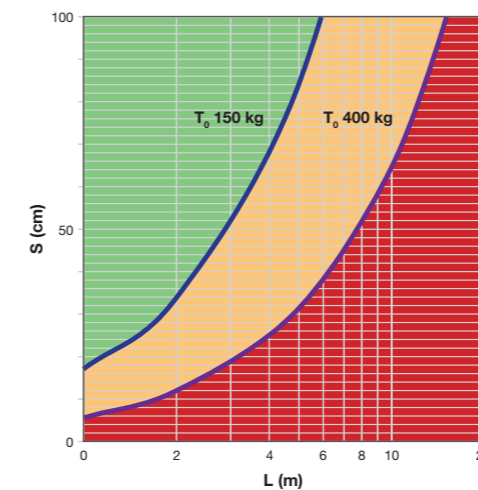

3 mm Catenary (W = 30 kg)

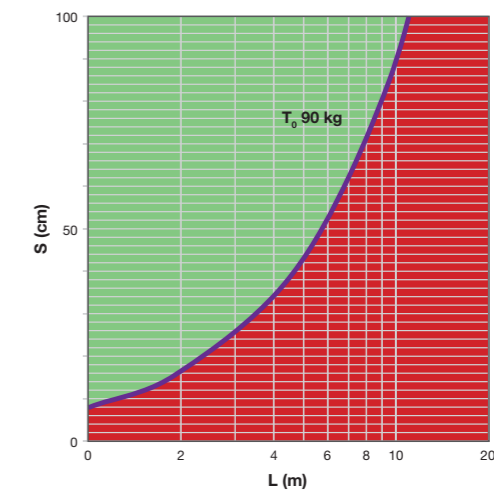

Accessories



Gripper Torq Tensioning Tool

The Gripper Torq Tensioning Tool provides a quick and accurate way to tension catenary wires. This lightweight tool delivers up to 400 kg of load with ease, and is suitable for use with both 3 mm and 6 mm Catenary Kits. **Part code: TOOL-5-SINGLE-LOKABLE**



GF Bracket

The GF bracket is ideal to clamp on an I-Beam when it's not possible to loop around with the catenary wire or when the depth of the beam is too great. Safe working load of 340 kg with 5:1 safety factor.

Suitable for M12 thread and for I-beams 6 mm - 13 mm in thickness. **Part code: GF12-EYENUT**



Adjustment Key

The Adjustment Key is used to reposition the Gripper Lockable along the catenary wire. Insert the key into the small hole beside the wire entry hole to move the internal wedge and allow free movement of the wire rope. This is only possible before tension is applied and by prior removal of the locking screws and the load. **Part code: KEY-HF-LOGO-NO4/NO5**



Wire Cutters

Gripper Wire Cutters are used to deliver cutting on 6 mm wire rope. When the catenary is installed, these long-armed cutters can be used to trim unsightly tail ends to ensure a more aesthetic final appearance. **Part code: CUTTER-GRIPPLE-6MM**

www.gripple.com

info@gripple.com



Gripple Ltd (Headquarters)

The Old West Gun Works
Savile Street East
Sheffield S4 7UQ
UK

UK Sales: 0800 018 4264
Fax: +44 (0)114 275 1155
Email: info@gripple.com



Gripple Europe S.à.r.l

1, rue du commerce
BP 37
67211 Obernai Cedex
France

T | +33 (0)3 88 95 44 95
F | +33 (0)3 88 95 08 78
E | frinfo@gripple.com

Gripple GmbH

Pariser Ring 1
76532 Baden-Baden
Deutschland

T | +49 (0)700 95 44 95 11
F | +49 (0)700 95 08 78 11
E | deinfo@gripple.com

Gripple Inc

1611 Emily Lane
Aurora
IL 60502
USA

T | +1 866 474 7753
F | +1 800 654 0689
E | usinfo@gripple.com

Gripple s.r.l

Via Marconi, 32
24068 Seriate BG
Italia

T | +39 (0)35 300 246
F | +39 (0)35 424 0036
E | itinfo@gripple.com

Gripple Benelux

1, rue du commerce
BP37
67211 Obernai Cedex
Frankrijk

T | +31 (0)70 363 34 30
F | +31 (0)70 362 18 44
E | nlinfo@gripple.com

Gripple Industrial Ibérica, S.L.

Ctra. Logroño km 7, 3 Pol. Europa 1
50011 Zaragoza
España

T | +34 (0)97 678 32 67
F | +34 (0)97 678 32 68
E | esinfo@gripple.com

Gripple Portugal

Estrada Nacional 4
Km 4,5 Pontal
2985-201 Pegões
Portugal

T | +351 265 898 870
F | +351 265 898 879
E | ptinfo@gripple.com

Gripple Australia / NZ

Polyplas Pty Ltd, 30 Sydney Rd
Bayswater, Victoria 3153
Australia

T | +61 (0)3 9720 0449
F | +61 (0)3 9720 0469
E | auinfo@gripple.com

© 2010 Gripple

Gripple is a registered trademark of Gripple Limited,
Company registered in England No. 1772901, VAT Reg No. GB 600 1951 88

BROC-IND-CAT-ENG