

GODFREY SYRETT



design/make/deliver

Desking

Product Range



Using This Price List/

Contents/

An Overview

This Price List has been designed to be as clear and easy to use as possible, whilst also providing a comprehensive set of information for all of our Desking products. Below is a brief overview on how to use the document, as well as where to find key information.

Page Layout

For ease of use, the page layout in this document is consistent throughout. Images always run from left to right across the page, whilst corresponding product information always runs from top to bottom down the page.

Document Navigation and Page Number

Product image & descriptor

Product information
(more detailed info below)

Product range name

Product range features, benefits and any relevant industry standards

Relevant Finish Options
(more detailed info below)

Product Information Tables

Product Descriptor	Product Code (/**/* specify your MFC & Paint Finishes)	Product Price
Double Wave Desk w1400 d900 h720	CBA/DW14/E/**/*	Fixed Leg £123 Adjustable Leg /HS £123

Product Dimensions (Most Desks are available in a range of sizes)

Finish Options

- MFC Options.** Where you see /** in a product code, you need to specify your MFC Finish from the Finishes page at the back of this document.
- Paint Finish Options.** Where you see /* in a product code, you need to specify your Paint Finish from the Finishes page at the back of this document.

	Align	32		Trios TRK	10
	Baseline A-Frame	12		Tubestation	46
	Cable Management	38		Universal Extensions	30
	Electrics	40		Finishes	28
	Response	18			
	Trapeze A-Frame	16			
	Trapeze Panel	14			
	Trios TR1	4			
	Trios TR2	6			
	Trios TR3	8			

This is an interactive document!

Just click or tap on the product image or name you'd like to see to go directly to that page in the document. To return back to this Contents page, just click or tap on the coloured bar on the outer corner of each page.

Trios/TR1

Trios/TR1



Rectangular Desk



Left-Handed Wave Desk



Right-Handed Wave Desk



Double Wave Desk



Rectangular Desk 600mm Depth

w800	d600	h720	TR1/86S/E/**/*
w1000	d600	h720	TR1/106S/E/**/*
w1200	d600	h720	TR1/126S/E/**/*
w1400	d600	h720	TR1/146S/E/**/*
w1600	d600	h720	TR1/166S/E/**/*
w1800	d600	h720	TR1/186S/E/**/*

Rectangular Desk 800mm Depth

w800	d800	h720	TR1/88S/**/*
w1000	d800	h720	TR1/108S/**/*
w1200	d800	h720	TR1/128S/**/*
w1400	d800	h720	TR1/148S/**/*
w1600	d800	h720	TR1/168S/**/*
w1800	d800	h720	TR1/188S/**/*

Left-Handed Wave Desk

w1200	d1 900	d2 800	h720	TR1/129LW/E/**/*
w1400	d1 900	d2 800	h720	TR1/149LW/E/**/*
w1600	d1 900	d2 800	h720	TR1/169LW/E/**/*
w1800	d1 900	d2 800	h720	TR1/189LW/E/**/*

Right-Handed Wave Desk

w1200	d1 800	d2 900	h720	TR1/129RW/E/**/*
w1400	d1 800	d2 900	h720	TR1/149RW/E/**/*
w1600	d1 800	d2 900	h720	TR1/169RW/E/**/*
w1800	d1 800	d2 900	h720	TR1/189RW/E/**/*

Double Wave Desk

w1600	d900	h720	TR1/169DW/E/**/*
w1800	d900	h720	TR1/189DW/E/**/*



Left-Handed Radial Desk



Right-Handed Radial Desk



Symmetrical Workstation Desk



120° Desk



Left-Handed Radial Desk

w1600	d1 1200	d2 800	h720	TR1/1612L/E/**/*
w1800	d1 1200	d2 800	h720	TR1/1812L/E/**/*

Right-Handed Radial Desk

w1600	d1 800	d2 1200	h720	TR1/1612R/E/**/*
w1800	d1 800	d2 1200	h720	TR1/1812R/E/**/*

Symmetrical Workstation Desk

w1400	d1 800	d2 1400	h720	TR1/SY14/□/E/**/*	(Specify Left or Right-Handed)
w1600	d1 800	d2 1600	h720	TR1/SY16/□/E/**/*	(Specify Left or Right-Handed)
w1800	d1 800	d2 1800	h720	TR1/SY18/□/E/**/*	(Specify Left or Right-Handed)

120° Desk

d1 1200	d2 1200	d3 800	h720	TR1/Y1208/E/**/*
---------	---------	--------	------	------------------

Please note: Symmetrical Workstation Desks require a Left- or Right-Handing to be specified in order to establish the correct grain direction, and/or Cable Port placement (see illustration right).

Please specify Left-Handed or Right-Handed for your Symmetrical Workstation Desk. Just replace the square symbol with **/L** (Left-Handed) or **/R** (Right-Handed).



- » Clean, classic leg style
- » Our best-selling Desk, with over 100,000 sold
- » Compatible with all Universal Desk Extensions
- » Metal-to-metal fixings

MFC & Frame Paint Options

- ** Please specify your MFC Finish from the Desking Finishes page
- * Please specify your Frame Paint Finish from the Desking Finishes page

- » Clean, classic leg style
- » Our best-selling Desk, with over 100,000 sold
- » Compatible with all Universal Desk Extensions
- » Metal-to-metal fixings

MFC & Frame Paint Options

- ** Please specify your MFC Finish from the Desking Finishes page
- * Please specify your Frame Paint Finish from the Desking Finishes page

Trios/TR2

Trios/TR2



Rectangular Desk



Left-Handed Wave Desk



Right-Handed Wave Desk



Double Wave Desk



Rectangular Desk 600mm Depth

w800	d600	h720	TR2/86S/E/**
w1000	d600	h720	TR2/106S/E/**
w1200	d600	h720	TR2/126S/E/**
w1400	d600	h720	TR2/146S/E/**
w1600	d600	h720	TR2/166S/E/**
w1800	d600	h720	TR2/186S/E/**

Rectangular Desk 800mm Depth

w800	d800	h720	TR2/88S/E/**
w1000	d800	h720	TR2/108S/E/**
w1200	d800	h720	TR2/128S/E/**
w1400	d800	h720	TR2/148S/E/**
w1600	d800	h720	TR2/168S/E/**
w1800	d800	h720	TR2/188S/E/**

Left-Handed Wave Desk

w1200	d1 900	d2 800	h720	TR2/129LW/E/**
w1400	d1 900	d2 800	h720	TR2/149LW/E/**
w1600	d1 900	d2 800	h720	TR2/169LW/E/**
w1800	d1 900	d2 800	h720	TR2/189LW/E/**

Right-Handed Wave Desk

w1200	d1 800	d2 900	h720	TR2/129RW/E/**
w1400	d1 800	d2 900	h720	TR2/149RW/E/**
w1600	d1 800	d2 900	h720	TR2/169RW/E/**
w1800	d1 800	d2 900	h720	TR2/189RW/E/**

Double Wave Desk

w1600	d900	h720	TR2/169DW/E/**
w1800	d900	h720	TR2/189DW/E/**

- » High quality Desk with 25mm top and panels
- » Wide range of wire management options
- » Compatible with all Universal Desk Extensions

MFC Options

** Please specify your MFC Finish from the Desking Finishes page



Left-Handed Radial Desk



Right-Handed Radial Desk



Symmetrical Workstation Desk



120° Desk

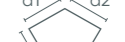

Left-Handed Radial Desk

w1600	d1 1200	d2 800	h720	TR2/1612L/E/**
w1800	d1 1200	d2 800	h720	TR2/1812L/E/**

Right-Handed Radial Desk

w1600	d1 800	d2 1200	h720	TR2/1612R/E/**
w1800	d1 800	d2 1200	h720	TR2/1812R/E/**

Symmetrical Workstation Desk

w1400	d1 800	d2 1400	h720	TR2/SY14/□/E/**	(Specify Left-Handed or Right-Handed)
w1600	d1 800	d2 1600	h720	TR2/SY16/□/E/**	(Specify Left-Handed or Right-Handed)
w1800	d1 800	d2 1800	h720	TR2/SY18/□/E/**	(Specify Left-Handed or Right-Handed)

120° Desk

d1 1200	d2 1200	d3 800	h720	TR2/Y1208/E/**
---------	---------	--------	------	----------------

Please note: Symmetrical Workstation Desks require a Left- or Right-Handing to be specified in order to establish the correct grain direction, and/or Cable Port placement (see illustration right).

 Please specify Left-Handed or Right-Handed for your Symmetrical Workstation Desk. Just replace the square symbol with **/L** (Left-Handed) or **/R** (Right-Handed).



- » High quality Desk with 25mm top and panels
- » Wide range of wire management options
- » Compatible with all Universal Desk Extensions

MFC Options

** Please specify your MFC Finish from the Desking Finishes page



Trios/TR3

Trios/TR3



Rectangular Desk



Left-Handed Wave Desk



Right-Handed Wave Desk



Double Wave Desk



Rectangular Desk 600mm Depth

w800	d600	h720	TR3/86S/E/**/*
w1000	d600	h720	TR3/106S/E/**/*
w1200	d600	h720	TR3/126S/E/**/*
w1400	d600	h720	TR3/146S/E/**/*
w1600	d600	h720	TR3/166S/E/**/*
w1800	d600	h720	TR3/186S/E/**/*

Rectangular Desk 800mm Depth

w800	d800	h720	TR3/88S/E/**/*
w1000	d800	h720	TR3/108S/E/**/*
w1200	d800	h720	TR3/128S/E/**/*
w1400	d800	h720	TR3/148S/E/**/*
w1600	d800	h720	TR3/168S/E/**/*
w1800	d800	h720	TR3/188S/E/**/*

Left-Handed Wave Desk

w1200	d1 900	d2 800	h720	TR3/129LW/E/**/*
w1400	d1 900	d2 800	h720	TR3/149LW/E/**/*
w1600	d1 900	d2 800	h720	TR3/169LW/E/**/*
w1800	d1 900	d2 800	h720	TR3/189LW/E/**/*

Right-Handed Wave Desk

w1200	d1 800	d2 900	h720	TR3/129RW/E/**/*
w1400	d1 800	d2 900	h720	TR3/149RW/E/**/*
w1600	d1 800	d2 900	h720	TR3/169RW/E/**/*
w1800	d1 800	d2 900	h720	TR3/189RW/E/**/*

Double Wave Desk

w1600	d900	h720	TR3/169DW/E/**/*
w1800	d900	h720	TR3/189DW/E/**/*



Left-Handed Radial Desk



Right-Handed Radial Desk



Symmetrical Workstation Desk



120° Desk

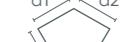

Left-Handed Radial Desk

w1600	d1 1200	d2 800	h720	TR3/1612L/E/**/*
w1800	d1 1200	d2 800	h720	TR3/1812L/E/**/*

Right-Handed Radial Desk

w1600	d1 800	d2 1200	h720	TR3/1612R/E/**/*
w1800	d1 800	d2 1200	h720	TR3/1812R/E/**/*

Symmetrical Workstation Desk

w1400	d1 800	d2 1400	h720	TR3/SY14/□/E/**/*	(Specify Left-Handed or Right-Handed)
w1600	d1 800	d2 1600	h720	TR3/SY16/□/E/**/*	(Specify Left-Handed or Right-Handed)
w1800	d1 800	d2 1800	h720	TR3/SY18/□/E/**/*	(Specify Left-Handed or Right-Handed)

120° Desk

d1 1200	d2 1200	d3 800	h720	TR3/Y1208/E/**/*
---------	---------	--------	------	------------------



Height Settable Adjustable Leg (**/HS**).
Offers 120mm of adjustability. For use with Trios TR3 Leg only. Prices stated above.

Please note: Symmetrical Workstation Desks require a Left- or Right-Handing to be specified in order to establish the correct grain direction, and/or Cable Port placement (see illustration right).

 Please specify Left-Handed or Right-Handed for your Symmetrical Workstation Desk. Just replace the square symbol with **/L** (Left-Handed) or **/R** (Right-Handed).



- » Classic 40mm diameter 'Goal Post' style leg
- » Height Settable leg option offers adjustability
- » Compatible with all Universal Desk Extensions
- » Metal-to-metal fixings



MFC & Frame Paint Options

- **** Please specify your MFC Finish from the Desking Finishes page
- *** Please specify your Frame Paint Finish from the Desking Finishes page



- » Classic 40mm diameter 'Goal Post' style leg
- » Height Settable leg option offers adjustability
- » Compatible with all Universal Desk Extensions
- » Metal-to-metal fixings



MFC & Frame Paint Options

- **** Please specify your MFC Finish from the Desking Finishes page
- *** Please specify your Frame Paint Finish from the Desking Finishes page

Trios/TRK



Rectangular Desk

Left-Handed Wave Desk

Right-Handed Wave Desk

Double Wave Desk



Rectangular Desk 600mm Depth

w800	d600	h720	TRK/86S/E/**/*
w1000	d600	h720	TRK/106S/E/**/*
w1200	d600	h720	TRK/126S/E/**/*
w1400	d600	h720	TRK/146S/E/**/*
w1600	d600	h720	TRK/166S/E/**/*
w1800	d600	h720	TRK/186S/E/**/*

Rectangular Desk 800mm Depth

w800	d800	h720	TRK/88S/**/*
w1000	d800	h720	TRK/108S/**/*
w1200	d800	h720	TRK/128S/**/*
w1400	d800	h720	TRK/148S/**/*
w1600	d800	h720	TRK/168S/**/*
w1800	d800	h720	TRK/188S/**/*

Left-Handed Wave Desk

w1200	d1 900	d2 800	h720	TRK/129LW/E/**/*
w1400	d1 900	d2 800	h720	TRK/149LW/E/**/*
w1600	d1 900	d2 800	h720	TRK/169LW/E/**/*
w1800	d1 900	d2 800	h720	TRK/189LW/E/**/*

Right-Handed Wave Desk

w1200	d1 800	d2 900	h720	TRK/129RW/E/**/*
w1400	d1 800	d2 900	h720	TRK/149RW/E/**/*
w1600	d1 800	d2 900	h720	TRK/169RW/E/**/*
w1800	d1 800	d2 900	h720	TRK/189RW/E/**/*

Double Wave Desk

w1600	d900	h720	TRK/169DW/E/**/*
w1800	d900	h720	TRK/189DW/E/**/*

Trios/TRK



Left-Handed Radial Desk

Right-Handed Radial Desk

Symmetrical Workstation Desk

120° Desk



Left-Handed Radial Desk

w1600	d1 1200	d2 800	h720	TRK/1612L/E/**/*
w1800	d1 1200	d2 800	h720	TRK/1812L/E/**/*

Right-Handed Radial Desk

w1600	d1 800	d2 1200	h720	TRK/1612R/E/**/*
w1800	d1 800	d2 1200	h720	TRK/1812R/E/**/*

Symmetrical Workstation Desk

w1400	d1 800	d2 1400	h720	TRK/SY14/□/E/**/*	(Specify Left-Handed or Right-Handed)
w1600	d1 800	d2 1600	h720	TRK/SY16/□/E/**/*	(Specify Left-Handed or Right-Handed)
w1800	d1 800	d2 1800	h720	TRK/SY18/□/E/**/*	(Specify Left-Handed or Right-Handed)

120° Desk

d1 1200	d2 1200	d3 800	h720	TRK/Y1208/E/**/*
---------	---------	--------	------	------------------

Please note: Symmetrical Workstation Desks require a Left- or Right-Handing to be specified in order to establish the correct grain direction, and/or Cable Port placement (see illustration right).

 Please specify Left-Handed or Right-Handed for your Symmetrical Workstation Desk. Just replace the square symbol with **/L** (Left-Handed) or **/R** (Right-Handed).





- » Step-up Cantilever option
- » Folded Steel Leg panel can conceal optional cable riser
- » Compatible with all Universal Desk Extensions
- » Metal-to-metal fixings

  **MFC & Frame Paint Options**

****** Please specify your MFC Finish from the Desking Finishes page

***** Please specify your Frame Paint Finish from the Desking Finishes page

- » Step-up Cantilever option
- » Folded Steel Leg panel can conceal optional cable riser
- » Compatible with all Universal Desk Extensions
- » Metal-to-metal fixings

  **MFC & Frame Paint Options**

****** Please specify your MFC Finish from the Desking Finishes page

***** Please specify your Frame Paint Finish from the Desking Finishes page

Baseline/A-Frame



Rectangular Desk



Left-Handed Wave Desk



Right-Handed Wave Desk



Double Wave Desk



Rectangular Desk

w800	d800	h720	CBA/R808/E/**/*
w1000	d800	h720	CBA/R810/E/**/*
w1200	d800	h720	CBA/R812/E/**/*
w1400	d800	h720	CBA/R814/E/**/*
w1600	d800	h720	CBA/R816/E/**/*
w1800	d800	h720	CBA/R818/E/**/*

Left-Handed Wave Desk

w1200	d1 900	d2 800	h720	CBA/WL12/E/**/*
w1400	d1 900	d2 800	h720	CBA/WL14/E/**/*
w1600	d1 900	d2 800	h720	CBA/WL16/E/**/*
w1800	d1 900	d2 800	h720	CBA/WL18/E/**/*

Right-Handed Wave Desk

w1200	d1 800	d2 900	h720	CBA/WR12/E/**/*
w1400	d1 800	d2 900	h720	CBA/WR14/E/**/*
w1600	d1 800	d2 900	h720	CBA/WR16/E/**/*
w1800	d1 800	d2 900	h720	CBA/WR18/E/**/*

Double Wave Desk

w1400	d900	h720	CBA/DW14/E/**/*
w1600	d900	h720	CBA/DW16/E/**/*
w1800	d900	h720	CBA/DW18/E/**/*

Baseline/A-Frame



Left-Handed Radial Desk



Right-Handed Radial Desk



Symmetrical Workstation Desk



120° Desk



Left-Handed Radial Desk

w1400	d1 1200	d2 800	h720	CBA/RL14/E/**/*
w1600	d1 1200	d2 800	h720	CBA/RL16/E/**/*
w1800	d1 1200	d2 800	h720	CBA/RL18/E/**/*

Right-Handed Radial Desk

w1400	d1 800	d2 1200	h720	CBA/RR14/E/**/*
w1600	d1 800	d2 1200	h720	CBA/RR16/E/**/*
w1800	d1 800	d2 1200	h720	CBA/RR18/E/**/*

Symmetrical Workstation Desk

w1400	d1 800	d2 1400	h720	CBA/SY14/□/E/**/*	(Specify Left-Handed or Right-Handed)
w1600	d1 800	d2 1600	h720	CBA/SY16/□/E/**/*	(Specify Left-Handed or Right-Handed)
w1800	d1 800	d2 1800	h720	CBA/SY18/□/E/**/*	(Specify Left-Handed or Right-Handed)

120° Desk

d1 1200	d2 1200	d3 800	h720	CBA/Y1208/E/**/*
---------	---------	--------	------	------------------



Height Settable Adjustable Leg (/HS). Offers 120mm of adjustability. For use with A-Frame Leg only. Prices stated above.

Please note: Symmetrical Workstation Desks require a Left- or Right-Handing to be specified in order to establish the correct grain direction, and/or Cable Port placement (see illustration right).

Please specify Left-Handed or Right-Handed for your Symmetrical Workstation Desk. Just replace the square symbol with /L (Left-Handed) or /R (Right-Handed).



- » Offers exceptional value for money
- » Clean and contemporary A-Frame leg styling
- » Compatible with all Universal Desk Extensions
- » Height Settable leg option offers adjustability
- » Metal-to-metal fixings

MFC & Frame Paint Options

- ** Please specify your MFC Finish from the Desking Finishes page
- * Please specify your Frame Paint Finish from the Desking Finishes page

- » Offers exceptional value for money
- » Clean and contemporary A-Frame leg styling
- » Compatible with all Universal Desk Extensions
- » Height Settable leg option offers adjustability
- » Metal-to-metal fixings

MFC & Frame Paint Options

- ** Please specify your MFC Finish from the Desking Finishes page
- * Please specify your Frame Paint Finish from the Desking Finishes page

Trapeze/Panel



Rectangular Desk

Left-Handed Wave Desk

Right-Handed Wave Desk

Double Wave Desk



Rectangular Desk 600mm Depth

w800	d600	h720	CLP/R608/E/**
w1000	d600	h720	CLP/R610/E/**
w1200	d600	h720	CLP/R612/E/**
w1400	d600	h720	CLP/R614/E/**
w1600	d600	h720	CLP/R616/E/**
w1800	d600	h720	CLP/R618/E/**

Rectangular Desk 800mm Depth

w800	d800	h720	CLP/R808/E/**
w1000	d800	h720	CLP/R810/E/**
w1200	d800	h720	CLP/R812/E/**
w1400	d800	h720	CLP/R814/E/**
w1600	d800	h720	CLP/R816/E/**
w1800	d800	h720	CLP/R818/E/**

Left-Handed Wave Desk

w1200	d1 900	d2 800	h720	CLP/WL12/E/**
w1400	d1 900	d2 800	h720	CLP/WL14/E/**
w1600	d1 900	d2 800	h720	CLP/WL16/E/**
w1800	d1 900	d2 800	h720	CLP/WL18/E/**

Right-Handed Wave Desk

w1200	d1 800	d2 900	h720	CLP/WR12/E/**
w1400	d1 800	d2 900	h720	CLP/WR14/E/**
w1600	d1 800	d2 900	h720	CLP/WR16/E/**
w1800	d1 800	d2 900	h720	CLP/WR18/E/**

Double Wave Desk

w1400	d900	h720	CLP/DW14/E/**
w1600	d900	h720	CLP/DW16/E/**
w1800	d900	h720	CLP/DW18/E/**

- » Step-up panel end desk range
- » Unique wire management 'thru-pass'
- » Compatible with all Universal Desk Extensions

MFC Options

** Please specify your MFC Finish from the Desking Finishes page

Trapeze/Panel



Left-Handed Radial Desk

Right-Handed Radial Desk

Symmetrical Workstation Desk

120° Desk

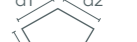

Left-Handed Radial Desk

w1400	d1 1200	d2 800	h720	CLP/RL14/E/**
w1600	d1 1200	d2 800	h720	CLP/RL16/E/**
w1800	d1 1200	d2 800	h720	CLP/RL18/E/**

Right-Handed Radial Desk

w1400	d1 800	d2 1200	h720	CLP/RR14/E/**
w1600	d1 800	d2 1200	h720	CLP/RR16/E/**
w1800	d1 800	d2 1200	h720	CLP/RR18/E/**

Symmetrical Workstation Desk

w1400	d1 800	d2 1400	h720	CLP/SY14/□/E/**	(Specify Left-Handed or Right-Handed)
w1600	d1 800	d2 1600	h720	CLP/SY16/□/E/**	(Specify Left-Handed or Right-Handed)
w1800	d1 800	d2 1800	h720	CLP/SY18/□/E/**	(Specify Left-Handed or Right-Handed)

120° Desk

d1 1200	d2 1200	d3 800	h720	CLP/Y1208/E/**
---------	---------	--------	------	----------------

Please note: Symmetrical Workstation Desks require a Left- or Right-Handing to be specified in order to establish the correct grain direction, and/or Cable Port placement (see illustration right).

 Please specify Left-Handed or Right-Handed for your Symmetrical Workstation Desk. Just replace the square symbol with **/L** (Left-Handed) or **/R** (Right-Handed).



- » Step-up panel end desk range
- » Unique wire management 'thru-pass'
- » Compatible with all Universal Desk Extensions

MFC Options

** Please specify your MFC Finish from the Desking Finishes page

Trapeze/A-Frame

Trapeze/A-Frame



Rectangular Desk



Left-Handed Wave Desk



Right-Handed Wave Desk



Double Wave Desk



Rectangular Desk 600mm Depth

w800	d600	h720	CLA/R608/E/**/*
w1000	d600	h720	CLA/R610/E/**/*
w1200	d600	h720	CLA/R612/E/**/*
w1400	d600	h720	CLA/R614/E/**/*
w1600	d600	h720	CLA/R616/E/**/*
w1800	d600	h720	CLA/R618/E/**/*

Rectangular Desk 800mm Depth

w800	d800	h720	CLA/R808/E/**/*
w1000	d800	h720	CLA/R810/E/**/*
w1200	d800	h720	CLA/R812/E/**/*
w1400	d800	h720	CLA/R814/E/**/*
w1600	d800	h720	CLA/R816/E/**/*
w1800	d800	h720	CLA/R818/E/**/*

Left-Handed Wave Desk

w1200	d1 900	d2 800	h720	CLA/WL12/E/**/*
w1400	d1 900	d2 800	h720	CLA/WL14/E/**/*
w1600	d1 900	d2 800	h720	CLA/WL16/E/**/*
w1800	d1 900	d2 800	h720	CLA/WL18/E/**/*

Right-Handed Wave Desk

w1200	d1 800	d2 900	h720	CLA/WR12/E/**/*
w1400	d1 800	d2 900	h720	CLA/WR14/E/**/*
w1600	d1 800	d2 900	h720	CLA/WR16/E/**/*
w1800	d1 800	d2 900	h720	CLA/WR18/E/**/*

Double Wave Desk

w1400	d900	h720	CLA/DW14/E/**/*
w1600	d900	h720	CLA/DW16/E/**/*
w1800	d900	h720	CLA/DW18/E/**/*



Left-Handed Radial Desk



Right-Handed Radial Desk



Symmetrical Workstation Desk



Left-Handed Radial Desk

w1400	d1 1200	d2 800	h720	CLA/RL14/E/**/*
w1600	d1 1200	d2 800	h720	CLA/RL16/E/**/*
w1800	d1 1200	d2 800	h720	CLA/RL18/E/**/*

Right-Handed Radial Desk

w1400	d1 800	d2 1200	h720	CLA/RR14/E/**/*
w1600	d1 800	d2 1200	h720	CLA/RR16/E/**/*
w1800	d1 800	d2 1200	h720	CLA/RR18/E/**/*

Symmetrical Workstation Desk

w1400	d1 800	d2 1400	h720	CLA/SY14/□/E/**/*	(Specify Left-Handed or Right-Handed)
w1600	d1 800	d2 1600	h720	CLA/SY16/□/E/**/*	(Specify Left-Handed or Right-Handed)
w1800	d1 800	d2 1800	h720	CLA/SY18/□/E/**/*	(Specify Left-Handed or Right-Handed)



Height Settable Adjustable Leg (/HS). Offers 120mm of adjustability. For use with A-Frame Leg only. Prices stated above.

Please note: Symmetrical Workstation Desks require a Left- or Right-Handing to be specified in order to establish the correct grain direction, and/or Cable Port placement (see illustration right).

Please specify Left-Handed or Right-Handed for your Symmetrical Workstation Desk. Just replace the square symbol with /L (Left-Handed) or /R (Right-Handed).



- » Open, clean aesthetic design
- » Compatible with all Universal Desk Extensions
- » Height Settable leg option offers adjustability

MFC & Frame Paint Options

- **** Please specify your MFC Finish from the Desking Finishes page
- *** Please specify your Frame Paint Finish from the Desking Finishes page

- » Open, clean aesthetic design
- » Compatible with all Universal Desk Extensions
- » Height Settable leg option offers adjustability

MFC & Frame Paint Options

- **** Please specify your MFC Finish from the Desking Finishes page
- *** Please specify your Frame Paint Finish from the Desking Finishes page

Response/Fixed Height



Rectangular Starter Desk



Rectangular Extender Desk

Left-Handed Wave
Starter DeskLeft-Handed Wave
Extender Desk

Rectangular Starter Desk 600mm Depth

w800	d600	h720	RSB/R608ST/E/**
w1000	d600	h720	RSB/R610ST/E/**
w1200	d600	h720	RSB/R612ST/E/**
w1400	d600	h720	RSB/R614ST/E/**
w1600	d600	h720	RSB/R616ST/E/**
w1800	d600	h720	RSB/R618ST/E/**

Rectangular Extender Desk 600mm Depth

w800	d600	h720	RSB/R608EX/E/**
w1000	d600	h720	RSB/R610EX/E/**
w1200	d600	h720	RSB/R612EX/E/**
w1400	d600	h720	RSB/R614EX/E/**
w1600	d600	h720	RSB/R616EX/E/**
w1800	d600	h720	RSB/R618EX/E/**

Left-Handed Wave Starter Desk

w1200	d1 900	d2 800	h720	RSB/WL12ST/E/**
w1400	d1 900	d2 800	h720	RSB/WL14ST/E/**
w1600	d1 900	d2 800	h720	RSB/WL16ST/E/**
w1800	d1 900	d2 800	h720	RSB/WL18ST/E/**

Left-Handed Wave Extender Desk

w1200	d1 900	d2 800	h720	RSB/WL12EX/E/**
w1400	d1 900	d2 800	h720	RSB/WL14EX/E/**
w1600	d1 900	d2 800	h720	RSB/WL16EX/E/**
w1800	d1 900	d2 800	h720	RSB/WL18EX/E/**

Rectangular Starter Desk 800mm Depth

w800	d800	h720	RSB/R808ST/E/**
w1000	d800	h720	RSB/R810ST/E/**
w1200	d800	h720	RSB/R812ST/E/**
w1400	d800	h720	RSB/R814ST/E/**
w1600	d800	h720	RSB/R816ST/E/**
w1800	d800	h720	RSB/R818ST/E/**

Rectangular Extender Desk 800mm Depth

w800	d800	h720	RSB/R808EX/E/**
w1000	d800	h720	RSB/R810EX/E/**
w1200	d800	h720	RSB/R812EX/E/**
w1400	d800	h720	RSB/R814EX/E/**
w1600	d800	h720	RSB/R816EX/E/**
w1800	d800	h720	RSB/R818EX/E/**

Response/Fixed Height

Right-Handed Wave
Starter DeskRight-Handed Wave
Extender Desk

Double Wave Starter Desk



Double Wave Extender Desk



Right-Handed Wave Starter Desk

w1200	d1 800	d2 900	h720	RSB/WR12ST/E/**
w1400	d1 800	d2 900	h720	RSB/WR14ST/E/**
w1600	d1 800	d2 900	h720	RSB/WR16ST/E/**
w1800	d1 800	d2 900	h720	RSB/WR18ST/E/**

Right-Handed Wave Extender Desk

w1200	d1 800	d2 900	h720	RSB/WR12EX/E/**
w1400	d1 800	d2 900	h720	RSB/WR14EX/E/**
w1600	d1 800	d2 900	h720	RSB/WR16EX/E/**
w1800	d1 800	d2 900	h720	RSB/WR18EX/E/**

Double Wave Starter Desk

w1400	d900	h720	RSB/DW14ST/E/**
w1600	d900	h720	RSB/DW16ST/E/**
w1800	d900	h720	RSB/DW18ST/E/**

Double Wave Extender Desk

w1400	d900	h720	RSB/DW14EX/E/**
w1600	d900	h720	RSB/DW16EX/E/**
w1800	d900	h720	RSB/DW18EX/E/**



- » Easy fitting of extension tables
- » Stylish leg aesthetic across all leg variations
- » Shared leg system creates extra legroom
- » Beam based system creates integral cable management

MFC Options

** Please specify your MFC Finish from the Desking Finishes page

All Response Desks have a Smooth Aluminium leg and frame paint finish.



- » Easy fitting of extension tables
- » Stylish leg aesthetic across all leg variations
- » Shared leg system creates extra legroom
- » Beam based system creates integral cable management

MFC Options

** Please specify your MFC Finish from the Desking Finishes page

All Response Desks have a Smooth Aluminium leg and frame paint finish.

Response/Fixed Height



Left-Handed Radial Desk



Right-Handed Radial Desk

Bow Fronted Left-Hand
Radial DeskBow Fronted Right-Hand
Radial Desk

Left-Handed Radial Desk

w1400	d1 1200	d2 800	h720	RSB/RL14/E/**
w1600	d1 1200	d2 800	h720	RSB/RL16/E/**
w1800	d1 1200	d2 800	h720	RSB/RL18/E/**

Right-Handed Radial Desk

w1400	d1 800	d2 100	h720	RSB/RR14/E/**
w1600	d1 800	d2 1200	h720	RSB/RR16/E/**
w1800	d1 800	d2 1200	h720	RSB/RR18/E/**

Bow Fronted Left-Hand Radial Desk

w1400	d1 1300	d2 800	h720	RSB/BRL14/E/**
w1600	d1 1300	d2 800	h720	RSB/BRL16/E/**
w1800	d1 1300	d2 800	h720	RSB/BRL18/E/**

Bow Fronted Right-Hand Radial Desk

w1400	d1 800	d2 1300	h720	RSB/BRR14/E/**
w1600	d1 800	d2 1300	h720	RSB/BRR16/E/**
w1800	d1 800	d2 1300	h720	RSB/BRR18/E/**

- » Easy fitting of extension tables
- » Stylish leg aesthetic across all leg variations
- » Shared leg system creates extra legroom
- » Beam based system creates integral cable management

MFC Options

** Please specify your MFC Finish from the Desking Finishes page
All Response Desks have a Smooth Aluminium leg and frame paint finish.

Response/Fixed Height



Bow Fronted Desk



Symmetrical Workstation Desk



120° Desk



Bow Fronted Desk

w1400	d900	h720	RSB/BF14/E/**
w1600	d900	h720	RSB/BF16/E/**
w1800	d900	h720	RSB/BF18/E/**

Symmetrical Workstation Desk

w1400	d1 800	d2 1400	h720	RSB/SY14/□/E/**	(Specify Left or Right-Handed)
w1600	d1 800	d2 1600	h720	RSB/SY16/□/E/**	(Specify Left or Right-Handed)
w1800	d1 800	d2 1800	h720	RSB/SY18/□/E/**	(Specify Left or Right-Handed)

120° Desk

d1 1200	d2 1200	d3 800	h720	RSB/Y128/E/**
---------	---------	--------	------	---------------

Please note: Symmetrical Workstation Desks require a Left- or Right-Handing to be specified in order to establish the correct grain direction, and/or Cable Port placement (see illustration right).



Please specify Left-Handed or Right-Handed for your Symmetrical Workstation Desk. Just replace the square symbol with **/L** (Left-Handed) or **/R** (Right-Handed).



Left-Handed (**/L**)



Right-Handed (**/R**)

- » Easy fitting of extension tables
- » Stylish leg aesthetic across all leg variations
- » Shared leg system creates extra legroom
- » Beam based system creates integral cable management

MFC Options

** Please specify your MFC Finish from the Desking Finishes page
All Response Desks have a Smooth Aluminium leg and frame paint finish.

Response/Fixed Height with Modesty Panel

22



Rectangular Desk



Left-Handed Wave Desk



Right-Handed Wave Desk



Double Wave Desk



Rectangular Desk

w800	d800	h720	RSM/R808/E/**
w1000	d800	h720	RSM/R810/E/**
w1200	d800	h720	RSM/R812/E/**
w1400	d800	h720	RSM/R814/E/**
w1600	d800	h720	RSM/R816/E/**
w1800	d800	h720	RSM/R818/E/**

Left-Handed Wave Desk

w1200	d1 900	d2 800	h720	RSM/WL12/E/**
w1400	d1 900	d2 800	h720	RSM/WL14/E/**
w1600	d1 900	d2 800	h720	RSM/WL16/E/**
w1800	d1 900	d2 800	h720	RSM/WL18/E/**

Right-Handed Wave Desk

w1200	d1 800	d2 900	h720	RSM/WR12/E/**
w1400	d1 800	d2 900	h720	RSM/WR14/E/**
w1600	d1 800	d2 900	h720	RSM/WR16/E/**
w1800	d1 800	d2 900	h720	RSM/WR18/E/**

Double Wave Desk

w1400	d900	h720	RSM/DW14/E/**
w1600	d900	h720	RSM/DW16/E/**
w1800	d900	h720	RSM/DW18/E/**

Response/Fixed Height with Modesty Panel

23



Bow Fronted Desk



Bow Fronted Desk

w1400	d900	h720	RSM/BF14/E/**
w1600	d900	h720	RSM/BF16/E/**
w1800	d900	h720	RSM/BF18/E/**



- » Easy fitting of extension tables
- » Stylish leg aesthetic across all leg variations
- » Shared leg system creates extra legroom
- » Beam based system creates integral cable management

MFC Options

** Please specify your MFC Finish from the Desking Finishes page

All Response Desks have a Smooth Aluminium leg and frame paint finish.



- » Easy fitting of extension tables
- » Stylish leg aesthetic across all leg variations
- » Shared leg system creates extra legroom
- » Beam based system creates integral cable management

MFC Options

** Please specify your MFC Finish from the Desking Finishes page

All Response Desks have a Smooth Aluminium leg and frame paint finish.

Response/Crank Height Adjustable



Rectangular Desk



Left-Handed Wave Desk



Right-Handed Wave Desk



Double Wave Desk



Rectangular Desk 600mm Depth

w800	d600	h690-1000	RSC/R608/E/**
w1000	d600	h690-1000	RSC/R610/E/**
w1200	d600	h690-1000	RSC/R612/E/**
w1400	d600	h690-1000	RSC/R614/E/**
w1600	d600	h690-1000	RSC/R616/E/**
w1800	d600	h690-1000	RSC/R618/E/**

Rectangular Desk 800mm Depth

w800	d800	h690-1000	RSC/R808/E/**
w1000	d800	h690-1000	RSC/R810/E/**
w1200	d800	h690-1000	RSC/R812/E/**
w1400	d800	h690-1000	RSC/R814/E/**
w1600	d800	h690-1000	RSC/R816/E/**
w1800	d800	h690-1000	RSC/R818/E/**

Left-Handed Wave Desk

w1200	d1 900	d2 800	h690-1000	RSC/WL12/E/**
w1400	d1 900	d2 800	h690-1000	RSC/WL14/E/**
w1600	d1 900	d2 800	h690-1000	RSC/WL16/E/**
w1800	d1 900	d2 800	h690-1000	RSC/WL18/E/**

Right-Handed Wave Desk

w1200	d1 800	d2 900	h690-1000	RSC/WR12/E/**
w1400	d1 800	d2 900	h690-1000	RSC/WR14/E/**
w1600	d1 800	d2 900	h690-1000	RSC/WR16/E/**
w1800	d1 800	d2 900	h690-1000	RSC/WR18/E/**

Double Wave Desk

w1400	d900	h690-1000	RSC/DW14/E/**
w1600	d900	h690-1000	RSC/DW16/E/**
w1800	d900	h690-1000	RSC/DW18/E/**

- » Easy fitting of extension tables
- » Stylish leg aesthetic across all leg variations
- » Shared leg system creates extra legroom
- » Beam based system creates integral cable management

MFC Options

** Please specify your MFC Finish from the Desking Finishes page
All Response Desks have a Smooth Aluminium leg and frame paint finish.

Response/Crank Height Adjustable



Left-Handed Radial Desk



Right-Handed Radial Desk



Symmetrical Workstation Desk



120° Desk

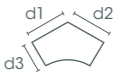

Left-Handed Radial Desk

w1400	d1 1200	d2 800	h690-1000	RSC/RL14/E/**
w1600	d1 1200	d2 800	h690-1000	RSC/RL16/E/**
w1800	d1 1200	d2 800	h690-1000	RSC/RL18/E/**

Right-Handed Radial Desk

w1400	d1 800	d2 1200	h690-1000	RSC/RR14/E/**
w1600	d1 800	d2 1200	h690-1000	RSC/RR16/E/**
w1800	d1 800	d2 1200	h690-1000	RSC/RR18/E/**

Symmetrical Workstation Desk

w1400	d1 800	d2 1400	h690-1000	RSC/SY14/□/E/**	(Specify Left or Right-Handed)
w1600	d1 800	d2 1600	h690-1000	RSC/SY16/□/E/**	(Specify Left or Right-Handed)
w1800	d1 800	d2 1800	h690-1000	RSC/SY18/□/E/**	(Specify Left or Right-Handed)

120° Desk

d1 1200	d2 1200	d3 800	h690-1000	RSC/Y128/E/**
---------	---------	--------	-----------	---------------

Please note: Symmetrical Workstation Desks require a Left- or Right-Handing to be specified in order to establish the correct grain direction, and/or Cable Port placement (see illustration right).

 Please specify Left-Handed or Right-Handed for your Symmetrical Workstation Desk. Just replace the square symbol with **/L** (Left-Handed) or **/R** (Right-Handed).



- » Easy fitting of extension tables
- » Stylish leg aesthetic across all leg variations
- » Shared leg system creates extra legroom
- » Beam based system creates integral cable management

MFC Options

** Please specify your MFC Finish from the Desking Finishes page
All Response Desks have a Smooth Aluminium leg and frame paint finish.

Response/Electric Height Adjustable

26



Rectangular Desk



Left-Handed Wave Desk



Right-Handed Wave Desk



Double Wave Desk



Rectangular Desk 600mm Depth

w800	d600	h690-1000	RSE/R608/E/**
w1000	d600	h690-1000	RSE/R610/E/**
w1200	d600	h690-1000	RSE/R612/E/**
w1400	d600	h690-1000	RSE/R614/E/**
w1600	d600	h690-1000	RSE/R616/E/**
w1800	d600	h690-1000	RSE/R618/E/**

Rectangular Desk 800mm Depth

w800	d800	h690-1000	RSE/R808/E/**
w1000	d800	h690-1000	RSE/R810/E/**
w1200	d800	h690-1000	RSE/R812/E/**
w1400	d800	h690-1000	RSE/R814/E/**
w1600	d800	h690-1000	RSE/R816/E/**
w1800	d800	h690-1000	RSE/R818/E/**

Left-Handed Wave Desk

w1200	d1 900	d2 800	h690-1000	RSE/WL12/E/**
w1400	d1 900	d2 800	h690-1000	RSE/WL14/E/**
w1600	d1 900	d2 800	h690-1000	RSE/WL16/E/**
w1800	d1 900	d2 800	h690-1000	RSE/WL18/E/**

Right-Handed Wave Desk

w1200	d1 800	d2 900	h690-1000	RSE/WR12/E/**
w1400	d1 800	d2 900	h690-1000	RSE/WR14/E/**
w1600	d1 800	d2 900	h690-1000	RSE/WR16/E/**
w1800	d1 800	d2 900	h690-1000	RSE/WR18/E/**

Double Wave Desk

w1400	d900	h690-1000	RSE/DW14/E/**
w1600	d900	h690-1000	RSE/DW16/E/**
w1800	d900	h690-1000	RSE/DW18/E/**

- » Easy fitting of extension tables
- » Stylish leg aesthetic across all leg variations
- » Shared leg system creates extra legroom
- » Beam based system creates integral cable management

MFC Options

** Please specify your MFC Finish from the Desking Finishes page
All Response Desks have a Smooth Aluminium leg and frame paint finish.

Response/Electric Height Adjustable

27



Left-Handed Radial Desk



Right-Handed Radial Desk



Symmetrical Workstation Desk



120° Desk

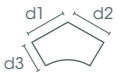

Left-Handed Radial Desk

w1400	d1 1200	d2 800	h690-1000	RSE/RL14/E/**
w1600	d1 1200	d2 800	h690-1000	RSE/RL16/E/**
w1800	d1 1200	d2 800	h690-1000	RSE/RL18/E/**

Right-Handed Radial Desk

w1400	d1 800	d2 1200	h690-1000	RSE/RR14/E/**
w1600	d1 800	d2 1200	h690-1000	RSE/RR16/E/**
w1800	d1 800	d2 1200	h690-1000	RSE/RR18/E/**

Symmetrical Workstation Desk

w1400	d1 800	d2 1400	h690-1000	RSE/SY14/□/E/**	(Specify Left or Right-Handed)
w1600	d1 800	d2 1600	h690-1000	RSE/SY16/□/E/**	(Specify Left or Right-Handed)
w1800	d1 800	d2 1800	h690-1000	RSE/SY18/□/E/**	(Specify Left or Right-Handed)

120° Desk

d1 1200	d2 1200	d3 800	h690-1000	RSE/Y128/E/**
---------	---------	--------	-----------	---------------

Please note: Symmetrical Workstation Desks require a Left- or Right-Handing to be specified in order to establish the correct grain direction, and/or Cable Port placement (see illustration right).



Please specify Left-Handed or Right-Handed for your Symmetrical Workstation Desk. Just replace the square symbol with **/L** (Left-Handed) or **/R** (Right-Handed).



Left-Handed (**/L**)



Right-Handed (**/R**)

- » Easy fitting of extension tables
- » Stylish leg aesthetic across all leg variations
- » Shared leg system creates extra legroom
- » Beam based system creates integral cable management

MFC Options

** Please specify your MFC Finish from the Desking Finishes page
All Response Desks have a Smooth Aluminium leg and frame paint finish.



Response/Linking

28

Accessories



Linking Top Triangular 3-Way

RSB/LK/3WAY/06/E/** (For use with 600mm Deep Desks)

RSB/LK/3WAY/08/E/** (For use with 800mm Deep Desks)

25mm MFC Linking Top. Only for use with fixed height Response Desks.



Linking Top Square 4-Way

RSB/LK/4WAY/06/E/** (For use with 600mm Deep Desks)

RSB/LK/4WAY/08/E/** (For use with 800mm Deep Desks)

25mm MFC Linking Top. Only for use with fixed height Response Desks.



Linking Top 30° Curved

RSB/LK/30DEG/06/E/** (For use with 600mm Deep Desks)

RSB/LK/30DEG/08/E/** (For use with 800mm Deep Desks)

25mm MFC Linking Top. Only for use with fixed height Response Desks.



Linking Top 45° Curved

RSB/LK/45DEG/06/E/** (For use with 600mm Deep Desks)

RSB/LK/45DEG/08/E/** (For use with 800mm Deep Desks)

25mm MFC Linking Top. Only for use with fixed height Response Desks.



Linking Top 60° Curved

RSB/LK/60DEG/06/E/** (For use with 600mm Deep Desks)

RSB/LK/60DEG/08/E/** (For use with 800mm Deep Desks)

25mm MFC Linking Top. Only for use with fixed height Response Desks.

Response/Linking

29

Accessories



Floating MFC Modesty Panel

RSB/WMP/08/E/** (For use with 800mm Length Desks)

RSB/WMP/10/E/** (For use with 1000mm Length Desks)

RSB/WMP/12/E/** (For use with 1200mm Length Desks)

RSB/WMP/14/E/** (For use with 1400mm Length Desks)

RSB/WMP/16/E/** (For use with 1600mm Length Desks)

RSB/WMP/18/E/** (For use with 1800mm Length Desks)



Steel Modesty Panel

RSB/SMP/08 (For use with 800mm Length Desks)

RSB/SMP/10 (For use with 1000mm Length Desks)

RSB/SMP/12 (For use with 1200mm Length Desks)

RSB/SMP/14 (For use with 1400mm Length Desks)

RSB/SMP/16 (For use with 1600mm Length Desks)

RSB/SMP/18 (For use with 1800mm Length Desks)



Replacement Crank Handle

RC/HANDLE

£25

For use with Crank Height Adjustable Desks only.



- » Easy fitting of extension tables
- » Stylish leg aesthetic across all leg variations
- » Shared leg system creates extra legroom
- » Beam based system creates integral cable management

MFC Options

** Please specify your MFC Finish from the Desking Finishes page



- » Easy fitting of extension tables
- » Stylish leg aesthetic across all leg variations
- » Shared leg system creates extra legroom
- » Beam based system creates integral cable management

MFC Options

** Please specify your MFC Finish from the Desking Finishes page

Universal Extensions/



Semi-Circular Extension Table



Bow Shaped Extension Table



Meeting Extension Table



Semi-Circular Extension Table

w1200	d600	h720	XU/SEM1200/E/**/*	(For use with 600mm Depth Desks back to back)
w1210	d605	h720	XU/SEM1210/E/**/*	(For use with 600mm Depth Desks back to back, with a central Screen)
w1600	d800	h720	XU/SEM1600/E/**/*	(For use with 800mm Depth Desks back to back)
w1610	d805	h720	XU/SEM1610/E/**/*	(For use with 800mm Depth Desks back to back, with a central Screen)
w1800	d900	h720	XU/SEM1800/E/**/*	(For use with 900mm Depth Desks back to back)
w1810	d905	h720	XU/SEM1810/E/**/*	(For use with 900mm Depth Desks back to back, with a central Screen)

Bow Shaped Extension Table

w1200	d600	h720	XU/BOW1200/E/**/*	(For use with 600mm Depth Desks back to back)
w1210	d600	h720	XU/BOW1210/E/**/*	(For use with 600mm Depth Desks back to back, with a central Screen)
w1600	d600	h720	XU/BOW1600/E/**/*	(For use with 800mm Depth Desks back to back)
w1610	d600	h720	XU/BOW1610/E/**/*	(For use with 800mm Depth Desks back to back, with a central Screen)
w1800	d600	h720	XU/BOW1800/E/**/*	(For use with 900mm Depth Desks back to back)
w1810	d600	h720	XU/BOW1810/E/**/*	(For use with 900mm Depth Desks back to back, with a central Screen)

Meeting Extension Table

w1 800	w2 1100	d927	h720	XU/DIA08/1100/E/**/*	(For use with 800mm Depth Desks)
--------	---------	------	------	----------------------	----------------------------------



Part of a product family

Universal Desk Extensions are designed to integrate with all **Trios TR1, TR2, TR3, and TRK Desks**, all **Response Fixed Height Desks**, all **Baseline Desks**, and all **Trapeze Desks**.



Please note: Universal Desk Extensions are not suitable for use with height adjustable Desks.

Universal Extensions/



Manager Extension Table



Bullet Extension Table



Universal Fixed Pedestals

Manager Extension Table

w1100	d1100	h720	XU/MGR08/1100/E/**/*	(For use with 800mm Depth Desks. Can be fitted Left- or Right-Handed)
-------	-------	------	----------------------	---

Bullet Extension Table

w600	d800	h720	XU/BLT06/E/**/*
w800	d800	h720	XU/BLT08/E/**/*
w900	d800	h720	XU/BLT09/E/**/*

Universal Fixed Pedestals

w400	d573	h450	UFP/1P1F	(1 Personal Drawer, & 1 Filing Drawer)
w400	d573	h450	UFP/3P	(3 Personal Drawers)

For use with 800mm Depth Rectangular Trios TR1, TR2, TR3, TRK, Baseline, and Trapeze Desks (except Trapeze A-Frame) only. Suitable only for 800mm Rectangular Desks.

Please note: 1 Pedestal only can be fitted to 1400mm and 1600mm width Rectangular Desks. 1800mm width Rectangular Desks can be fitted with either 1 or 2 Pedestals. Pedestals can be fixed in either left or right position. Fixed Pedestals are not suitable for use with 800mm, 1000mm, 1200mm or 2000mm width Desks.

Please note: Universal Desk Extensions are not suitable for use with height adjustable Desks. All Extensions and Fixed Pedestals are supplied with the appropriate fixings.



- » Extension shapes designed to meet all needs
- » Full metal to metal fixings
- » Fully retro-fittable



MFC & Frame Paint Options

- ** Please specify your MFC Finish from the Desking Finishes page
- * Please specify your Frame Paint Finish from the Desking Finishes page



- » Extension shapes designed to meet all needs
- » Full metal to metal fixings
- » Fully retro-fittable



MFC & Frame Paint Options

- ** Please specify your MFC Finish from the Desking Finishes page
- * Please specify your Frame Paint Finish from the Desking Finishes page

Align/Straight Square Leg



Rectangular Starter Desk
Single-Sided



Rectangular Extender Desk
Single-Sided



Double Wave Starter Desk
Single-Sided



Double Wave Extender Desk
Single-Sided



Rectangular Starter Desk Single-Sided

w1000	h720	AGS/10ST/RE△/SSL/SC/**/*	(Includes 1 Cable Scoop)*
w1200	h720	AGS/12ST/RE△/SSL/SC/**/*	(Includes 1 Cable Scoop)*
w1400	h720	AGS/14ST/RE△/SSL/SC/**/*	(Includes 1 Cable Scoop)*
w1600	h720	AGS/16ST/RE△/SSL/SC/**/*	(Includes 1 Cable Scoop)*
w1800	h720	AGS/18ST/RE△/SSL/SC/**/*	(Includes 2 Cable Scoops)*
w2000	h720	AGS/20ST/RE△/SSL/SC/**/*	(Includes 2 Cable Scoops)*

Rectangular Extender Desk Single-Sided

w1000	h720	AGS/10EX/RE△/SSL/SC/**/*	(Includes 1 Cable Scoop)*
w1200	h720	AGS/12EX/RE△/SSL/SC/**/*	(Includes 1 Cable Scoop)*
w1400	h720	AGS/14EX/RE△/SSL/SC/**/*	(Includes 1 Cable Scoop)*
w1600	h720	AGS/16EX/RE△/SSL/SC/**/*	(Includes 1 Cable Scoop)*
w1800	h720	AGS/18EX/RE△/SSL/SC/**/*	(Includes 2 Cable Scoops)*
w2000	h720	AGS/20EX/RE△/SSL/SC/**/*	(Includes 2 Cable Scoops)*

Double Wave Starter Desk Single-Sided

w1400	d900	h720	AGS/14ST/DW09/SSL/SC/**/*	(Includes 1 Cable Scoop)*
w1600	d900	h720	AGS/16ST/DW09/SSL/SC/**/*	(Includes 1 Cable Scoop)*
w1800	d900	h720	AGS/18ST/DW09/SSL/SC/**/*	(Includes 2 Cable Scoops)*

Double Wave Extender Desk Single-Sided

w1400	d900	h720	AGS/14EX/DW09/SSL/SC/**/*	(Includes 1 Cable Scoop)*
w1600	d900	h720	AGS/16EX/DW09/SSL/SC/**/*	(Includes 1 Cable Scoop)*
w1800	d900	h720	AGS/18EX/DW09/SSL/SC/**/*	(Includes 2 Cable Scoops)*

△ To specify the depth of your Align Single-Sided Rectangular Desk, replace the triangular △ symbol with /06 (600mm) or /08 (800mm).

*To specify Cable Ports (x2) instead of Cable Scoops for Align Single-Sided Desks, just replace /SC with /CP in the code.

Please note: All standard Cable Trays and Baskets can be fitted to Align Single-Sided Desks. If Screens are required, any of the standard 'Desk-Up' Screen ranges can be used (please see the Screens Price List for more information).



- » Available in 2 different widths
- » Includes Height Adjustable Leg option (690mm-810mm)
- » Designed to work with GS standard Screen ranges

MFC & Frame Paint Options

- ** Please specify your MFC Finish from the Desking Finishes page
- * Please specify your Frame Paint Finish from the Desking Finishes page

Align/Straight Square Leg



Rectangular Starter Desk
Double-Sided



Rectangular Extender Desk
Double-Sided



Double Wave Starter Desk
Double-Sided



Double Wave Extender Desk
Double-Sided



Rectangular Starter Desk Double-Sided

w1000	h720	AGD/10ST/RE△/SSL/SC/**/*	(Includes 1 Cable Scoop)
w1200	h720	AGD/12ST/RE△/SSL/SC/**/*	(Includes 1 Cable Scoop)
w1400	h720	AGD/14ST/RE△/SSL/SC/**/*	(Includes 1 Cable Scoop)
w1600	h720	AGD/16ST/RE△/SSL/SC/**/*	(Includes 1 Cable Scoop)
w1800	h720	AGD/18ST/RE△/SSL/SC/**/*	(Includes 2 Cable Scoops)
w2000	h720	AGD/20ST/RE△/SSL/SC/**/*	(Includes 2 Cable Scoops)

Rectangular Extender Desk Double-Sided

w1000	h720	AGD/10EX/RE△/SSL/SC/**/*	(Includes 1 Cable Scoop)
w1200	h720	AGD/12EX/RE△/SSL/SC/**/*	(Includes 1 Cable Scoop)
w1400	h720	AGD/14EX/RE△/SSL/SC/**/*	(Includes 1 Cable Scoop)
w1600	h720	AGD/16EX/RE△/SSL/SC/**/*	(Includes 1 Cable Scoop)
w1800	h720	AGD/18EX/RE△/SSL/SC/**/*	(Includes 2 Cable Scoops)
w2000	h720	AGD/20EX/RE△/SSL/SC/**/*	(Includes 2 Cable Scoops)

Double Wave Starter Desk Double-Sided

w1400	d1800	h720	AGD/14ST/DW18/SSL/SC/**/*	(Includes 1 Cable Scoop)
w1600	d1800	h720	AGD/16ST/DW18/SSL/SC/**/*	(Includes 1 Cable Scoop)
w1800	d1800	h720	AGD/18ST/DW18/SSL/SC/**/*	(Includes 2 Cable Scoops)

Double Wave Extender Desk Double-Sided

w1400	d1800	h720	AGD/14EX/DW18/SSL/SC/**/*	(Includes 1 Cable Scoop)
w1600	d1800	h720	AGD/16EX/DW18/SSL/SC/**/*	(Includes 1 Cable Scoop)
w1800	d1800	h720	AGD/18EX/DW18/SSL/SC/**/*	(Includes 2 Cable Scoops)

△ To specify the depth of your Align Double-Sided Rectangular Desk, just replace the triangular △ symbol with /12 (1200mm) or /16 (1600mm).

Please note: For Align Double-Sided Desks, 'Double Bench' Cable Baskets can be fitted. If Screens are required, please specify the 'DB' Bracket for use with any of our standard Screen ranges (please see the Screens Price List for more information).



- » Available in 2 different widths
- » Includes Height Adjustable Leg option (690mm-810mm)
- » Designed to work with GS standard Screen ranges

MFC & Frame Paint Options

- ** Please specify your MFC Finish from the Desking Finishes page
- * Please specify your Frame Paint Finish from the Desking Finishes page

Align/Square Angled Leg



Rectangular Starter Desk
Single-Sided



Rectangular Extender Desk
Single-Sided



Double Wave Starter Desk
Single-Sided



Double Wave Extender Desk
Single-Sided



Rectangular Starter Desk Single-Sided

w1000	d800	h720	AGS/10ST/RE08/SAL/SC/**/*	(Includes 1 Cable Scoop)*
w1200	d800	h720	AGS/12ST/RE08/SAL/SC/**/*	(Includes 1 Cable Scoop)*
w1400	d800	h720	AGS/14ST/RE08/SAL/SC/**/*	(Includes 1 Cable Scoop)*
w1600	d800	h720	AGS/16ST/RE08/SAL/SC/**/*	(Includes 1 Cable Scoop)*
w1800	d800	h720	AGS/18ST/RE08/SAL/SC/**/*	(Includes 2 Cable Scoops)*
w2000	d800	h720	AGS/20ST/RE08/SAL/SC/**/*	(Includes 2 Cable Scoops)*

Rectangular Extender Desk Single-Sided

w1000	d800	h720	AGS/10EX/RE08/SAL/SC/**/*	(Includes 1 Cable Scoop)*
w1200	d800	h720	AGS/12EX/RE08/SAL/SC/**/*	(Includes 1 Cable Scoop)*
w1400	d800	h720	AGS/14EX/RE08/SAL/SC/**/*	(Includes 1 Cable Scoop)*
w1600	d800	h720	AGS/16EX/RE08/SAL/SC/**/*	(Includes 1 Cable Scoop)*
w1800	d800	h720	AGS/18EX/RE08/SAL/SC/**/*	(Includes 2 Cable Scoops)*
w2000	d800	h720	AGS/20EX/RE08/SAL/SC/**/*	(Includes 2 Cable Scoops)*

Double Wave Starter Desk Single-Sided

w1400	d900	h720	AGS/14ST/DW09/SAL/SC/**/*	(Includes 1 Cable Scoop)*
w1600	d900	h720	AGS/16ST/DW09/SAL/SC/**/*	(Includes 1 Cable Scoop)*
w1800	d900	h720	AGS/18ST/DW09/SAL/SC/**/*	(Includes 2 Cable Scoops)*

Double Wave Extender Desk Single-Sided

w1400	d900	h720	AGS/14EX/DW09/SAL/SC/**/*	(Includes 1 Cable Scoop)*
w1600	d900	h720	AGS/16EX/DW09/SAL/SC/**/*	(Includes 1 Cable Scoop)*
w1800	d900	h720	AGS/18EX/DW09/SAL/SC/**/*	(Includes 2 Cable Scoops)*

*To specify Cable Ports (x2) instead of Cable Scoops for Align Single-Sided Desks, just replace /SC with /CP in the code.

Please note: All standard Cable Trays and Baskets can be fitted to Align Single-Sided Desks. If Screens are required, any of the standard 'Desk-Up' Screen ranges can be used (please see the Screens Price List for more information).

Align/Square Angled Leg



Rectangular Starter Desk
Double-Sided



Rectangular Extender Desk
Double-Sided



Double Wave Starter Desk
Double-Sided



Double Wave Extender Desk
Double-Sided



Rectangular Starter Desk Double-Sided

w1000	d1600	h720	AGD/10ST/RE16/SAL/SC/**/*	(Includes 1 Cable Scoop)
w1200	d1600	h720	AGD/12ST/RE16/SAL/SC/**/*	(Includes 1 Cable Scoop)
w1400	d1600	h720	AGD/14ST/RE16/SAL/SC/**/*	(Includes 1 Cable Scoop)
w1600	d1600	h720	AGD/16ST/RE16/SAL/SC/**/*	(Includes 1 Cable Scoop)
w1800	d1600	h720	AGD/18ST/RE16/SAL/SC/**/*	(Includes 2 Cable Scoops)
w2000	d1600	h720	AGD/20ST/RE16/SAL/SC/**/*	(Includes 2 Cable Scoops)

Rectangular Extender Desk Double-Sided

w1000	d1600	h720	AGD/10EX/RE16/SAL/SC/**/*	(Includes 1 Cable Scoop)
w1200	d1600	h720	AGD/12EX/RE16/SAL/SC/**/*	(Includes 1 Cable Scoop)
w1400	d1600	h720	AGD/14EX/RE16/SAL/SC/**/*	(Includes 1 Cable Scoop)
w1600	d1600	h720	AGD/16EX/RE16/SAL/SC/**/*	(Includes 1 Cable Scoop)
w1800	d1600	h720	AGD/18EX/RE16/SAL/SC/**/*	(Includes 2 Cable Scoops)
w2000	d1600	h720	AGD/20EX/RE16/SAL/SC/**/*	(Includes 2 Cable Scoops)

Double Wave Starter Desk Double-Sided

w1400	d1800	h720	AGD/14ST/DW18/SAL/SC/**/*	(Includes 1 Cable Scoop)
w1600	d1800	h720	AGD/16ST/DW18/SAL/SC/**/*	(Includes 1 Cable Scoop)
w1800	d1800	h720	AGD/18ST/DW18/SAL/SC/**/*	(Includes 2 Cable Scoops)

Double Wave Extender Desk Double-Sided

w1400	d1800	h720	AGD/14EX/DW18/SAL/SC/**/*	(Includes 1 Cable Scoop)
w1600	d1800	h720	AGD/16EX/DW18/SAL/SC/**/*	(Includes 1 Cable Scoop)
w1800	d1800	h720	AGD/18EX/DW18/SAL/SC/**/*	(Includes 2 Cable Scoops)

Please note: For Align Double-Sided Desks, 'Double Bench' Cable Baskets can be fitted. If Screens are required, please specify the 'DB' Bracket for use with any of our standard Screen ranges (please see the Screens Price List for more information).



- » Elegant design
- » Simple modular system
- » Cable Management options



MFC & Frame Paint Options

- ** Please specify your MFC Finish from the Desking Finishes page
- * Please specify your Frame Paint Finish from the Desking Finishes page



- » Elegant design
- » Simple modular system
- » Cable Management options



MFC & Frame Paint Options

- ** Please specify your MFC Finish from the Desking Finishes page
- * Please specify your Frame Paint Finish from the Desking Finishes page

Align/Round Angled Leg



Rectangular Starter Desk
Single-Sided



Rectangular Extender Desk
Single-Sided



Double Wave Starter Desk
Single-Sided



Double Wave Extender Desk
Single-Sided



Rectangular Starter Desk Single-Sided

w1000	d800	h720	AGS/10ST/RE08/RAL/SC/**/*	(Includes 1 Cable Scoop)*
w1200	d800	h720	AGS/12ST/RE08/RAL/SC/**/*	(Includes 1 Cable Scoop)*
w1400	d800	h720	AGS/14ST/RE08/RAL/SC/**/*	(Includes 1 Cable Scoop)*
w1600	d800	h720	AGS/16ST/RE08/RAL/SC/**/*	(Includes 1 Cable Scoop)*
w1800	d800	h720	AGS/18ST/RE08/RAL/SC/**/*	(Includes 2 Cable Scoops)*
w2000	d800	h720	AGS/20ST/RE08/RAL/SC/**/*	(Includes 2 Cable Scoops)*

Rectangular Extender Desk Single-Sided

w1000	d800	h720	AGS/10EX/RE08/RAL/SC/**/*	(Includes 1 Cable Scoop)*
w1200	d800	h720	AGS/12EX/RE08/RAL/SC/**/*	(Includes 1 Cable Scoop)*
w1400	d800	h720	AGS/14EX/RE08/RAL/SC/**/*	(Includes 1 Cable Scoop)*
w1600	d800	h720	AGS/16EX/RE08/RAL/SC/**/*	(Includes 1 Cable Scoop)*
w1800	d800	h720	AGS/18EX/RE08/RAL/SC/**/*	(Includes 2 Cable Scoops)*
w2000	d800	h720	AGS/20EX/RE08/RAL/SC/**/*	(Includes 2 Cable Scoops)*

Double Wave Starter Desk Single-Sided

w1400	d900	h720	AGS/14ST/DW09/RAL/SC/**/*	(Includes 1 Cable Scoop)*
w1600	d900	h720	AGS/16ST/DW09/RAL/SC/**/*	(Includes 1 Cable Scoop)*
w1800	d900	h720	AGS/18ST/DW09/RAL/SC/**/*	(Includes 2 Cable Scoops)*

Double Wave Extender Desk Single-Sided

w1400	d900	h720	AGS/14EX/DW09/RAL/SC/**/*	(Includes 1 Cable Scoop)*
w1600	d900	h720	AGS/16EX/DW09/RAL/SC/**/*	(Includes 1 Cable Scoop)*
w1800	d900	h720	AGS/18EX/DW09/RAL/SC/**/*	(Includes 2 Cable Scoops)*

*To specify Cable Ports (x2) instead of Cable Scoops for Align Single-Sided Desks, just replace /SC with /CP in the code.

Please note: All standard Cable Trays and Baskets can be fitted to Align Single-Sided Desks. If Screens are required, any of the standard 'Desk-Up' Screen ranges can be used (please see the Screens Price List for more information).

MFC & Frame Paint Options

** Please specify your MFC Finish from the Desking Finishes page

* Please specify your Frame Paint Finish from the Desking Finishes page

- » Striking angled leg
- » Full single- and double-sided range
- » Easy configuration

Align/Round Angled Leg



Rectangular Starter Desk
Double-Sided



Rectangular Extender Desk
Double-Sided



Double Wave Starter Desk
Double-Sided



Double Wave Extender Desk
Double-Sided



Rectangular Starter Desk Double-Sided

w1000	d1600	h720	AGD/10ST/RE16/RAL/SC/**/*	(Includes 1 Cable Scoop)
w1200	d1600	h720	AGD/12ST/RE16/RAL/SC/**/*	(Includes 1 Cable Scoop)
w1400	d1600	h720	AGD/14ST/RE16/RAL/SC/**/*	(Includes 1 Cable Scoop)
w1600	d1600	h720	AGD/16ST/RE16/RAL/SC/**/*	(Includes 1 Cable Scoop)
w1800	d1600	h720	AGD/18ST/RE16/RAL/SC/**/*	(Includes 2 Cable Scoops)
w2000	d1600	h720	AGD/20ST/RE16/RAL/SC/**/*	(Includes 2 Cable Scoops)

Rectangular Extender Desk Double-Sided

w1000	d1600	h720	AGD/10EX/RE16/RAL/SC/**/*	(Includes 1 Cable Scoop)
w1200	d1600	h720	AGD/12EX/RE16/RAL/SC/**/*	(Includes 1 Cable Scoop)
w1400	d1600	h720	AGD/14EX/RE16/RAL/SC/**/*	(Includes 1 Cable Scoop)
w1600	d1600	h720	AGD/16EX/RE16/RAL/SC/**/*	(Includes 1 Cable Scoop)
w1800	d1600	h720	AGD/18EX/RE16/RAL/SC/**/*	(Includes 2 Cable Scoops)
w2000	d1600	h720	AGD/20EX/RE16/RAL/SC/**/*	(Includes 2 Cable Scoops)

Double Wave Starter Desk Double-Sided

w1400	d1800	h720	AGD/14ST/DW18/RAL/SC/**/*	(Includes 1 Cable Scoop)
w1600	d1800	h720	AGD/16ST/DW18/RAL/SC/**/*	(Includes 1 Cable Scoop)
w1800	d1800	h720	AGD/18ST/DW18/RAL/SC/**/*	(Includes 2 Cable Scoops)

Double Wave Extender Desk Double-Sided

w1400	d1800	h720	AGD/14EX/DW18/RAL/SC/**/*	(Includes 1 Cable Scoop)
w1600	d1800	h720	AGD/16EX/DW18/RAL/SC/**/*	(Includes 1 Cable Scoop)
w1800	d1800	h720	AGD/18EX/DW18/RAL/SC/**/*	(Includes 2 Cable Scoops)

Please note: For Align Double-Sided Desks, 'Double Bench' Cable Baskets can be fitted. If Screens are required, please specify the 'DB' Bracket for use with any of our standard Screen ranges (please see the Screens Price List for more information).

MFC & Frame Paint Options

** Please specify your MFC Finish from the Desking Finishes page

* Please specify your Frame Paint Finish from the Desking Finishes page

- » Striking angled leg
- » Full single- and double-sided range
- » Easy configuration



Cable Management

38

Accessories

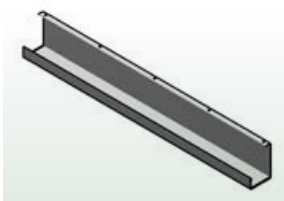

Universal Cable Trays

UCT08S	For use with 800mm width Straight Desks. (Actual Cable Tray length: 400mm)
UCT10S/12C	For use with 1000mm width Straight Desks / Single-Sided Align Desks, and 1200mm side of corner Workstation Desk. (Actual Cable Tray length: 600mm)
UCT12S/14C	For use with 1200mm width Straight Desks / Single-Sided Align Desks, and 1400mm side of corner Workstation Desk. (Actual Cable Tray length: 800mm)
UCT14S/16C	For use with 1400mm width Straight Desks / Single-Sided Align Desks, and 1600mm side of corner Workstation Desk. (Actual Cable Tray length: 1000mm)
UCT16S/18C	For use with 1600mm width Straight Desks / Single-Sided Align Desks, and 1800mm side of corner Workstation Desk. (Actual Cable Tray length: 1200mm)
UCT18S	For use with 1800mm width Straight Desks / Single-Sided Align Desks. (Actual Cable Tray length: 1400mm)
UCT20S	For use with 2000mm width Single-Sided Align Desks. (Actual Cable Tray length: 1600mm)

For use with all Trios TR1, TR2, TR3, and TRK Desks, all Baseline Desks, all Trapeze Desks, and all Single-Sided Align Bench Desks. Available in Silver Crackle only.

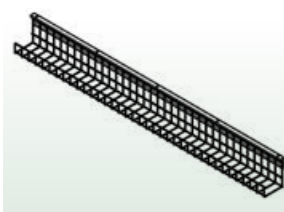

Universal Cable Baskets

UCB08S	For use with 800mm width Straight Desks. (Actual Cable Basket length: 400mm)
UCB10S/12C	For use with 1000mm width Straight Desks / Single-Sided Align Desks, and 1200mm side of corner Workstation Desk. (Actual Cable Basket length: 600mm)
UCB12S/14C	For use with 1200mm width Straight Desks / Single-Sided Align Desks, and 1400mm side of corner Workstation Desk. (Actual Cable Basket length: 800mm)
UCB14S/16C	For use with 1400mm width Straight Desks / Single-Sided Align Desks, and 1600mm side of corner Workstation Desk. (Actual Cable Basket length: 1000mm)
UCB16S/18C	For use with 1600mm width Straight Desks / Single-Sided Align Desks, and 1800mm side of corner Workstation Desk. (Actual Cable Basket length: 1200mm)
UCB18S	For use with 1800mm width Straight Desks / Single-Sided Align Desks. (Actual Cable Basket length: 1400mm)
UCB20S	For use with 2000mm width Single-Sided Align Desks. (Actual Cable Basket length: 1600mm)

For use with all Trios TR1, TR2, TR3, and TRK Desks, all Baseline Desks, all Trapeze Desks, and all Single-Sided Align Bench Desks. Available in Silver Crackle only.

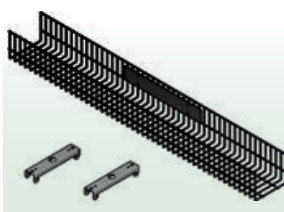

Double-Sided Align Bench Desk Cable Baskets

DBB10	For use with 1000mm width Double-Sided Align Desks. (Actual length: 800mm)
DBB12	For use with 1200mm width Double-Sided Align Desks. (Actual length: 1000mm)
DBB14	For use with 1400mm width Double-Sided Align Desks. (Actual length: 1200mm)
DBB16	For use with 1600mm width Double-Sided Align Desks. (Actual length: 1400mm)
DBB18	For use with 1800mm width Double-Sided Align Desks. (Actual length: 1600mm)
DBB20	For use with 2000mm width Double-Sided Align Desks. (Actual length: 1800mm)

For use with all Double-Sided Align Bench Desks. Available in Silver Crackle only. Includes a pair of metal fixing brackets (shown left).



MFC & Frame Paint Options

- * Please specify your Frame Paint Finish from the Desking Finishes page
- ** Please specify your MFC Finish from the Desking Finishes page

Cable Management

39

Accessories



Universal Cable Riser Kit

UCR/KIT

Comprises 2x 280mm lengths of 3-way self-adhesive trunking, and 2x 3-way cable clamps (and fixing screws). All items attach to inside face of modesty panel. **Please note:** A fully cable-managed corner Desk will require 2 Cable Riser Kits. Not suitable for use with Trapeze A-Frame Desks.



Under-Desk Cable Riser

660042

Vertical Cable Riser Spine. Available in Silver only.



Under-Desk Cable Way

660046

Arched 1340mm Cable Way. Available in Silver only.



Under-Desk Cable Tray and Riser

RACEWAY

Flexible 1600mm Cable Management system. Available in Silver only.



MFC & Frame Paint Options

- * Please specify your Frame Paint Finish from the Desking Finishes page
- ** Please specify your MFC Finish from the Desking Finishes page

Electrical Standards

Know your responsibilities

You've just chosen your new desk, but unless it's correctly configured for power and data services, it's potential for maximum efficiency will not be realised.

Electrical equipment and installations must be designed and tested to ensure their safety, and to comply with statutory regulations – in particular the 'Electricity At Work Regulations'. Relevant British Standards may be used as a means of demonstrating safety and compliance with the regulations. In the case of electrical systems in office and educational furniture, the relevant standard for systems connected to the mains supply by means of a 13A plug is BS 6396:2008.

Whilst acceptable for domestic use, socket blocks purchased from the high street will not comply with BS 6396, which requires that all sockets on the power module must be individually fused. Power modules used in the office should meet all electrical standards set out in BS 6396, as part of the requirements for compliance of the desk electrical system. All power modules supplied by Godfrey Syrett fully comply with current standards and legislation.

The diagram (right) indicates the maximum number of sockets that may be connected to a single power supply cable, fed from a 13 Amp BS 1363 plug, as well as their relevant fuse ratings.

If your socket block has a 13 Amp plug you can use 4 sockets, each fused at 5 Amp. Alternatively you can also use 6 sockets, each fused at 3.15 Amp. In all circumstances the combined sockets should not exceed 20 Amps. Equipment with ratings in excess of 5 Amp, such as kettles, coffee makers and fans must be provided with their own dedicated power feeds. It is generally acceptable to run these through the workstation cable management system.

We understand the importance of a correct installation in terms of both office safety and increased productivity. As such, we offer an extensive range of cable baskets, cable trays, under- and above- desktop power modules and other accessories.

We can also offer practical advice and guidance on an electrical configuration that is right for you now, and in the future.

If you have any questions please contact us on 0191 268 1010.

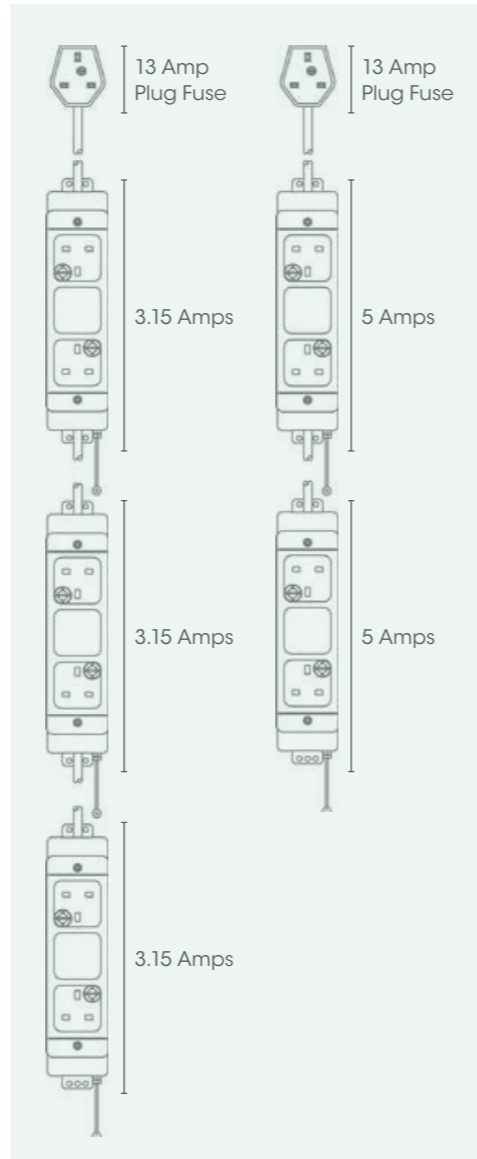

Appliance Power Usage

Personal Computer CPU	2 Amp
Monitor (Colour CRT type)	1.50 Amp
Laptop Computer	0.60 Amp
Mobile Phone Charger	0.05 Amp
Desk Lamp – 60W Tungsten	0.25 Amp
Desk Lamp – Low Voltage	0.10 Amp
Fax Machine	2 Amp
Desk Fan	0.25 Amp
Kettle	2 Amp

Desking Electrics - What You'll Need

1 Powerbar Socket Block

Used to supply power from the Power Modules.



See Page 45

2 Cable Tray/Basket

Used to safely house all under-desk cables and Powerbars.

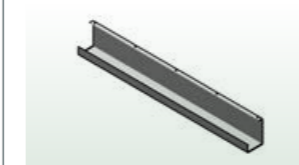

See Pages 38-39

3 Desktop Power Module

Supplies power from the mains electricity supply.



See Pages 42-43

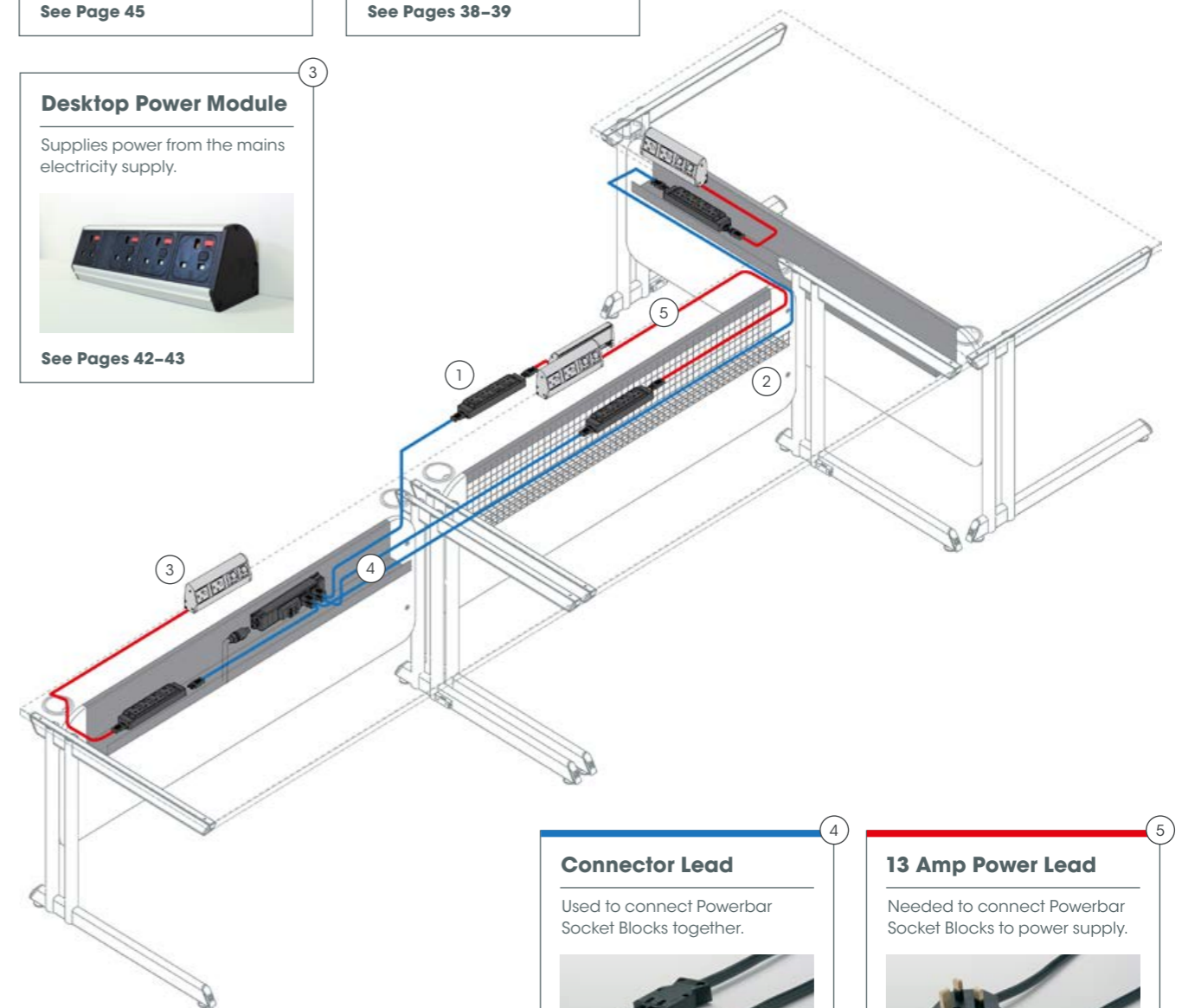

4 Connector Lead

Used to connect Powerbar Socket Blocks together.



See Page 45

5 13 Amp Power Lead

Needed to connect Powerbar Socket Blocks to power supply.



See Page 45

Accessories

**Poco Desktop Power Module**

POCO25/1007	(Includes 2x UK Power Sockets)
POCO40/1138	(Includes 2x UK Power Sockets, and 2x RJ45 Ports)
POCO40/1843	(Includes 2x UK Power Sockets, and 1x Twin USB Fast Charger)
POCO50/1016	(Includes 4x UK Power Sockets)

All Poco Power Modules are supplied with a hardwired 0.8m power lead to male GST18/3 connector, and individually fused @ 3.15 Amps. All data ports are 3m Cat5e. Also includes standard clamp fixing. Other fixings available on request. **Please order Power Leads separately.**

**Pearl Desktop Power Module**

PEARL25/1001	(Includes 2x UK Power Sockets)
PEARL40/1042	(Includes 2x UK Power Sockets, and 2x RJ45 Ports)
PEARL40/1067	(Includes 2x UK Power Sockets, and 1x Twin USB Fast Charger)
PEARL50/1020	(Includes 4x UK Power Sockets)

All Pearl Power Modules are supplied with a hardwired 0.8m power lead to male GST18/3 connector, and individually fused @ 3.15 Amps. All data ports are 3m Cat5e. **Please order Power Leads separately.**

**Pod Desktop Power Module**

POD25/1103	(Includes 2x UK Power Sockets)
POD45/1071	(Includes 2x UK Power Sockets, and 2x RJ45 Ports)
POD45/2183	(Includes 2x UK Power Sockets, and 1x Twin USB Fast Charger)
POD45/1105	(Includes 4x UK Power Sockets)

All Pod Power Modules are supplied with a hardwired 0.8m power lead to male GST18/3 connector, and individually fused @ 3.15 Amps. All data ports are 3m Cat5e. Also includes standard clamp fixing. Other fixings available on request. **Please order Power Leads separately.**

**Polarice Desktop Power Module**

POLARICE20/1016	(Includes 2x UK Power Sockets)
POLARICE30/1007	(Includes 2x UK Power Sockets, and 2x RJ34 Ports)
POLARICE30/1401	(Includes 2x UK Power Sockets, and 1x Twin USB Fast Charger)
POLARICE40/1042	(Includes 4x UK Power Sockets)

All Polarice Power Modules are supplied with a hardwired 0.8m power lead to male GST18/3 connector, and individually fused @ 3.15 Amps. All data ports are 3m Cat5e. Also includes standard clamp fixing. Other fixings available on request. **Please order Power Leads separately.**

Accessories

**Pluto Desktop Power Module**

PLUTO/1009	(Includes 2x UK Power Sockets, and 1x Twin USB Fast Charger)
PLUTO/1007	(Includes 3x UK Power Sockets)
PLUTO/1023	(Includes 2x UK Power Sockets, and 2x RJ45 Ports)

All Pluto Power Modules are supplied with a hardwired 0.8m power lead to male GST18/3 connector, and individually fused @ 3.15 Amps. All data ports are 3m Cat5e. Side or base exit **must** be advised.

**Pixel Desktop Power Module**

PIXEL/1011	(Includes 1x UK Power Socket)
PIXEL/1015	(Includes 1x UK Power Socket, and 2x RJ45 Ports)
PIXEL/1027	(Includes 1x Twin USB Fast Charger)

All Pixel Power Modules are supplied with a hardwired 0.8m power lead to male GST18/3 connector, and individually fused @ 3.15 Amps. All data ports are 3m Cat5e.

**Phantom Desktop Power Module**

PHANTOM/200	(Includes 2x UK Power Sockets)
PHANTOM/22B	(Includes 2x UK Power Sockets, and 2x RJ45 Ports)

All Phantom Power Modules are supplied with a hardwired 0.8m power lead to male GST18/3 connector, and individually fused @ 3.15 Amps. All data ports are 3m Cat5e.



Please note: When ordering Pluto, Pixel and Phantom Desktop Power Modules, please check with the Design department to ensure suitability and fit.

Accessories



Prism Platinum Thru-Desk Power Module

PLATINUM45/1004/□ (Includes 2x UK Power Sockets, and 2x RJ45 Ports)

PLATINUM45/4142/□ (Includes 2x UK Power Sockets, and 1x Twin USB Fast Charger)

PLATINUM75/1006/□ (Includes 4x UK Power Sockets, and 4x RJ45 Ports)

PLATINUM75/1243/□ (Includes 4x UK Power Sockets, 2x RJ45 Ports, and 1x A/V Port)

All Prism Platinum Power Modules are supplied with hardwired 0.8m lead to male GST18/3 Wieland. All data ports are Cat5e with 3m fly lead. A/V Port: 3.5mm Audio, 15pin VGA. Available in Silver only. **Please order Power Leads separately.**



Genie Thru-Desk Power Module

GENIE/1019/□ (Includes 4x UK Power Sockets)

GENIE/1087/□ (Includes 3x UK Power Sockets, 2x RJ45 Ports, and 1x Twin USB Fast Charger)

GENIE/1041/□ (Includes 4x UK Power Sockets, 2x RJ45 Ports, and 1x A/V Port)

All Genie Power Modules are supplied with male GST18/3 entry only. All data ports are Cat5e with 3m fly lead. A/V Port: 3.5mm Audio, 15pin VGA. Available in White only. **Please order Power Leads separately.**



Axxess Thru-Desk Power Module

AXXESS/1231/□ (Includes 4x UK Power Sockets, and 2x RJ45 Ports)

AXXESS/1172/□ (Includes 2x UK Power Sockets, 2x RJ45 Ports, and 1x A/V Port)

AXXESS/1450/□ (Includes 3x UK Power Sockets, 2x RJ45 Ports, and 1x Twin USB Fast Charger)

All Axxess Power Modules are supplied with male GST18/3 entry only. All data ports are Cat5e with 3m fly lead. A/V Port: 3.5mm Audio, 15pin VGA. Available in Silver only. **Please order Power Leads separately.**

Thru-Desk Power Module Position

Please specify your Thru-Desk Power Module position from the options below, and add the relevant letters to the code.



Central /CC



Middle Rear /MR



Left Rear /LR

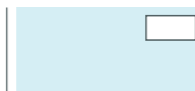

Right Rear /RR



Left Middle /LM



Right Middle /RM

Please note: Cutout size needs to be specified. Please see below for the relevant sizes:

PLATINUM45/1004 272mm x 132mm

PLATINUM45/4142 274mm x 132mm

PLATINUM75/1006 430mm x 132mm

PLATINUM75/1243 430mm x 132mm

GENIE/1019 405mm x 140mm

GENIE/1087 405mm x 140mm

GENIE/1041 405mm x 140mm

AXXESS/1231 272mm x 138mm

AXXESS/1172 272mm x 138mm

AXXESS/1450 272mm x 138mm

Accessories



Powerbar Socket Block

PB2 (Includes 2x UK Power Sockets. GST 18/3 Male entry to GST 18/3 Female output)

PB4 (Includes 4x UK Power Socket. GST 18/3 Male entry to GST 18/3 Female output)

PB6 (Includes 6x UK Power Sockets. GST 18/3 Male entry only)

All Powerbar Socket Blocks are individually fused @ 3.15 Amps, and are fitted with GST 18/3 Wieland Connectors. **Please note:** For under-desk use only.



13 Amp Power Lead

PL1 (1000mm Length)

PL2 (2000mm Length)

PL3 (3000mm Length)

PL4 (4000mm Length)

PL5 (5000mm Length)

PL6 (6000mm Length)

PL7 (7000mm Length)

Female GST 18/3 Wieland Connector to 13 Amp UK Plug.



Connector Lead

LC3 (300mm Length)

LC5 (500mm Length)

LC10 (1000mm Length)

LC20 (2000mm Length)

LC30 (3000mm Length)

Female GST 18/3 Wieland Connector to Male GST 18/3 Wieland Connector.



Adaptor Block

GSTAB/M3F/B (1 in, 3 out adaptor)

Use for joining Connector Leads together.



- » The Genie Thru-Desk Power Module features a recessed channel to the inside rim to funnel any minor spillages away from the current carrying parts
- » Assists with the requirements of the Disability Discrimination Act (DDA) by providing easily accessible facilities
- » All Power Modules are tested and compliant to BS6396 and BS7671

- » All Electrics on this page are tested and compliant to BS6396 and BS7671



Tubestation/

Accessories/

Accessories

3-Way Tubestation 1200mm Height

TS2/3/1200/FB/12P/◇ (Includes 12x Power Sockets)

TS2/3/1200/FB/6P6D/◇ (Includes 6x Power Sockets, and 6x Data Points)

TS2/3/1200/FB/12D/◇ (Includes 12x Data Points)

Available in Black, Silver or White (please specify). Power and Data modules are mounted 720mm from floor level, unless otherwise stated. 3-Way Power is available through the points shown in the diagram below.



4-Way Tubestation 1200mm Height

TS2/4/1200/FB/16P/◇ (Includes 16x Power Sockets)

TS2/4/1200/FB/8P8D/◇ (Includes 8x Power Sockets, and 8x Data Points)

TS2/4/1200/FB/16D/◇ (Includes 16x Data Points)

Available in Black, Silver or White (please specify). Power and Data modules are mounted 720mm from floor level, unless otherwise stated. 4-Way Power is available through the points shown in the diagram below.

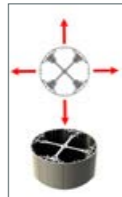

EPod Tables



Tubestation is designed to work seamlessly with EPod Table Units. Please refer to the Tables Price List for EPod pricing and product details.

Please note: Standard Tubestation supplied complete with all doors. Other height and electrical options are available (\$POA).

Colour Options

◇ Please specify your Tubestation finish colour from the options below

BL Black

SL Silver

WT White

Accessories

ADDB Mobile CPU Holder

ADDB/M/TR

Adjustable small CPU cradle. Height range 300mm-500mm. Width range 105mm-210mm. Available in silver only.



ADDB Adjustable CPU Holder

ADDB/TR/S

Static CPU cradle. Height range 330mm-533mm. Width range 127mm-260mm. Available in silver only.



JAW Adjustable CPU Holder

CPU/013

Static CPU cradle. Height range 290mm-510mm. Width range 90mm-240mm. Supplied with a Universal Mounting Rotating Bracket. Available in silver only.



CLAM CPU Holder

CLAM01

Adjustable small CPU cradle. Height range 250mm-480mm. Width range 90mm-140mm. Available in silver only.

CLAM02

Adjustable small CPU cradle. Height range 300mm-560mm. Width range 140mm-240mm. Available in silver only.



Universal Slide & Rotate

UNI/SR350

Length 350mm. Width 114mm. Available in silver only.

Universal Clam Lock Kit

CLAM/UNL

Consists of 4x Lock Bar, 1x Lock Plate, and 1x Lock Key. Available in silver only.

Please note: CPU's are not included, and are for illustrative purposes only.



- » Robust stove powder coated aluminium construction
- » Base cover to eliminate trip hazards
- » Tested and complies to BS EN 6396



Accessories/

48

Accessories

**Flo Dynamic Monitor Arm with Split Clamp****DYN/013/001/◇**

Supplied with a Flo Split Clamp. Working load range 3kg-9kg. Clamp range 0mm-71mm. Available in silver or white (please specify).

**Flo Dynamic Monitor Arm with Thru-Desk Clamp****DYN/013/002/◇**

Supplied with a Flo Thru-Desk Clamp. Working load range 3kg-9kg. Clamp range 0mm-50mm. Available in silver or white (please specify).

**Flo Dynamic Monitor Arm with Top Mount Clamp****DYN/013/003/◇**

Supplied with a Flo Top Mount Clamp. Working load range 3kg-9kg. Clamp range 12mm-25mm. Available in silver or white (please specify).

**Flo Plus Dual Monitor Arm with Split Clamp****DYN026/010/DMB/A35/W**

Supplied with a Flo Split Clamp. Working load range 6kg-18kg. Clamp range 0mm-71mm. Accommodates 2x 24" widescreen monitors in landscape orientation. Available in white only.

**Flo Plus Dual Monitor Arm with Top Mount Clamp****DYN026/010/DMB/A34/W**

Supplied with a Flo Plus Top Mount Clamp. Working load range 6kg-18kg. Clamp range 12mm-25mm. Accommodates 2x 24" widescreen monitors in landscape orientation. Available in white only.

Please note: Computer Monitors are not included, and are for illustrative purposes only.

◇ Colour Options

◇ Please specify your Monitor Arm colour from the options below

S Silver**W** White

Accessories/

49

Accessories

**Rodney Monitor Arm with Desk Clamp****SUN/001/◇**

Supplied with a Desk Clamp. Maximum working load 8.5kg. Available in silver or white (please specify).

**Rodney Monitor Arm with Thru-Desk Fixing****SUN/002/◇**

Supplied with a Thru-Desk Fixing. Maximum working load 8.5kg. Available in silver or white (please specify).

Please note: Computer Monitors are not included, and are for illustrative purposes only.

◇ Colour Options

◇ Please specify your Monitor Arm colour from the options below

SL Silver**WT** White

Finishes/ Paint

* Replace /* with the 2-digit letter code below that represents your choice of Paint Finish.

Standard Metal Paint Finishes

Below are the Standard Paint Finish options, available at no extra cost. **+£0**

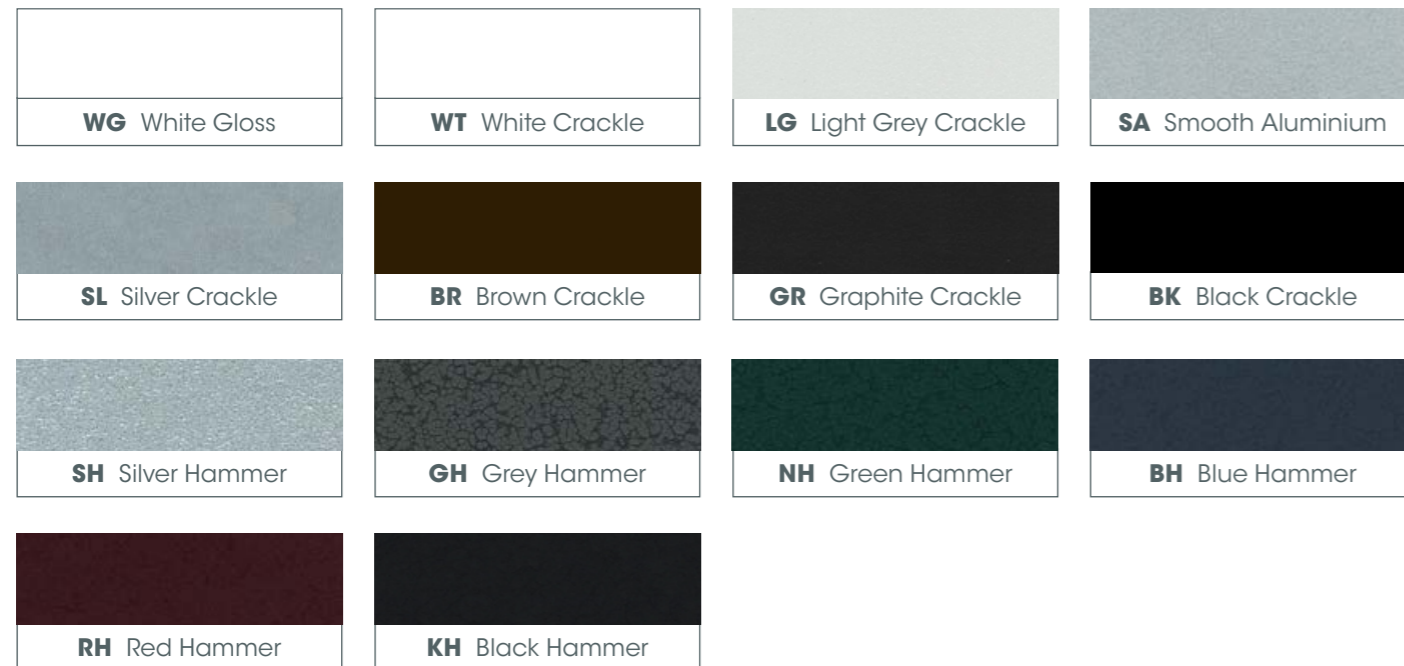

Premium Metal Paint Finishes

We also offer a Premium Chrome Effect paint finish, priced on application.



Metal Paint Samples

We can supply metal paint samples, free of charge, for any of the paint finishes listed above. To request a paint sample, please contact us at sales@godfreysyrett.co.uk

***Please note:** Unless otherwise stated, all Premium Paint Finishes are an additional percentage of the overall retail cost. The only exception to this are Tables from the Table Creator, where the additional percentage is taken only from the Table frame cost.

Finishes/ MFC

** Replace /** with the 2-digit letter code below that represents your choice of MFC Finish.

E/ Standard MFC with Matching Edge

Below are the Standard MFC Finish options, available at no extra cost.

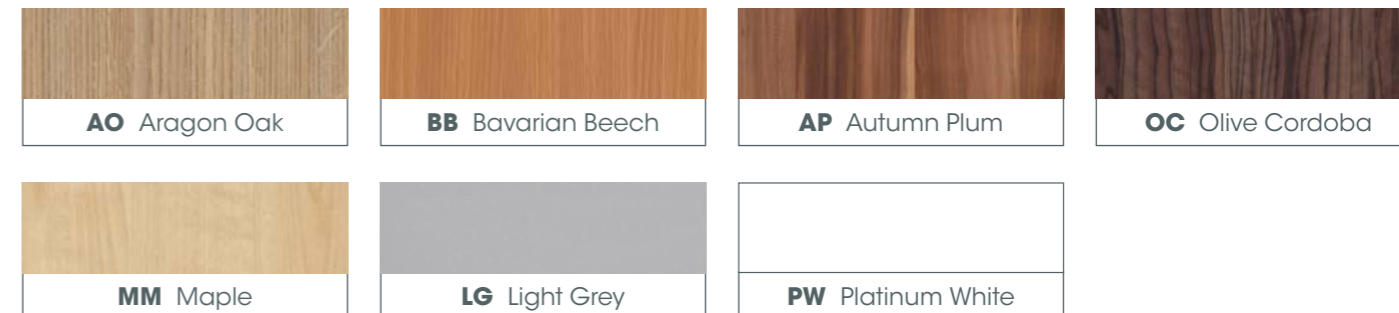

U/ Premium MFC with Matching Edge

Below are the Premium MFC Finish options, priced on application.
Please note: Replace **E/** on product code with **U/** and add additional cost to the price.

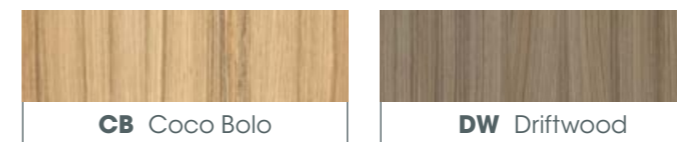

S/ MFC with Contrasting Edge

Below are the MFC Finish Contrasting Edge options, available at an additional cost.
Please note: Replace **E/** on product code with **S/** and add additional cost to the price.

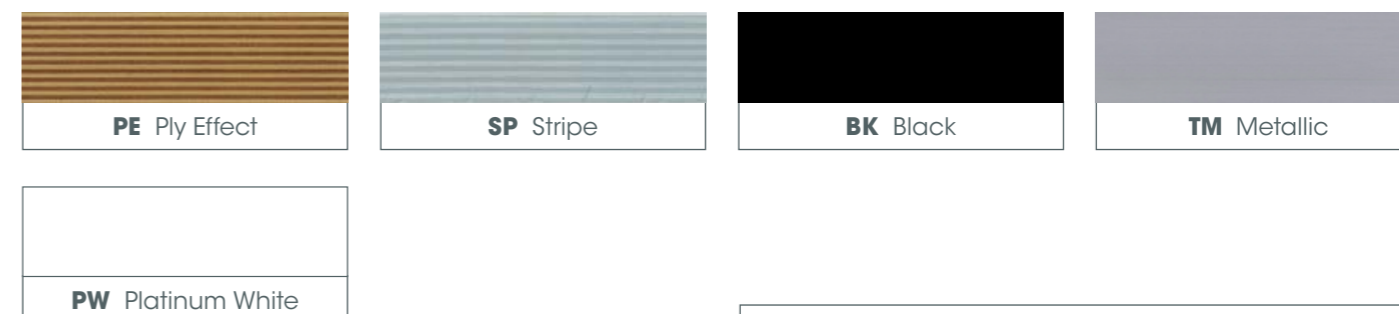

MFC Samples

We can supply MFC wood samples, free of charge, for any of the MFC finishes listed above. To request a sample, please contact us at sales@godfreysyrett.co.uk

GODFREY SYRETT



design/make/deliver

Head Office & Manufacturing

Godfrey Syrett Ltd
Planet Place
Killingworth
Newcastle upon Tyne
NE12 6DY

T: 0191 268 1010

F: 0191 268 3134

E: sales@godfreysyrett.co.uk

www.godfreysyrett.co.uk

Information contained in this brochure is subject to error. Godfrey Syrett Limited reserve the right to make additions to/deletions from and changes to the specifications of any item without prior notice. Due to the printing process some colours may differ from the actual products. Please ask for samples before ordering.