

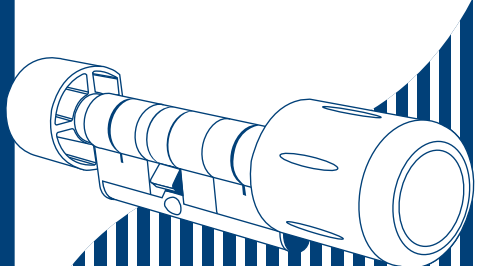

# C-700 Series Digital Locking Cylinder User Manual



[www.waferlock.com](http://www.waferlock.com)

## Parts list for the C700 Cylinder

- Digital Locking Cylinder X 1  
External Knob Dimensions: 47 (L) x 35.8 (D)mm



- Internal Knob x 1  
(Dimensions: 25 (L) x 32 (D)mm)



- Batteries X 1 ( CR2 )



- M5 Screw x 1



- L shape 1.5mm Hex Screw Driver



- C7 Tool ( optional )  
Waferlock Screw Driver for C700 Cylinder use



## ⊙ Battery Replacement

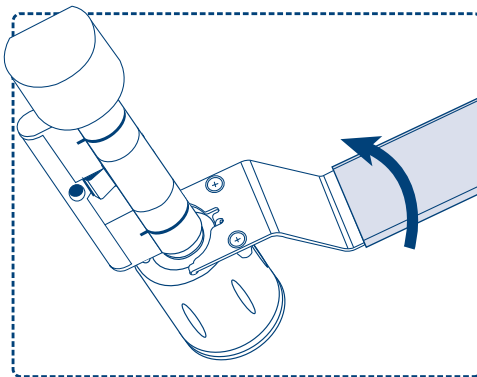

- 1 Use the C7 screw driver to find and match 2 holes of external knob.  
( There are 4 holes alongside of external knob )

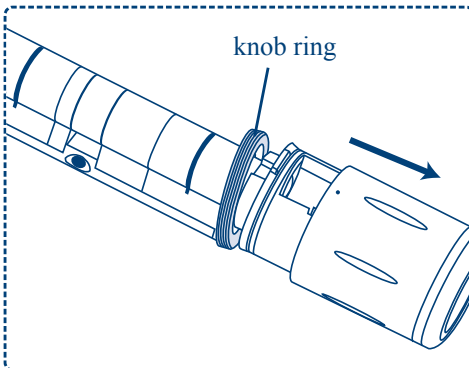

- 2 One hand holds the knob cover and the other hand turns the tool counter-clockwise until the knob ring is loosened from the knob, then pull out the metal cover.

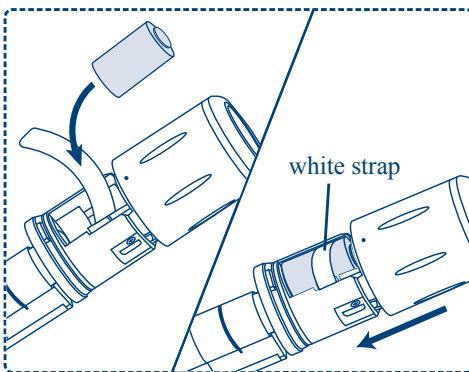

- 3 Insert CR2 x 1 battery into the knob and make sure that the white strap is properly under/cross the battery. ( The strap will help you to pull out the battery easily )

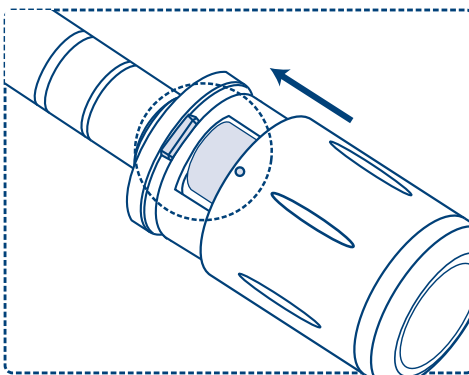

- 4 Place the metal cover back to the knob by matching the cover hint hole with knob raised edge properly.

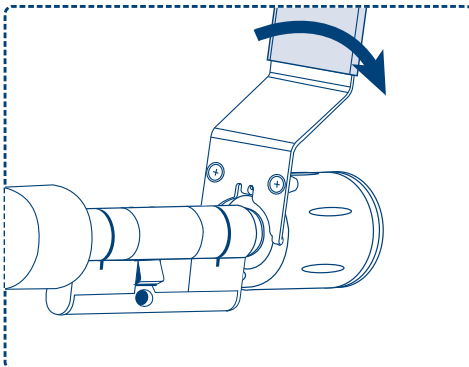

- 5 Turn the knob ring clockwise with the C7 tool to tighten the knob ring back inside the knob properly.

## ◎ Assemble C700 on Door Lock

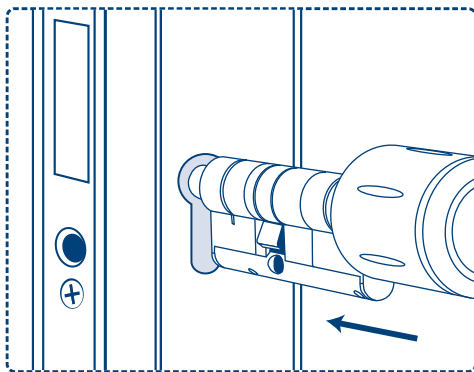

- ① Insert Cylinder through door  
( from outside )

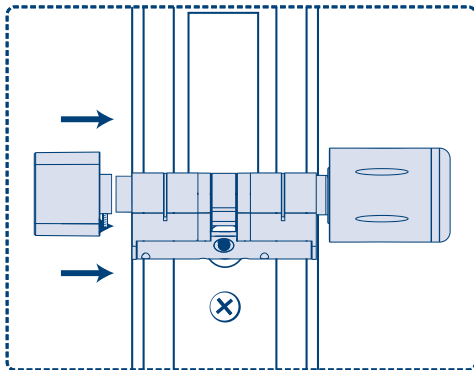

- ② Ready the small internal knob and put it on  
the cylinder core.

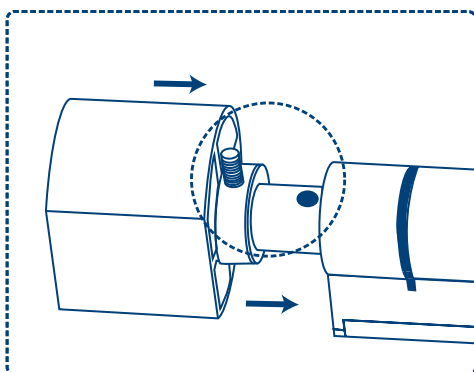

- ③ Match the screw hole of the knob and  
cylinder.

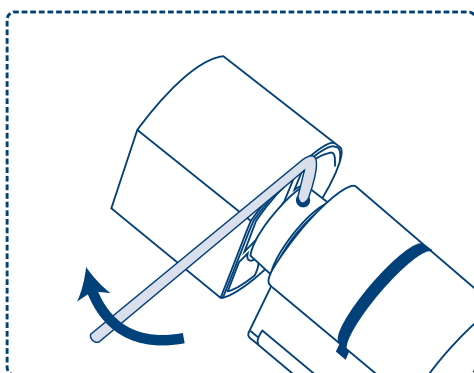

- ④ Turn the screw clockwise with the L – Shape  
hex screwdriver ( enclosed ) to secure the  
knob tightly onto the cylinder.

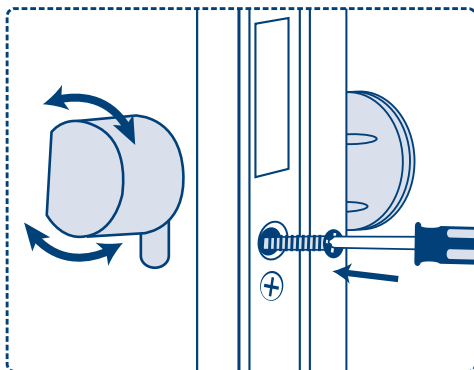

- ⑤ Turn internal knob to activate dead/latch  
bolt and check if the cylinder is in the right  
position; then insert M5 screw ( enclosed )  
to fix cylinder with the door lock.

## ◎ Your Warranty

Your Warranty covers all manufacturers' defects in workmanship and material. It does not cover any unit that is damaged beyond normal usage, by improper installations, by contacts to chemicals, or any other acts or omissions unsanctioned within the user manual.

All components are covered for one (1) year after the date of purchase or installation from supplier.

The user is required to provide dated proof of purchase. Waferlock or its authorized distributor will determine if there is a warrantable condition associated with material and/or manufacturing workmanship. If the lock conforms to the warranty conditions, the lock will be repaired free of charge. The shipping freights would be at owner's expense.

The warranty does not include any further obligation whatsoever, including but not limited to the installation of the replacement unit to the customer's lock. All other warranties, express or implied, are disclaimed. All collateral agreements, which purport to modify this limited warranty, are of no effect.

### CE Marking

This device has been tested to and conforms to the regulatory requirements of the European Union and has attained CE Marking. The CE Mark is a conformity marking consisting of the letters "CE". The CE Mark applies to products regulated by certain European health, safety and environmental protection legislation. The CE Mark is obligatory for products it applies to: the manufacturer affixes the marking in order to be allowed to sell his product in the European market.

This product conforms to the essential requirements of the R&TTE directive 1999/5/EC in order to attain CE Marking. A notified body has determined that this device has properly demonstrated that the requirements of the directive have been met and has issued a favorable certificate of expert opinion. As such the device will bear the notified body number 0560 after the CE mark.

The CE Marking is not a quality mark. Foremost, it refers to the safety rather than to the quality of a product. Secondly, CE Marking is mandatory for the product it applies to, whereas most quality markings are voluntary.

Marking: The product shall bear the CE mark, the notified body number(s) as depicted to the right. CE 0560.

**WFE TECHNOLOGY CORPORATION**  
Tel: 886-4-22300362 Fax: 886-4-22377995  
No. 16 Ke Yuan 2nd Rd., Central Taiwan Science Park  
Taichung city 407, Taiwan.  
E-mail: info@waferlock.com