

Conos

6055

Conos

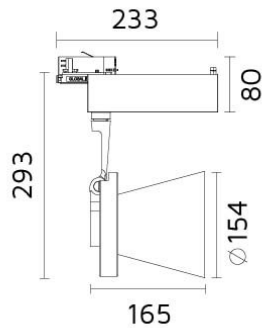

Track Mounted Adjustable Spotlight for G12 CDM-T MH lamps

- Light head: 350° rotation and up to 90° lockable tilting.
- 3 circuit universal track adaptor.
- Control gear housing and light head made of die cast aluminium.
- Superpure aluminium reflector.
- Safety glass included.
- Lamp source: 70W G12 CDM-T Metal Halide (lamp not included).
- Optic: reflector beam angle: 40°.
- 220-240V 50/60Hz integral control gear is inclusive.
- Accepts optical accessories.
- Versions for PAR30 CDM-R or GX8,5 CDM-R111 MH or G53 AR111 Halogen or PAR30 E27 LED retrofit lamps or with LED COB package are available.

For lamps Information refer to Osram or Philips or GE lamp data Index.

Accessories

(To be ordered separately)

Item	Code
Coloured Filters	2153
Reflector	2155
UV Filter	2157
Honeycomb Louvre	2367

Specifications

Designed and manufactured to comply with European standard EN 60598.



Product code	Finish	Color temperature	CRI	Beam angle	Dim. options	Code
6055	10 - Black 11 - White 75 - Grey			40°		

Ordering code example : 6055 - _ _