

Conos

6323-K40D40

Conos

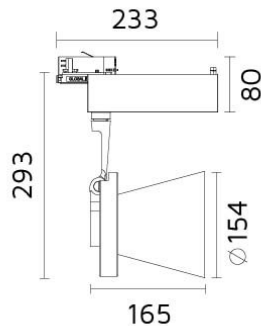

Track Mounted Adjustable Spotlight with LED

- Light head: 350° rotation and up to 90° lockable tilting.
 - Control gear housing and light head made of die cast aluminium.
 - Optical grade metalized polycarbonate reflector.
 - 3 circuit universal track adaptor.
 - Passive cooling COB LED source 4000K CRI>80 of 4880 nominal lumen.
 - System power 47W; System efficacy 68,7 lm/W; 32305 delivered lumen.
 - Optic: reflector beam angle: 40°.
 - 220-240V 50/60Hz integral control gear is inclusive.
 - Versions for G12 CDM-T or E27 PAR30 CDM-R or GX8,5 CDM-R111 MH or G53 AR111 Halogen or PAR30 E27 LED retrofit lamps are available.
- LED source package is available on request with a preferred LED colour rendering CRI>90 and/or other colour temperature K options.

Accessories

(To be ordered separately)

Item	Code
Ceiling Base	2049

Specifications

Designed and manufactured to comply with European standard EN 60598.



Product code	Finish	Color temperature	CRI	Beam angle	Dim. options	Code
6323	10 - Black	K40-4000K	>80	D40-40°	Phase	2
	11 - White				LaserDIM	5
	75 - Grey					

Ordering code example : 6323 - __ K40 D40 __