

Installation & Maintenance Guide

v1.2

Guide for Hyperion Fence Gates

HYPERION[®]

F E N C I N G





STORAGE & HANDLING

While composites are highly durable, to ensure their lasting beauty, please follow these important guidelines when storing, moving and working with Hyperion Fencing products.



Storage

- Material should always be covered until it is ready to be installed to maintain a clean surface. If stored outside use a non-translucent material
- All products should be stored flat and level, supported above the ground at 500mm intervals
- Battens used to separate and support stored material should be spaced no more than 500mm apart, to ensure the boards don't bow
- Stack units with banding and bottom supports aligned
- Pallets of fencing slats should not be stacked more than 4 pallets or 3m in height



Handling

- Hyperion Fencing materials should be placed and not dumped when unloading
- When removing boards from a unit, lift the slats and set them down, do not slide slats against each other when moving them
- Carry Hyperion Fencing slats on the edge for better support
- During construction, do not slide or drag any equipment across the slats
- The surface of the boards should be kept free of construction material and waste to prevent damage
- Each 1.8 fencing slat can weigh on average 4.5kg please ensure they are handled safely. we recommend that two people handle the boards during transportation





Recommended Tools To Install Hyperion Fencing

Standard woodworking tools can be used when working with Hyperion Fencing. If you are unsure on how to use any tool, please consult the tool's manufacturer's user manual.

- Circular Saw - we recommend a thin kerf 40-tooth alternate top bevel finish blade to achieve the cleanest cuts.
- Chisel
- Impact Driver
- Tape Measure
- Spirit Level
- Safety Glasses and relevant Personal Protection Equipment (PPE)
- Chalk Line
- Phillips head screwdriver
- Sledge hammer and driving block if using fence post spikes
- Hex head key – 8m & 10mm





Gate Kit - Frame, Lock & Hinges





Gate Kit - Component Labels

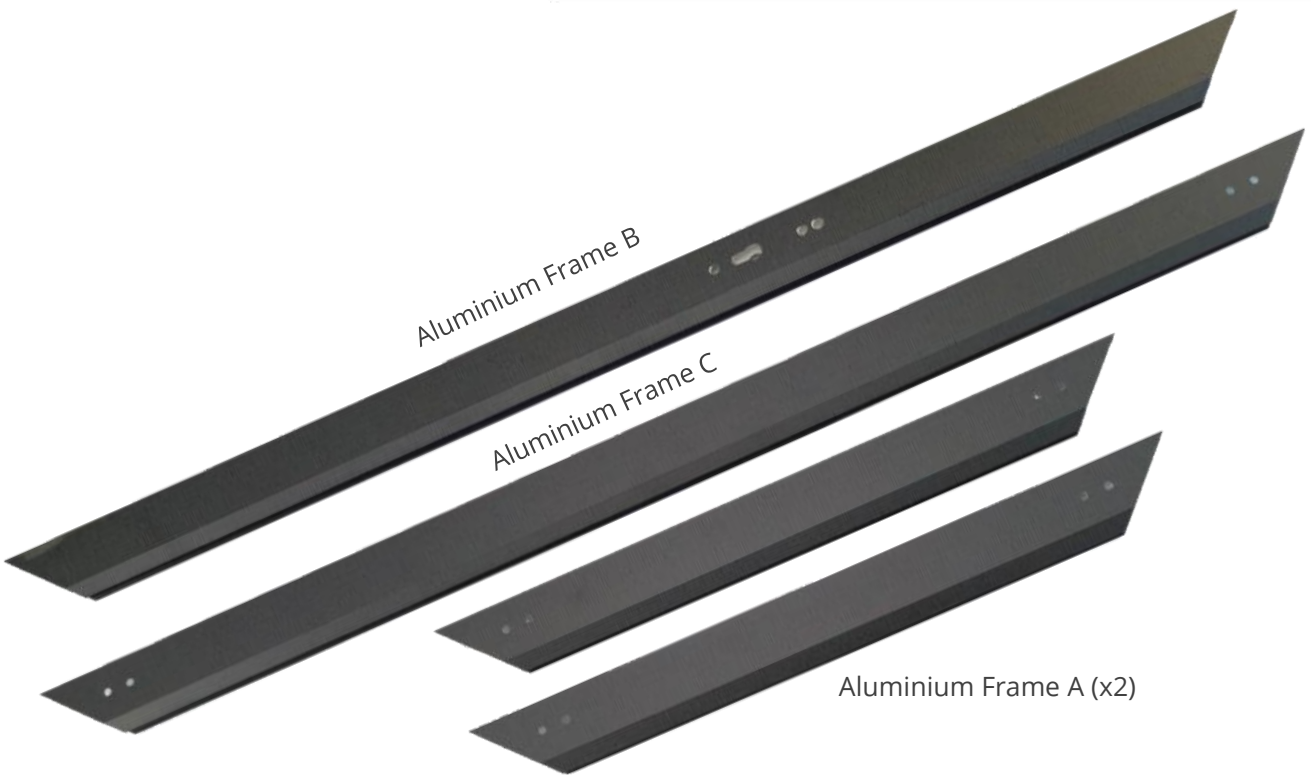
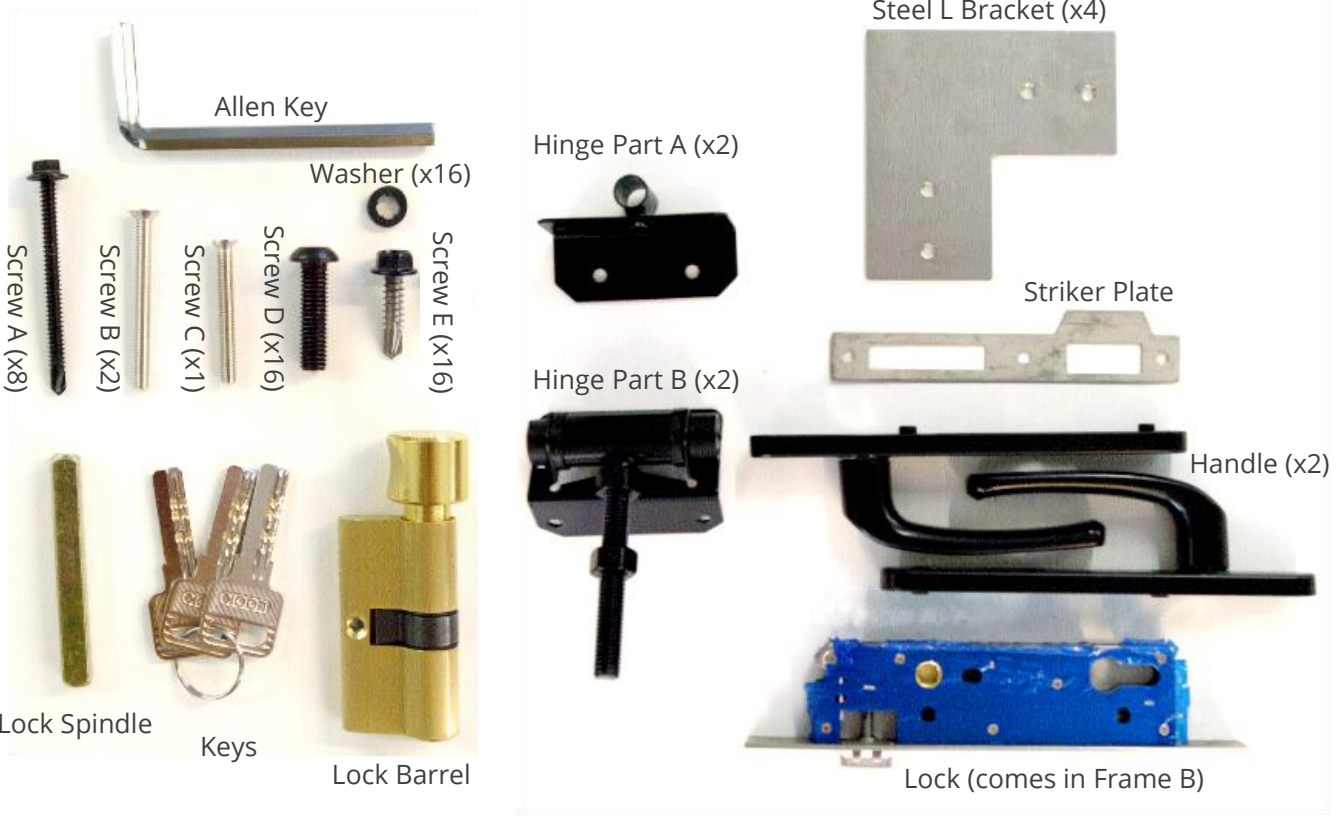



Instal Posts & Choose Gate Direction

Step 1: Unpack and Check Items

1. **Unpack your gate kit** and verify all items are present.

Step 2: Prepare and Install Posts

1. Fix your posts in place using 1.6m ground anchor steel pole and ensure there is a **gap of at least 875 mm** between them (860mm gate, 5mm latch, min 10mm gap between hinge which can be extended) – Fig.01.

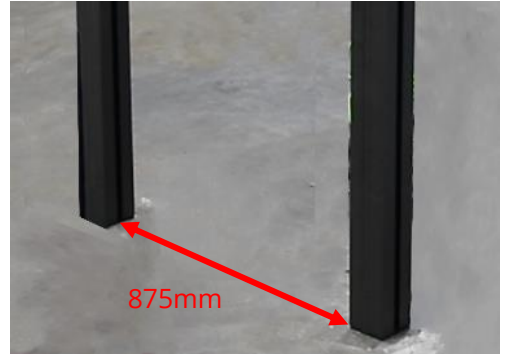

Fig.01

Step 3: Determine Gate Opening Direction

1. Decide which way you want the gate to open and therefore when you will need to install your hinges and have your latch facing (curved latch edge facing the post it latches too).
2. If required you can re-position the latch direction in the lock case. Unscrew the lock from Aluminium Frame B with 2 face screws shown in Fig.02.
3. With lock removed lift the lever shown Fig.03 and push in the latch fully, you can now rotate 180 degrees and depress the latch ensuring the level falls back to locked position – Fig.04.



Fig.02



Fig.03



Fig.04





Build Gate Panel

Step 5: Attach L Brackets to Aluminium Frame

1. Take the L brackets and attach one to each end of one of your Aluminium Frame A parts using Screw D – Fig.05.



Fig.05

Step 6: Attach Frame Sides (B&C) to Bottom Frame (A)

1. Slide the bottom end of Aluminium Frame B & C (B bottom is based on lock direction) pieces over just 1 of the Aluminium Frame A pieces with the affixed L brackets until the holes line up – Fig.05.
2. Fix the pieces in place with Screw D so you have just the bottom and 2 side pieces joined, do not fix the top frame piece at this point.



Fig.06

Step 7: Insert Fence Panels

1. Cut your fence panel pieces to size (720mm).
2. Slide the 10 pieces in from the top to fill your gate frame – Fig.07.



Fig.07

Step 8: Attach Remaining Frame A

1. Slide the second Aluminium Frame A with L brackets attached into the top of the gate until the holes line up with the brackets – Fig.08.
2. Fix in place using Screw D.



Fig.08



Fix The Hinges

Step 9: Attach Hinges

1. On the opposite side frame from the lock, align the Hinge Part A with the first and last joints between the fence panels.
2. Attach each Hinge Part A's with 4 x Screw E and Washers to the gate frame – Fig.09.



Fig.09

Step 10: Position Gate for Hanging

1. Either measure or line up your gate (with Hinge Part B attached) to determine the desired height (and gap at the top/bottom) and thus where Hinge Part B shall be fixed to the post.



Fig.10

Step 11: Install Hinge Part B

1. Once measured and marked, place the L plate of Hinge Part B onto the corner of the post and fix it in place with:
 1. Top Hinge 4 x Screw A – Fig.10
 2. Bottom Hinge 2 x Screw A in the shorter L face and 2 x Screw E in the wider L face (due to ground anchor pole in the post) – Fig.11
3. Note: if fixing to non-composite post, use appropriate screw
2. If you have lined up the gate with hinges attached then you can simply screw them in place with the screws as per above – Fig.12.
3. Where required, slide the gate onto the Hinge Part A and reattach the nut to the end of the adjusting rod (top and bottom)
4. Adjust and tighten the nuts until you are satisfied with the gap between the gate and the post.

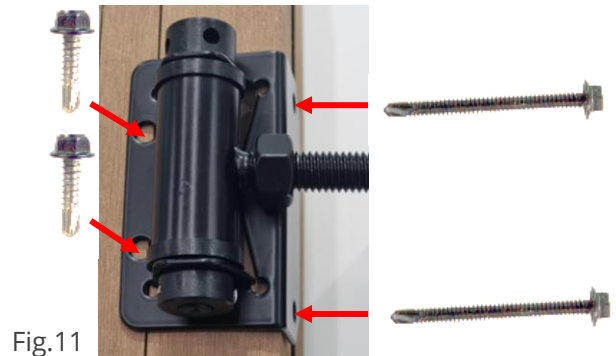

Fig.11



Fig.12



Attach The Lock

Step 12: Install the Lock and Handles

1. Insert the spindle and key barrel into the inside facing handle (has screw holes) ensuring the key slot is facing in the opposite direction to the handle - Fig.13. Then slide them through the pre-drilled holes in the gate frame - Fig.14.
2. Once the key barrel is fully inserted into lock mechanism, use Screw C and a hand screwdriver to fix this in place through the hole on the front of the lock face - Fig.14.
3. Attach the second handle aligning with the spindle on the opposite side and screw the handles in place with 2 x Screw B using a hand screwdriver (not electric) - Fig.15.



Fig.13



Fig.14



Fig.15

Step 13: Install the Striker Plate

1. Line up the striker plate on the post.
2. Fix striker plate (use appropriate screws dependant on head space available and post material - self drilling for composite), then mark out the two areas of material to be removed for the locks - Fig.16.
3. Remove striker plate and create void using a drill, multi-tool or chisel (dep. on material).
4. Reattach the striker plate.

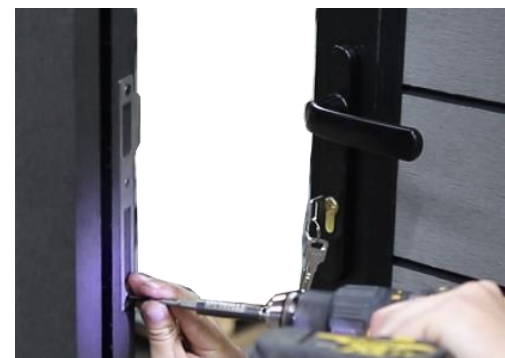

Fig.16





Trellis Topper

Trellis Installation

1. Follow the steps in the fencing install guide for the fencing, until you begin to slide your fence panels into your posts.
2. Slide in 10 fence panels between your 2 posts.
3. On top of the 10th panel slide in the panel cap (ensure you have inserted your fence clips into the end of the panel cap).
4. With the panel cap in place you can now slide the trellis into position in the same post slots.
5. Once in place install your post caps (if you are using composite posts), following the fencing install guide.

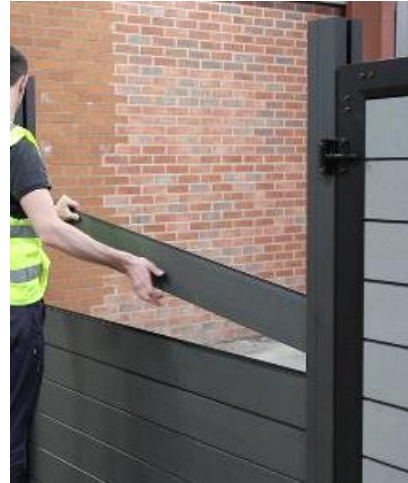



Trellis Topper – High Wind Areas

Trellis Support Channel

1. For high wind areas an additional channel may be required to hold the trellis in place (Aluminium retrofit post channel).
2. Trim the aluminium channel to required length and place on the top of the fence panel on the composite panel cap.
3. Pre-drill holes for fixing screws every 40cm and fix in place with suitable screws.
4. Slot the trellis in place which will now be held in place on 3 sides.
5. Once in place install your post caps (if you are using composite posts), following the fencing install guide.

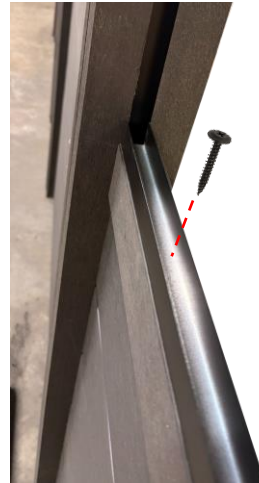



MAINTENANCE & CARE

Hyperion products are low maintenance, however with a little cleaning you can help keep your outside space looking beautiful for longer. Please note that although Hyperion products are relatively colour stable, there may be some initial lightening of the Pioneer range products as the product naturally weathers over the first 8-10 weeks.

Dirt & Grime

Maintaining a clean, dry surface is the best method for combating dirt, grime and mildew build up, where a periodic cleaning is all that maybe required. Even though Hyperion products are formulated to inhibit mildew growth and staining, mildew stains can occur where moisture and dirt or pollen is present.

Scrapes & Scratches

Surface scratches and abrasions will fade after weathering. However, scrape and scratch marks can be eliminated by using a wire brush or coarse 60-80 grit sandpaper (Pioneer range products only). Simply brush/sand in the direction of the grain on the product until the mark has gone. The treated area will weather back in approximately 8-10 weeks.

Painting & Staining

EnviroBuild does not guarantee or recommend anything applied to Hyperion products, however it is still possible for Hyperion products to be painted or stained. Wait until the product has completed its weathering process and ensure you have a clean and dry surface prior to applying any paint or stain. Always apply products in accordance with the manufacturer's application instructions.

Spot Stains

Many stains can be cleaned with soap or household de-greasing agent and warm water. Scrub and soak the affected area as soon as the stain occurs to ensure best results, then rinse off with warm water. For more stubborn stains we recommend using a composite specific cleaner for more effective stain removal. Only with very set stains, you may want to use coarse sandpaper (60-80 grit) and sand lightly (Pioneer range products only), always in the direction of the grain of the product (be careful if sanding the flat wood grained side of the Pioneer decking board as this can remove the enhanced wood grain effect).

Cleaned or sanded areas may lighten, which can require 8-10 weeks exposure to the sun to match the remaining product, depending on location and specific application. Due to the wood content, composite products, like any wood-based product, may experience a naturally occurring process called Extractive Bleeding (known as tea staining). This process can cause a temporary discoloration that will fade with time.

Cleaning

With the proper safety precautions Hyperion products can be washed with either soapy water and a soft bristled brush or with a power washer (recommended max. 1500psi pressure). You should ensure to spray in the direction of the grain of the boards and use a fan tip nozzle (min. 6 inches from surface) along with the proper cleaning product.





Q. What colours do your products come in?

A. Hyperion Fencing comes in a variety of colours. We have the natural browns: Oak and Walnut, then the modern greys: Granite, Stone

Q. Will the colour fade over time?

A. Hyperion products will naturally lighten over the first 8-12 weeks and then will stabilize after this period.

Q. Does the Fencing require treating?

A. Hyperion products are already coloured so do not require painting at all. Also, due to the plastic content within Hyperion products there is no need for any further treatment. This also makes it easy to clean.

Q. How do your products react when exposed to water?

A. Hyperion products are designed to take on very little water (c.1%). Our ranges have a much lower absorption rate than timber which heavily reduces the likelihood of wet rot over a longer period of time.

Q. Do you have recommended installers I can use?

A. EnviroBuild has an extensive network of recommended installers who we trust to bring your plans to reality. We have chosen these installers for their high quality of work and professionalism, but as with any third party, we recommend that you follow your own precautions before entering into a contract with them.

Q. Anything else?

A. For any other technical, installation or care questions, go to www.envirobuild.com, call our technical team on 0208 088 4888, or email us at info@envirobuild.com

Q. Can I see Hyperion Fencing samples?

A. Simply go to www.envirobuild.com to order your free samples.





ENVIRO
BUILD

HYPERION[®]

F E N C I N G

ENVIROBUILD.COM

+44 (0) 208 088 4888

EnviroBuild Materials Ltd. Unit 210, Bon Marche Centre, 241-251 Ferndale Road, London, SW9 8BJ