



ENVIRO  
BUILD

INSTALLATION & MAINTENANCE GUIDE

# HYPERION<sup>®</sup>

C L A D D I N G

EXPLORER



ENVIROBUILD.COM



+44 (0) 208 088 4888

Version 3.2

©EnviroBuild 2025



## CONTENTS

---

<b>Cladding Installation MUST READ</b>	<b>03</b>
Storage & Handling	<b>04</b>
Tools	<b>05</b>
Calculating Materials	<b>06</b>
<b>Spacing Hyperion Composite Cladding</b>	<b>08</b>
Installing Cladding Supports	<b>09</b>
Installation – Horizontal Cladding	<b>11</b>
Installation – Vertical Cladding	<b>14</b>
Installation – Covering Edges & Expansion Gaps	<b>15</b>
Doors and Windows – Fascia Boarding	<b>17</b>
FAQs	<b>19</b>
Maintenance & Care	<b>20</b>

---

It is the customer's responsibility to determine the suitability of Hyperion Cladding for their particular private or commercial installation. It is solely the customer's responsibility to consult with their local building control to determine fire classification project requirements



## ✓ Always leave expansion gaps

- Min. 8 mm gap should be left at board end butt joints to allow material expansion (or min. 0.2% of the length for trimmed boards).
- Min. 20 mm gaps must be left between board edges and solid abutting walls/objects/ground.
- A 20mm expansion gap should be left on runs of cladding >4m
- Not leaving an expansion gap will result in boards warping and will invalidate the warranty.

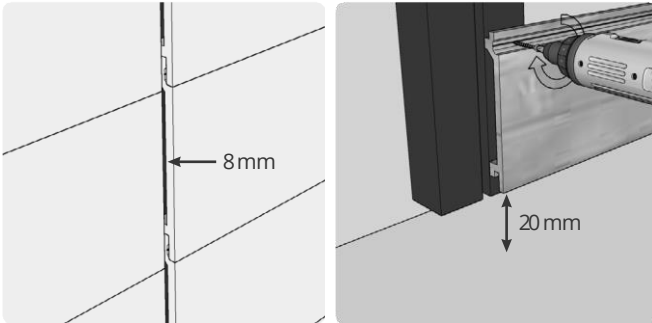

## ✗ Do not share clips between board ends

- A double batten should be used to support both board ends fully.

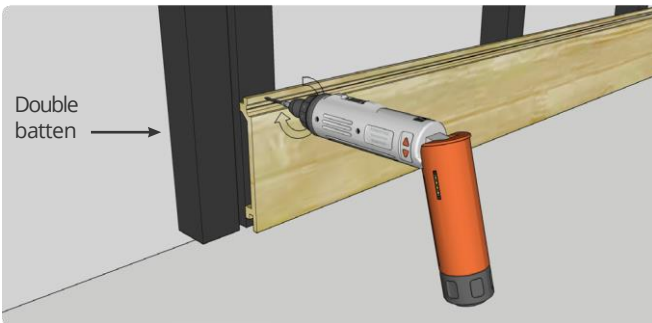

## ✓ Always pre-drill pilot holes

- Ensure the correct sized pilot holes are pre-drilled before screwing into all composite products to avoid splitting (**7mm holes for cladding board fixing screws**).
- Countersink holes in cladding edging profiles for colour matched countersunk screws to avoid product splitting.
- Do not overtighten screws.

## ✓ Use counter battens for vertical cladding

- For vertical cladding, counter battening should be used to allow sufficient drainage and airflow.



## ✓ Be aware of tannins and natural 2-12 month colour fading

- Hyperion Composites contain natural wood oils called tannins.
- Over a period of 2-12 months, tannins are gradually washed out of the wood by rain and moisture and during this process water like marks may appear like in the pictures below.
- Different environmental conditions can cause this process to be faster or slower.
- This is nothing to be worried about and they should disappear after the boards have been wet and dried sufficiently.
- This process makes the boards naturally lighten and will stabilise after the tannins are fully washed out.



This is not the full installation guide. The warranty will only be valid if the full Cladding Installation Guide is followed.



## STORAGE & HANDLING

While composites are highly durable, to ensure their lasting beauty, please follow these important guidelines when storing, moving and working with Hyperion Cladding products



### Storage

- Material should always be covered until it is ready to be installed to maintain a clean surface . If stored outside use a non-translucent material
- All products should be stored flat and level, supported above the ground at 500mm intervals
- Battens used to separate and support any stored cladding material should be spaced no more than 500mm apart, to ensure the boards don't bow
- Stack units with banding and bottom supports aligned
- Pallets of cladding boards should not be stacked more than 4 pallets or 3m in height



### Handling

- Hyperion Cladding materials should be placed and not dumped when unloading
- When removing boards from a unit, lift the boards and set them down, do not slide boards against each other when moving them
- Carry Hyperion Cladding boards on the edge for better support
- During construction, do not slide or drag any equipment across the boards
- The surface of the boards should be kept free of construction material and waste to prevent damage
- As our cladding is quite long we recommend that two people handle the boards during transportation





## Recommended Tools To Install Hyperion Cladding

Standard woodworking tools can be used when working with Hyperion Cladding. If you are unsure on how to use any tool, please consult the tool's manufacturer's user manual

- Circular Saw - we recommend a thin kerf 40-tooth alternate top bevel finish blade to achieve the cleanest cuts. If cutting Manticore plastic battens use a tungsten carbide blade
- Power Mitre Saw can also be useful for efficiency and bevelled edges
- Jig Saw
- Hand Drill - 7mm drill bit
- Impact Driver (Philips Head drill bit supplied in all Hyperion hidden fastening packs, use low torque setting)
- Tape Measure
- Carpentry Square
- Spirit Level
- Safety Glasses and relevant Personal Protection Equipment (PPE)



## CALCULATING MATERIALS

To determine how much Hyperion Cladding material you will require, you can either use detailed plans or follow the method below. Alternatively, feel free to call one of our technical experts for assistance with planning your project by calling 0208 088 4888

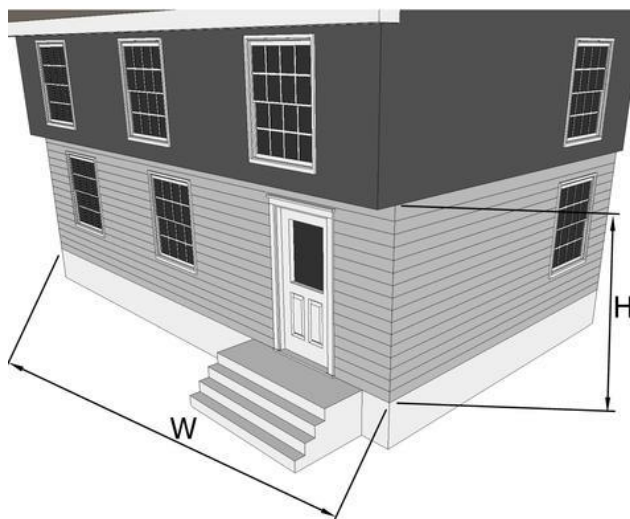

- 1 Start by measuring your proposed cladding area(s) height and width (as above)
- 2 Plan which direction to install your cladding; horizontally or vertically

**The following example will use a Cladding area of 11m wide x 6m high:**

- 3 If the boards are installed horizontally, divide the wall height by the visible width of the board (150mm)

**Height = 6m, then  $6m / 0.15m = 40$  boards high**

- 4 Now multiply the width of the wall by the number of boards high (given above), and divide this number by the longest length of cladding board:

**Width = 11m, then  $(11m \times 40 \text{ boards}) / 4.0m \text{ lengths} = 110$  of the 4.0m boards**

- Always round UP the number of boards required
- If the wall width is less than our 4.0m board and you want no butt joints across the wall, simply order the calculated number of boards high
- For multiple Cladding areas, follow the steps for each above and sum the quantities together

If you have multiple Cladding areas, follow the steps for each above and sum the quantities together



## CALCULATING MATERIALS

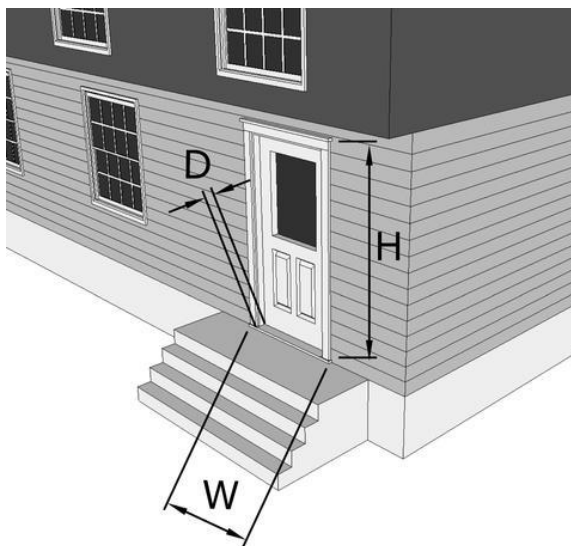

- 5 Now it is time to remove any openings from the cladding board total. If the boards are installed horizontally, divide the opening height by the width of the board (150mm)

**Door Height = 2m, then  $2\text{m} / 0.15\text{m} = 14$  boards high**

- 6 Now multiply the width of the opening by the number of boards high (given above), and divide this number by the longest length of cladding board:

**Door Width = 0.80m, then  $(0.80\text{m} \times 14 \text{ boards}) / 4.0\text{m lengths} = 2.8$  of the 4.0m boards**

- 7 Remove this amount from cladding board total (always rounding DOWN):

**Total amount of boards required =  $110 - 2 = 108$  of the 4.0m boards**

- 8 It is recommended that you add approx. 5% extra material to the total for a scrap factor

You may also require substructure, finishing materials and fixing screws. Below are our quantity recommendations:

- Battens / Joists – Require 9 linear meters per 5m<sup>2</sup> of Cladding
- Fascia Boards and Corner Nosing Trim or Edge board– 2 lengths per 5m<sup>2</sup> of Cladding
- Fixing screws – Require 7 per cladding board (600mm batten centres)

These are best estimates only, for more complex designs and features a drawing to scale may help you determine how many more cladding boards and accessories will be required





## SPACING HYPERION COMPOSITE CLADDING

Ensure the correct sized pilot holes are pre-drilled before screwing into all composite products to avoid splitting. Pre-drilled holes in cladding boards need to be 7mm wide to allow space for thermal expansion of the boards (The flanged screw head is 10mm).

Due to natural expansion and contraction of material with changes in temperature, please ensure the following gapping requirements for all Hyperion Cladding products:

- Butt joints need to be min. 8mm for 4.0m length boards and 6mm for 2.5m length boards. When boards are trimmed down, the expansion gap should be min. 0.2% of the length of the board
- Aluminium batten butt joints should be gapped min.10mm end to end
- Cladding runs require a 20mm expansion space every 4m, can be covered with fascia or drip trays
- A min. 20mm gap is required when abutting walls or other fixed objects
- A min. 20mm gap is required between the lowest board edge and the ground surface
- To allow air ventilation and drainage of rainwater, a cavity of no less than 38mm must be in place

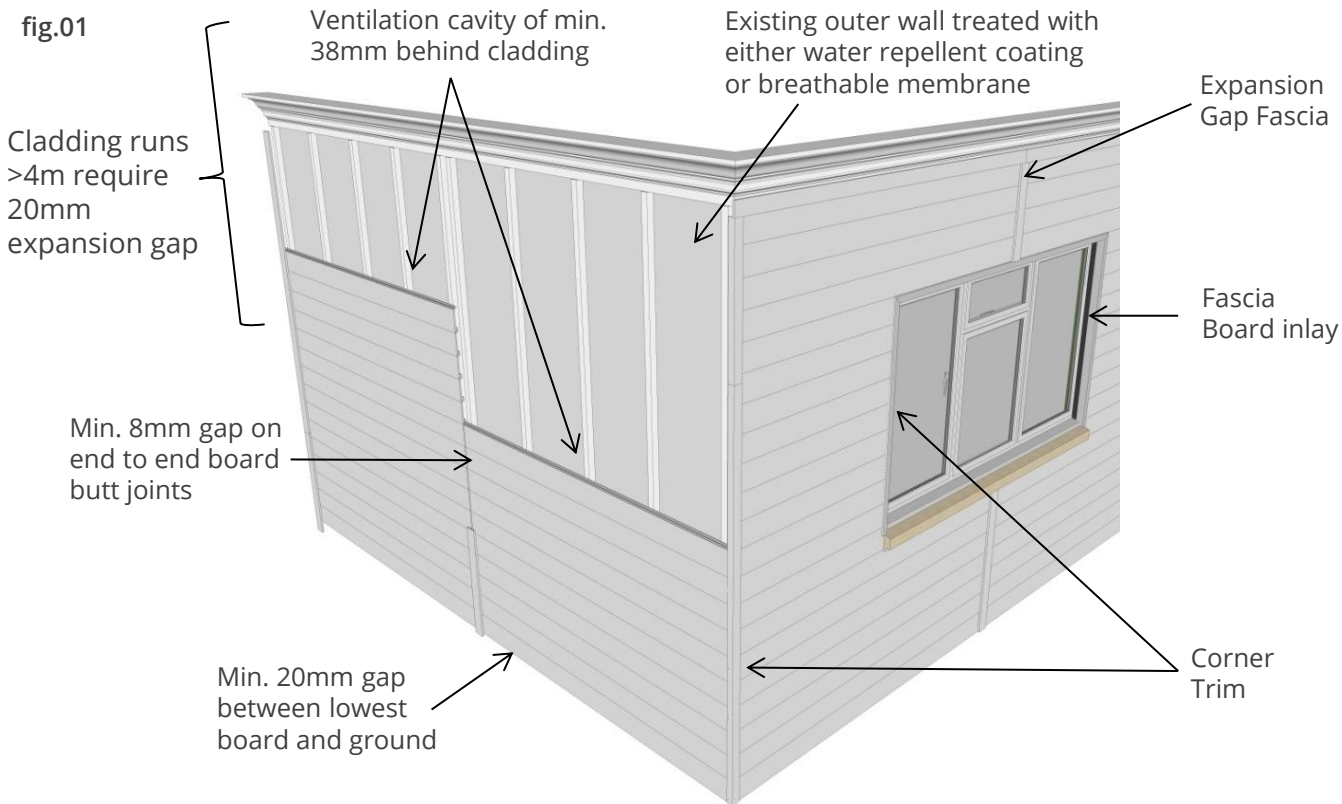



## Planning Cladding Support Structure

Hyperion Cladding may be fixed to a property using the following methods:

1. Preferably screwed to battens attached to sub-frame battening that is fixed separately to the wall; or,
2. Screwed to battens fixed directly to the outer wall once a waterproof membrane/vapour barrier and non-compressible insulation is in place; or:
3. For uneven or non-load bearing walls, the cladding may be fixed to battens on a self-supporting frame

### Waterproof membrane

- A water repellent coating or breathable membrane must be installed before battens are fixed, to protect walls from water penetration (**fig.02**). **If a breathable membrane is used, to ensure the B Class fire rating, it must be min. B Class fire rated to EN13501**
- However if water repellent insulation is used, it is not essential to use a breather membrane between battens fixed to a cavity wall

Hyperion Cladding can be fixed on MESA Aluminium, Manticore Recycled Plastic or treated timber battens.

**To ensure the EN13501 B Class fire rating is achieved MESA Aluminium battens must be used**

- Each batten must be fixed in a minimum of 3 places
- A ventilation cavity of min. 38mm must be in place behind the cladding boards (use battens min. 38mm thick) to allow air ventilation and unrestricted drainage of rainwater that may penetrate cladding
- Any timber used must be pre-treated by an industrial process in accordance with BS8417 for a BSEN335:1. Use Class 3 application - Wood Protection Association Commodity Specification Code: C6 (NBS as Z12/120)
- Insect mesh should be used on cavity openings

fig.02



Water repellent coating or breather membrane

Ventilation cavity of min. 38mm behind cladding

fig.03





## INSTALLING CLADDING SUPPORT BATTENS

1 Fix battens at a maximum of 600mm intervals to the supporting wall or structure (**fig.04**)

- For vertical cladding, we recommend using counter battening to allow sufficient airflow (**fig.03**). For more about vertical cladding please see **p.09**

2 If the optional drip tray is being used to cover the bottom of cladded area and send water away from the building, it should be fixed to the wall with suitable screws (not supplied by EnviroBuild) and the battens fixed over the top of the drip tray profile (**fig.05**)

3 The first batten should be installed min. 20mm from the ground (no starter tray required)

- Using suitable A2/A4 stainless steel countersunk screws, fix the battens into position at max. 600mm centres
- Ensure all battens are level to the wall surface, using packers where appropriate
- A double batten structure should be installed for cladding board ends (butt joints)

4 Install additional wall battening around windows and doors (**fig.06**)

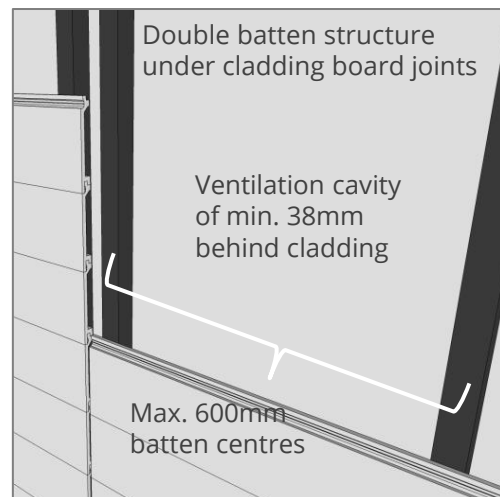

fig.05

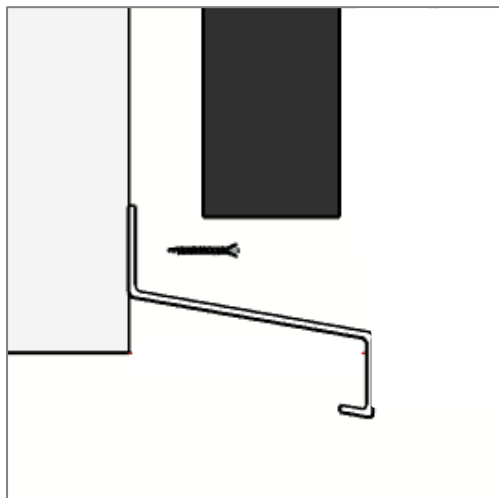
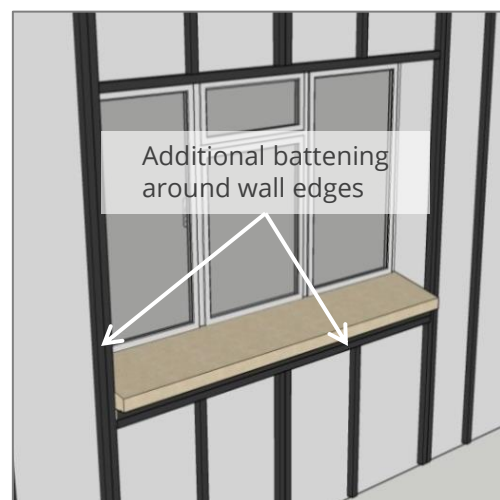

fig.06





## INSTALLATION - HORIZONTAL CLADDING

### Before You Start

Hyperion Explorer Cladding boards can be installed using screws alone (**option 2**), however for extra security you can also install the cladding using the starter rail on the first board (**option 1**)

### Option 1: Installing The First Board Using Starter Rails

If not using the Starter Rail please move to **Option 2**

- 1 Mark level lines on the battens for the starter rail installation, the bottom of the starter rail should sit 20mm or above the ground surface to ensure the board will sit a min. 20mm above the ground (**fig.07**)
  - If the optional insect mesh is being installed this can be fixed in place with the clip rail screws
  - Ensure the starter rail is level
  - Either use self drilling screws or pre-drill screw holes at each batten and fix in place with screws
- 2 Once the starter rail has been installed push the cladding board into the rail (**fig.07**)
- 3 Secure the top of the board:
  - Pre-drill 7mm screw holes in the centre of the cladding board fixing channel (to allow for material expansion – flanged screw head is 10mm). These holes should line up with the supporting battens (**fig.09**)

fig.07

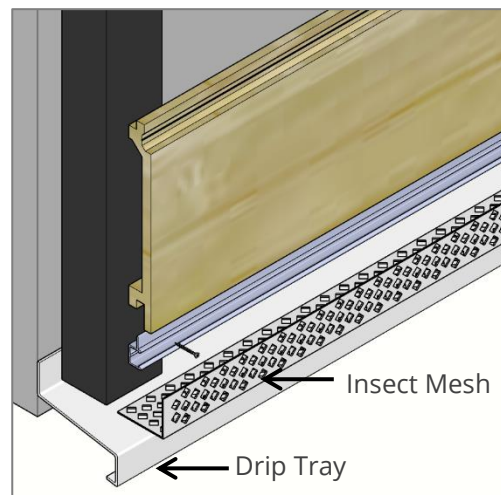

fig.08

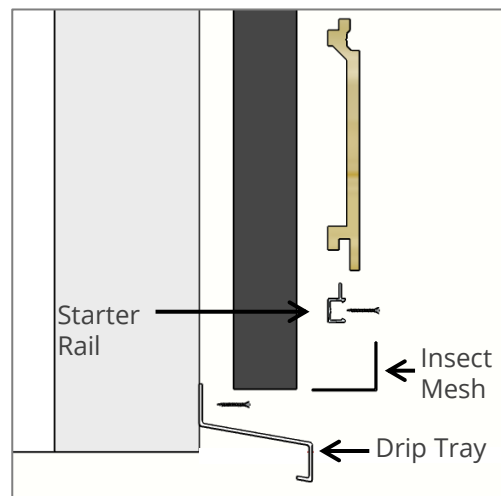
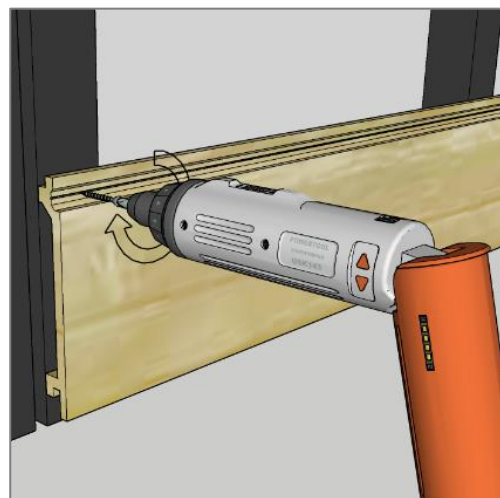

fig.09





## INSTALLATION - HORIZONTAL CLADDING

- Fix to the batten using the Hyperion Flanged head screws through the pre-drilled holes; be careful not to over tighten the screws (**fig.09**)

- 4 Once the first board is in place please **move on to step 1-3 on p.12**

### Option 2: Installing The First Cladding Board Without Rails

Explorer composite cladding boards are rigid enough to be installed without the starter rail.

- 1 Mark level lines on the battens for the first (lowest) board to be installed, ensuring the board will sit min. 20mm off the ground surface (**fig.10**)
- 2 Pre-drill 7mm screw holes in the centre of the cladding board fixing channel (to allow for material expansion). These holes should line up with the supporting battens
  - Place the bottom cladding boards in position
  - Fix to the batten the Hyperion Flanged head screws through the pre-drilled holes; be careful not to over tighten the screws (**fig.11**)
- 3 Once the first board is in place please **move on to step 1-3 on p.12**

fig.09

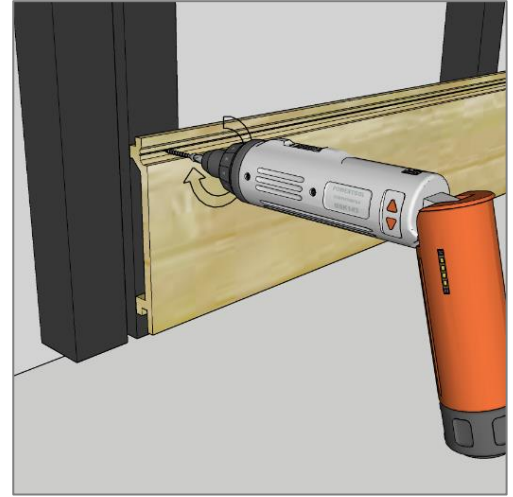

fig.10

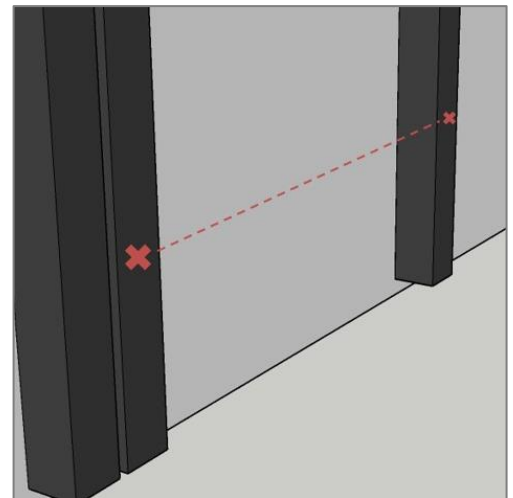
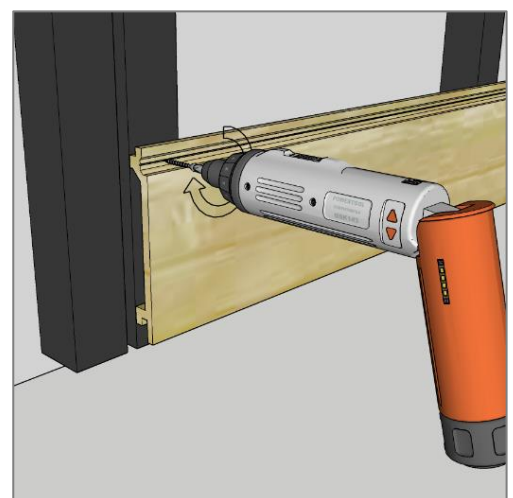

fig.11





## INSTALLATION - HORIZONTAL CLADDING

### Installing The Remaining Boards

- 1 Once the first board is secured, line up the next board and slide into place.
  - Pre-drill 7mm screw holes in the centre of the cladding board fixing channel (to allow for material expansion). These holes should line up with the supporting battens
  - Place the next cladding boards in position and fix the Hyperion Flanged head screws through the pre-drilled holes; be careful not to over tighten the screws (**fig.06**)
  
- 2 Repeat step 1, fixing all boards until the top (or side for vertical) edge of the wall or once you create a run of 4m of cladding.
  - Check the board is level before each board is fixed. Slight adjustments may be required (**fig.07**)
  - For cladding runs >4m you will need to leave a min.20mm expansion gap then start a new run as per steps on **p.11**. The expansion gap can be covered by fascia **p.15** or on horizontal runs by the drip tray (**fig.08**)
  
- 3 Around objects such as doors and windows you may be required to shape boards to fit (**fig.08**)
  - It is suggested to use fascia boards where horizontal cladding meets a roofline, window ledge or is going to butt up against a horizontal edge.

fig.12



fig.13



fig.14





## INSTALLATION - VERTICAL CLADDING

### Vertical Cladding Supports

For vertical cladding, we recommend using counter battening to allow sufficient drainage and airflow (**fig.15**).

### Vertical Cladding Installation Steps

- 1 Always start your installation from the corner or edge of the design (**fig.15**)
- 2 Mark level lines on the battens for the first board to be installed, ensuring the board will sit min. 20mm off the ground surface
  - If using the starter rail, follow **steps 1-2 on p.10**
- 3 Once secure, place the next cladding board in place and repeat this process, (**fig.16**). Fix all boards until the end of the wall

### Finishing Corners and Windows.

To finish off your vertical cladding around corners you will need to use Hyperion Corner Trim;

- Hyperion Corner Trim and Fascia Board can be used to finish corners, doors and window frames (**fig.17**)
- For more about finishing with Corner Trim and Fascia Board see **p.15-16**
- **Do not fix corner trim or fascia boards with adhesive of any kind, this is not a permanent fixing solution and will void your warranty**

fig.15

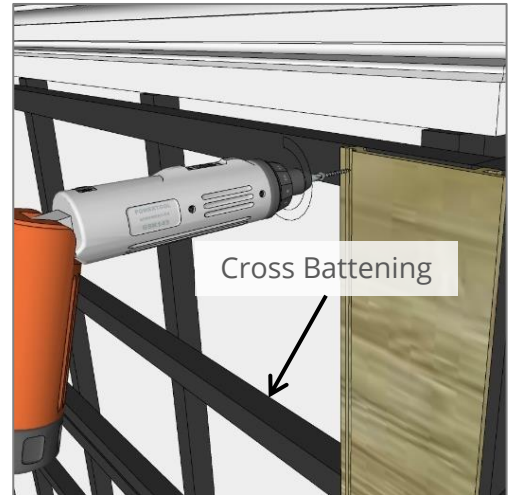
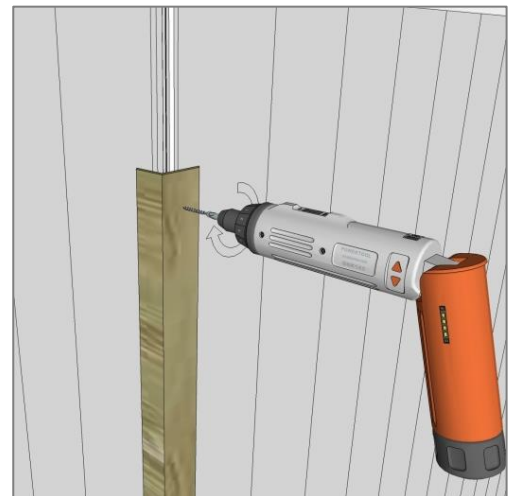

fig.16



fig.17





## INSTALLATION - FINISHING EDGES

### Covering Top Gaps

- 1 Install a Hyperion Fascia Board to finish off and cover the top cladding board fixing groove (horizontally installed cladding only) (**fig.18**)

- Cut down the Hyperion Fascia boards to size
- Place over the groove of the top cladding board
- Pre-drill through the board and countersink
- Screw into place with Hyperion countersunk colour matched screws

fig.18



### Covering Corners

- 2 Install Hyperion Corner Nosing Trim to cover corners/edges (**fig.19**)

- Cut down the Hyperion Corner Trim to size
- Place over the corner to cover, pre-drill through the trim and countersink – **screw holes should be placed either where there is battening behind to take the screw or where cladding boards overlap**
- Screw into place with Hyperion countersunk colour matched screws

fig.19

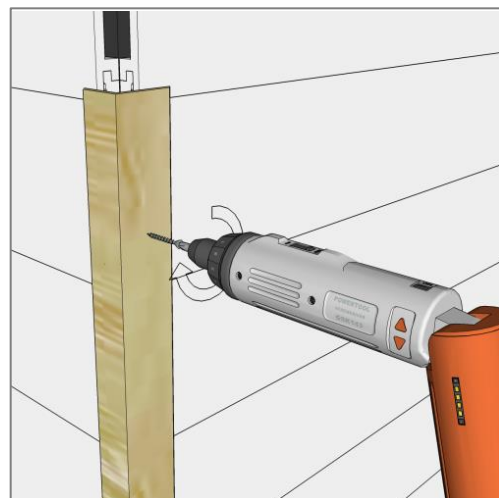



## Fascia Covering

- 1 If required, you can use Hyperion Fascia Board to cover cladding board expansion gaps (**fig.20**)
  - Cut down the Hyperion Fascia boards to size
  - Place over the expansion gap to cover
  - Pre-drill through the board and countersink
  - Screw into place with Hyperion countersunk colour matched screws (**fig.21**)
  - For any openings to the ventilation cavity insect mesh should be installed

fig.20



fig.21

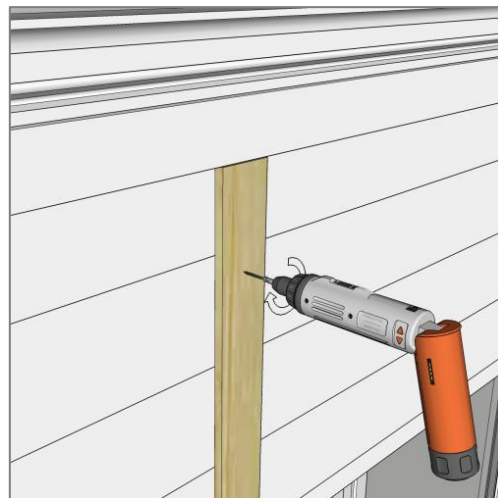

## Drip Tray for Horizontal Expansion Gap Cover

- 1 The drip tray can be used as a cover for horizontal expansion gaps whether the boards are running vertically or horizontally.
  - With the lower cladding run installed up to 4m, fix the drip tray level to the supporting wall so it covers the cladding run top edge (**fig.22**)
  - Install the upper cladding run (**P.11**) with the drip tray fixed in place (**fig.22**)

fig.22

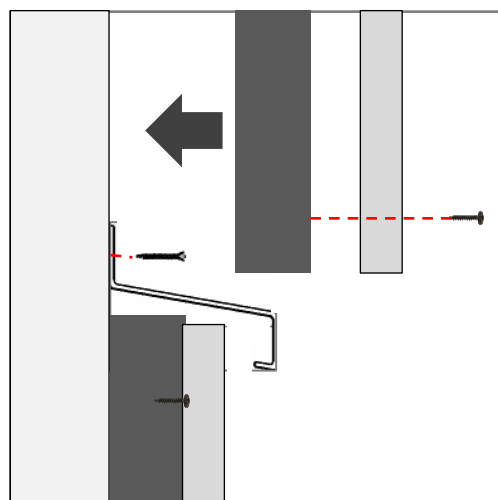



## Before You Start

Additional battening is required around doors and windows, more battening may be required depending on your finishing option (**fig.23**).

It is suggested to use fascia boarding anywhere where horizontal cladding meets a roofline, window ledge or is going to butt up against a horizontal edge/barrier.

fig.23

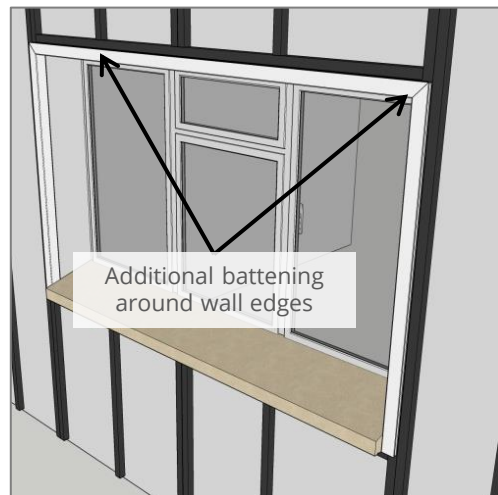

## Option 1. Hyperion Fascia Boarding **fig.24**

Hyperion Fascia Board can be used to cover the cladding board edges and around window frames. This option can also be paired with corner trim around window frames and doors

- 1 Measure the amount of fascia boarding required and cut down to size.
- 2 Place over the desired area. Make sure the edge of the fascia board sits flush with the cladded surface (**fig.24**)
- 3 Pre-drill and countersink the board
- 4 Screw into place with Hyperion countersunk colour matched screws
- 5 If desired the corner trim can then be placed over the fascia boards (**fig.25**)

fig.25

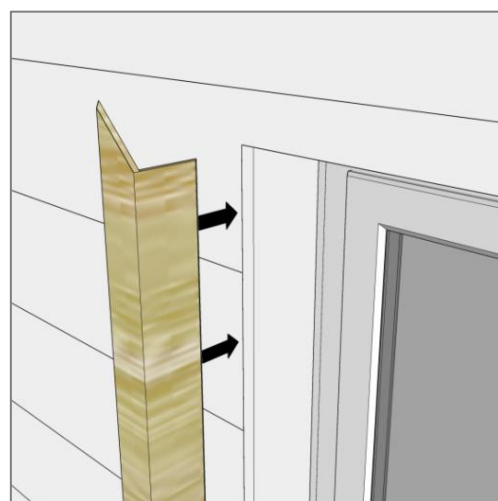
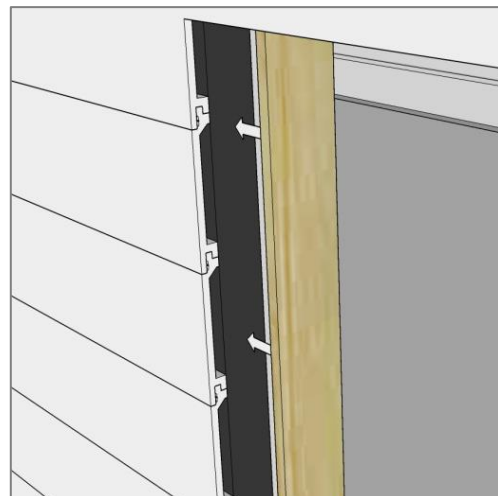



## Option 2. Hyperion Corner Trim

Hyperion Corner Trim can be used on its own or with Hyperion Fascia Boards to cover cladding board edges and exposed substructure at corners, doors and window frames

- 1 Measure the required amount of Hyperion Corner Trim and cut down to size
- 2 Mitre down at 45 degrees, Corner Trim ends if being placed next to each other at wall edges **(fig.26)**
- 3 Place over the corner to cover, pre-drill and countersink through the trim **(fig.26)**
- 4 Screw into place with Hyperion countersunk colour matched screws **(fig.27)**

Corner Trim can be combined with Fascia Boards to cover deeper window and door frames **(fig. 28)**

fig.26

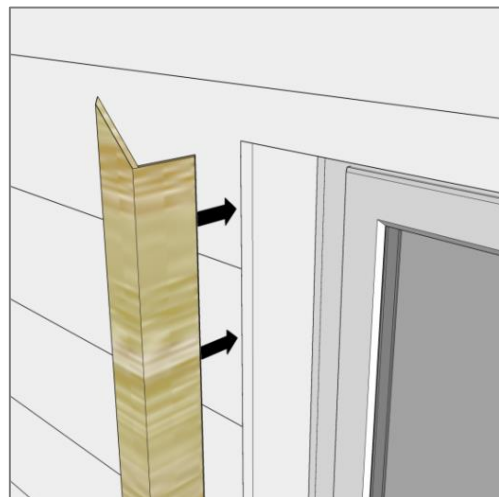

fig.27

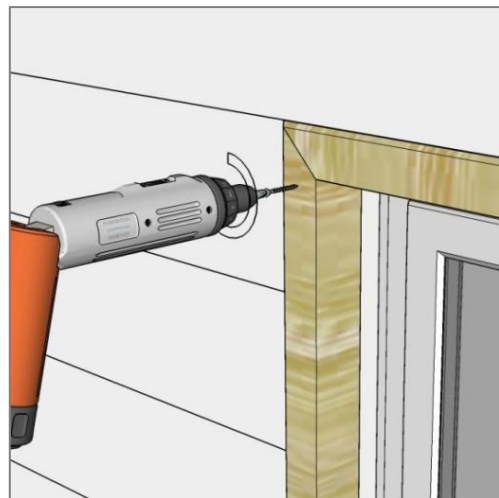
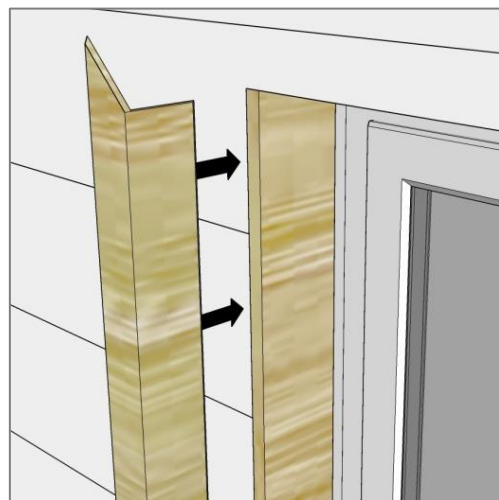

fig.28



**Q. Where can I use Hyperion Cladding?**

A. The versatile Hyperion product range can be used in a variety of locations, both residential and commercial. However as this is an external building covering, you must ensure you consult with your local building control to determine fire classification project requirements. **Hyperion Explorer Cladding is classified B-s3, d0 Reaction to Fire (EN13501-1).**

**Q. What colours do your products come in?**

A. Hyperion Cladding comes in a variety of colours. We have the natural browns: Oak and Walnut, then the modern greys: Granite, Stone and Silver Birch.

**Q. Will the colour fade over time?**

A. Hyperion Explorer products will naturally lighten over the first 8-10 weeks and then will stabilize after this period.

**Q. How do your products react when exposed to water?**

A. Hyperion products are designed to take on very little water (c.1%). The products have a much lower absorption rate than timber which heavily reduces the likelihood of wet rot over a longer period of time.

**Q. Does the cladding require painting/treating?**

A. Hyperion products are already coloured so do not require painting at all. Also, due to the plastic content within Hyperion products there is no need for any further treatment. This also makes it easy to clean.

**Q. Do you have recommended installers I can use?**

A. EnviroBuild has an extensive network of recommended installers who we trust to bring your plans to reality. We have chosen these installers for their high quality of work and professionalism, but as with any third party, we recommend that you follow your own precautions before entering into a contract with them.

**Q. What size boards does Hyperion Cladding come in?**

A. Hyperion Cladding boards come in 2.5 and 4.0m length boards. Bespoke length boards can be ordered subject to minimum order quantity and extra lead times.

**Q. Does the cladding use a starter rack?**

A. Hyperion Cladding boards do not require a starter rail, clips or fasteners. However for extra security you can also install the cladding using the starter rail on the first board.

**Q. Anything else?**

A. For any other technical, installation or care questions, go to [www.envirobuild.com](http://www.envirobuild.com), call our technical team on 0208 088 4888, or email us at [info@envirobuild.com](mailto:info@envirobuild.com)

**Q. Can I see Hyperion Cladding samples?**

A. Simply go to [www.envirobuild.com](http://www.envirobuild.com) to order your samples.



## MAINTENANCE & CARE

Hyperion products are low maintenance, however with a little cleaning you can help keep your outside space looking beautiful for longer. Please note that although Hyperion products are relatively colour stable, there may be some initial lightening as the product naturally weathers over the first 8-10 weeks.

With the proper safety precautions Hyperion products can be washed with either soapy water and a soft bristled brush or with a power washer (recommended max. 1500psi pressure). You should ensure to spray in the direction of the grain of the boards and use a fan tip nozzle (min. 6 inches from surface) along with the proper cleaning product.

### Dirt & Grime

Maintaining a clean, dry surface is the best method for combating dirt, grime and mildew build up, where a periodic cleaning is all that maybe required. Even though Hyperion products are formulated to inhibit mildew growth and staining, mildew stains can occur where moisture and dirt or pollen is present.

### Spot Stains

Many stains can be cleaned with soap or household de-greasing agent and warm water. Scrub and soak the affected area as soon as the stain occurs to ensure best results, then rinse off with warm water. For more stubborn stains we recommend using a composite specific cleaner for more effective stain removal. Only with very set stains, you may want to use coarse sandpaper (60-80 grit) and sand lightly (Pioneer range products only), always in the direction of the grain of the product.

Cleaned or sanded areas may lighten, which can require 8-10 weeks exposure to the sun to match the remaining product, depending on location and specific application. Due to the wood content, composite products, like any wood-based product, may experience a naturally occurring process called Extractive Bleeding (known as tea staining). This process can cause a temporary discoloration that will fade with time.

### Scrapes & Scratches

Surface scratches and abrasions will fade after weathering. However, scrape and scratch marks can be eliminated by using a wire brush or coarse 60-80 grit sandpaper (Pioneer range products only). Simply brush/ sand in the direction of the grain on the product until the mark has gone. The treated area will weather back in approximately 8-10 weeks.

### Painting & Staining

EnviroBuild does not guarantee or recommend anything applied to Hyperion products, however it is still possible for Hyperion products to be painted or stained. Wait until the product has completed its weathering process and ensure you have a clean and dry surface prior to applying any paint or stain. Always apply products in accordance with the manufacturer's application instructions.





ENVIRO  
BUILD

# **HYPERION<sup>®</sup>**

C L A D D I N G

ENVIROBUILD.COM



+44 (0) 208 088 4888