

5 51 534 0

Basis Wave slide broad, ph 200 cm

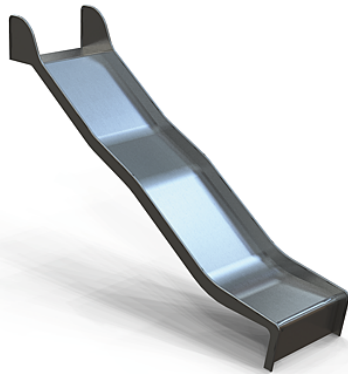





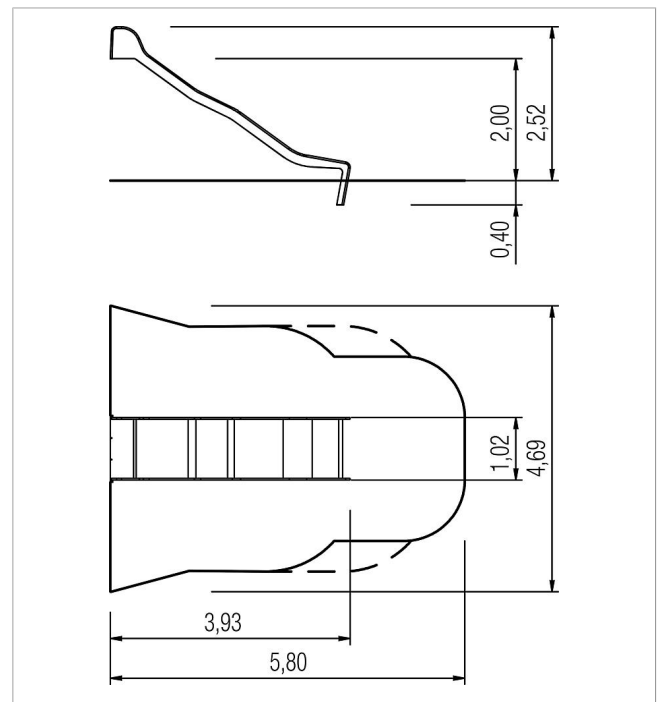

made in germany



Scope of delivery

1x slide ph 200 cm: stainless steel

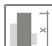

	Material	Stainless steel
	Foundation level	FL 1
	Minimum space	5,80x4,69x3,80 m
	Free falling height	200 cm
	Impact protection net	21,0 m ²
	Foundations	2x CF or 2x PFs + 1x CF
	Assembly	2 persons/3 h
	Largest section	435x100x70 cm
	Heaviest section	139 kg