

5 55 008 5

unique hexagonal system 270







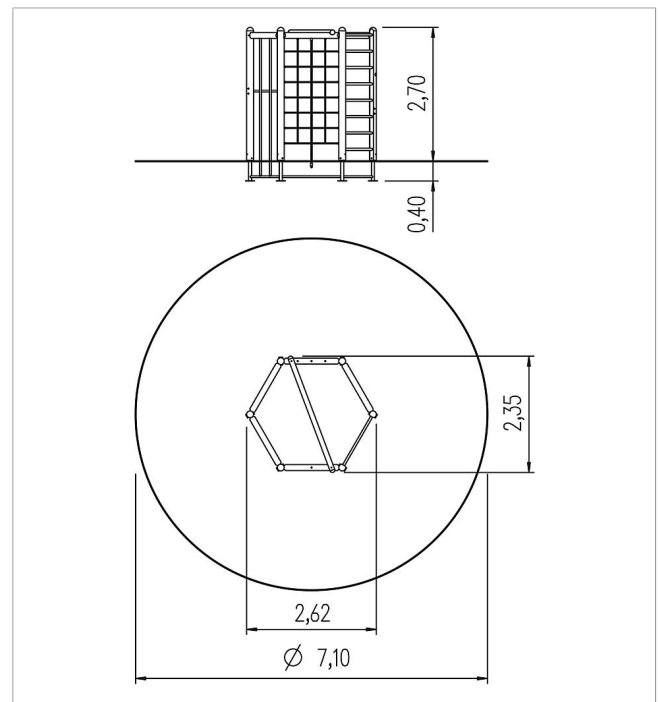

made in germany



Scope of delivery

1x rung element: SW, ash
 2x horizontal bar: galvanised and powder-coated steel
 2x fireman"s pole: powder-coated steel
 1x climbing net: polyester-coated steel cable
 1x climbing rope: polyester-coated steel cable
 wood structure H 260 cm: SW
 post shoes: galvanised steel

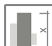

	Material	SW pi
	Foundation level	FL 1
	Minimum space	7,17x6,82x2,70 m
	Free falling height	265 cm
	Impact protection net	39,0 m ²
	Foundations	7x CF or 7x PFs
	Assembly	2 persons/3 h
	Largest section	310x139x14 cm
	Heaviest section	140 kg