

5 55 309 5







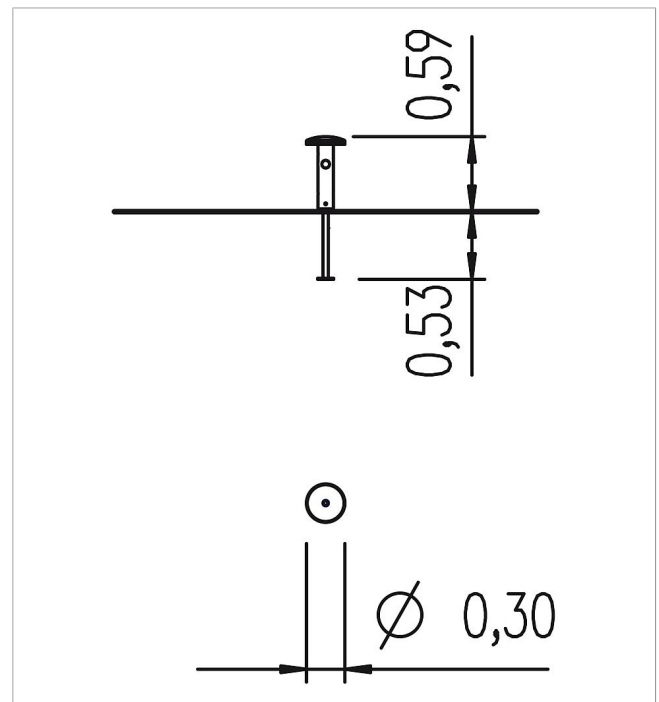

**balance jump-over
mushroom Square
Dance**
made in germany

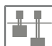

Scope of delivery

1x standing posts: SW
1x mushroom head: GFRP
1x post shoe: galvanised steel



	Material	SW pi
	Foundation level	FL 1
	Minimum space	Ø 0,30x2,39 m
	Free falling height	59 cm
	Impact protection net	-
	Foundations	1x CF
	Assembly	1 person/0.2 h
	Largest section	56xØ 30 cm
	Heaviest section	6 kg