

5 54 049 0

**fit active-station  
combination III  
abdomen & back**



made in germany

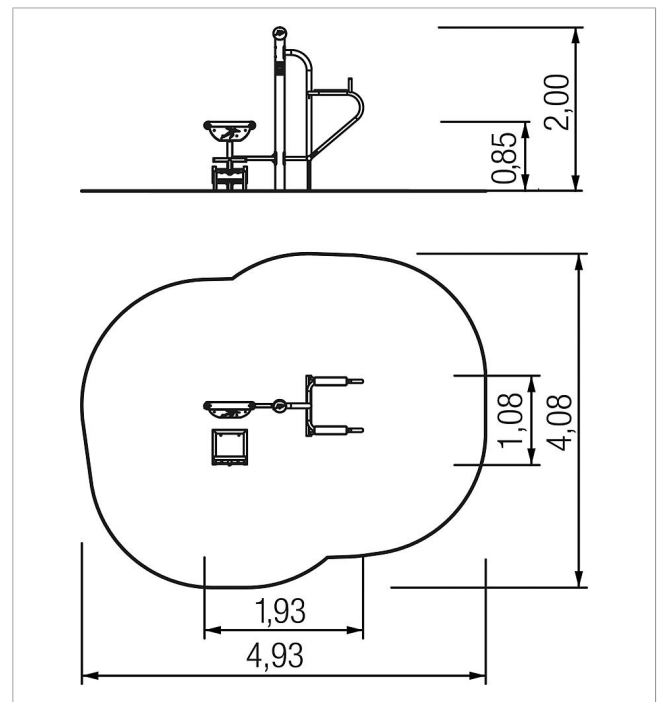

**Scope of delivery**

1x active-station combination: stainless steel, high pressure laminate (HPL), HDPE

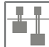

	Material	VA, HPL, HDPE
	Foundation level	FL 2
	Minimum space	4,93x4,08x3,80 m
	Free falling height	120 cm
	Impact protection net	4,5 m <sup>2</sup>
	Foundations	1x CF