

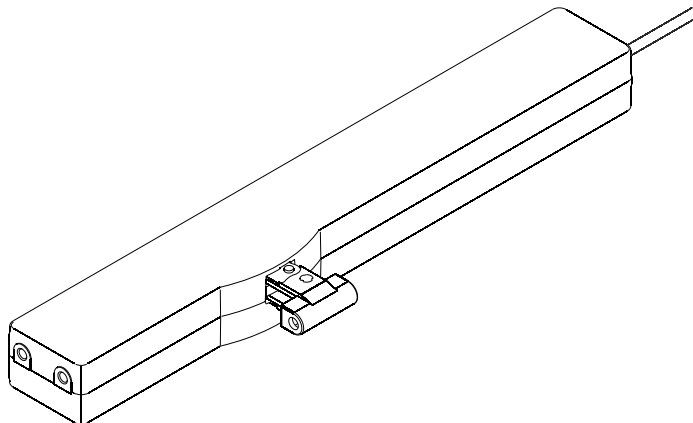

VCD 203 instructions



CE



Please order bracket sets separately



WARNING

Read all safety warnings, instructions, illustrations and specifications provided with this product. Failure to follow all instructions listed below may result in electric shock, fire and/or serious injury. Save all warnings and instructions for future reference.

Safety notes

Safety extra low voltage 24 V DC!

Do not connect directly to the mains supply!

- Connection has to be carried out only by an authorized electrical specialist
- Danger of violent pressure in handaccessible area
- Keep away People from the operating area of the drive
- Keep away children from the control
- Use only in dry rooms
- Only for inside mounting.
Use rain detector with danger of rain (e.g. at domelights or roof windows)
- Just use unchanged original D+H parts
- Observe mounting instructions of bracket set!

Observe enclosed red safety slip!

TMS+ / -BRV function

Up to two VCD 203 drives and one locking drive can be used in tandem. Combined TMS and BRV signal. The BRV signal is only output when in the end position - this prevents locking drives and modules from malfunctioning.

During the learning phase, the activated stroke is transferred to the tandem drive via the TMS+ function.

Guarantee

You will get 2 years guarantee for all D+H products from date of verified handing over of the system up to maximal 3 years after date of delivery, when mounting and starting has been carried out by an authorized D+H-distributor.

D+H guarantee is expired, with connection of D+H components with external systems or with mixing of D+H products with parts of other manufacturers.

Intended use

- Chain drive for electric opening and closing of windows and flaps in the facade and roof area
- Useable for daily natural ventilation
- Operating voltage 24 V DC
- Only for inside mounting

Performance features

- Microprocessor controlled electronics
- Individually programmable via Powerline (PLP1 and SCS)
- Stroke programming with magnets
- Low running noises
- Connection via plug connector
- Tandem-safety function for operation of two VCD 203 drives on one sash

Extent of supply

Drive unit with 2,5 m PVC cable. Dependent on the type of window, different bracket sets are available separately.

Maintenance and cleaning

Maintenance work is only allowed when the device is in a de-energized condition! Inspection and maintenance has to be carried out according to D+H maintenance notes. Only original D+H spare parts may be used. Repair is to be carried out exclusively by D+H.

Wipe away debris or contamination with a dry, soft cloth.

Do not use cleaning agents or solvents.

Declaration of Conformity

We declare under our sole responsibility that the product described under "Technical Data" is in conformity with the following directives:

2014/30/EU, 2014/35/EU

Technical file at:

D+H Mechatronik AG, D-22949 Ammersbek

Dirk Dingfelder
Member of the Board
24.02.2016

Maik Schmees
Authorized signatory, Technical Director

Technical data

Type	VCD 203
Power supply	24 V DC / $\pm 20\%$
Nominal current	0,35 A
Nominal force	200 N
Nominal locking force	approx. 2000 N (Excluding bracket)
Service life	>20 000 double strokes
Duty cycle	30 % (With cycle time 10 minutes)
Housing	Zinc-diecasting, powdercoated
Ingress protection	IP 30
Temp. range	0 ... +60 °C
Emission sound pressure level	$L_{pA} \leq 70$ dB(A)
Nominal stroke length * / **	250 mm
Additional functions **	Closing edge protection activated (3 stroke repetitions); Locking relief activated
*Adjustable with PLP 1 ** Programmable with PLP 1 and SCS	

Running speed and forces

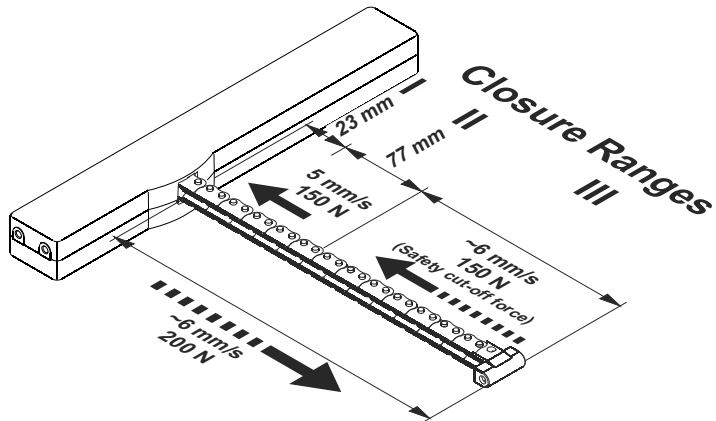

All forces + approx. 20 % switch-off reserve (temporary)

Closing edge protection

In the "CLOSE" direction the drive has an active protection for the main closing edge. If there is an overload in the closing ranges 3 and 2, the drive runs "OPEN" for 20 seconds, then "CLOSE" again. If closing is not possible after three attempts, the drive remains in this position.

In addition, the drive is equipped with passive protection. The closing speed in closing range 2 and 1 is reduced to 5 mm/s.



Significantly greater forces can be exerted at the secondary closing edges.
Danger of crushing hands and fingers!

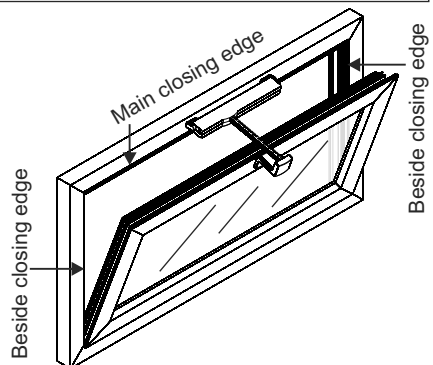

Stroke limiting with magnets



When using two VCD 203 on one window, both drives must be electrically connected in order to set the stroke, although only one drive needs to be switched to the stroke learning mode with the magnet.

1 Close drive.

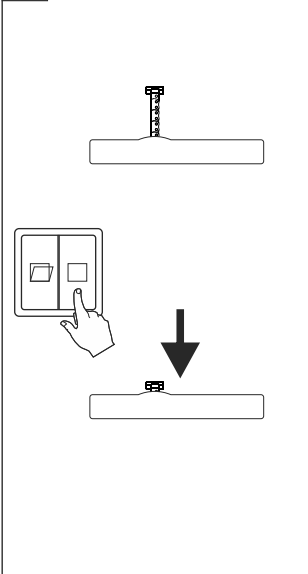

2 Voltage must continue to be applied to the drive when moving in the "CLOSE" direction. Hold the magnet next to the drive as shown in the diagramme (2 sec.) until you hear a pulsating ton > The drive is now in learning mode. The magnet can now be removed and the drive no longer has to be under voltage.

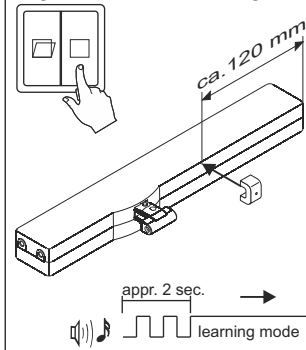

3 Allow the drive to run "OPEN" until you reach the required stroke. If the stroke is set incorrectly, the procedure is accidentally interrupted or the drive continues to the full stroke length, please return to point 1 and start again.

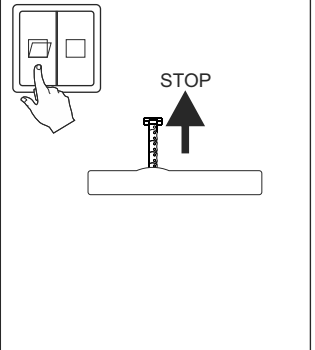

Disposal

Electrical devices, accessories, batteries and packaging should be sorted for environmental-friendly recycling. Do not dispose electrical devices and batteries into household waste!

Only for EC countries:

According the European Guideline 2012/19/EU for waste electrical and electronic equipment and its implementation into national right, electrical devices that are no longer usable must be collected separately and disposed of in an environmentally correct manner.



Pin Assignment

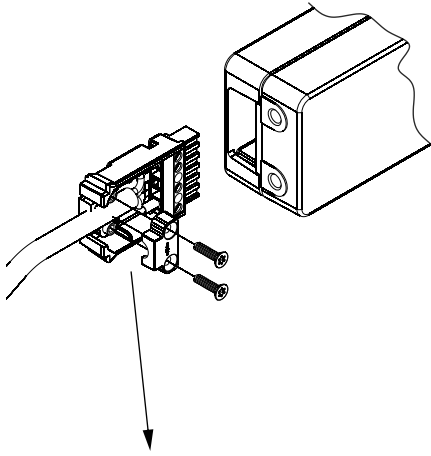

Mot. a (WH)
Mot. b (BN)

	+	-
	-	+

(BN) brown
(YE) yellow
(GN) green
(WH) white
(PK) pink
(GR) grey

Standard

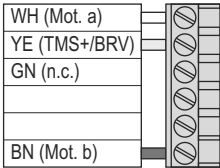

Optional signals

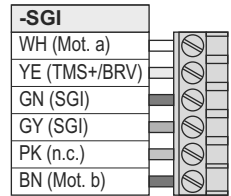
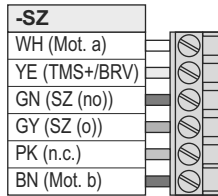
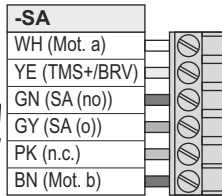

max. 50 V / 0,5 A

max. 50 V / 0,5 A

Connection

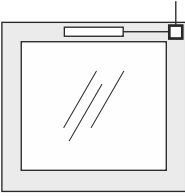

1 drive

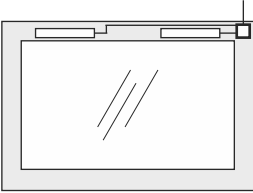
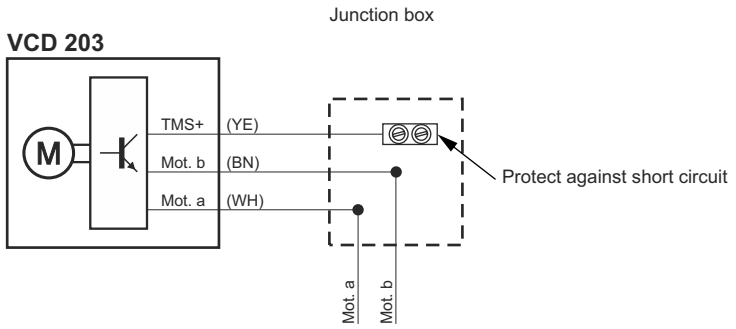

max. 2 drives

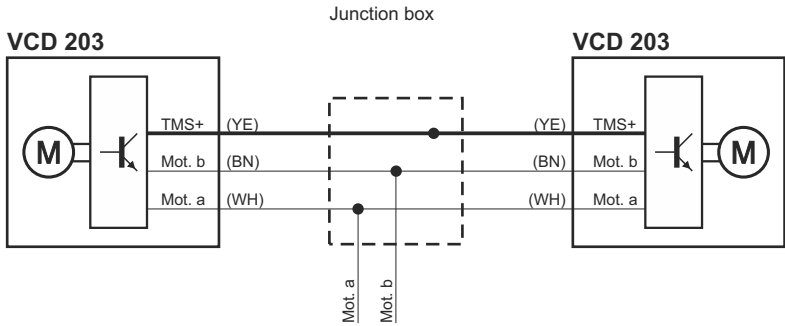

Dimensions

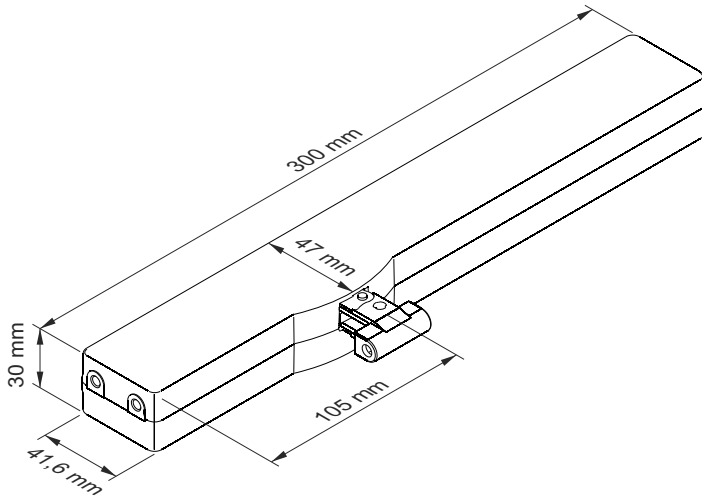

Dyer Environmental Controls Ltd
Unit 10 Lawnhurst Trading Estate, Cheadle Heath,
Stockport SK3 0SD

Tel: +44 (0)161 491 4840
E-Mail: enquiry@dyerenvironmental.co.uk

www.dyerenvironmental.co.uk