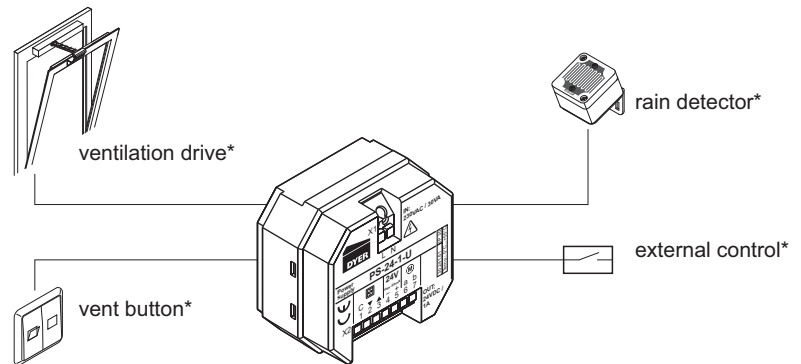
**Example for Application**

* optional function extension (separate components retrofitable)

WARNING

Read all safety warnings, instructions, illustrations and specifications provided with this product.
Failure to follow all instructions listed below may result in electric shock, fire and/or serious injury.
Save all warnings and instructions for future reference.

Intended use

- Compact ventilation control for separate rooms and conservatories
- For triggering of 24 VDC drives
- 1 ventilation group
- 1 A total actuating current
- Ventilation safety function (key operation OPEN/CLOSE)
- Possibility of connecting rain detector or wind/ rain detector
- For installation in branch box provided on site
- Only for inside mounting

Safety notes

Operating voltage 230 V AC!
Risk of injury from electric shock!
Connection must be carried out by a certified electrical technician.

- Use only in dry rooms.
- Do not lay 24 V DC and 230 V AC cables in the same cable duct!
- Use unmodified original parts only.
- Observe the drive instructions for use.

Technical Data

Type	: PS-24-1-U
Power supply	: 230 V AC 50 Hz
Power	: 30 VA
Class of rating	: short-time duty, 20%
Output	: 24 V DC, max. 1 A
Ripple	: <= 1%
Ingress protection	: IP 30
Temp. range	: -0 ... +50 °C
Housing	: plastic
Dimensions	: 50 x 48 x 28 mm WxHxD

Maintenance and cleaning

Maintenance work is only allowed when the device is in a de-energized condition! Inspection and maintenance has to be carried out according to D+H maintenance notes. Only original D+H spare parts may be used. Repair is to be carried out exclusively by D+H.
Wipe away debris or contamination with a dry, soft cloth.
Do not use cleaning agents or solvents.

Disposal

Electrical devices, accessories, batteries and packaging should be sorted for environmental-friendly recycling.
Do not dispose electrical devices and batteries into household waste!
Only for EC countries:
According to the European Guideline 2012/19/EU for waste electrical and electronic equipment and its implementation into national right, electrical devices that are no longer usable must be collected separately and disposed of in an environmentally correct manner.



Connection



Overall group operation

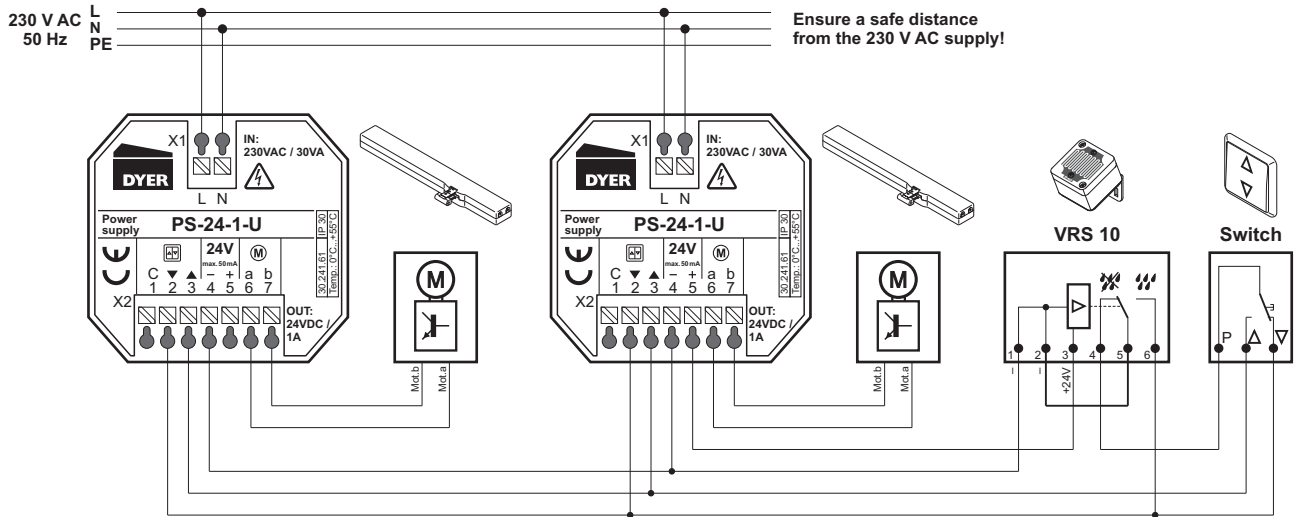

Individual switch control of each window with group rain sensor override

