

# D298.PF Bronze Strainer

## Features & Benefits

- Strainer complete with Press-Fit connectors
- Helps prevent damage to pipeline equipment caused by scale and dirt
- Supplied as one integral unit means less joints to make on-site
- The performance, exact dimensions & tolerances are known in advance
- Incorporates both Crane Fluid Systems and proven Geberit Mapress technology
- Vibration tested to DVGW and bend tested to BS EN331
- Quickly and easily installed using a Press-Fit tool (supplied by others)



## Materials

NO.	COMPONENT	MATERIAL	SPECIFICATION
1	Body	Bronze	BS EN 1982 CC491K
2	Mesh	Stainless Steel	AISI Type 304
3	Cap Seal	P.T.F.E	WRAS Approved
4	Cap	Bronze	BS EN 1982 CC491K
5	Press-Fit Connector	Bronze	BS EN 1982 CC499K
6	Joint 'O' Ring	EPDM Rubber	WRAS Approved
7	Connector 'O' Ring	CIIR Butyl Rubber	WRAS Approved

## Dimensions & Weights

SIZE (MM)	DIMENSIONS (MM)										WEIGHT (KG)
	MESH HOLE Ø	A	B	C	D	E	F	G	H	ØJ	
½ x 15	0.75	58	33	40	55	62	27	103	64	15	0.284
½ x 18	0.75	58	33	40	55	62	27	104	64	18	0.290
¾ x 22	0.75	70	42	54	69	80	33	121	80	22	0.443
1 x 28	0.75	88	48	60	80	93	40	140	95	28	0.612
1 ¼ x 35	1.40	96	55	69	95	108	49	154	103	35	1.064
1 ½ x 42	1.40	107	61	76	107	118	55	175	117	42	1.416
2 x 54	1.40	126	79	99	135	153	67	207	138	54	2.030

## Dimensional Drawing

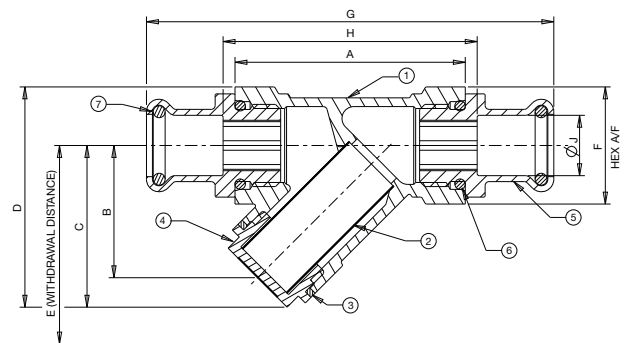

**PRESSURE RATING:** PN16 **TEMPERATURE RANGE:** -10 to 120°C

**CRANE FS D298.PF SPECIFICATION CLAUSE:** Bronze (BS EN 1982 CC491K) 'Y' type Strainer. Fitted with perforated stainless steel screen with 0.75 mm holes (1/2in to 1in) and 1.40mm holes (1.1/4in to 2in). Machined screen seats in body and cap ends. Screwed-in cap with captive washer. Complete with Geberit Mapress bronze Press-Fit adaptors Rated PN16, (Maximum temperature 120 deg C).

