

D171C / D171CEXS PN16



D171C Compression Ended Bronze Ball Valve

D171CEXS Compression Ended Bronze Ball Valve with Extension Stem

Crane D171C / D171CEXS Ball Valves are light, compact units which are easy to install and operate, yet their robust construction ensures long, trouble free service life.

In addition the D171C and D171CEXS are WRAS approved.

Materials

PART	MATERIAL	SIZES
Body	Bronze BS EN 1982 CC491K	All
Seat Retainer	Bronze BS EN 1982 CC491K	All
Ball	DZR Brass BS EN 12165 CW602N (Chrome plated)	All
Seat Ring	PTFE	All
Stem	DZR Brass BS EN 12164 CW602N	All
Packing	PTFE	All
Gland Nut	Brass BS EN 12164 CW617N	All
Lever	Mild Steel (Zinc Plated)	D171C
Screw	Mild Steel (Zinc Plated)	D171C
Lever Cover	PVC	D171C
Compression Olive	Brass BS EN 12449 CW505L/CW507L	All
Compression Nut	DZR Brass BS EN 12165 CW617N	All
Extension Housing	Aluminium	D171CEXS
Extension Stem	DZR Brass BS EN 12164 CW602N	D171CEXS



General Valves

Dimensional Drawing

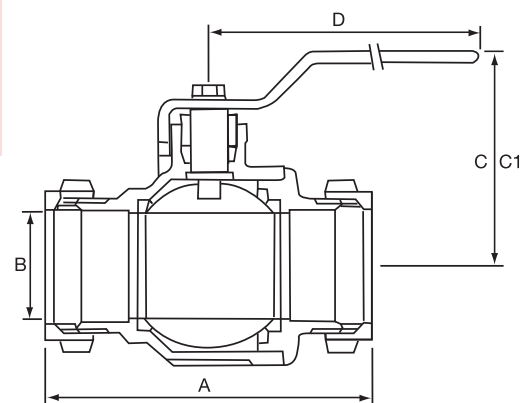

Dimensions & Weights

SIZE (mm)	WEIGHT (kg)	A (mm)	B (mm)	C (mm)	C1 (mm) D171CEXS	D (mm)
15	0.27	80	15	52	97	92
22	0.51	84	20	58	98	92
28	0.78	95	25	65	118	127
35	1.19	111	32	70	124	127
42	1.82	124	40	83	142	142
54	3.28	149	50	91	149	142

Pressure/Temperature Ratings

Compression

TEMPERATURE (°C)	-10 to 30	65	120
PRESSURE (BAR)	16	10	5

Intermediate pressure ratings shall be determined by interpolation.

PRESSURE RATING: PN16

TEMPERATURE OPERATING RANGE: -10 to 120°C

UK END CONNECTION: Compression end to suit BS EN 1057: Half Hard R250 copper tube

OPERATOR: Lever

SPECIFICATION: Quarter Turn, Tight Shut-off.

This valve is intended for Group 2 liquids only, as defined by the Pressure Equipment Directive 97/23/EC.

Every effort has been made to ensure that the information contained in this publication is accurate at the time of publishing. Crane Ltd assumes no responsibility or liability for typographical errors or omissions or for any misinterpretation of the information within the publication and reserves the right to change without notice.