

Standalone Presence Detectors

Exceptional lighting control solutions





Contents

Infrared Handsets



UNLCDHS
Professional programming/
commissioning LCD handset

4



UHS5
Compact programming/
commissioning handset

4



UHS7
Compact user handset

4

PIR Presence Detectors



EBDSPIR
Compact, flush mounted detectors

5



EBDSM
Compact, surface mounted
detectors

6



EBDMR
Mid range, flush mounted detectors

7



EBMHS
Miniature, flush/surface mounted
detectors

8



EBMPIR-MB
Miniature, retrofit, luminaire
mounted detectors

9



EBMINT
Miniature, retrofit, luminaire
mounted detectors

10



EBDRC
Long range, adjustable head,
flush mounted detectors

11

CP Electronics offer building-wide control.

Our wide range of presence detectors are designed to reduce the amount of time lighting or HVAC equipment is left on unnecessarily – for example if an area is unoccupied or if there is sufficient natural light.

Controlling lighting with a presence detector can save up to 60% of lighting energy usage dependent on occupancy behaviour and the amount of natural light available. Selected PIR and microwave presence detectors can also be used to control heating and ventilation.

In our range you are sure to find a presence detector that will suit any space.



PIR Presence Detectors



EBDHS

High bay/high level, flush mounted detectors

12



EBDHS-MB

High bay/high level, luminaire mounted detectors

13

Air Conditioning Controller



GESM-AC

Surface mounted controller for air conditioning

14

Microwave Presence Detectors



MWS3A

Adjustable head, long range, flush mounted detectors

15



MWS5

Compact, flush/surface mounted detectors

16



MWS6

Compact, flush mounted detectors

17



MWS6SM

Compact, surface mounted detectors

18



MWS1A

Low profile, back box mounted detectors

19



MWS1A-IP

Rugged, surface mounted detectors

20

Light Level Controls



ALC

Compact, flush mounted switching and dimming photocells

21

Product Spotlight



Low Temperature detectors

22



KNX presence detectors

22

Technology Guide

Presence and absence detection explained

23

PIRs and microwave detectors compared

23

PRM detectors – switching with lux level sensing

24

DD & AD detectors – dimming with lux level sensing

25

Order Codes

26

Infrared Handsets

Our range of infrared (IR) handsets have been designed to allow simple configuration, programming and maximum user convenience.

There's a handset to suit every user, whether it's the commissioning engineer configuring hundreds of detectors, a contractor setting up two or three, or a user who simply wishes to override a setting or switch between pre-programmed scenes.



UNLCDHS

UNLCDHS – Professional commissioning LCD programming handset

- The UNLCDHS is used for the operation, configuration and programming of CP products that have the ability to be programmed via IR. These include the PRM, DD, AD, Vitesse Plus, RAPID, D-Mate and An-10 ranges.
- Infrared range up to 20m.



UHS5



UHS7

UHS5 – Commissioning handset

- The UHS5 is a compact infrared handset used for the basic programming of IR enabled CP products
- Infrared range up to 7m.

UHS7 – User handset

- User handset for simple scene setting, on & off, raise & lower
- Infrared range up to 7m.

EBDSPIR | Compact, flush mounted detectors



This compact ceiling mounted PIR presence detector provides automatic control of lighting, heating and ventilation loads.

- Low profile design
- Self contained unit
- Pluggable
- Programme time delay and lux settings via infrared handset (excluding Basic variant).
- Available in a wide range of RAL colours
- 5 year warranty.

Available control methods

- B – Basic switching
- PRM – Switching
- DD – DALI/DSI dimming
- AD – Analogue dimming
- KNX – See page 22

Special order variants

- LT30 – Low temperature
 - LV – Low voltage
 - VFC – Voltage free contact
 - 2CH – 2 channel
- Additional variants available – please see our website.

Detection pattern

high < sensitivity > low

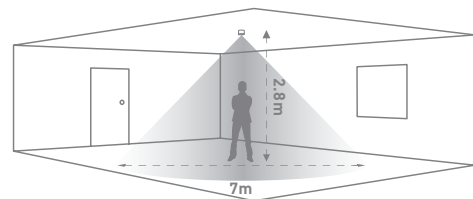

Dimensions (mm)

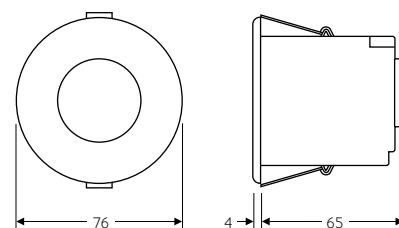

EBDSM | Compact, surface mounted detectors



This series of surface mounted PIR presence/absence detectors is perfect for simple attachment when flush mounting is not possible.

- Self contained unit
- Easy to install via back plate
- Programme time delay and lux settings via infrared handset
- IP40 (no gasket); IP54 when fitted with gasket
- 5 year warranty.

Available control methods

- PRM – Switching
- DD – DALI/DSI dimming
- AD – Analogue dimming

Detection pattern

high < sensitivity > low

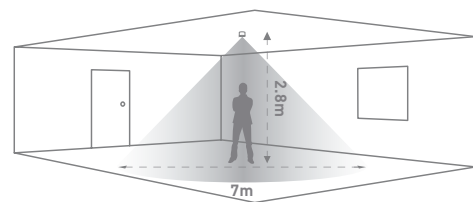

Dimensions (mm)

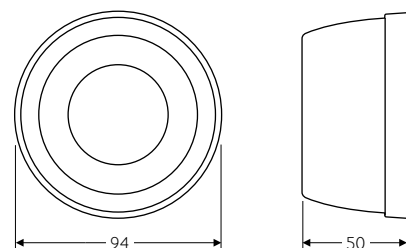

EBDMR | Mid range, flush mounted detectors



Our series of compact flush mounted PIR presence/absence detectors with high performance faceted lens is suitable for use in open spaces or where a larger detection range is required.

- Mid range lens with concentric lens facets for improved detection
- Ideal for open spaces
- Programme time delay and lux settings via infrared handset
- IP40 rated
- Available in a wide range of RAL colours
- 5 year warranty.

Available control methods

- PRM – Switching
- DD – DALI/DSI dimming
- AD – Analogue dimming

Special order variants

- LV – Low voltage
- Additional variants available to special order – please see our website.

Detection pattern

high < sensitivity > low

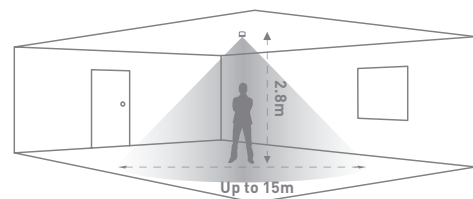

Dimensions (mm)

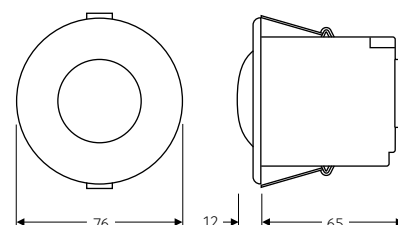

EBMHS | Miniature, flush/surface mounted detectors



This small, unobtrusive, but highly capable PIR presence/absence detector is supplied pre-wired and with a connector that snap-fits into the power supply unit (PSU) for ease of installation.

- Small and unobtrusive design
- High sensitivity head for increased detection range
- Programme time delay and lux settings via infrared handset
- Supplied pre-wired with an RJ11 plug for connection into the power supply
- Supplied with a flush mounting ring for easy fitting into the ceiling.
- Available with standard or slim line PSU
- 5 year warranty.

Available control methods

- PRM – Switching
- DD – DALI/DSI dimming
- AD – Analogue dimming

Special order variants

- LV – Low voltage

Detection pattern

high < sensitivity > low

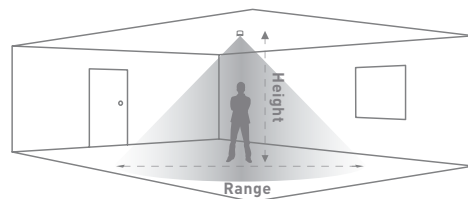

Height	Range
2.8m	9m
7m	16m

Dimensions (mm)

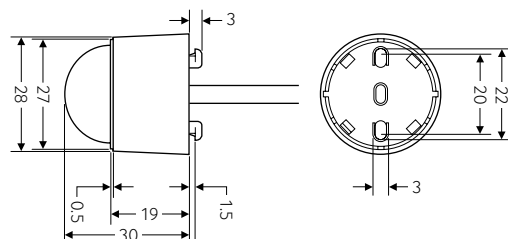

EBMPIR-MB | Miniature, retrofit, luminaire mounted detectors



The EBMPIR-MB series of batten mount PIR presence detectors have been designed specifically for mounting on to a batten style luminaire.

- Batten mount retrofit solution
- Integrated power supply
- Suitable for a wide range of luminaires
- Pre wired with 1m cable
- Programme time delay and lux settings via infrared handset
- IP65 rated for wet and damp environments
- For mounting at heights up to 7m
- 5 year warranty.

Available control methods

- PRM – Switching
- DD – DALI/DSI dimming
- AD – Analogue dimming

Special order variants

- LT30 – Low temperature
- LV – Low voltage (110V)

Detection pattern

high < sensitivity > low

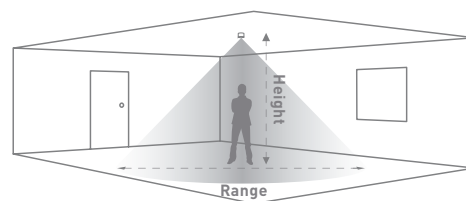

Height	Range
2.8m	9m
7m	16m

Dimensions (mm)

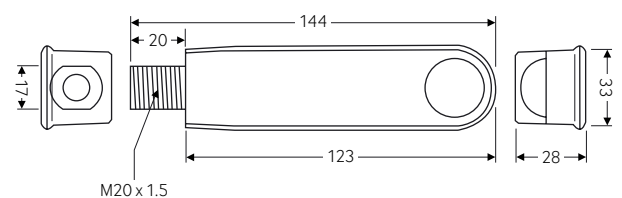

EBMINT | Miniature, retrofit, luminaire mounted detectors



This patented series of miniature PIR presence detectors is designed to be retrofitted to luminaires quickly and effectively.

- Sensitive movement detection up to 7m
- Fixings for T5, T8 battens and louvre reflectors
- Easy to install – no specialist tools required
- Programme time delay and lux settings via infrared handset
- Integrated power supply
- 5 year warranty.

Available control methods

- PRM – Switching
- DD – DALI/DSI dimming
- AD – Analogue dimming

Detection pattern

high < sensitivity > low

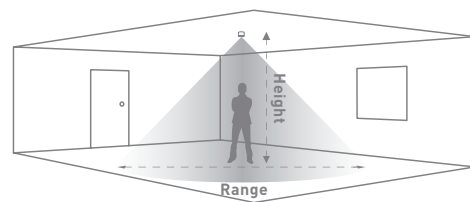

Height	Range
2.8m	9m
7m	16m

Dimensions (mm)

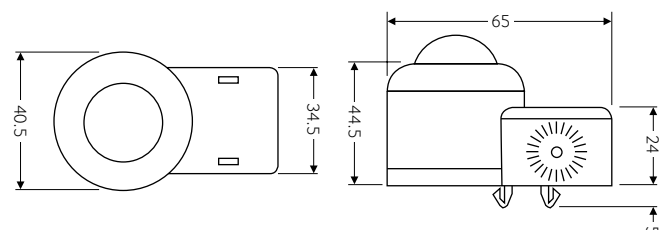

EBDRC | Long range, adjustable head, flush mounted detectors



Head can be adjusted to suit the detection pattern required



Detection head position set to 15°



Detection head position set to 90°



The EBDRC series of PIR presence/absence detectors contains an adjustable head, and is fitted with a curtain lens for long range detection. Our directional PIR is suitable for mounting in aisleway and corridor applications where a long narrow detection pattern is required.

- Adjustable head
- Curtain lens for longer detection range
- Programme time delay and lux settings via infrared handset
- IP40 rated
- Ideal for corridor applications
- 5 year warranty.

Available control methods

- PRM – Switching
- DD – DALI/DSI dimming
- AD – Analogue dimming

Special order variants

Additional variants available to special order – please see our website.

Detection pattern

high < sensitivity > low

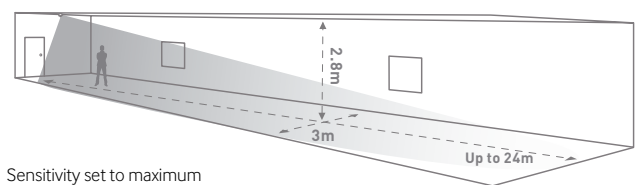

Sensitivity set to maximum
Detector head position set to 90°

Dimensions (mm)

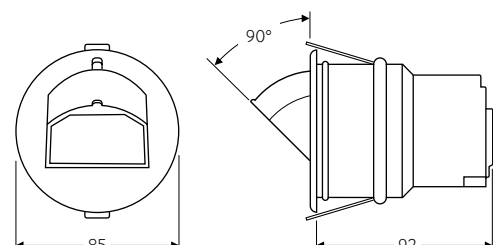

EBDHS | High bay/high level, flush mounted detectors



PATENTED DESIGN

The EBDHS PIR presence/absence detector is developed for lighting control in areas with demanding spaces and increased mounting heights.

- Ground breaking detection range
- For mounting at heights up to 20m depending on operating parameters
- Unique lens technology – high sensitivity
- Ideal for high level/high bay applications
- Programme time delay and lux settings via infrared handset
- Supplied with adjustable masking shields to tailor detection zones
- 5 year warranty.

Available control methods

- PRM – Switching
- DD – DALI/DSI dimming
- AD – Analogue dimming
- KNX – See page 22

Special order variants

- LT30 – Low temperature
- LV – Low voltage

Detection pattern

high < sensitivity > low

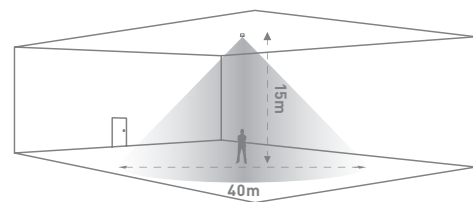

Dimensions (mm)

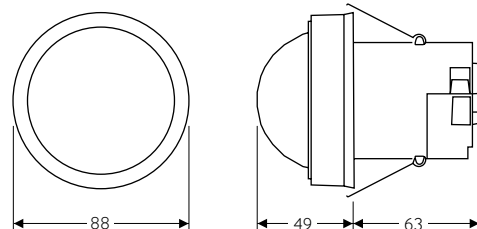

EBDHS-MB | High bay/high level, luminaire mounted detectors



PATENTED
DESIGN

The EBDHS-MB luminaire mounted PIR presence detector series provides exceptionally sensitive and long range detection. Ideal for high bay lighting control in areas with demanding spaces and increased mounting heights.

- Ground breaking detection range
- For mounting at heights up to 20m depending on operating parameters
- Unique lens technology – high sensitivity
- Ideal for high level/high bay applications
- Programme time delay and lux settings via infrared handset
- Easy to retrofit to commercial luminaires and basic battens
- 5 year warranty.

Available control methods

- PRM – Switching
- DD – DALI/DSI dimming
- AD – Analogue dimming

Special order variants

- LT30 – Low temperature

Detection pattern

high < sensitivity > low

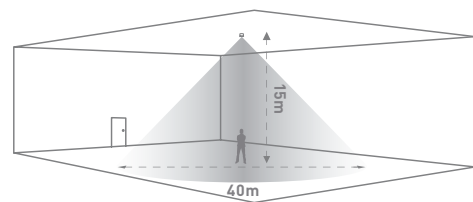

Dimensions (mm)

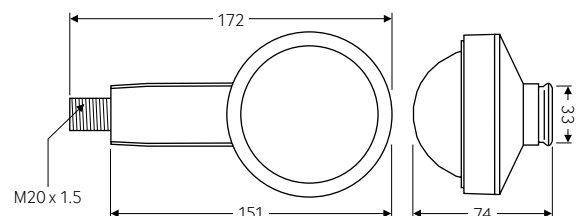

GESM-AC | Surface mounted controller for air conditioning



This AC unit simply 'learns' an AC unit's infrared code, then controls its operation, based on occupancy. As it is surface mounted and battery powered, installation is simplified and disruption is reduced.

- Compatible with most infrared controlled AC units
- Battery operated
- Presence detection - auto on, auto off
- Adjust time delay settings via push buttons
- Lockable settings
- Sleep mode extends battery life
- 5 year warranty.

Detection pattern

high < sensitivity > low

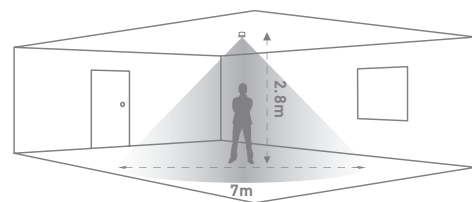

Dimensions (mm)

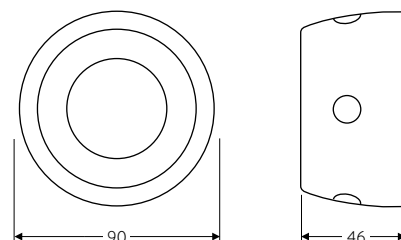

MWS3A | Adjustable head, long range, flush mounted detectors



Detection pattern high < sensitivity > low

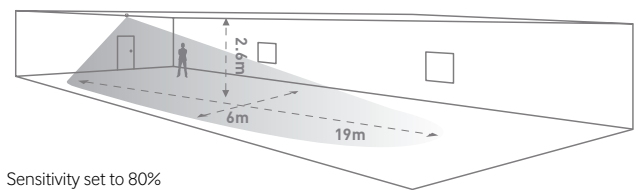
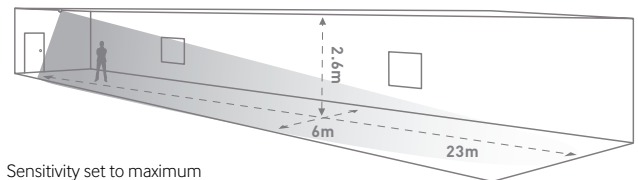
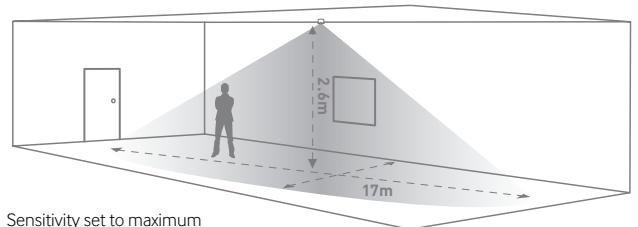

Unlike fixed head microwave detectors, the MWS3A series of presence/absence detectors offers a unique adjustable head to suit the required detection pattern.

- Unique adjustable head design to achieve the required detection pattern
- Locking mechanism to prevent tampering
- Can be flush or surface mounted
- Programme time delay and lux settings via infrared handset
- IP40 rated
- 5 year warranty.

Available control methods

- PRM – Switching
- DD – DALI/DSI dimming
- AD – Analogue dimming
- KNX – See page 22

Special order variants

- LV – Low voltage
- VFC – Voltage free contact
- VFC NC – Voltage free contact normally closed
- 2CH – 2 channel
- 2CH-NC – 2 channel normally closed

Dimensions (mm)

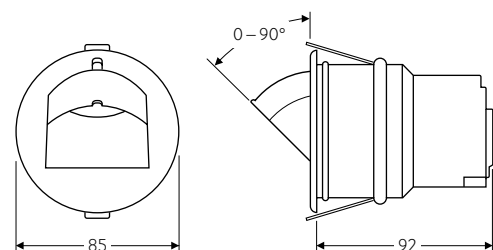

MWS5 | Compact, flush/surface mounted detectors



The MWS5 series of compact microwave presence/absence detectors has been specifically designed to be mounted within a luminaire. They are sensitive to movement and are ideal for large spaces that have an awkward shape.

- Can be flush or surface mounted
- Remote power supply allows head to be fitted in confined spaces
- Suitable for wall or ceiling mounted luminaires
- A selection of fixing clips to allow the unit to be mounted in or to the side of a luminaire is available
- Programme time delay and lux settings via infrared handset
- Standard and slimline power supply units also available
- 5 year warranty.

Available control methods

- PRM – Switching
- DD – DALI/DSI dimming
- AD – Analogue dimming

Detection pattern

high < sensitivity > low

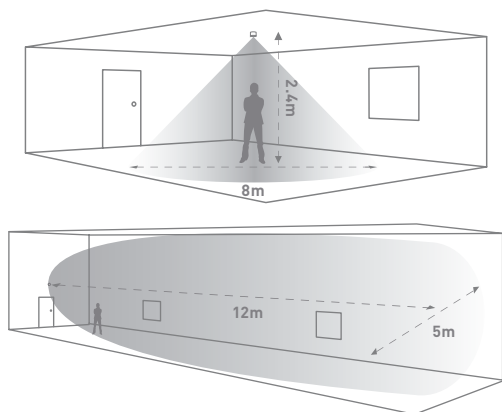

Dimensions (mm)

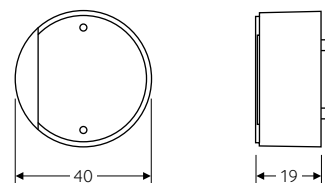

For power supply unit dimensions, please refer to the product installation guide on our website.

MWS6 | Compact, flush mounted detectors



The MWS6 is a low profile microwave presence/absence detector for the automatic control of lighting, heating and ventilation.

- Low profile design
- Self contained unit
- Pluggable
- IP40 rated
- Programme time delay and lux settings via infrared handset
- Available in a wide range of RAL colours
- 5 year warranty.

Available control methods

- PRM – Switching
- DD – DALI/DSI dimming
- AD – Analogue dimming
- KNX – See page 22

Special order variants

- LV – Low voltage
 - VFC – Voltage free contact
 - 2CH – 2 channel
- Additional variants available to special order – please see our website.

Detection pattern

high < sensitivity > low

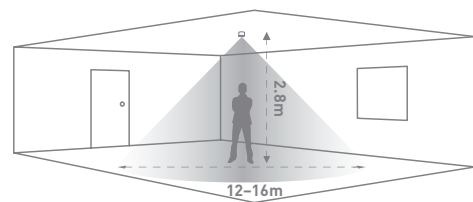

Dimensions (mm)

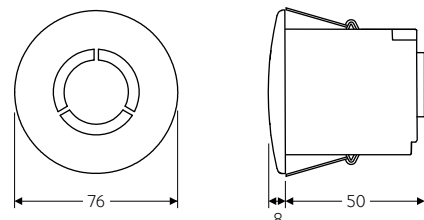

MWS6SM | Compact, surface mounted detectors



The MWS6SM is a surface mounted mid-range microwave presence/absence detector for the automatic control of lighting, heating and ventilation.

- Surface mounted
- IP40 rated
- Programme time delay and lux settings via infrared handset
- Self contained unit
- Easy to install via a back plate
- 5 year warranty.

Available control methods

- PRM – Switching
- DD – DALI/DSI dimming
- AD – Analogue dimming

Detection pattern

high < sensitivity > low

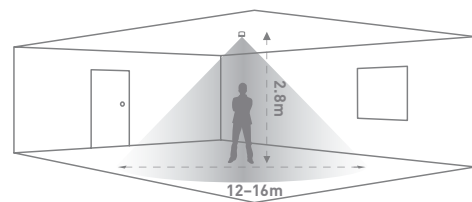

Dimensions (mm)

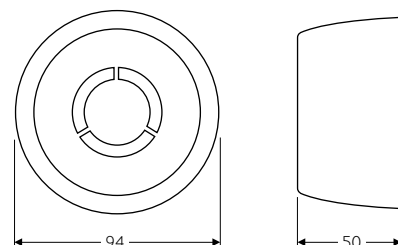

MWS1A | Low profile, back box mounted detectors



This discrete range of wall or ceiling mounted microwave presence detectors is designed to fit any single gang switch box.

- Presence detection
- Programme time delay and lux settings via infrared handset
- Suitable for heating and ventilation applications
- Compatible with European back boxes
- Fixing screw cap covers – smooth plate finish
- 5 year warranty.

Available control methods

- PRM – Switching

Special order variants

- LV – Low voltage
- VFC – Voltage free contact

Detection pattern

high < sensitivity > low

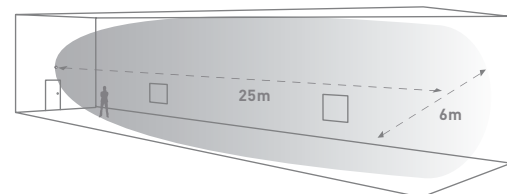
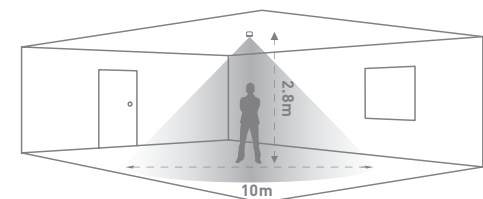

Dimensions (mm)

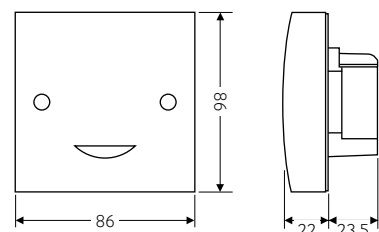

MWS1A-IP | Rugged, surface mounted detectors



This rugged range of wall or ceiling mounted presence microwave detectors are rated IP66 – suitable for use in damp environments.

- Unobtrusive design – vandal resistant
- Programme time delay and lux settings via infrared handset
- Built in lux level sensing – enhanced energy saving
- Low voltage and volt free options – suitable for BMS and other control applications
- 5 year warranty.

Available control methods

- PRM – Switching

Special order variants

- LV – Low voltage
- VFC – Volt free contact

Detection pattern

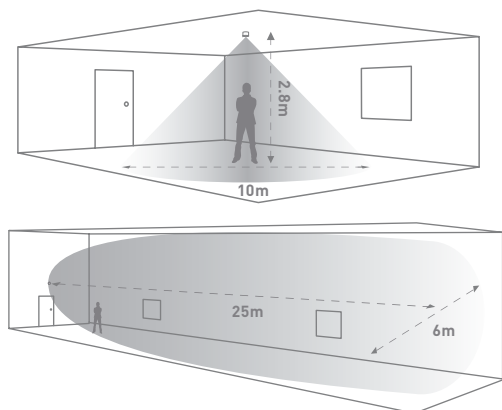

Dimensions (mm)

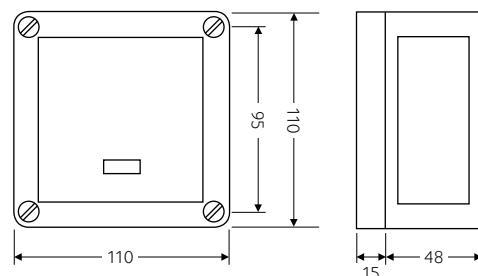

ALC | Compact, flush mounted switching and dimming photocells



The ALC dimming photocell automatically adjusts the light output of luminaires depending on the amount of natural light available, to a maintained illuminance level.

- Flush or surface mounted
- Adjustable preset levels for more control
- Programme time delay and lux settings via infrared handset
- Dimming version available to provide a maintained level of illuminance
- 5 year warranty.

Available control methods

- DD – DALI/DSI dimming
- AD – Analogue dimming

Dimensions (mm)

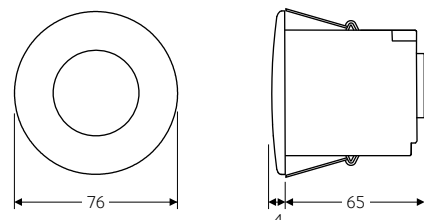

Low Temperature Detectors

Following rigorous testing in climatic chambers and on-site, our Minus30 range of lighting controls is specifically designed for the cold storage and refrigeration sector, performing down to aggressive -30° temperatures.



EBMPIR-MB-LT30



EBDSPIR-LT30



EBDHS-LT30



EBDHS-MB-LT30

KNX Presence Detectors

CP Electronics brings its extensive functionality to KNX, the worldwide standard for unifying all communication between intelligent devices that light, heat and ventilate homes and buildings.

Key features:

- Presence detector, either PIR or microwave
- Absence detection
- Walk test LED
- Light level sensor
- Two ELV switch inputs
- User-configurable logic functions and timers.

Configuration of devices on the KNX bus takes place via the standard ETS software application, allowing all aspects of the presence detector's behavior to be configured and controlled.



EBDSPIR-KNX



EBDHS-KNX



MWS3A-KNX



MWS6-KNX

Presence and absence detection explained



Presence Detection: Detectors will switch on lighting automatically when a person enters the room, and switches off lighting automatically when no movement is detected.



Absence Detection: Upon entering the room the person switches on the light as normal, but on leaving the detector switches off the lighting automatically. Lights can also be switched off manually.

PIRs and microwave detectors compared

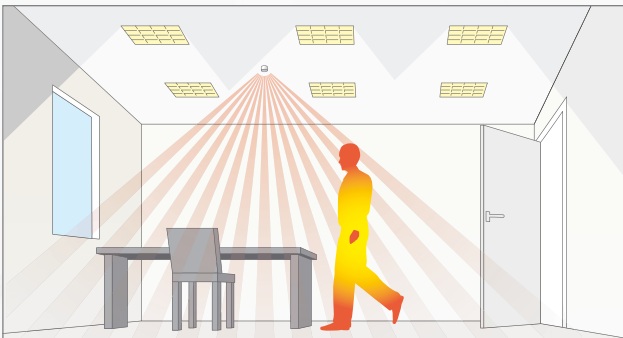

PIR (Passive Infrared) Detection: PIR detectors work on detecting the movement of body heat. They are better suited to smaller spaces or where a defined detection pattern is required.

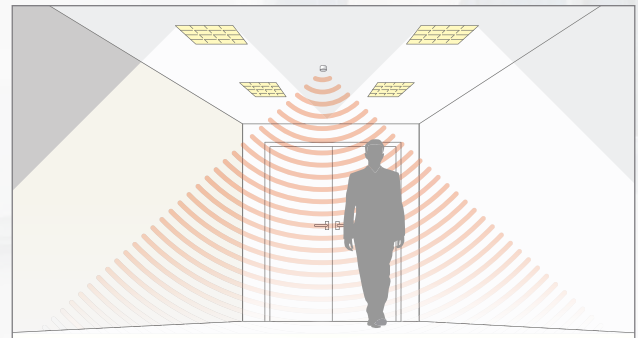

Microwave Detection: Microwave Detectors are sensitive to objects that move, with much greater coverage and sensitivity. They can detect through glass, therefore careful consideration on location is needed in certain applications.

PRM Detectors | Switching with lux level sensing

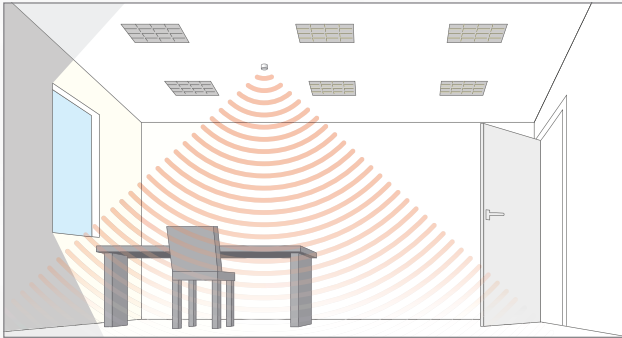

No presence detected, daylight, lights off.

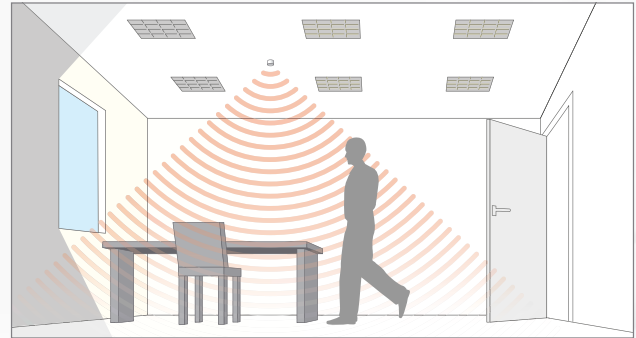

Presence detected, sufficient daylight, lights off.

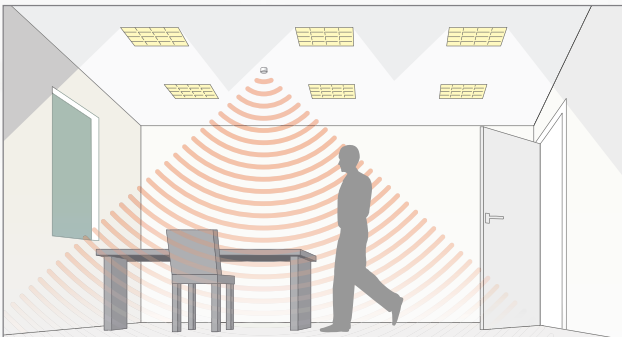

Presence detected, insufficient daylight, all lights on.

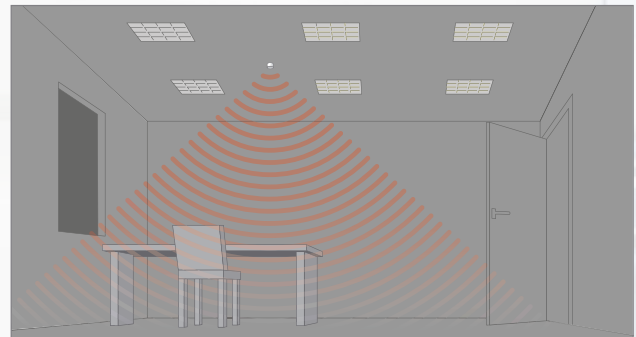

No presence detected, lights off.

These presence detectors have built-in adjustable lux sensors which will keep the lighting switched off if there is sufficient natural light.

Key features

- Switching with lux level sensing (infrared handset adjustment)
- Active photocell
- Time delay function
- Presence detection switching.
- Absence detection switching
- Programmable via Infrared handset
- Adjustable detection sensitivity
- On/off override via optional Infrared handset
- Manual on/off override via switch input.

DD & AD Detectors | Dimming with lux level sensing

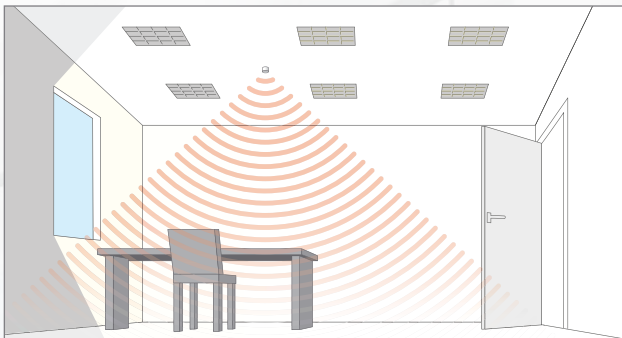

No presence detected, daylight, lights off.

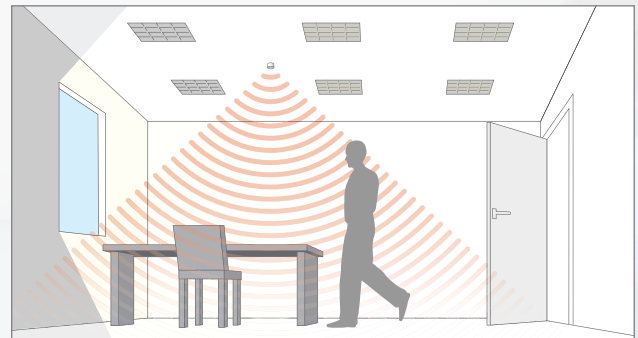

Presence detected, sufficient daylight, lights off.

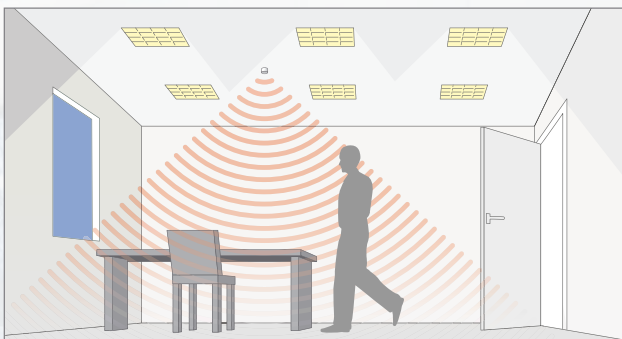

Presence detected, some daylight. Lights on and dimmed to maintain lux level.

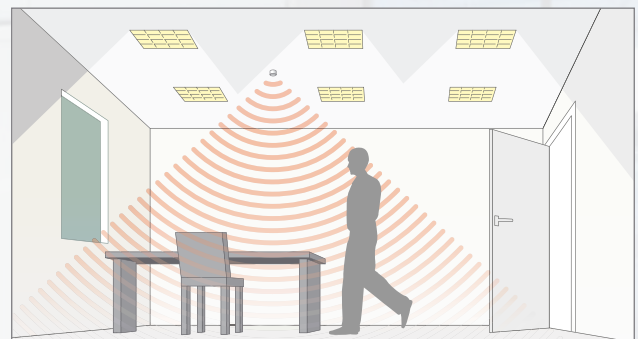

Presence detected, insufficient daylight. Detector measures and implements maintained illuminance.

These presence detectors have built-in adjustable lux sensors which will keep the lighting switched off if there is sufficient natural light.





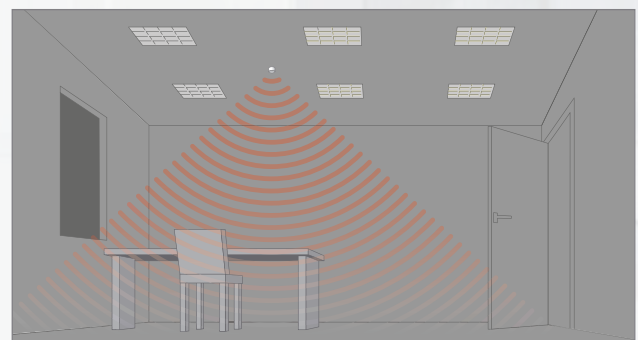

Key features (in addition to PRM detectors)

- Dimming functionality
- Two channel flexibility
- Step-down illuminance
- Maintained illuminance (daylight harvesting)
- Scene setting and recall
- Burn in feature for fluorescent tubes
- Control of DALI, DSI or 1–10V loads depending on product
- Integral relay to reduce parasitic power
- Suitable for all lighting types
- Manual dimming with infrared
- Manual dimming with switch inputs.



No presence detected, lights off.



Ceiling Mounted PIR Presence Detectors

Order Code	Description	PG
 EBDSPIR	Basic switching, compact, IP40, flush mounted, PIR, presence detector	5
EBDSPIR-VFC	Basic switching, compact, IP40, flush mounted, PIR, presence detector, volt free contact	
EBDSPIR-L3	Basic switching, compact, IP40, flush mounted, PIR, presence detector, c/w 3m lead	
EBDSPIR-IP	Basic switching, compact, IP55, flush mounted, PIR, presence detector	
EBDSPIR-AD	1–10V analogue dimming, compact, IP40, flush mounted, PIR, presence/absence detector,	
EBDSPIR-DD	DALI/DSI digital dimming, compact, IP40, flush mounted, PIR, presence/absence detector	
EBDSPIR-DD-LV	DALI/DSI digital dimming, compact, IP40, flush mounted, PIR, presence/absence detector, low voltage	
EBDSPIR-PRM	PRM switching, compact, IP40, flush mounted, PIR, presence/absence detector	
EBDSPIR-PRM-2CH	PRM switching, compact, IP40, flush mounted, PIR, presence/absence detector, 2-channel	
EBDSPIR-PRM-2CH-NC	PRM switching, compact, IP40, flush mounted, PIR, presence/absence detector, normally closed fail-safe contacts, 2-channel	
EBDSPIR-PRM-IP	PRM switching, compact, IP55, flush mounted, PIR, presence/absence detector	
EBDSPIR-PRM-L3	PRM switching, compact, IP40, flush mounted, PIR, presence/absence detector, c/w 3m lead	
EBDSPIR-PRM-LV	PRM switching, compact, IP40, flush mounted, PIR, presence/absence detector, low voltage	
EBDSPIR-PRM-VFC	PRM switching, compact, IP40, flush mounted, PIR, presence/absence detector, volt free contact	
 EBDSM-AD	1–10V analogue dimming, compact, IP54, surface mounted, PIR, presence/absence detector	6
EBDSM-DD	DALI/DSI digital dimming, compact, IP54, surface mounted, PIR, presence/absence detector	
EBDSM-PRM	PRM switching, compact, IP54, surface mounted, PIR, presence/absence detector	
 EBMHS-AD-SA-C	1–10V analogue dimming, miniature, IP40, flush/surface mounted, PIR, presence/absence detector, c/w pre-wired PSU	8
EBMHS-DD-SA-C	DALI/DSI digital dimming, miniature, IP40, flush/surface mounted, PIR, presence/absence detector, c/w pre-wired PSU	
EBMHS-PRM-SA-C	PRM switching, miniature, IP40, flush/surface mounted, PIR, presence/absence detector, c/w pre-wired PSU	
 EBMINT-AD	1–10V analogue dimming, miniature clip on, retrofit, IP40, luminaire mounted, PIR, presence detector	10
EBMINT-DD	DALI/DSI digital dimming, miniature clip on, retrofit, IP40, luminaire mounted, PIR, presence detector	
EBMINT-PRM	PRM switching, miniature clip on, retrofit, IP40, luminaire mounted, PIR, presence detector	
 EBMPIR-MB-AD	1–10V analogue dimming, miniature, retrofit, IP65, luminaire mounted, PIR, presence detector	9
EBMPIR-MB-DD	DALI/DSI digital dimming, miniature, retrofit, IP65, luminaire mounted, PIR, presence detector	
EBMPIR-MB-PRM	PRM switching, miniature, retrofit, IP65, luminaire mounted, PIR, presence detector	
EBMPIR-MB-PRM-110	PRM switching, miniature, retrofit, IP65, luminaire mounted, PIR, presence detector, 110V	
 EBDMR-PRM	PRM switching, compact, mid range, IP40, flush mounted, PIR, presence/absence detector	7
EBDMR-DD	DALI/DSI digital dimming, compact, mid range, IP40, flush mounted, PIR, presence/absence detector	
EBDMR-AD	1–10v analogue dimming, mid range, IP40, flush mounted, PIR, presence/absence detector	
 EBDRC-AD	1–10v analogue dimming, adjustable head, long range, IP40, flush mounted, PIR, presence/absence detector	11
EBDRC-DD	DALI/DSI digital dimming, adjustable head, long range, IP40, flush mounted, PIR, presence/absence detector	
EBDRC-PRM	PRM switching, adjustable head, long range, IP40, flush mounted, PIR, presence/absence detector	







Air Conditioning Controller

Order Code	Description	PG
 GESM-AC	Surface mount PIR AC controller	14



High Bay/High Level PIR Presence Detectors

Order Code	Description	PG
 EBDHS-AD	1–10v analogue dimming, IP65, high bay/high level, flush mounted, PIR, presence/absence detector	12
EBDHS-DD	DALI/DSI digital dimming, IP65, high bay/high level, flush mounted, PIR, presence/absence detector	
EBDHS-PRM	PRM switching, IP65, high bay/high level, flush mounted, PIR, presence/absence detector	
 EBDHS-MB-AD	1–10v analogue dimming, retrofit, IP65, high bay/high level, luminaire mounted, PIR, presence detector	13
EBDHS-MB-DD	DALI/DSI digital dimming, retrofit, IP65, high bay/high level, luminaire mounted, PIR, presence detector	
EBDHS-MB-PRM	PRM switching, retrofit, IP65, high bay/high level, luminaire mounted, PIR, presence detector	





Ceiling Mounted Microwave Presence Detectors

Order Code	Description	PG
 MWS1A-C-IP-PRM	PRM switching, rugged, IP66, surface mounted, microwave, presence detector	20
MWS1A-C-IP-PRM-LV	PRM switching, rugged, IP66, surface mounted, microwave, presence detector, low voltage	
MWS1A-C-IP-PRM-VFC	PRM switching, rugged, IP66, surface mounted, microwave, presence detector, volt free contacts	
 MWS1A-C-PRM	PRM switching, low profile, IP40, back box mounted, microwave, presence detector	19
MWS1A-C-PRM-LV	PRM switching, low profile, IP40, back box mounted, microwave, presence detector, low voltage	
MWS1A-C-PRM-VFC	PRM switching, low profile, IP40, back box mounted, microwave, presence detector, volt free contacts	
 MWS3A-AD	1–10v analogue dimming, adjustable head, long range, IP40, flush mounted, microwave, presence/absence detector	15
MWS3A-AD-LV	1–10v analogue dimming, adjustable head, long range, IP40, flush mounted, microwave, presence/absence detector, low voltage	
MWS3A-DD	DALI/DSI digital dimming, adjustable head, long range, IP40, flush mounted, microwave, presence/absence detector	
MWS3A-DD-LV	DALI/DSI digital dimming, adjustable head, long range, IP40, flush mounted, microwave, presence/absence detector, low voltage	
MWS3A-PRM	PRM switching, adjustable head, long range, IP40, flush mounted, microwave, presence/absence detector	
MWS3A-PRM-L3	PRM switching, adjustable head, long range, IP40, flush mounted, microwave, presence/absence detector, c/w 3m lead	
MWS3A-PRM-LV	PRM switching, adjustable head, long range, IP40, flush mounted, microwave, presence/absence detector, low voltage	
MWS3A-PRM-VFC	PRM switching, adjustable head, long range, IP40, flush mounted, microwave, presence/absence detector, volt free contact	
 MWS5-AD-SA-C	1–10v analogue dimming, miniature, IP40, flush mounted, microwave, presence/absence detector, c/w pre wired PSU	
MWS5-DD-SA-C	DALI/DSI digital dimming, miniature, IP40, flush mounted, microwave, presence/absence detector, c/w pre wired PSU	
MWS5-PRM-SA-C	PRM switching, miniature, IP40, flush mounted, microwave, presence/absence detector, c/w pre wired PSU	
 MWS6-AD	1–10V analogue dimming, compact, IP40, flush mounted, microwave, presence/absence detector	17
MWS6-DD	DALI/DSI digital dimming, compact, IP40, flush mounted, microwave, presence/absence detector	
MWS6-PRM	PRM switching, compact, IP40, flush mounted, microwave, presence/absence detector	
MWS6-PRM-2CH	PRM switching, compact, IP40, flush mounted, microwave, presence/absence detector, 2-channel	
MWS6-PRM-LV	PRM switching, compact, IP40, flush mounted, microwave, presence/absence detector, low voltage	
MWS6-PRM-VFC	PRM switching, compact, IP40, flush mounted, microwave, presence/absence detector, volt free contacts	
 MWS6SM-AD	1–10v analogue dimming, IP40, surface mounted, microwave, presence/absence detector	18
MWS6SM-DD	DALI/DSI digital dimming, IP40, surface mounted, microwave, presence/absence detector	
MWS6SM-PRM	PRM switching, IP40, surface mounted, microwave, presence/absence detector	





Wall Mounted Microwave Presence Detectors

Order Code	Description	PG
 MWS1A-IP-PRM	PRM switching, rugged, IP66, wall, surface mounted, microwave, presence detector	20
MWS1A-IP-PRM-LV	PRM switching, rugged, IP66, wall, surface mounted, microwave, presence detector, low voltage	
MWS1A-IP-PRM-VFC	PRM switching, rugged, IP66, wall, surface mounted, microwave, presence detector, volt free contacts	
 MWS1A-PRM	PRM switching, long range, IP40, wall, back box mounted, microwave, presence detector	19
MWS1A-PRM-LV	PRM switching, long range, IP40, wall, back box mounted, microwave, presence detector, low voltage	
MWS1A-PRM-VFC	PRM switching, long range, IP40, wall, back box mounted, microwave, presence detector, volt free contact	

Minus30 Low Temperature Detector Range

Order Code	Description	PG
 EBDHS-AD-LT30	1–10v analogue dimming, low temp, IP65, high bay/high level, flush mounted, PIR, presence/absence detector	12
EBDHS-DD-LT30	DALI/DSI digital dimming, low temp, IP65, high bay/high level, flush mounted, PIR, presence/absence detector	
EBDHS-PRM-LT30	PRM switching, low temp, IP65, high bay/high level, flush mounted, PIR, presence/absence detector	
 EBDHS-MB-AD-LT30	1–10v analogue dimming, retrofit, low temp, IP65, high bay/high level, luminaire mounted, PIR, presence detector	13
EBDHS-MB-DD-LT30	DALI/DSI digital dimming, retrofit, low temp, IP65, high bay/high level, luminaire mounted, PIR, presence detector	
EBDHS-MB-PRM-LT30	PRM switching, retrofit, low temp, IP65, high bay/high level, luminaire mounted, PIR, presence detector	
 EBDSPIR-AD-IP-LT30	1–10V analogue dimming, compact, low temp, IP55, flush mounted, PIR, presence/absence detector	5
EBDSPIR-DD-IP-LT30	DALI/DSI digital dimming, compact, low temp, IP55, flush mounted, PIR, presence/absence detector	
EBDSPIR-PRM-IP-LT30	PRM switching, compact, low temp, IP55, flush mounted, PIR, presence/absence detector	
 EBMPIR-MB-AD-LT30	1–10V analogue dimming, miniature, retrofit, low temp, IP65, luminaire mounted, PIR, presence detector	9
EBMPIR-MB-DD-LT30	DALI/DSI digital dimming, miniature, retrofit, low temp, IP65, luminaire mounted, PIR, presence detector	
EBMPIR-MB-PRM-LT30	PRM switching, miniature, retrofit, low temp, IP65, luminaire mounted, PIR, presence detector	



KNX Presence Detectors

Order Code	Description	PG
 EBDHS-KNX	KNX, IP65, high bay/high level, flush mounted, PIR, presence/absence detector	12
 EBDSPIR-KNX	KNX, compact, IP40, flush mounted, PIR, presence/absence detector	5
 MWS3A-KNX	KNX, adjustable head, long range, IP40, flush mounted, microwave, presence/absence detector	15
 MWS6-KNX	KNX, compact, IP40, flush mounted, microwave, presence/absence detector	17

Light Level Controls

Order Code	Description	PG
 ALC-PRM-VFC	Compact, IP40, flush mounted, photocell switch, PRM switching, volt free contacts	21
ALC-DD	Compact, IP40, flush mounted, photocell switch, DALI/DSI digital dimming	
ALC-AD	Compact, IP40, flush mounted, photocell switch, 1–10V analogue dimming	

Infrared Handsets

Order Code	Description	PG
 UHS5	Compact, programming/commissioning handset	4
 UHS7	Compact, user handset	4
 UNLCDHS	Professional, programming/commissioning LCD handset	4

Accessories

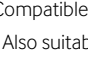
Order Code	Description
 DBB	Surface mount back box, white*
 MWS3A-DBB	MWS3A Surface mount back box BESA fixing, white*
 DBB-EXT	Surface mount back box extender BESA fixing, white*
 MWS3A-DBB-EXT	MWS3A Surface mount back box extender BESA fixing, white**
 EBDHS-DBB-WBRKT	EBDHS Wall mount bracket, white*
 MWS3A-DBB-WBRKT	MWS3A Wall mount bracket, white**
 EBD-ENCIP1	IP65 detector enclosure, grey*
 EXD-HSC	Extended wiring compartment for use with flush mounted detectors, white*
 EBDSPIR-MS	Adhesive masking shields (pack of 10), white
 EBDHS-MS	Masking shields
 MWS3A-VPPC	Wall mount protective cover for use with wall mount bracket, clear

*Compatible with EBDSPIR, EBDHS, ALC, MWS6 and EBDMR presence detectors.

** Also suitable for EBDRC.

TERMS & CONDITIONS OF SALE

These Terms & Conditions of Sale shall apply to and form part of every contract of sale entered into by the Company. All orders are accepted and executed on the understanding that the Customer is bound by these Terms & Conditions of Sale which shall govern the contract to the exclusion of any other terms and conditions subject to which any such order is accepted or purported to be accepted, or any such order is made or purported to be made, by the Purchaser.

No contract of sale shall come into being unless and until the Customer has accepted these Terms & Conditions of Sale either expressly or by implication.

1 Definitions

Agreement	means any agreement which incorporates the Conditions.
Company	means CP Electronics division of Legrand Electric Limited.
Conditions	means the terms and conditions set out herein and includes any special terms and conditions agreed in writing between the Company and the Customer.
Customer	means any person, company, firm or organisation who enters into an Agreement.
Goods	means those items which are the subject of an Order.
Invoice	means the document sent to the Customer whether verbally or in writing by the Company in demand of payment for the Goods.
Order	means an order placed by a Customer and accepted by the Company.
Premises	means Brent Crescent, London NW10 7XR.
Specification	means any specification whether written or oral, drawings, designs or instructions furnished by the Customer to the Company.

2 Orders and Specifications

- 2.1 Each Order shall constitute a separate Agreement between the Company and the Customer.
- 2.2 The Customer shall be responsible for ensuring the accuracy of the terms of any Order or Specification.
- 2.3 The Company's employees or agents are not authorised to make any representations concerning the Goods unless confirmed in writing by the Company.
- 2.4 The quantity and description of the Goods shall be as set out either in the Order or in the case where a quotation is given by the Company in the quotation. No other descriptive material, written or oral including promotional or sales literature, shall be incorporated into the Order or quotation.
- 2.5 The Company reserves the right to make any changes to the Goods which are required to conform with any applicable statutory or E.U. requirements.
- 2.6 Any typographical or other error in any document issued by the Company shall be subject to correction without any liability on the part of the Company.

3 Price and Payment

- 3.1 The price of the Goods shall be the Company's quoted price or where no price has been quoted (or the quoted price is no longer valid), the price listed in the Company's price list current at the date of the Order and in any case as shown on the Invoice.
- 3.2 All prices are quoted ex-warehouse and exclude charges for transport, packaging and insurance which shall be paid by the Customer.
- 3.3 The Company reserves the right by giving written notice to the Customer at any time before delivery to alter the price of the Goods where such alteration is due to any factor beyond the control of the Company (such as, without limitation, any foreign exchange fluctuation, alteration of duties), any changes in delivery dates or quantities requested by the Customer or any delay caused by any instructions of the Customer.
- 3.4 All prices and charges are exclusive of VAT and any other applicable taxes, rates, governmental levies or duty.
- 3.5 All prices and charges shall be due within 30 days of the date of the Invoice. Time shall be of the essence in respect of payment of all prices and charges.
- 3.6 If the Customer fails to make any payment on the due date then, without limiting any other right or remedy available to the Company, the Company may:
 - 3.6.1 cancel the Order or suspend any further deliveries to the Customer;
 - 3.6.2 appropriate any payment made by the Customer to such of the Goods as the Company may deem fit (notwithstanding any purported appropriation by the Customer); and
 - 3.6.3 charge interest on sums more than 7 days overdue on a daily basis (as well as before and after judgement) at a rate of 5% per annum compounded quarterly and payable on demand.

4 Delivery and Acceptance

- 4.1 Delivery shall be made either by the Customer collecting the Goods at the Premises at any time after the Company has notified the Customer that the Goods are ready for collection or by the Company delivering the Goods to the delivery address set out in the delivery note.
- 4.2 Any dates quoted for delivery are approximate only and the Company shall not be liable for any delay howsoever caused. The Company may by written notice given to the Customer reschedule its delivery dates without liability.
- 4.3 If the Customer fails to take delivery or fails to give the Company adequate delivery instructions, without prejudice to any other right or remedy available to it, the Company may store the Goods until actual delivery and charge the Customer for any reasonable costs (including insurance) of storage in such circumstances delivery is deemed to have taken place in the case of Goods delivered at the Premises on the date upon which the Company notified the Customer that the Goods were ready for collection and in the case of Goods delivered otherwise than at the Premises on the date upon which delivery was tendered by the Company.
- 4.4 Any claim by the Customer for short delivery must be notified to the Company in writing within seven days of delivery.
- 4.5 Failure by the Company to deliver one or more instalment of an Order in accordance with the Conditions shall not entitle the Customer to treat the Agreement as a whole as repudiated.
- 4.6 If the Company fails to deliver the Goods for any reason other than any cause beyond the Company's reasonable control or the Customer's fault, the Company's liability shall be limited to the excess (if any) of the cost to the Customer (in the cheapest available market) of similar Goods. The Customer shall be deemed to have accepted the Goods upon delivery.

5 Returns

- 5.1 Goods may not be returned without the written consent of the Company. Goods accepted for return are subject to a handling charge of 25% of the price of the Goods (exclusive of VAT), such charge to be paid on demand.
- 5.2 All costs of returning the Goods to the Company shall be borne by the Customer. Goods are returned at the risk of the Customer and any repairs undertaken by the Company in respect of damage caused in transit during their return will be charged to the Customer. All returned Goods must be accompanied by the original packing note together with details of the reason for return.
- 5.3 Any Goods in which title has passed to the Customer and which are returned to the Company shall become the property of the Company.

6 Title and Risk

- 6.1 Title shall pass to the Customer on payment in full of the price of the Goods and of any other sums due and payable by the Customer at any time.
- 6.2 The Company shall be entitled to recover the price and any other sums due notwithstanding that title in the Goods has not passed to the Customer.
- 6.3 The Customer shall hold the Goods as the Company's fiduciary agent and

bailee, and shall keep the Goods separate from those of the Customer and third parties and properly stored, protected and insured and identified as the Company's property until such time as title passes to the Customer and shall deliver up the Goods to the Company upon demand.

- 6.4 The Customer grants to the Company a full irrevocable licence to enter upon any premises in which the Goods are stored or installed (or are reasonably believed by the Company to be), to detach the Goods from any equipment to which they may be attached, and to repossess, sell or deal with any of the Goods in which title remains vested in the Company and the Customer will indemnify the Company in respect of any loss of damage or deterioration to the Goods resulting from any such action.
- 6.5 The Customer shall not pledge or in any way charge any of the Goods which remain the property of the Company, but if the Customer does so all money owing by the Customer to the Company shall (without prejudice to any other rights or remedy of the Company) forthwith become due and payable.
- 6.6 The Company may at any time by written notice to the Customer revoke the Customer's right to re-sell the Goods where title thereto has not passed to the Customer. Upon such revocation all such amounts payable in respect of the Goods which have been re-sold shall immediately become due notwithstanding that any period of credit permitted may not have expired. In the event that the Customer has sold or otherwise parted with possession of any part of the Goods before payment has been received in full by the Company, the Customer shall hold the proceeds of such sale (or in the case of payment not having been made the debt owed to the Customer by the sub-purchaser) up to the amount or value of the Customer's indebtedness as agent and trustee for the Company and shall account to the Company on demand.
- 6.8 Risk of damage or loss shall pass to the Customer, in the case of Goods delivered at the Premises at the time when the Company notifies the Customer that the Goods are available for collection or, in the case of Goods to be delivered otherwise than at the Premises at the time of delivery.

7 Warranty

- 7.1 Subject to clause 7.2 the Company warrants that the Goods will correspond with their Specification (if any) at the time of delivery and will be free from defects in material and workmanship for a period of five years from the date of delivery.
- 7.2 The Company shall have no liability for defects in the Goods arising or resulting from:-
 - 7.2.1 parts, materials, or equipment not manufactured by the Company in respect of which the Customer shall only be entitled to the benefit of any such warranty or guarantee as is given by the manufacturer to the Company;
 - 7.2.2 fair wear and tear, improper or inadequate installation, use or maintenance, accidental or willful damage, negligence, abnormal working conditions, failure to follow the Company's instructions (whether oral or in writing), misuse or modification or alteration or repair of the Goods by unauthorised third parties or the Customer; and
 - 7.2.3 any incorrect Specification.
- 7.3 Notwithstanding clause 7.1 the Company shall be under no liability for any warranty, condition or guarantee if the price has not been paid by the due date for payment.
- 7.4 Except where the Goods are sold to a person dealing as a consumer (within the meaning of the Unfair Contract Terms Act 1977), the warranty contained in 7.1 is given in place of all warranties, conditions, terms, undertakings and obligations express or implied by statute, common law, custom, usage, trade course of dealing or otherwise (including but not limited to fitness for a particular purpose), all of which are excluded to the fullest extent permitted by law.
- 7.5 The Company shall within the warranty period repair or at its option replace any defective Goods where such defects appear under proper use provided that the Customer receives written notice from the Customer of any alleged defects and the Goods are returned by the Customer to the Premises before the expiry of the warranty period.
- 7.6 Repaired or replaced Goods shall be redelivered by the Company free of charge to the original point of delivery. Repaired or replaced Goods are subject to these Conditions except that in the case of repaired goods, the five year period referred to in Clause 7.1 shall be replaced by the unexpired period of the warranty.
- 7.7 The Company shall at its sole discretion be entitled to supply an advance replacement of the defective Goods. For the avoidance of doubt it is confirmed that the Company has no obligation to supply an advance replacement of the defective Goods. In the event that an advance replacement is supplied and the Goods are not defective the Customer shall be liable to pay the price of both the advance replacement and the Goods.

8 Intellectual Property Rights

- 8.1 Subject to clause 8.2 in the event that any claim is made against the Customer for infringement of intellectual property rights arising directly from the use or sale by the Customer of the Goods, the Company at its own expense shall conduct any ensuing litigation and all negotiations for settlement of the claim. The Company will bear the cost of any payment made in settlement of or as a result of an award in a judgement against the Customer.
- 8.2 The Customer shall give to the Company at the earliest possible opportunity notice in writing of any claim being made or action threatened or brought against it, shall make no admission of liability or take any other action in connection therewith, shall permit the Company to have conduct of the claim pursuant to clause 8.1 and shall (at the Company's expense) give all reasonable information, co-operation and assistance to the Company (including without limitation lending its name to proceedings) in relation to the conduct of the claim. If it is made a condition of any settlement made by the Company of any judgement awarded against the Customer pursuant to clause 8.1, the Customer shall return or destroy as applicable all infringing Goods still under its control subject to a refund by the Company of any payment for such Goods already made less a reasonable allowance of a depreciation of the Goods by reason of their use (if any) by the Customer prior to their return or destruction aforesaid.
- 8.3 The provisions of clause 8.1 shall not apply to any infringement caused by the Company having followed a Specification nor to any use of the Goods in a manner or for a purpose which shall have been specifically prohibited in writing by the Company nor to any infringement which is due to the use of the Goods in association or combination with any other product.
- 8.4 If the Goods are to be manufactured or any process is to be applied to the Goods by the Company in accordance with a Specification the Customer shall indemnify the Company against all loss, damages, costs and expenses awarded against or incurred by the Company in connection with, or paid or agreed to be paid by the Company in settlement of any claim for infringement of any intellectual property rights whatsoever which results from the Company's use of the Specification.
- 8.5 With respect to the goods, the Customer agrees and acknowledges:
 - 8.5.1 that all copyright and other intellectual property rights (including but without limitation, patent, copyright trademark, registered design or other industrial property right) in and relating to the products supplied by the Company is the property of the Company (or its supplier as applicable) and the Customer agrees that it will not carry out or authorise or procure the carrying out of any act that might infringe such copyright or other intellectual property (including reproducing or authorising or procuring the reproduction of howsoever any item supplied by the Company under or by virtue of any order or contract); and
 - 8.5.2 that it is authorised to use and install the goods owned by it only for the pur-

pose defined in the order or contract and for no other purpose whatsoever; and

- 8.5.3 it will take all reasonable precautions to ensure that no unauthorised person may take or copy from the products any intellectual property rights or technical specifications or copy thereof and that all persons who have access to the products are made aware of the provision of this paragraph.
- ### 9 Liability
- 9.1 Except in respect of death or personal injury caused by the Company's negligence, the Company shall not be liable to the Customer by reason of any representation (unless fraudulent), or any implied warranty, condition or other term, or duty at common law, or under the express terms of the Agreement, or for any economic loss, loss of profit or loss of revenue, loss of business or otherwise whether arising from negligence, breach of contract or otherwise, costs, expenses or other claims for compensation whatsoever which arise out of or in connection with the supply of the Goods or their use or resale by the Customer, and the entire liability of the Company hereunder shall not exceed the price of the Goods except as otherwise expressly provided.
 - 9.2 The Company shall not be liable for any loss, damage or reduction in performance of the Goods which in the reasonable opinion of the Company is attributable to any equipment, products or services not supplied by the Company.
- ### 10 Force Majeure
- Neither party shall be deemed to be in breach of these Conditions or otherwise liable to the other for any delay in performance or any non performance of any obligations hereunder (and the time for performance shall be extended accordingly) if and to the extent that the delay or non performance is due to an event or circumstance beyond the reasonable control of that party.
- ### 11 Notice
- Any notice required to be given or served hereunder shall be given or served by sending the same by first class prepaid letter, telex or facsimile transmission addressed to the parties at their respective addresses set forth on the delivery note or such other address as may be notified from time to time by either party to the other. Any notice so sent shall be deemed to have been given on the second day after posting if it is sent by first class post, on the date of transmission in the case of a facsimile or telex, or on the date of delivery if it is delivered by hand.
- ### 12 Assignment
- The Agreement is personal to the Customer and may not be assigned or otherwise transferred without the written consent of the Company.
- ### 13 Waiver
- No forbearance, delay or indulgence by the Company in enforcing the provisions herein shall prejudice or restrict its rights nor shall any waiver of its rights operate as a waiver of any subsequent breach and no right or remedy herein conferred upon or reserved for the Company is exclusive of any other right, power or remedy available to it and each such right, power or remedy shall be cumulative.
- ### 14 Compliance
- Both parties shall:
- 14.1 comply with all applicable laws, statutes and regulations on anti-corruption, anti-bribery, compliance with embargoes, and on economic, financial and trade sanctions;
 - 14.2 adhere to the Legrand sustainable development and business ethics requirements as set out in the Charter of Fundamental Principles, the guide to Good Business Practices and the Charter for Fair Competition available at www.legrand.co.uk
- ### 15 Confidentiality
- Both the Company and the Customer shall keep confidential and shall not disclose without the prior written consent of the other any technical and commercial information acquired as a result of any communications between them relating to the Contract or the Goods.
- ### 16 Communications
- 16.1 All communications between the parties in respect of the Contract must be in writing and delivered by hand or sent by pre-paid first class post or sent by facsimile transmission (with a hard copy by post).
 - 16.2 In case of communications to the Company to its registered office unless otherwise notified to the Customer by the Company; and in the case of communications to the Customer to its registered office (if a Company) or to its address as set out in the Contract unless otherwise notified to the Company by the Customer.
 - 16.3 Communications shall be deemed to have been received if sent by pre-paid first class post, two working days (i.e. excluding Saturdays, Sundays and bank and other UK public holidays) after posting; if delivered by hand, on the day of delivery; or if sent by facsimile transmission on a working day prior to 4.00 p.m., at the time of transmission and otherwise on the next working day.
- ### 17 Entire Agreement
- 17.1 These Conditions constitute the entire and only agreement between the parties and supersede any and all prior proposals, agreements negotiations and discussions between the parties.
 - 17.2 The Customer acknowledges that in entering into the Agreement it does not do so on the basis of and does not rely on any representation, warranty or other provision except as expressly herein provided and all conditions, warranties or other terms implied by statute or common law are hereby excluded to the fullest extent permitted by law.
- ### 18 Partial Invalidation
- If any provision herein proves to be legally invalid this shall not affect the validity of the remaining provisions hereof which shall continue in full force and effect.
- ### 19 Variation
- These Conditions may not be varied or amended unless such variations or amendments are agreed in writing by both parties.
- ### 20 General
- 20.1 Any reference to any statute or statutory provision includes a reference to that statute or statutory provision as from time to time amended, extended or re-enacted.
 - 20.2 Any reference to a party includes a reference to its successors in title and permitted assigns.
- ### 21 Law
- These Conditions shall be governed by the laws of England and the parties hereby irrevocably agree to submit to the exclusive jurisdiction of the English Courts.

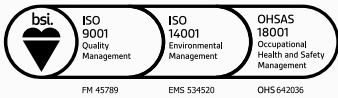

www.cpelectronics.co.uk

CP Electronics
 A business unit of Legrand Electric Limited,
 Brent Crescent,
 London NW10 7XR, UK
 +44 (0)333 900 0671
info@cpelectronics.co.uk

connect with us    

A brand of  **legrand®**