



**Dry Laid Underfloor
Heating Solutions**

Mojave Gobi

Why CELLECTA?

CELLECTA is the UK's leading innovator, manufacturer and supplier of environmentally friendly, high performance thermal and acoustic insulation products and underfloor heating solutions.

For over 25 years our products have been successfully installed in a myriad of residential, commercial, educational, health and industrial buildings.

CELLECTA's team of experienced staff are able to offer unrivalled customer support, from delivering RIBA certified CPDs, assisting in selecting the most suitable product that satisfies current legislation, arranging delivery of the right materials direct to site on time, to providing after sales installation instructions to ensure customer satisfaction.



FREE services offered by CELLECTA:

- Technical and installation advice
- Architectural drawings and NBS specs
- U-value and imposed load calculations
- Site surveys and take-off service
- Arrange acoustic testing
- Present RIBA certified CPDs



sponsoring organisation



01634 29-66-77

01634 22-66-30

technical@collecta.co.uk

collecta.co.uk



Dry Laid Underfloor Heating Solutions

Mojave Gobi

1120

PART E&L SOLUTIONS
SECTION 5&6 SOLUTIONS



- Low Profile, as thin as 15mm
- Ideal for refurbishment applications
- Directly accepts floor tile
- Ultra high compressive strength - 500kPa
- High thermal performance
- Manufactured to suit pipe and spacing required
- 15, 18, 20, 25mm x 600mm x 1200mm



Mojave



Gobi





Mojave®

Dry Laid Underfloor Heating System for Level Floors

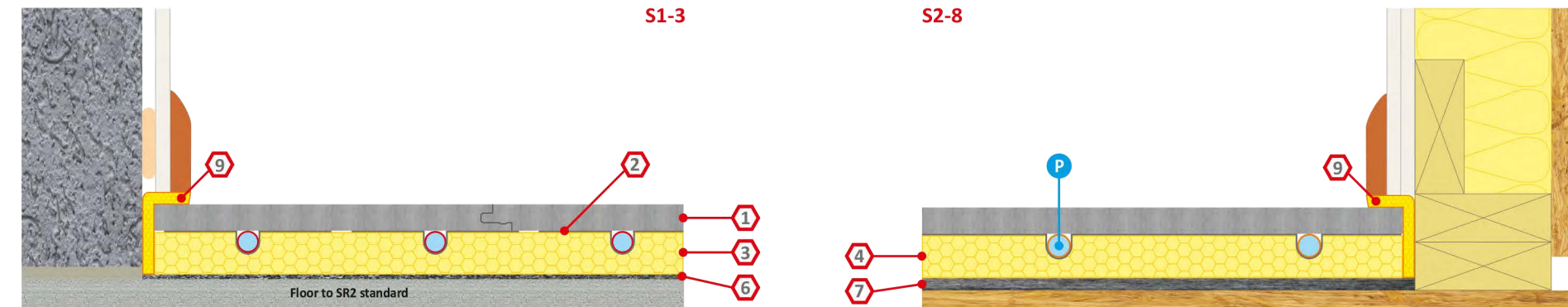

- 1 ScreedBoard® 20™**
Highly Conductive Interlocking Floorboard
- 2 ULTRAplate 11**
Aluminium Heat Diffuser Plate
- 3 XFL®**
High Strength Underfloor Heating Board
- 4 XFL® FF**
Foil Faced High Strength UFH Board
- 5 XFL® Micro**
Ultra Thin UFH Insulation Floorboard
- 6 RUBBERfon® Impact**
High compressive Strength Resilient Layer
- 7 FIBREfon® 8**
High Performance Resilient Layer
- 8 FIBREfon® 10**
High Load Resilient Layer
- 9 YELOfon® ESS**
Polyethylene Perimeter Edge Strip
- 10 CELLECTA PRO Adhesive**
Multi Purpose Expanding Joint Adhesive

- Perfect for underfloor heating applications
- 3x more thermally conductive than chipboard
- Robust Detail E-FS-3, E-FT-5, E-FT-6 proprietary overlay board & FFT4 compliant
- Unique interlocking edge detail
- Made from 100% recycled materials
- 20mm x 600mm x 1200mm
- Highly conductive, increases the UFH's efficiency
- Made from high quality aluminium plate
- Manufactured to suit pipe diameter used
- 10, 12, 15, 16, 20mm x 1300mm x 1000mm
- Available in three compressive strengths: 250, 300 & 500* kPa
- Manufactured to suit pipe and spacing required
- Works in conjunction with acoustic treatments
- Robust Detail compliant component
- 20, 25, 30, 40, 50, 60, 75mm x 600mm x 1250*/2500mm
- Aluminium foil facing for improved heat diffusion
- Available in three compressive strengths: 250, 300 & 500* kPa
- Manufactured to suit pipe and centres required
- Aluminium facing option available
- Easy to cut to size and install
- Patent pending
- 15, 18, 20, 25, 30, 40, 50, 60, 75mm x 600mm x 1250*/2500mm
- Low profile board
- Ultra high compressive strength - 500kPa
- Manufactured to suit pipe and centres required
- Aluminium facing option available
- Easy to cut to size and install
- Patent pending
- 15, 18, 20, 25mm x 600mm x 1200mm
- High sound deadening properties
- Available in 3, 5, 6 & 8mm thickness
- Suitable for all types of concrete floors where a high resistance to compression is required
- Made from recycled rubber
- 3mm x 1m x 15m, 5mm x 1m x 10m, 6mm x 1m x 8m, 8mm x 1m x 6m
- Outstanding impact sound reduction properties
- Proprietary resilient layer for RID E-FS-3, E-FT-5 & 6
- Robust Detail E-FS-1, E-FC-1 & 2 compliant
- Made from recycled polyester
- 8mm x 600mm x 1200mm
- Excellent impact sound reduction properties
- High compressive strength
- Robust Detail E-FS-1, E-FC-1 & 2 FFT4 compliant
- Made from recyclable wood fibre
- 10mm x 600mm x 1200mm
- Superior sound and isolation properties
- Suitable for concrete, steel and timber floors
- High compressive strength
- Easy to install
- ESS/100: 5mm x 100mm x 50m
- ESS/120: 5mm x 120mm x 50m
- ESS/150: 5mm x 150mm x 50m
- Other sizes made to order
- Ultra-strong bond adhesive
- Expands to fill any void in the joint
- Suitable for bonding ScreedBoard 20
- 1kg bottles
- Enough for 33m² of ScreedBoard 20

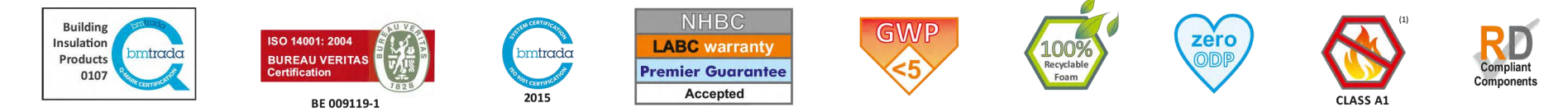

- ### Benefits of the Mojave® System
- Rapid heat response times
 - Dry Installation, no added moisture to build
 - Superior output - Up to 100W/m²
 - Performs at a low flow temperature
 - Low energy use, reducing running costs and CO₂ emissions
 - Works in combination with all pipe diameters (10-20mm)
 - System as thin as 35mm
 - Suitable for concrete, steel and timber floors
 - High compressive strength resilient layer options, ideal for floors with brittle finishes
 - 100% recycled gypsum and cellulose overlay board, recyclable thermal and acoustic insulation
 - Outstanding acoustic performance - Robust Detail treatment
 - Speeds up the installation of floor finishes
 - Components supplied from one source, on one lorry, reducing environmental impact during the build

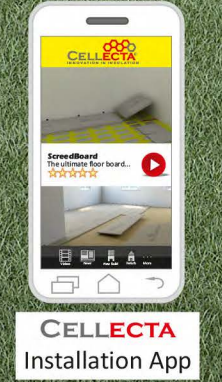

Gobi®

Dry Laid Underfloor Heating System for Uneven Floors

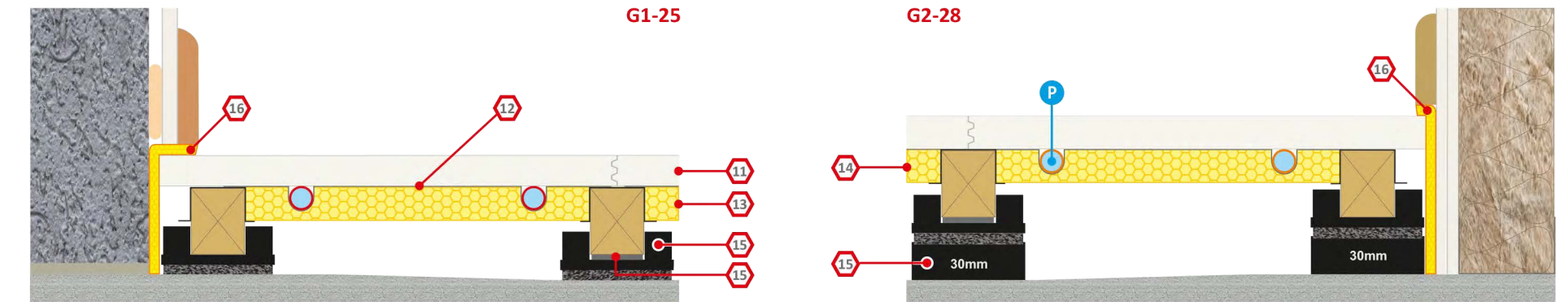

- 11 HIDECK® Structural™**
Highly Conductive Structural Floorboard
- 12 ULTRAplate 21/31**
Aluminium Heat Diffuser Plates
- 13 XFL® JB**
Between Batten UFH Board
- 14 XFL® JB FF**
Foil Faced Between Batten UFH Board
- 15 RUBBERfon® Cradles**
Acoustic Levelling Cradle & Batten System
- 16 YELOfon® ESS**
Polyethylene Perimeter Edge Strip
- 17 CELLECTA PRO Adhesive**
Multi Purpose Expanding Joint Adhesive
- 18 FIBREfon® Micro 50**
Non-itch Sound Absorbing Quilt
- 19 CELLECTA AH50**
High performance Acoustic Ceiling Hangers

- Highly conductive, ideal for underfloor heating applications
- Outstanding performance - Robust Detail proprietary structural board for FFT2
- Suitable for all types of steel, concrete & wooden floors
- 25, 28 & 30mm x 600mm x 1200mm
- Highly conductive, increases the UFH's efficiency
- Made from high quality aluminium plate
- 150mm and 200mm centres
- Two (2) or three (3) impressions
- Manufactured to suit pipe diameter used
- 10, 12, 15, 16, 20mm x 390mm x 1000mm
- Excellent thermal performance
- Fit between timber battens
- Manufactured to suit pipe and spacing required
- 30, 40, 50mm x 300mm x 1250mm
- 30, 40, 50mm x 350mm x 1200mm
- Aluminium foil facing for improved heat diffusion
- Excellent thermal performance
- Fit between timber joists or battens
- Manufactured to suit pipe and spacing required
- 30, 40, 50mm x 300mm x 1250mm
- 30, 40, 50mm x 350mm x 1200mm
- High compressive Strength Resilient Layer
- High Performance Resilient Layer
- High Load Resilient Layer
- Polyethylene Perimeter Edge Strip
- Multi Purpose Expanding Joint Adhesive
- Non-itch Sound Absorbing Quilt
- High performance Acoustic Ceiling Hangers
- Levels uneven structural floors
- Made from high impact plastic
- Incorporates recycled rubber acoustic pad
- Outstanding acoustic performance
- Suitable for all floor types
- Robust Detail FFT2 compliant
- Three packers available: 2, 3 & 5mm
- Two elevation blocks: 15 & 30mm



- ### Benefits of the Gobi® System
- Levels up an uneven sub-floor
 - Dry Installation, no added moisture to build
 - Rapid heat response times
 - Imposes lower load on the structure compared to a screed
 - Superior output - Up to 100W/m²
 - Performs at a low flow temperature
 - Low running costs, reducing CO₂ emissions
 - Works in combination with all pipe diameters (10-20mm)
 - Suitable for concrete, steel and timber floors
 - Provides stiff floor able to accept all floor coverings, including brittle finishes
 - 100% recycled gypsum and cellulose overlay board, rubber acoustic pads and recyclable thermal insulation
 - Outstanding acoustic performance - Robust Detail treatment
 - Components supplied from one source, on one lorry, reducing environmental impact during the build