

Data Sheet

Down Lights 8"



Features

- Energy Saving
- Low heat, No UV, or IR light radiation
- Light source: SMD LED
- Long life time > 30,000 hours
- Power consumption up to 14W
- High power driver efficiency > 50%
- CE, FCC Approved
- IP 43

Typical Application

- Indoor Lighting
- Architectural Lighting
- Conference Lighting
- Mood Lighting
- Biological Lighting
- Hospital Lighting
- Commercial and Industrial Lighting



Life Span	30,000 hrs
Total Power Consumption	14W
Working Voltage	DC18-22V
Size	235mm x 235mm
Beam Angle	105°
CRI	Cool White Ra=65 Warm White Ra=54 Natural White Ra=74
Colour Temperature	Cool White 6000K Warm White 3000K Natural White 4000K
Lumens	Cool White - 774lm Warm White - 664lm Natural White - 768lm
Material	Aluminium Alloy Frame
Net Weight	660g
Operational Temperature	-20 to 40°C
Frequency(Hz)	50 Hz

Model Number DL8SA14C

Model Number DL8SA14W

Model Number DL8SA14N

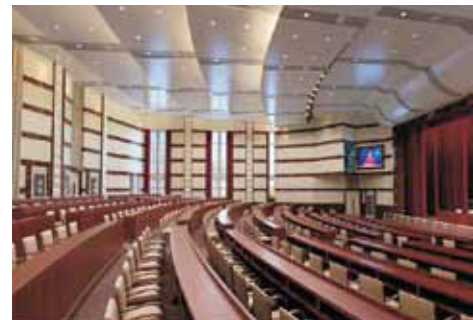

8" Non Dimmable Driver
LED Constant Current Driver
Input: 100-240VAC/50-60Hz0.3A
Operating Temperature: 40°C
Output Voltage: DC18-22V
Output Constant Current: 0.6A



8" Dimmable Driver
LED Adjustable Current Driver
Input: 220-240V/60Hz
Operating Temperature: 40°C
Output Voltage: DC18-22V
Output Constant Current: 0.6A (max)

Cool White

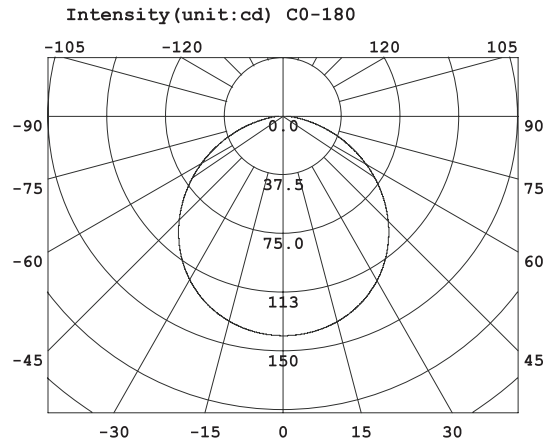
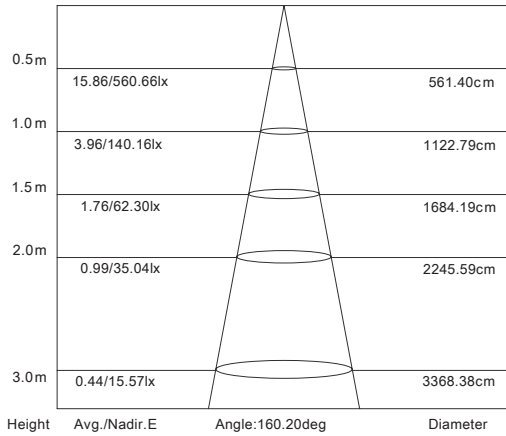

Warm White

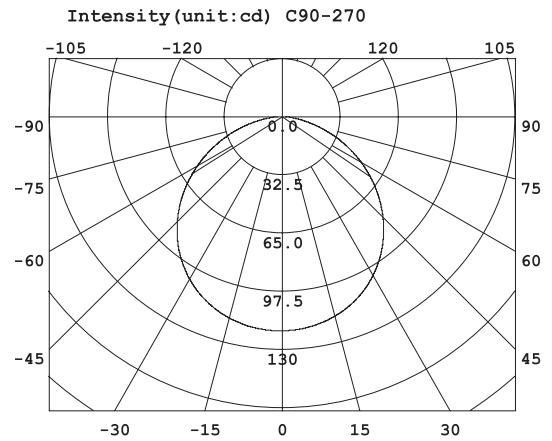
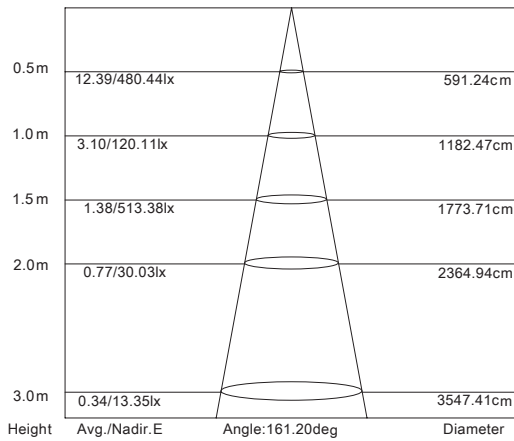

Natural White

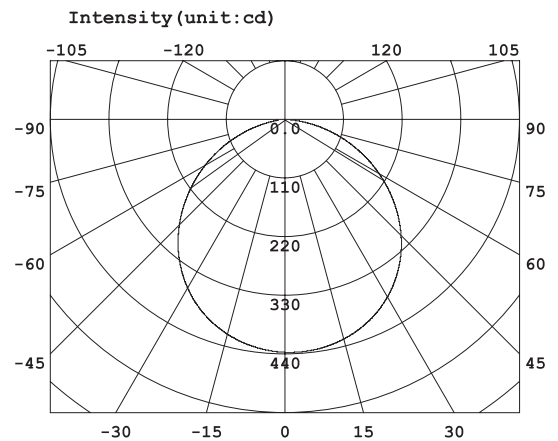
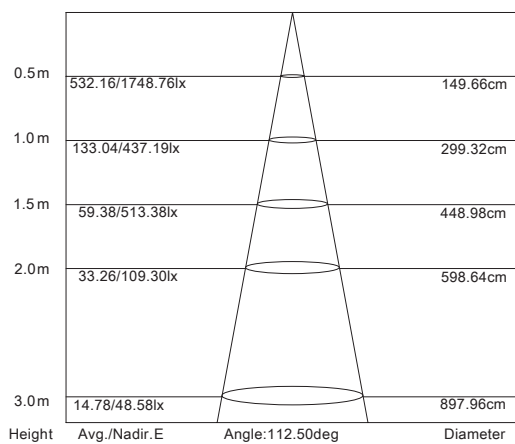

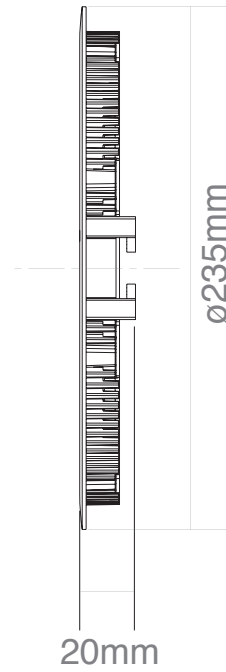
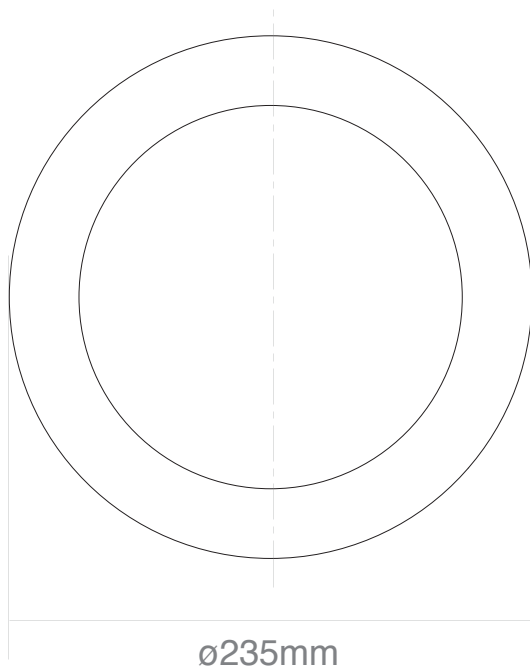

①	make a hole	A	Wall
②	connect the power wire	B	Spring
③	push spring	C	LED lamp
④	put the lamp into the hole	D	Driver

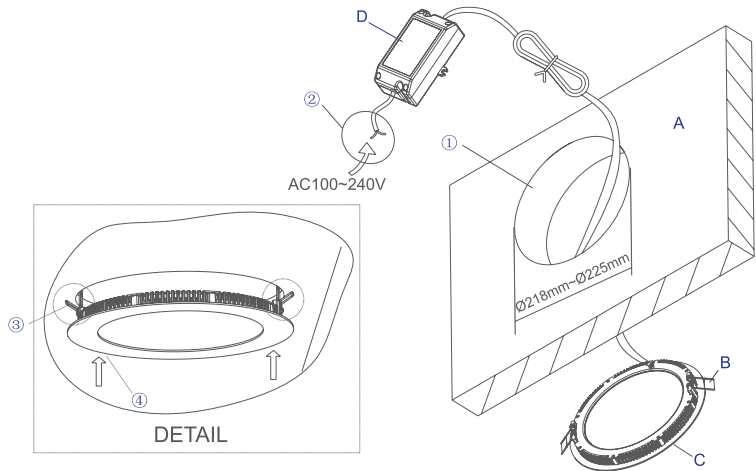

Disclaimer

The information contained in this document is subject to change without notice.

Copyright

This document contains proprietary information that is protected by copyright. All rights are reserved. No part of this document may be reproduced, stored in a retrieval system, or transmitted, in any form or by any means, electronic, mechanical, photocopying, recording, or otherwise, without the prior written consent of:

Bri-Tek

Head Office:

Unit D3C, Edgefold Industrial Estate
 Smethurst Lane, Farnworth, Bolton, BL4 0JW
 Tel: +44 (0) 161 850 0905 Fax: +44 (0) 161 850 0907
 Web: www.britektechnologies.co.uk
 Email: enquiries@britektechnologies.co.uk