

Maintenance

- Caution !** Do not use water near the drive unit and control box.
- Warning !** Switch the power supply off before carrying out any maintenance and/or other work on the speedlane.
- Weekly:** Clean the stainless steel surfaces with a damp cloth.
- Monthly:** Clean the stainless steel surfaces with a damp cloth and soft soap.
- Annually:** The Speedlane needs to be serviced at least once a year. This service and any repairs should be performed by Boon Edam or your dealer.



Test the emergency and safety devices every day and check that the Speedlane is generally working properly !

Dealer

For further information, consult the operating manual.

Instruction Card

Speedlane 300

Safety devices

Working principles

Security devices (alarms)

Control Panel (optional)

Maintenance

Key to Symbols

	Doors will open		Authorisation to allow a person in (Pulse in)
	Doors will close		Authorisation to allow a person out (Pulse out)
	Doors will lock in open position		Access open (free in and out)
	Doors will lock in closed position		Locked
	Doors will not open		Person passing detection area in or out
	Person may pass		Person passing detection area not in or out
	Person may not pass		More than one person passing detection area in
	Alarm with optical and acoustical signal		More than one person passing detection area out
	No power supply		More than one person passing detection area in or out
	Fire alarm, leave premises through emergency exit		Press the touch sensitive sensor for free exit
	People leaving premises		
		*	Option

Safety devices

A. The Speedlane safety devices

1 Optical safety

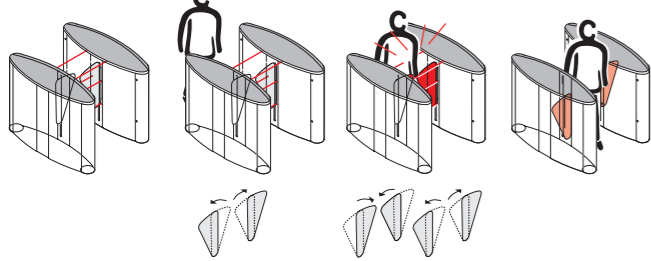

2 Mechanical safety

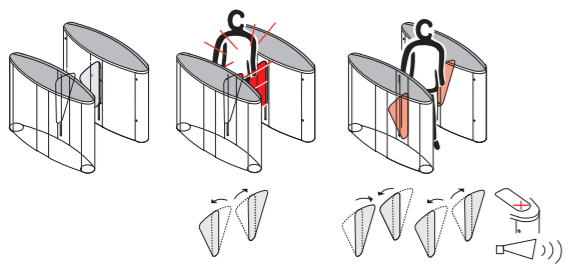

3 Emergency power supply

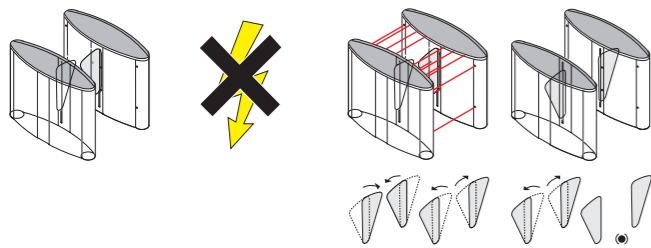

4 Fire alarm

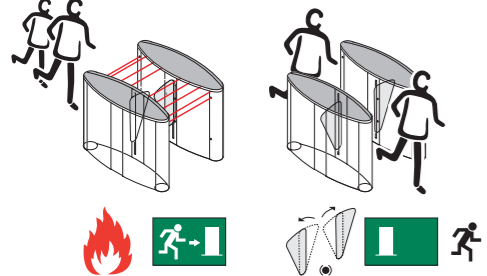

Working principles

B. The working principles of the speedlane

1 Controlled access pulse in

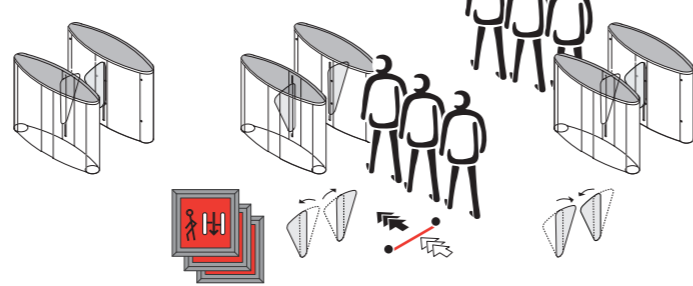

2 Controlled access pulse out

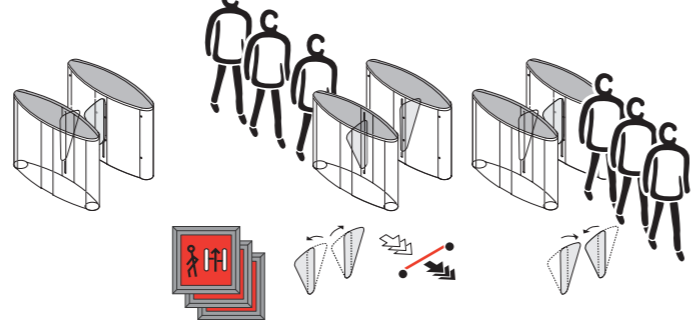

3 Free out*

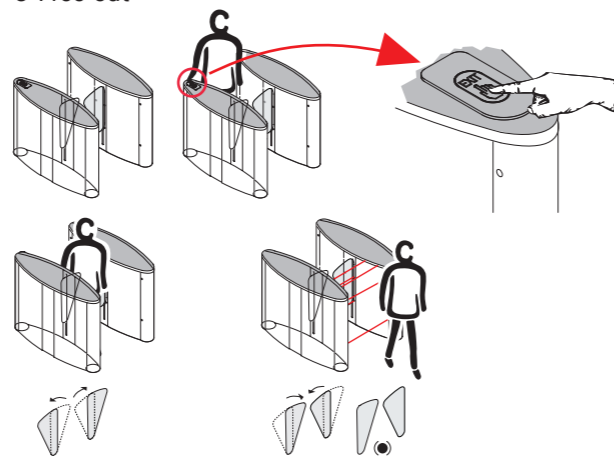

Security devices (alarms)

C. Security devices

1 Intruder alarm



2 Tailgating alarm: 2 people, one behind the other, space > 30 cm

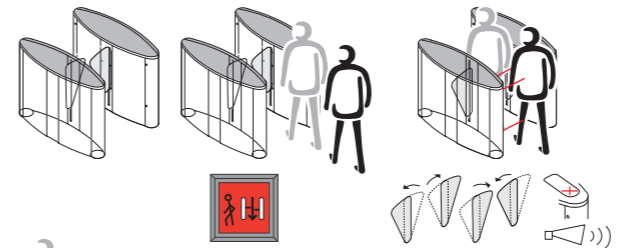

3 Opposite direction alarm

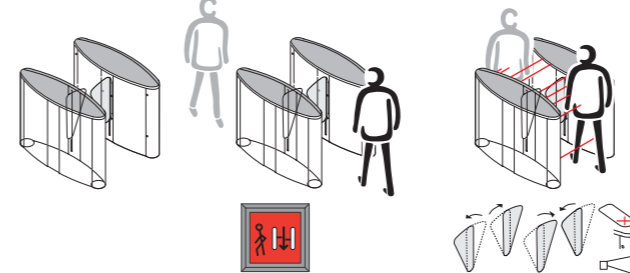

4 Crawl through alarm

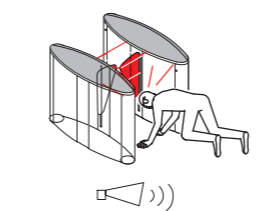

Control panel (optional)

D. Control panel

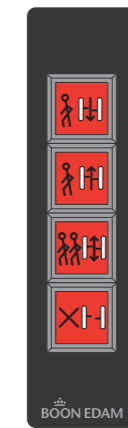

1 Pulse in

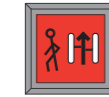

2 Pulse out



3 Access open

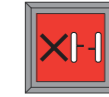

4 Locked

1 Pulse in

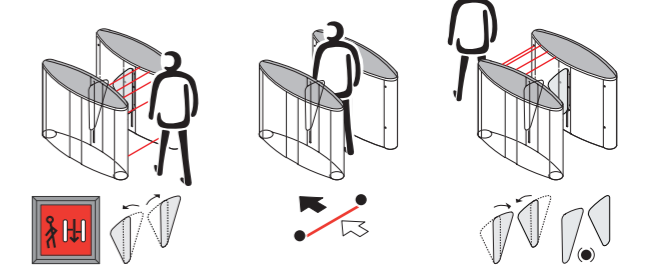

2 Pulse out

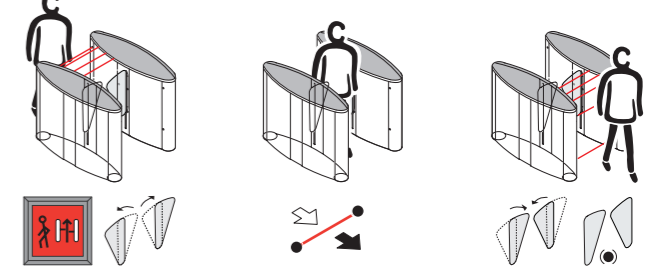

3 Access open

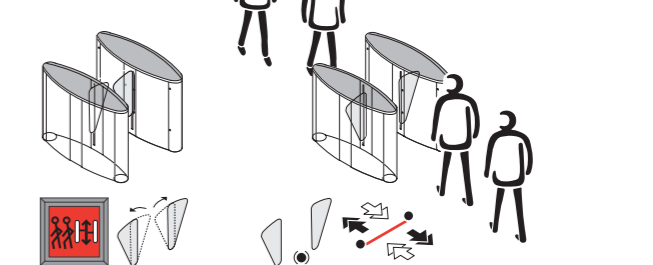

4 Locked

