

MS100/5/S/P15

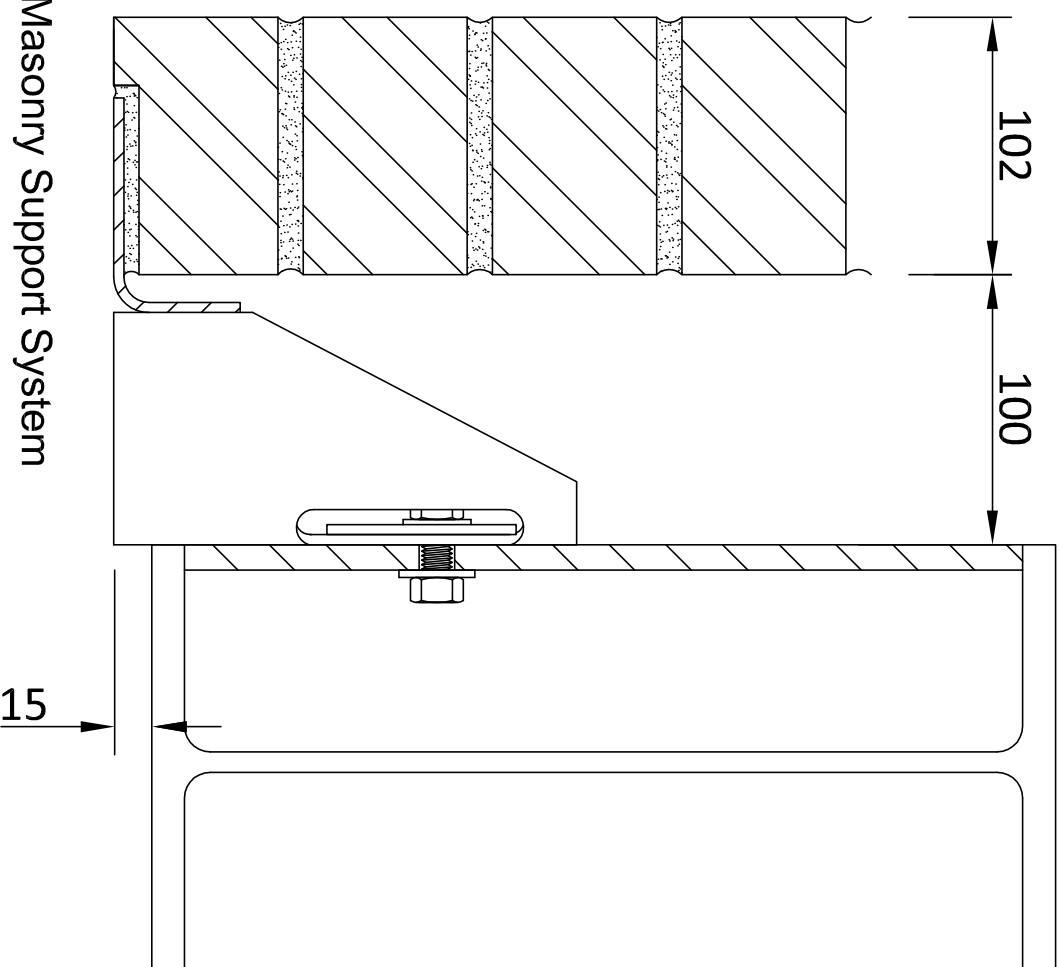

Expamet BAT Masonry Support System

Expamet MS100/5/S/P15 fixed to steel beam using set screws
c/w nut, washer and adjustment plate.

Example specification code : MS100/5/S/P15

(100 cavity, carrying 5000mm of brickwork fixed with set screws
with a 15mm projection below the RHS)