

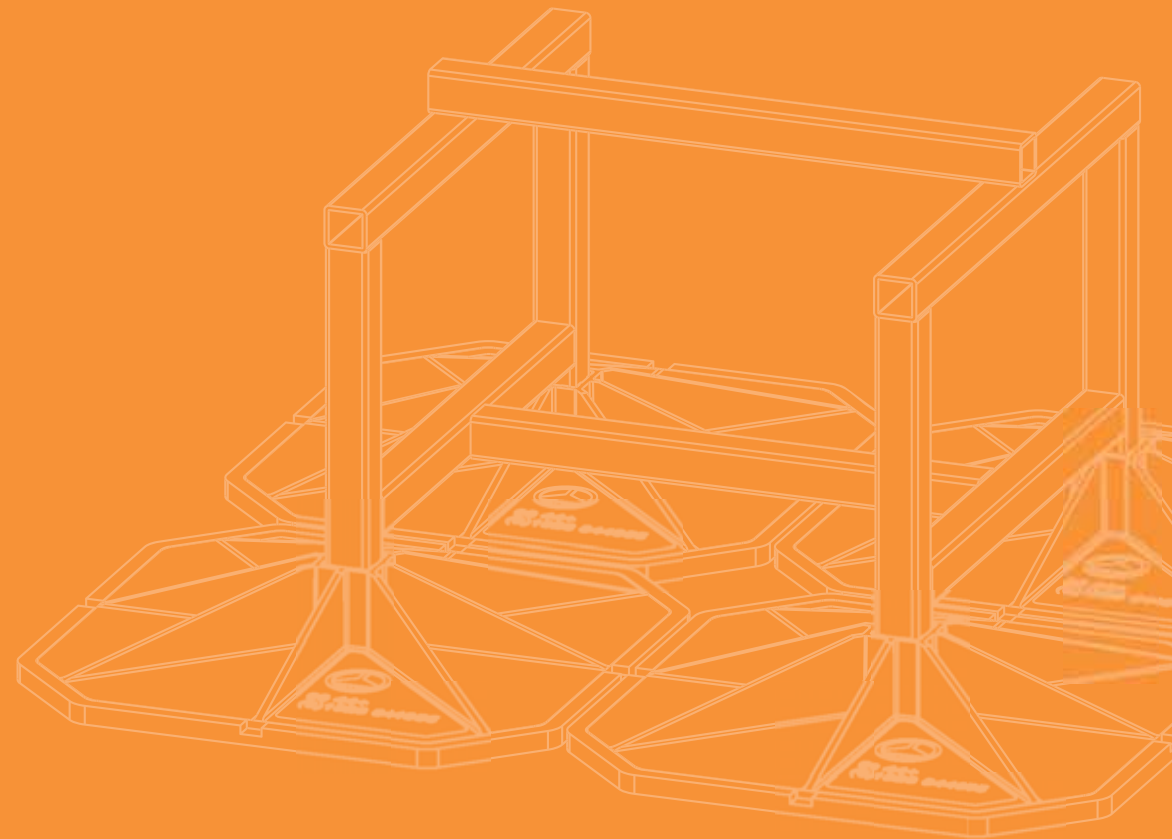

Heavy Duty Support

The Big Foot Systems Heavy Duty range offers a robust cost effective support alternative to on-site concrete constructions. With minimal on-site assembly and easy positioning, the HD Cube and HD Beam products aid load dispersal and are non-penetrative – helping to protect the roof finish.

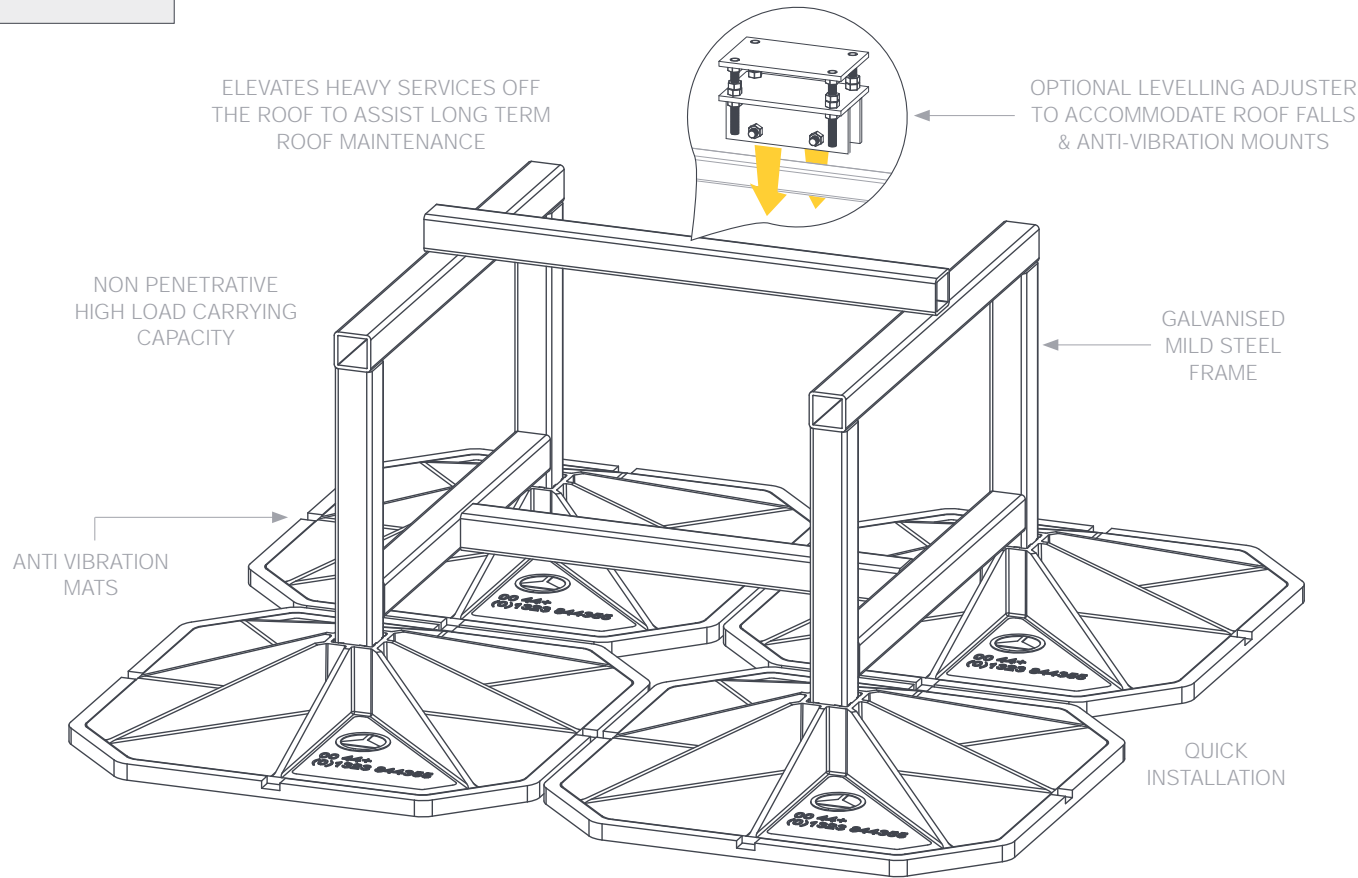



PRODUCT NAME

Big Foot HD Cube

TYPICAL APPLICATION

Chillers | Plant Rooms | Large AHU

FEATURES & BENEFITS

- Optional Certified Independent Warranty
- In-house Computer Aided Design (CAD) Service
- Non penetrative high load management system
- Finite Element Analysis (FEA)
- Load Calculation Service available
- Cost and time effective on-site installation
- Pre-fabricated for consistent and controlled installations
- Ensures greater project design flexibility

CONTACT

+44 (0)1323 844 355

technical@bigfootsystems.co.uk

X TRADITIONAL SUPPORT



✓ BIG FOOT SYSTEM (WARM ROOF DESIGN)

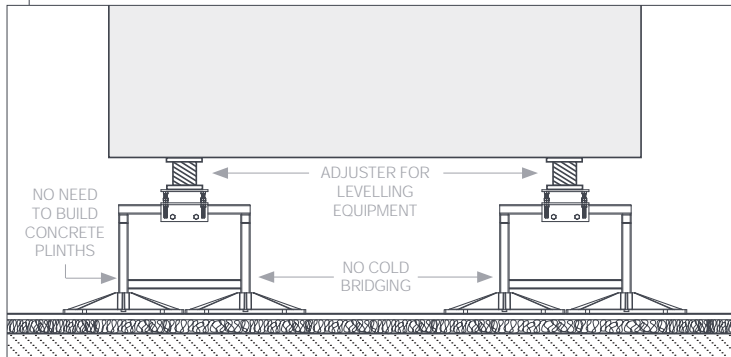

✓ BIG FOOT SYSTEM (INVERTED ROOF DESIGN)



Big Foot Systems Ltd
Apex Way Hailsham
East Sussex BN27 3WA
United Kingdom
www.bigfootsystems.co.uk



Big Foot HD Cube

Typical Application

The HD Cube offers a complete, efficient and robust solution for supporting heavier services on flat roofs. Ideal for the support of large plant rooms, chillers and large air handling units. The HD Cube provides a simplistic approach without the necessity of casting traditional concrete plinths early on in the construction.

Finite Element Analysis (FEA)

Utilising the industry leading ANSYS load analysis programme, specific loading conditions can be calculated with consideration to total weight, weight distribution and dimensions to optimise the HD support framework design solution. FEA calculations are available based on customer supplied information, dependent upon scheme size and complexity.

Technical Information

Model	Part No.	Feet Size (mm)	Height (mm)	Footprint (mm)	Max. Load per Cube (kg)	Packaged Weight (kg)
200HDC	B9378	450 x 450	333	1136	1200	62
200HDC	B9376	600 x 600	333	1292	2000	72
600HDC	B9377	450 x 450	583	1136	1200	75
600HDC	B9375	600 x 600	583	1292	2000	82

200HDC

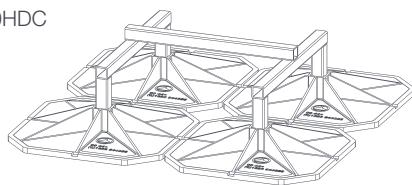

600HDC

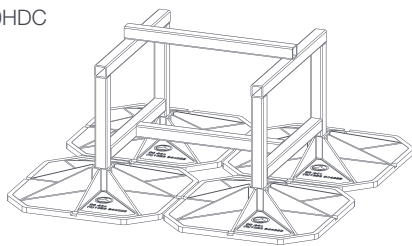

Top Bar: 700mm x 50mm x 50mm box section (5mm Wall)
Frame: 50mm x 50mm box section (5mm Wall)

Kit Includes

- 4 x Feet
- 4 x Anti-vibration mats
- Hot dip galvanised framework

Vertical Adjustment

The minimum height, with the adjuster on top of a 600HD Cube is 640mm and adjusted up to a maximum of 720mm (80mm of adjustment within the adjuster max). 200HD Cube: 240mm minimum up to a maximum of 320mm.

Model	Part No.	Length (mm)	Width (mm)	Weight (kg)
HDC Adjuster	B9374	250	150	3

Material Specification

PLASTIC FOOT

Nylon 6 B601L 30% Glass Fibre Filled

ANTI-VIBRATION MAT

SBR-Recycled Rubber. Bound using a ratio of high quality moisture curing Polyurethane Pre-Polymer. BS7188:1989 & BS5696 Part 3:1979

METAL FRAMEWORK

Hot Dip Galvanised Mild Steel: BS EN 10219-1:1997. Welding Standard: BS EN ISO 15614-1
Galvanising: BS EN ISO 1461:1999
Salt Mist Testing: BSEN60068-2-52
Test Kb Severity 1

WORKING CONDITIONS

Suitable for internal or external applications in temperatures between -30°C to +80°C

Regulations and Standards

- BS8000-4:1989 : Workmanship on building sites. Code of Practice for waterproofing
- BS6229:2003 : Code of Practice for flat roofs with continuously supported coverings
- BS EN 1107-1:2000 : Flexible sheets for waterproofing. Determination of dimensional stability
- BS EN 1850-1:2000 : Determination of visible defects
- BS 747:2000 : Reinforced bitumen sheets for roofing
- BS 8212:1998 : Code of Practice for mastic asphalt roofing

Specification Reference

The contractor will use Big Foot Systems (Tel. +44 (0) 1323 844 355).

HD Cube for the support of the plant and equipment. HD Cube to be provided with HDC Adjuster for levelling. HD Cube to be placed on Big Foot AV mats.

RIBA

RIBA encourages excellence in design, good practice and architectural education and campaigns on important issues such as design standards and sustainability.

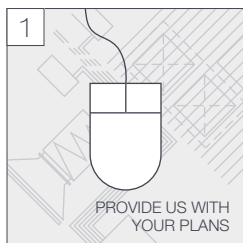

Associated Products

Safe Access

Step Over
Safe personnel access



HD Support

HD Beam
For large heavy pipe support



Services Support

H Frame
For supporting pipes & ductwork



Warranty



Big Foot Systems have an independent warranty which is provided by AWM Ltd. Please see warranty terms and conditions on our website for further details.

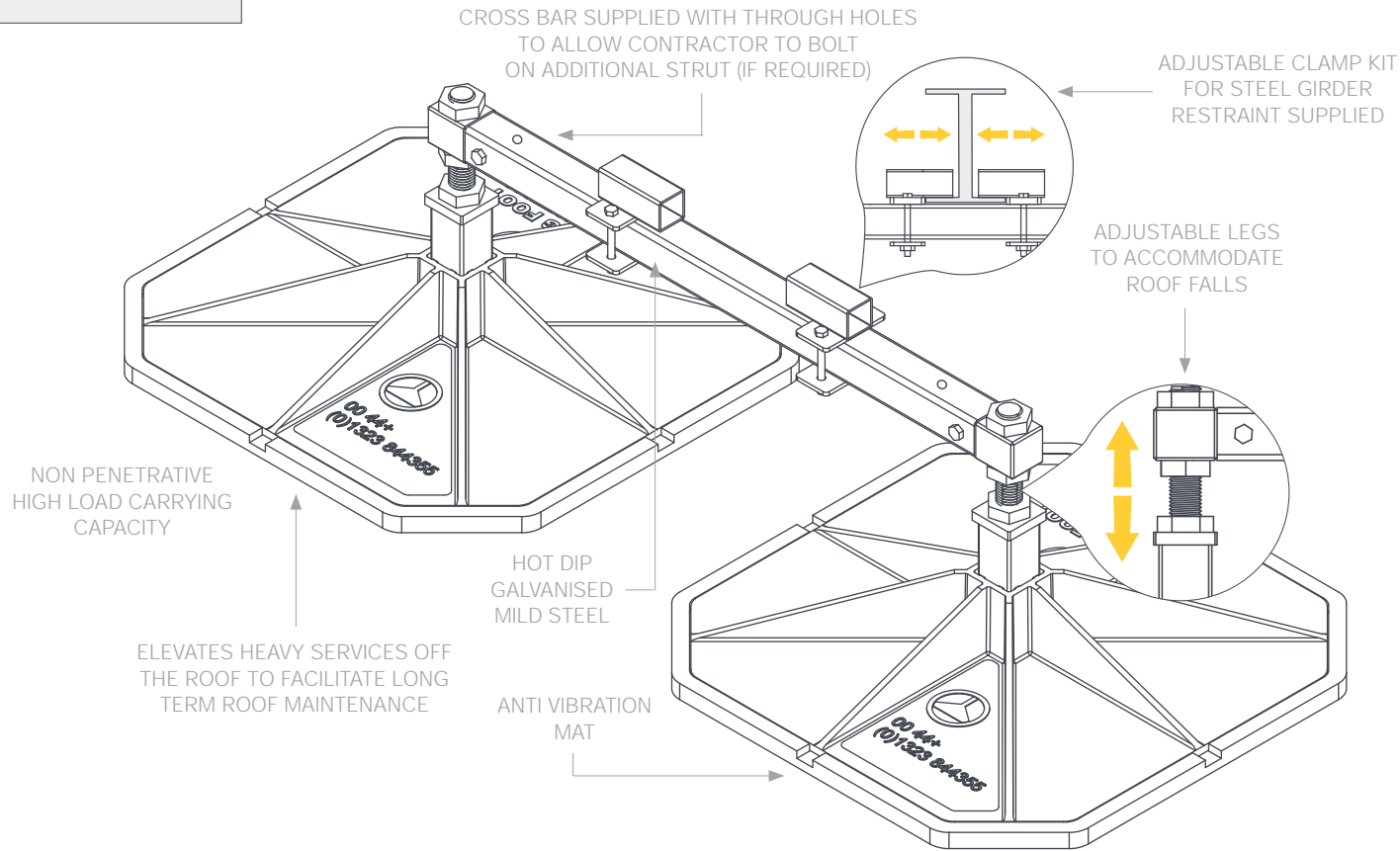

PRODUCT NAME

Big Foot HD Beam

TYPICAL APPLICATION

Steels | Chillers | Plant Rooms | Heavy Pipes & Armoured Cabling

FEATURES & BENEFITS

- Optional Certified Independent Warranty
- In-house Computer Aided Design (CAD) Service
- Non penetrative high load management system
- Finite Element Analysis (FEA)
- Load Calculation Service available
- Cost and time effective on-site installation
- Pre-fabricated for consistent and controlled installations
- Ensures greater project design flexibility

CONTACT

+44 (0)1323 844 355

technical@bigfootsystems.co.uk

X TRADITIONAL SUPPORT



✓ DESIGN DETAIL

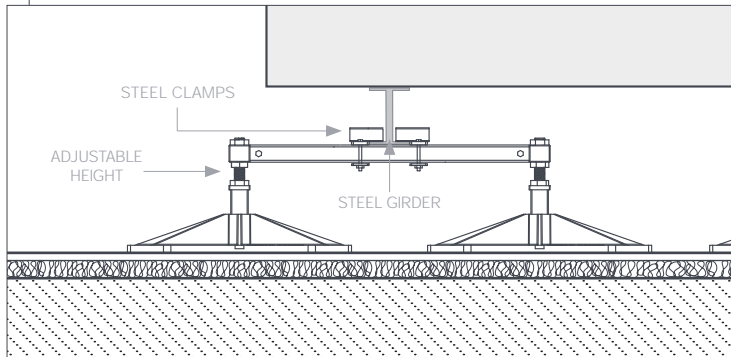

✓ BIG FOOT SYSTEM



Big Foot Systems Ltd
Apex Way Hailsham
East Sussex BN27 3WA
United Kingdom
www.bigfootsystems.co.uk



Big Foot HD Beam

Typical Application

The HD Beam was developed as a lighter weight companion to the HD Cube. Typical applications include large chillers, large air handling units and heavy pipes and services. HD Beam is a robust but flexible solution where space may be limited, or there is a requirement to position directly over existing structural roof beams. With M24 stud built into both legs to accommodate roof falls, the requirement for additional adjustment is not usually needed. An optional, 'quick fitting' Clamp Kit ensures a rigid fit back to the services, or secondary steelwork.

Kit Includes

- 2 x Feet
- 2 x Anti-Vibration mats
- 1 x Adjustable cross beam
- 2 x Clamps
- Assembly instructions

Technical Information

Cross Beam: 800mm x 50mm x 50mm box section
(5mm Wall)

Model (with clamps)	Part No.	Feet Size (mm)	Max Height (mm)	Overall Width (mm)	Overall Length (mm)	Max Load per Beam (kg)	Packaged Weight (kg)
600HDB	B9373	600 x 600	360	642	1392	800	37
450HDB	B9423	450 x 450	360	486	1346	500	35

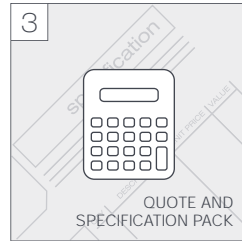
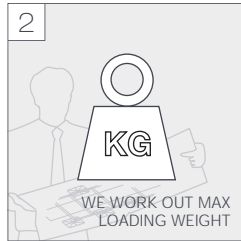
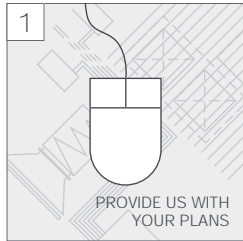

Associated Products



Step Over
Safe personnel access



HD Cube
For large chillers & plant

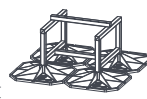

H Frame
For supporting pipes & ductwork



Finite Element Analysis (FEA)

Utilising the industry leading ANSYS load analysis programme, specific loading conditions can be calculated with consideration to total weight, weight distribution and dimensions to optimise the HD support framework design solution. FEA calculations are available based on customer supplied information, dependent upon scheme size and complexity.

HEIGHT ADJUSTMENT

Height adjustment from 255mm to 360mm.
Big Foot Feet can inter-change with our various leg assemblies to offer customers differing support heights and foot prints to suit.

Material Specification

PLASTIC FOOT
Nylon 6 B601L 30% Glass Fibre Filled

ANTI-VIBRATION MAT
SBR-Recycled Rubber. Bound using a ratio of high quality moisture curing Polyurethane Pre-Polymer. BS7188:1989 & BS5696 Part 3:1979

METAL FRAMEWORK
Hot Dip Galvanised Mild Steel: BS EN 10219-1:1997. Welding Standard: BS EN ISO 15614-1
Galvanising: BS EN ISO 1461:1999
Salt Mist Testing: BSEN60068-2-52
Test Kb Severity 1

WORKING CONDITIONS

Suitable for internal or external applications in temperatures between -30°C to +80°C

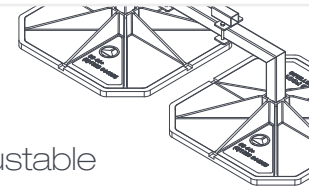

Big Foot Non-Adjustable HD Beam

- 2 x Feet
- 2 x Anti-vibration mats
- 1 x Non-adjustable cross beam
- 2 x Clamps
- Assembly instructions

Part No.	Height (mm)	Width (mm)	Length (mm)	Clearance Height (mm)
B9217	303	642	1392	800

Regulations and Standards

- BS8000-4:1989 : Workmanship on building sites. Code of Practice for waterproofing
- BS6229:2003 : Code of Practice for flat roofs with continuously supported coverings
- BS EN 1107-1:2000 : Flexible sheets for waterproofing. Determination of dimensional stability
- BS EN 1850-1:2000 : Determination of visible defects
- Building Regulations Part L : Conservation of Fuel & Power

Specification Reference

The contractor will use Big Foot Systems (Tel. +44 (0) 1323 844 355).

HD Beam for the support of the plant and equipment. HD Beam to be provided with clamp kits for securing back to the services or secondary steelwork. HD Beam to be placed on Big Foot AV mats.

RIBA

RIBA encourages excellence in design, good practice and architectural education and campaigns on important issues such as design standards and sustainability.



AWM Warranty

Big Foot Systems have an independent warranty which is provided by AWM Ltd. Please see warranty terms and conditions on our website for further details.



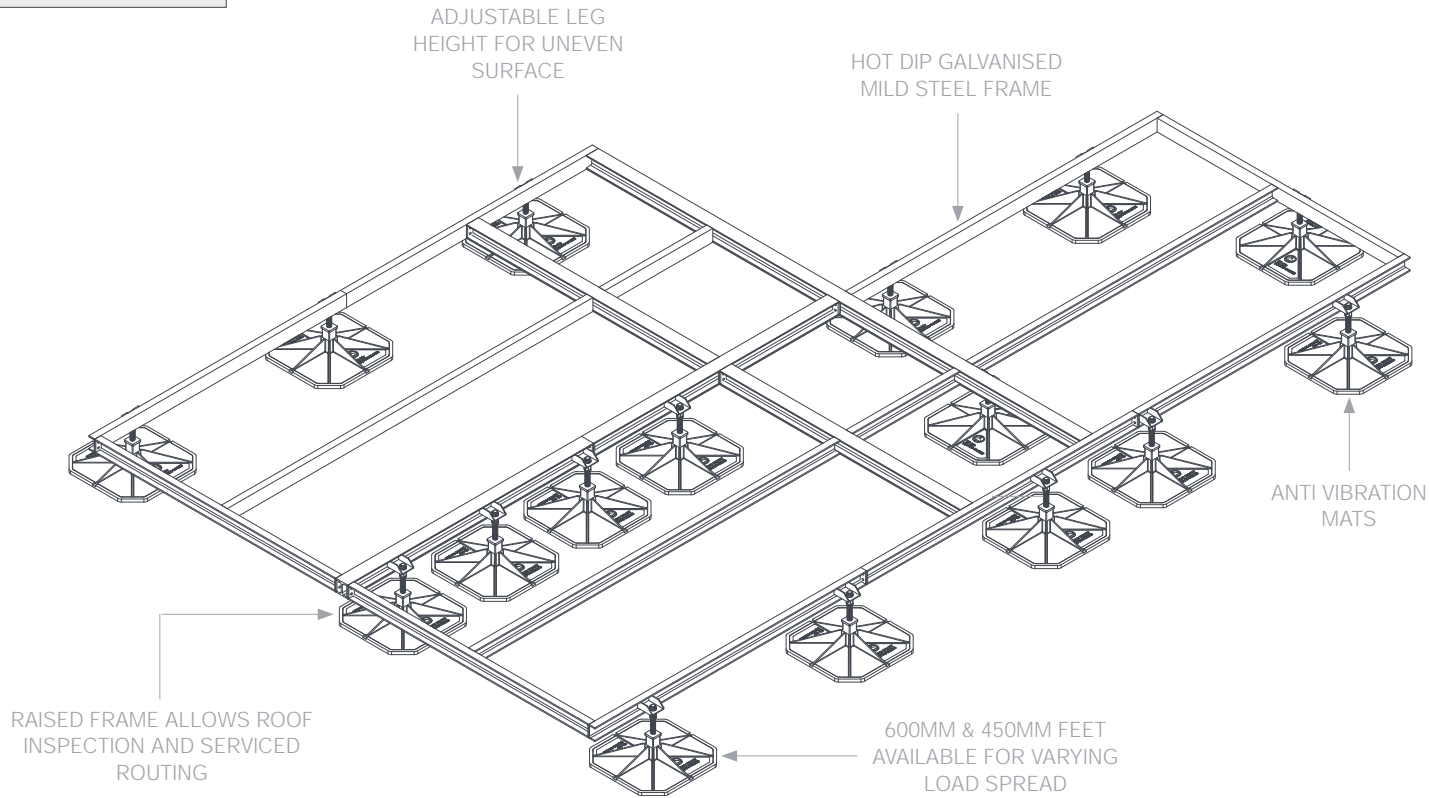

PRODUCT NAME

Big Foot HD Custom Framework

TYPICAL APPLICATION

Large AHU's and Heavy Plant to customer specific requirements

FEATURES & BENEFITS

- Optional Certified Independent Warranty
- In-house Computer Aided Design (CAD) Service
- Non penetrative high load management system
- Finite Element Analysis (FEA)
- Load Calculation Service available
- Cost and time effective on-site installation
- Pre-fabricated for consistent and controlled installations
- Ensures greater project design flexibility

TRADITIONAL SUPPORT



DESIGN DETAIL

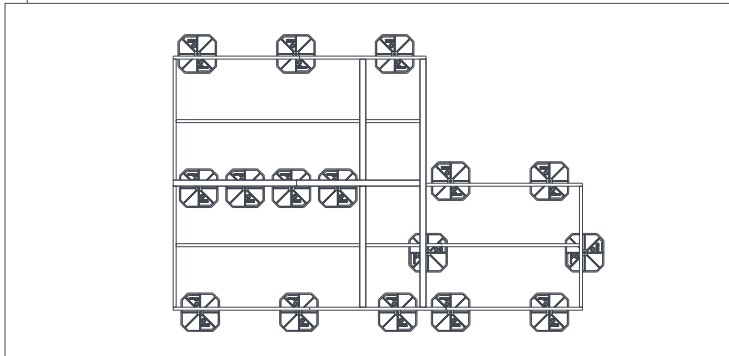

BIG FOOT SYSTEM



CONTACT

+44 (0)1323 844 355

technical@bigfootsystems.co.uk

Big Foot Systems Ltd
Apex Way Hailsham
East Sussex BN27 3WA
United Kingdom
www.bigfootsystems.co.uk



Big Foot HD Custom Framework

Typical Application

There are many situations at roof level that direct the customer away from our standard framework approach. Limited space, existing upstands, lightweight roofs, and other services may all contribute to detailing an appropriate custom support solution. With the aid of our technical surveyors and using our ANSYS FEA software, Big Foot can offer custom made one-off solutions to meet the demanding environment present on some of today's roofs.

Our extensive knowledge of waterproofing systems and roof build-ups ensure we keep within the loading parameters and this can be further demonstrated by us providing the necessary calculations to support our design. This, together with a rapid manufacturing and delivery time, offers customers a fast solution.

Finite Element Analysis (FEA)

Utilising the industry leading ANSYS load analysis programme, specific loading conditions can be calculated with consideration to total weight, weight distribution and dimensions to optimise the HD support framework design solution. FEA calculations are available based on customer supplied information, dependent upon scheme size and complexity.

Product Details

ANGLED AV MATS

The solution to sloping roofs. 2.5° & 5° AV mats are available for 450mm feet.

LEG HEIGHT ADJUSTMENT

255mm – 360mm: floor to top of framework
(255mm – 560mm: stepped roof option)
Large Stud (440mm) can be purchased as an extra individual component if required.

FEET FLEECEES

Recommended for use on PVC membrane roof surfaces to prevent migration of plasticizers.

BIG FOOT ADJUSTABLE LEGS

Ensure level siting

AV MATS & ANGLED AV MATS

Cater for roof fall

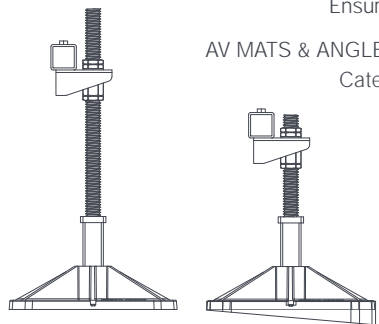

Material Specification

PLASTIC FOOT

Nylon 6 B601L 30% Glass Fibre Filled

ANTI-VIBRATION MAT

SBR-Recycled Rubber. Bound using a ratio of high quality moisture curing Polyurethane Pre-Polymer. BS7188:1989 & BS5696 Part 3:1979

METAL FRAMEWORK

Hot Dip Galvanised Mild Steel: BS EN 10219-1:1997. Welding Standard: BS EN ISO 15614-1
Galvanising: BS EN ISO 1461:1999
Salt Mist Testing: BSEN60068-2-52
Test Kb Severity 1

WORKING CONDITIONS

Suitable for internal or external applications in temperatures between -30°C to +80°C

For Custom Framework

Email: technical@bigfootsystems.co.uk or call +44 (0)1323 844355 for technical assistance

Regulations and Standards

- BS8000-4:1989 : Workmanship on building sites. Code of Practice for waterproofing
- BS6229:2003 : Code of Practice for flat roofs with continuously supported coverings
- BS EN 1107-1:2000 : Flexible sheets for waterproofing. Determination of dimensional stability
- BS EN 1850-1:2000 : Determination of visible defects
- BS 747:2000 : Reinforced bitumen sheets for roofing
- BS 8212:1998 : Code of Practice for mastic asphalt roofing
- Building Regulations Part L : Conservation of Fuel & Power

Specification Reference

The contractor will use Big Foot Systems (Tel. +44 (0) 1323 844 355).

Custom Frameworks solution as per Big Foot Systems site specific layout drawings.

RIBA

RIBA encourages excellence in design, good practice and architectural education and campaigns on important issues such as design standards and sustainability.

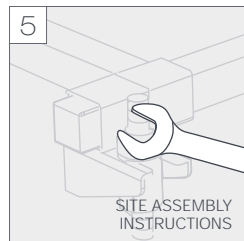
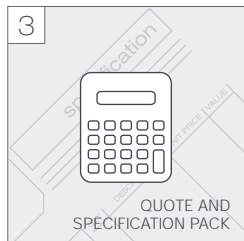
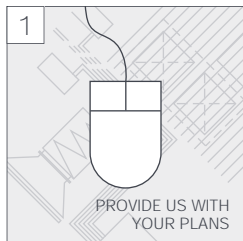

Associated Products



Step Over
Safe personnel access



H Frame
For supporting pipes & ductwork



Fix-it Foot
For supporting light services

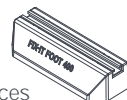

Big Foot Systems have an independent warranty which is provided by AWM Ltd. Please see warranty terms and conditions on our website for further details.

