

BEWI External Wall Insulation (EWI)

Technical Datasheet

BEWI EWI is manufactured from expanded polystyrene (EPS) and can be bonded and/or mechanically fixed to an external wall.

It can be used in conjunction with a variety of render and cladding systems including timber or plastic weatherboarding, tile hanging and reinforced-render systems.

Key Benefits

- Available in a range of Lambda values
- 100% recyclable
- Off-cut collection
- Achieves an A+ rating in the BRE Green
- Guide to Specification
- Lightweight and easy to handle
- Flood resilient and durable
- Can be cut to fit with a sharp knife
- Helps to achieve a high quality rendered surface
- Insulates for the lifetime of the building
- Reaction to Fire Class E

Dimensions:

Standard size: 1200mm x 600mm
Standard thickness: From 20mm – 200mm

Type:

BEWI EWI is supplied as EPS 70E and EPS HP+70 E (grey) as defined in BS EN 13163.

All our EWI contain a flame retardant additive to achieve Reaction to Fire Class E.

BEWI EWI for use with a rendered finish should be "aged" material.

Easy to install

BEWI EWI is manufactured from expanded polystyrene (EPS) which is lightweight and easy to handle. It is easily installed and there is generally no need for specialised trades or equipment, therefore disruption to the building occupants is minimal.

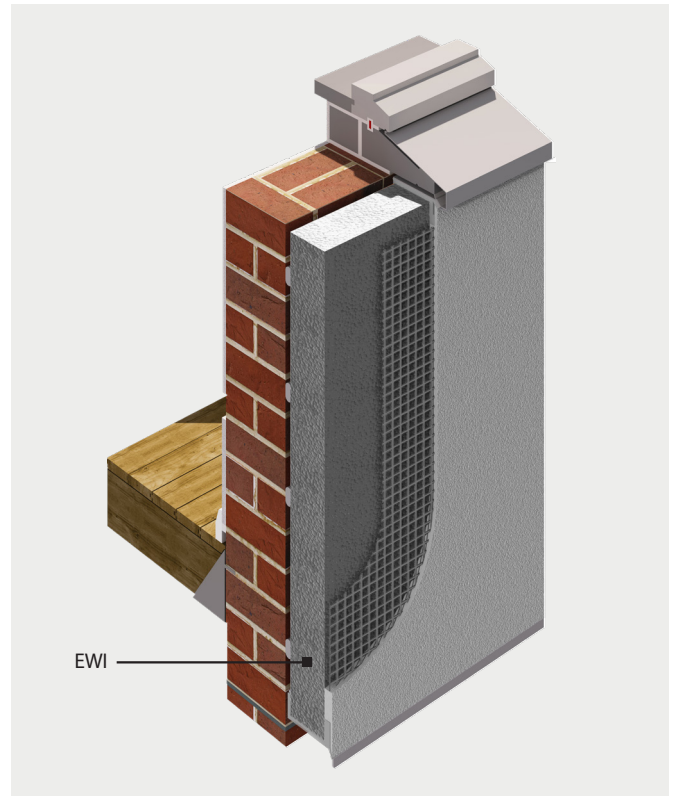

Environment

EPS has been awarded an A+ rating by the BRE's Green Guide to specification.

Permanent

BEWI EWI is rot-proof and durable and will remain effective for the life of the building; recommended fixing methods will retain the boards permanently in position.

It also has the added advantage of being flood resilient.

Fire

Any necessary fire performance should be provided by the facing material and the system design.

Water vapour transmission

BEWI EWI offers significant resistance to the passage of water vapour, but should not be regarded as a vapour-control layer.

Condensation calculations covering typical environmental conditions show that the dew point of an external-wall insulation system will occur on the external face of the insulation. This is the ideal situation.

For more information:

bewi.com e-mail: sales.insulation.uk@bewi.com Tel: 0870 600 3666

© BEWI TDS-03W-EWI-V02 JULY 2024

BEWI

BEWI External Wall Insulation (EWI)

Technical Datasheet

Thermal Resistance (R-Values)

Board Thickness	EPS 70E white (thermal conductivity of 0.038 W/mK)	EPS HP +70E grey (thermal conductivity of 0.030 W/mK)
40mm	1.05m ² K/W	1.30m ² K/W
50mm	1.30m ² K/W	1.65m ² K/W
60mm	1.55m ² K/W	2.00m ² K/W
75mm	1.95m ² K/W	2.50m ² K/W
80mm	2.10m ² K/W	2.65m ² K/W
90mm	2.35m ² K/W	3.00m ² K/W
100mm	2.60m ² K/W	3.30m ² K/W
110mm	2.85m ² K/W	3.65m ² K/W
120mm	3.15m ² K/W	4.00 m ² K/W
130mm	3.40m ² K/W	4.30m ² K/W
150mm	3.95m ² K/W	5.00m ² K/W

Accessory Products – BEWI Basetherm

BEWI Basetherm is a high performance insulation board that is designed specifically to insulate the plinth below the damp-proof course and provide an impact proof base board. It is made of expanded polystyrene which maintains the thermal performance of the insulation even in a damp environment and can be used in conjunction with BEWI external wall insulation.

Dimensions:

Standards size: 1200mm x 1200mm
Standard Thicknesses: 50mm or 100mm

Key properties:

200 Grade – High density EPS
Compressive strength – 200kPa @10% strain
Tensile Strength – minimum 100kPa
Flatness – 3mm
Reaction to Fire – Class E

Test to prove performance:

Compressive strength at 10% deformation (kPa) BS EN 13163
Tensile Strength BS EN 1607
Fire Classification BS EN 13501-1

Fire

Any necessary fire performance should be provided by the facing material and the system design.

Water vapour transmission

BEWI EWI offers significant resistance to the passage of water vapour, but should not be regarded as a vapour-control layer.

Condensation calculations covering typical environmental conditions show that the dew point of an external-wall insulation system will occur on the external face of the insulation. This is the ideal situation.

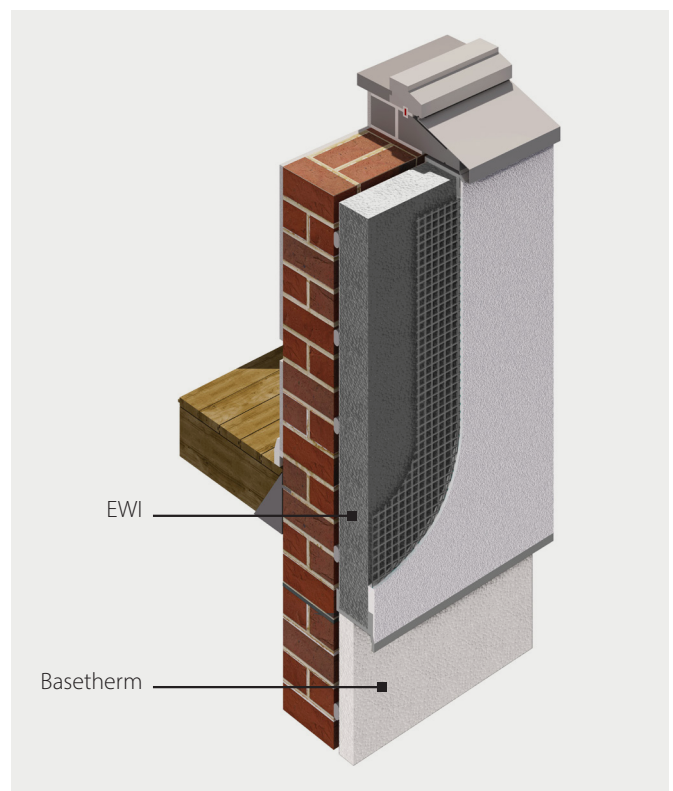

For more information:

bewi.com e-mail: sales.insulation.uk@bewi.com Tel: 0870 600 3666

© BEWI TDS-03W-EWI-V02 JULY 2024

BEWI