

6 x clearance holes to suit M6 screws. Typ.

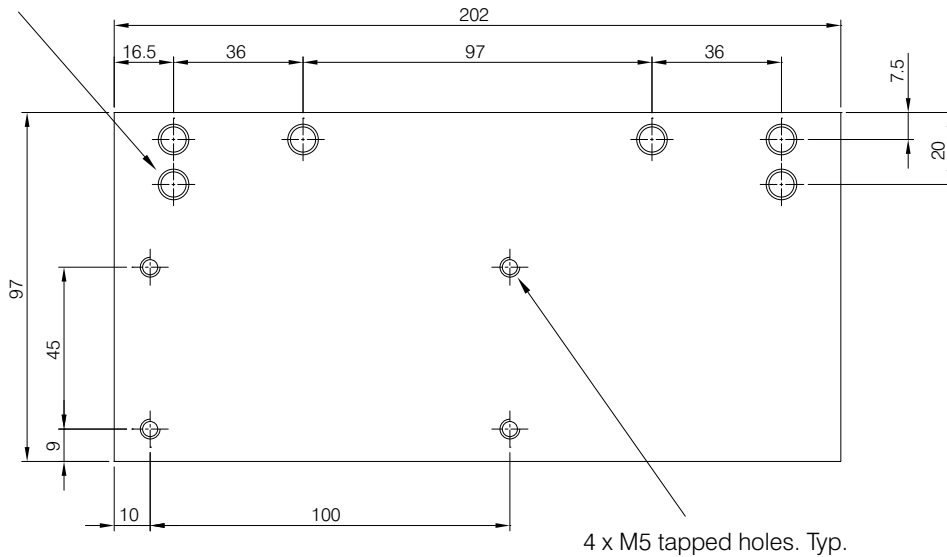

**FC-1000-12-AL**

Backplate for use with FC1000 series surface closers on parallel arm installation

4 x M5 tapped holes. Typ.

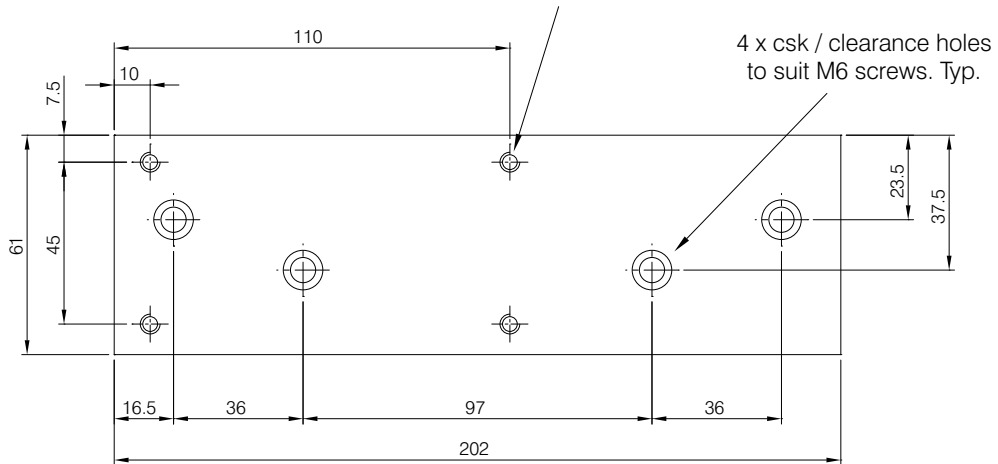

**FC-1000-14-AL**

Backplate for use with FC1000 series surface closers on standard and top jamb installation



**THE PARKSIDE GROUP LTD**

UNIT 5, THE WILLOW CENTRE  
17 WILLOW LANE, MITCHAM, SURREY, CR4 4NX  
Tel: 020-8685 9685 Fax: 020-8646 5096  
Email: axim@parksidegrp.co.uk  
Web Site: <http://www.axim.co.uk>

SCALE NTS @A4

DATE MARCH 2014

For scaled technical or CAD drawings, please contact AXIM.

ISO view not to scale

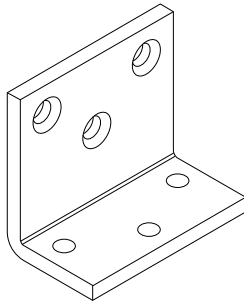

**Material:** Mild steel  
**Finish:** Zinc plating + silver,  
bronze or white PPC

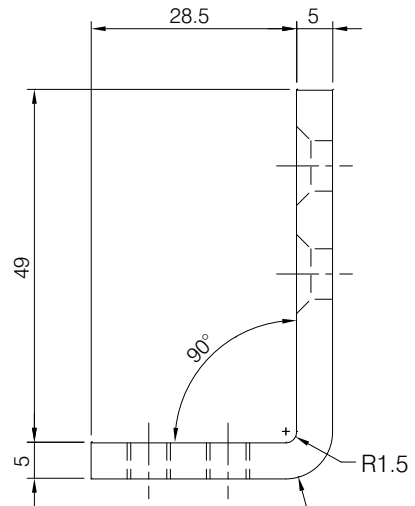
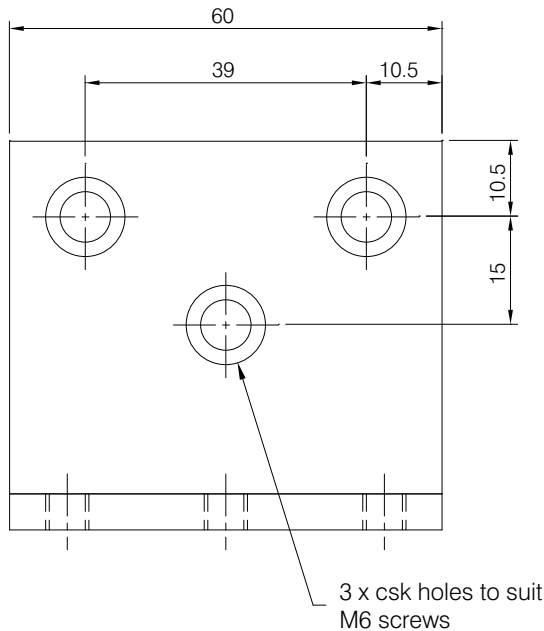
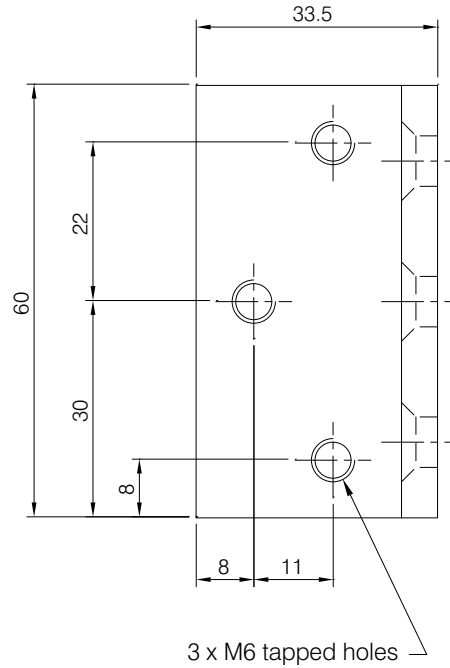

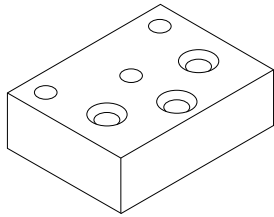

ISO view not to scale

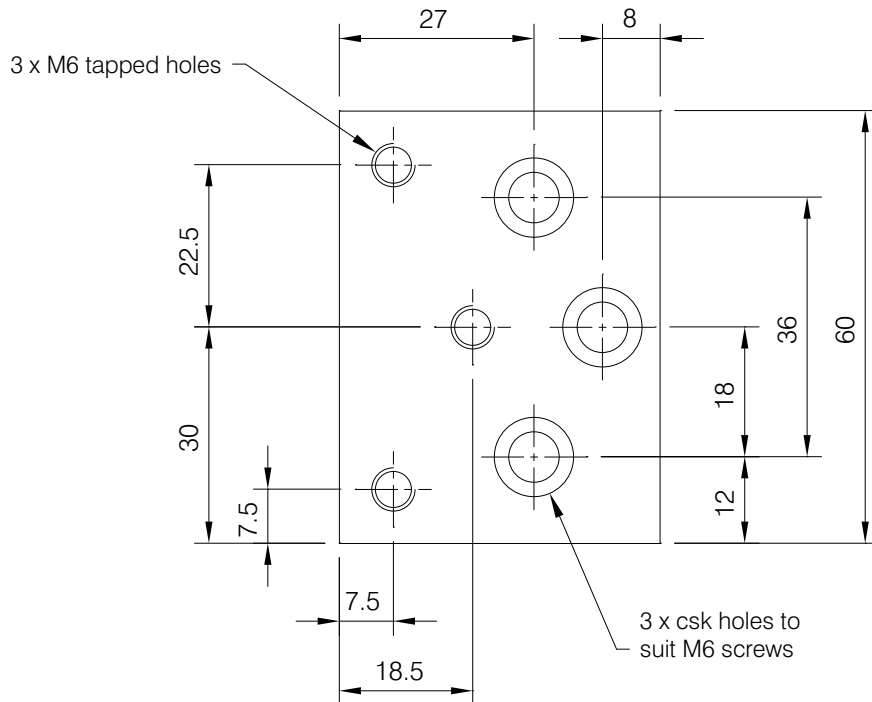
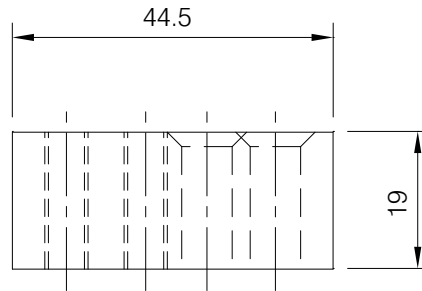

**Material:** Aluminium  
**Finish:** Mill finish



**THE PARKSIDE GROUP LTD**

UNIT 5, THE WILLOW CENTRE  
17 WILLOW LANE, MITCHAM, SURREY, CR4 4NX  
Tel: 020-8685 9685 Fax: 020-8646 5096  
Email: axim@parksidegrp.co.uk  
Web Site: <http://www.axim.co.uk>

SCALE	NTS @A4
DATE	MARCH 2014
For scaled technical or CAD drawings, please contact AXIM.	

**Standard installation**

Closer mounted on door on pull side

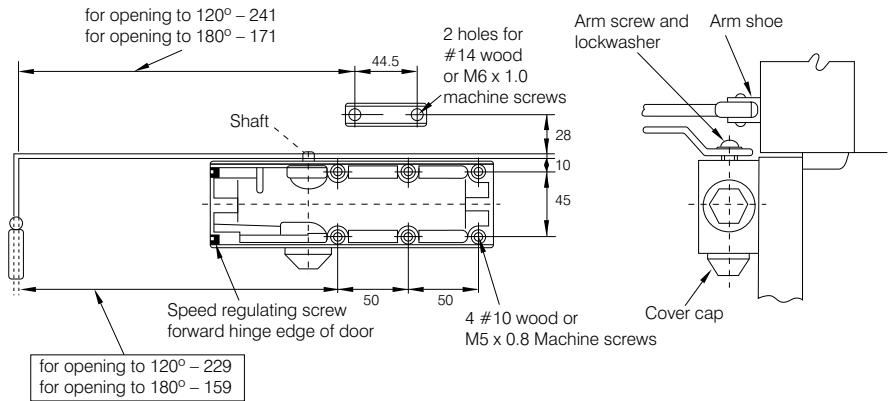
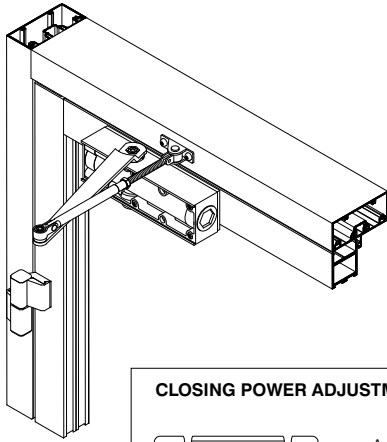

**CLOSING POWER ADJUSTMENT**

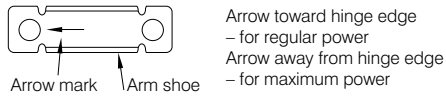

**Right hand door shown**  
Same dimensions apply for left hand door measured from hinge edge

**POSITION OF ARMS AND INDEX SETTINGS**

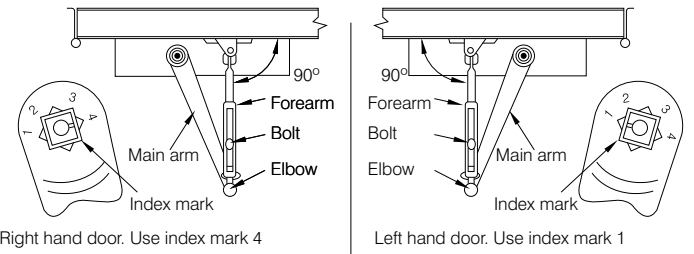

**Top jamb installation**

Closer mounted on top jamb on push side of door.  
Reveals of 70 to 127 requires long top jamb forearms

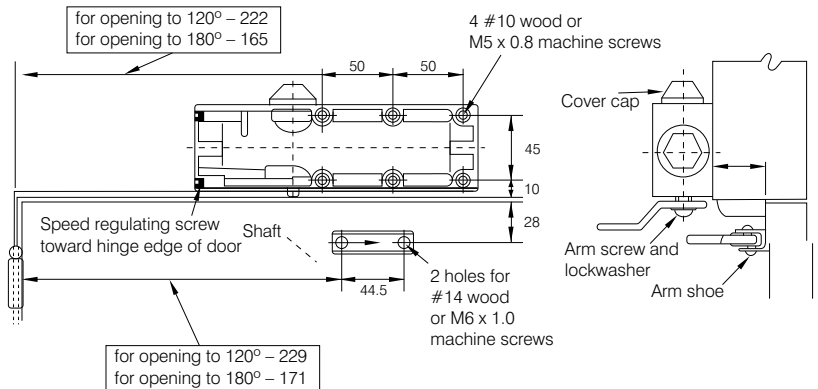
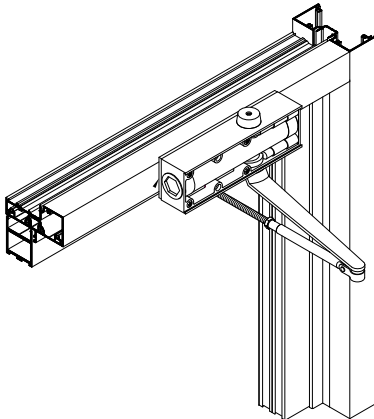

**CLOSING POWER ADJUSTMENT**

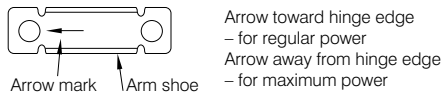

**Left hand door shown**  
Same dimensions apply for right hand door measured from hinge edge

**POSITION OF ARMS AND INDEX SETTINGS**

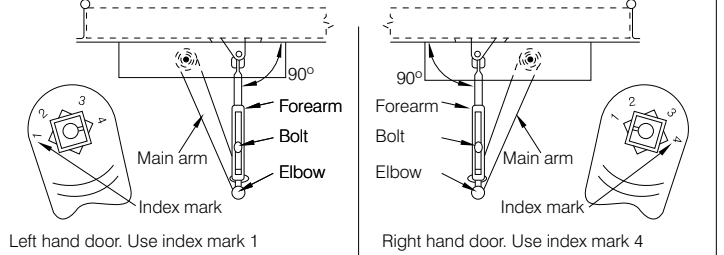

**THE PARKSIDE GROUP LTD**

UNIT 5, THE WILLOW CENTRE  
17 WILLOW LANE, MITCHAM, SURREY, CR4 4NX  
Tel: 020-8685 9685 Fax: 020-8646 5096  
Email: axim@parksidegrp.co.uk  
Web Site: <http://www.axim.co.uk>

SCALE NTS @A4

DATE MARCH 2014

For scaled technical or CAD drawings,  
please contact AXIM.

**Parallel arm installation**

Closer mounted on door on push side

**Left hand door shown**

Same dimensions apply for right hand door measured from hinge edge.

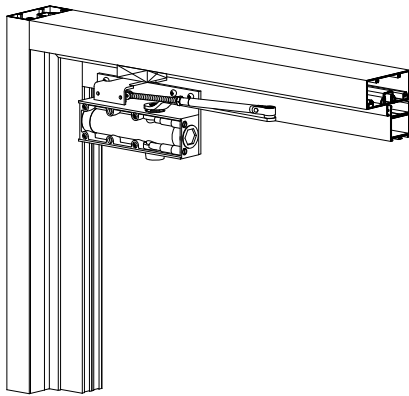
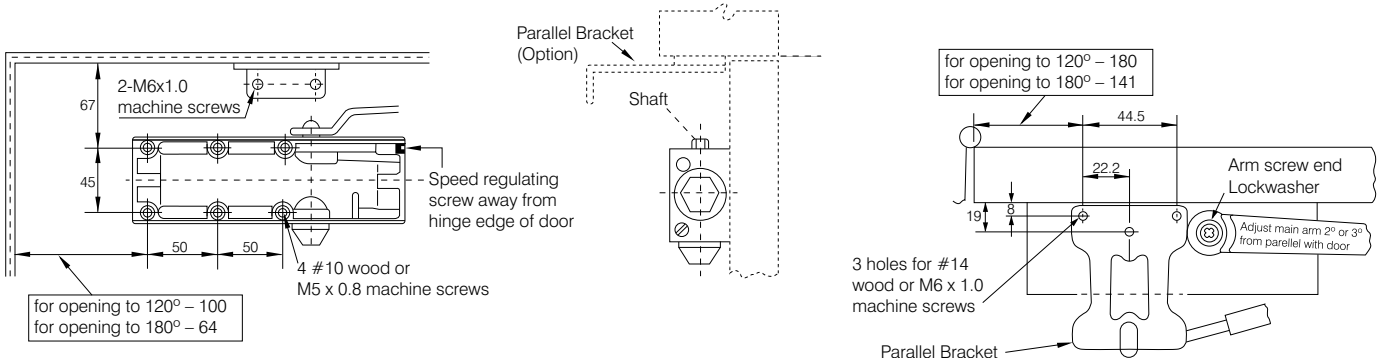

**POSITION OF ARMS AND INDEX SETTINGS**

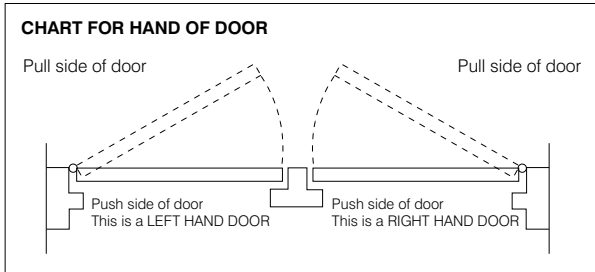
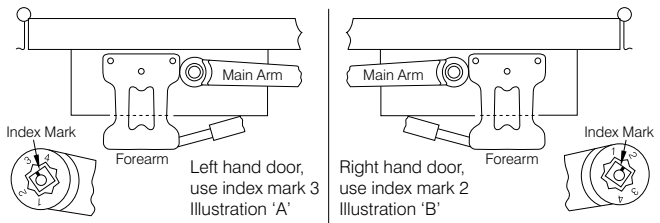

**Instructions**

Step 1

- A. Check hand of door.
- B. Select type of installation.

Step 2

- A. See instructions for installation you have selected.
- B. Follow instructions for correct application and adjustment.

Step 3

- A. Apply closer body and forearm (or parallel bracket and forearm) to door and frame as shown.
- B. Place main arm on shaft at proper index mark as shown and tighten arm screw with lockwasher securely.
- C. Adjust length of forearm as shown and attach to main arm at elbow and tighten locknut bolt.

Step 4

Fixing cover cap on shaft at unused side and insert rubber plug into one of unused fixing hole on body then slide in the Faceplate.

Step 5

Door closing and latching speeds are controlled by #1, #2 speed regulating screw separately.

- A. Clockwise turns slow the Speed.
- B. Counterclockwise turns increase the speed.

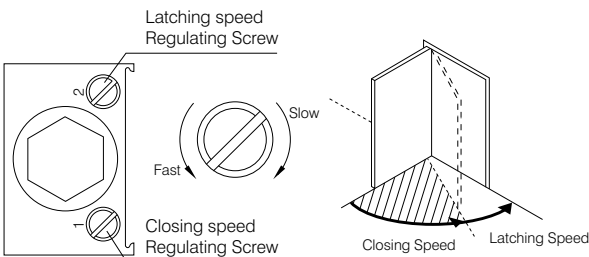

**THE PARKSIDE GROUP LTD**

UNIT 5, THE WILLOW CENTRE  
17 WILLOW LANE, MITCHAM, SURREY, CR4 4NX  
Tel: 020-8685 9685 Fax: 020-8646 5096  
Email: axim@parksidegrp.co.uk  
Web Site: <http://www.axim.co.uk>

SCALE	NTS @A4
DATE	MARCH 2014
For scaled technical or CAD drawings, please contact AXIM.	