

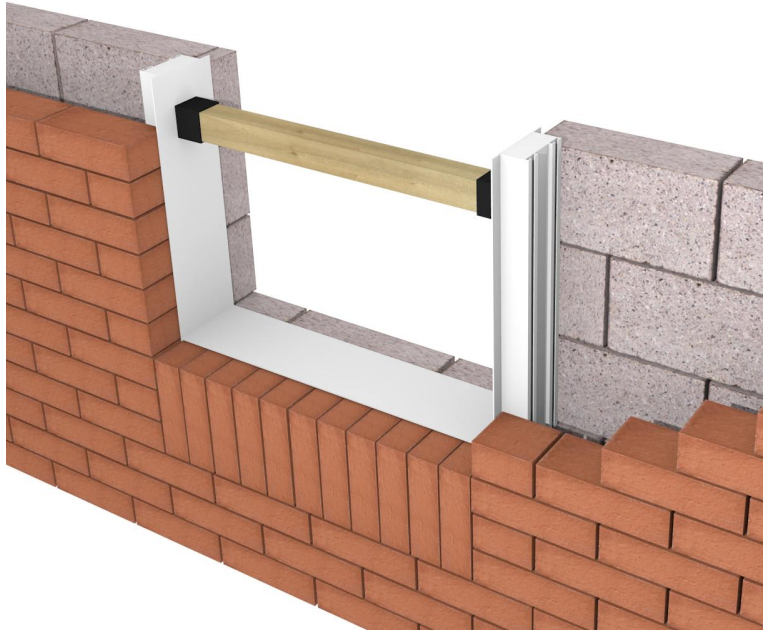

Frame Former



Key Features

- Closes off cavities around window and door reveals
- Prevents cold bridging
- Acts as a bricklaying template enabling thermally efficient fitting of windows and doors
- Rigid PVCu profile
- Compatible with all window and door materials
- BBA approved profile and Part L 2010 compliant

Description

The ARC Frame Former provides the bricklayer with a bricklaying template enabling a thermally efficient fitting of windows and doors. The key advantage of using the ARC Frame Former is the time saving for the brick layer and window fitter. Complies with the Part L 2010 Building Regulations. Using frame formers prevents cold bridging around the reveals, eliminating moisture, mould and staining around windows and doors.

Installation

Step 1: Build brickwork up to sill level, then place the former in place and secure with prop and ensure it is square.

Step 2: Brick up the jambs, using ties at 300mm centres to secure in place while the brickwork progresses.

Step 3: Continue building brickwork around former and head detail, then remove the brace and fit the window.

Health and Safety

ARC Building Solutions has an approved Health and Safety Policy and is committed to working and supplying products safely. We have assessed products as required by Substances Hazardous to Health Regulations (COSHH). An ARC COSHH data sheet is available and can be downloaded from ARC's website.

