

Vapour Control Layers

PROCHECK SERIES, PROFOIL 86 I & REFLECTATHERM SERIES

OVERVIEW:

Attention to detail: All Vapour Control Layers (VCLs) need to be well-sealed continuous layers. Care should be taken to seal all laps, penetrations, perimeters, junctions, and accidental punctures. Ensure substrate surfaces are as clean, dry and dust-free as possible before beginning installation.

Weather Conditions: Securing lightweight membranes in windy conditions may result in a poor-quality installation. Appropriate precautions should be taken during installation.

Accessories: Probond Butyl Tape and Reflectafoil Tape.

Mechanical Fixings: Place fixings at 100-150mm centres. If using blown insulation, reduce fixing centres to 50-100mm.

Penetrations/Opening: VCLs should be cut and neatly formed around openings and penetrations. The membrane should be made air- and vapour-tight by sealing the opening with Reflectafoil Tape.

Puncture Damage: For through-membrane punctures, apply a continuous bead of Probond Butyl Tape around the damaged area and place a generous patch of membrane over the puncture extending at least 150mm beyond the puncture edge. For minor scuff-type damage of less than 25mm, Reflectafoil Tape may be used alone to protect the area without a patch.

Delivery & Site Handling: Rolls are supplied to site with a label clearly identifying product name and grade. Rolls should be stored flat or upright on a clean, level surface and kept under cover.

INSTALLATION: PROCHECK SERIES & PROFOIL 86 I

1. Apply single runs of Probond Butyl Tape at equal centres (max. 600mm) to substrate/studs/fixing rails to provide a temporary fixing point (Fig.1).
2. Install the VCL horizontally or vertically in an even manner ensuring the membrane is flat against the substrate and without wrinkles. If installing horizontally, work from bottom to top to ensure overlaps are shingled (Fig.2).
3. Vertical and horizontal overlaps should be min. 150mm. Seal between overlaps with a double run of Probond Butyl Tape (Fig.2).
4. Mechanical fixings (staples) may be used to permanently attach the VCL to the underlying substrate/stud/fixing rail by firing the fixing through the run of Probond Butyl Tape thereby sealing the fixing-puncture.
5. Seal perimeter edges with a double run of Probond Butyl Tape (Fig.3).
6. Reflectafoil Tape may be used to seal over all edges for added vapour protection.
7. The VCL can be lapped directly to the subfloor, tied into a VCL along the ceiling or to the airtight layer between floors in multi-storey dwellings. If in doubt, please send a detail to the Technical Department for assistance.

INSTALLATION: PROFOIL 86 I continued

Follow previous instructions 1-7, then:

8. Seal all overlaps and perimeter edges with a single run of Reflectafoil Tape. A double run of Probond Butyl Tape between overlaps is still required (Fig.4).

INSTALLATION: PROCHECK ADAPT

Follow previous instructions 1-7, using the additional notes re: **Integrated Tape:**

- Working from the bottom of the wall to the top, install the membrane horizontally with the Integrated Tape running along the bottom edge (Fig.5).
- Ensure the Integrated Tape laps line up, without undue stress or wrinkles in the lap line, before removing release liner. Apply sufficient hand pressure to ensure Integrated Tape is fully bonded to the membrane/substrate below.
- Cut Procheck Adapt neatly around openings and penetrations, using Procheck Multilap Tape for air and vapour tightness.

(over...)

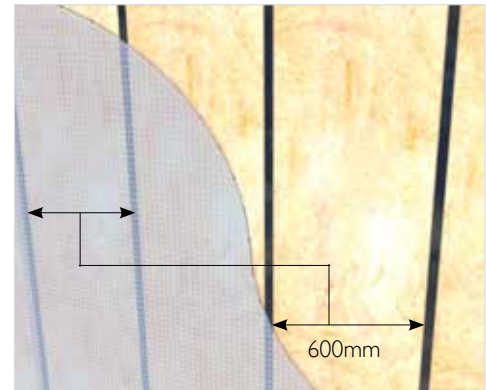

Fig. 1: Temporary fixing with Probond Butyl Tape

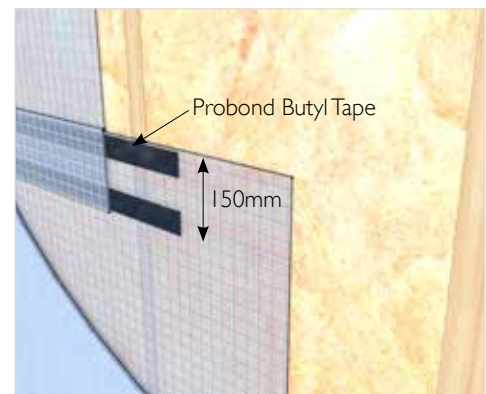

Fig. 2: Procheck Series: Lap joint detail with double run of Probond Butyl Tape

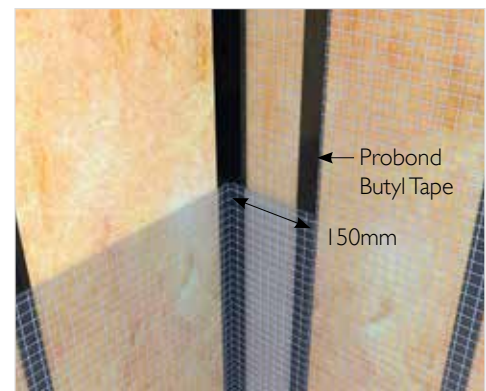

Fig. 3: Procheck Series: Corner joint detail

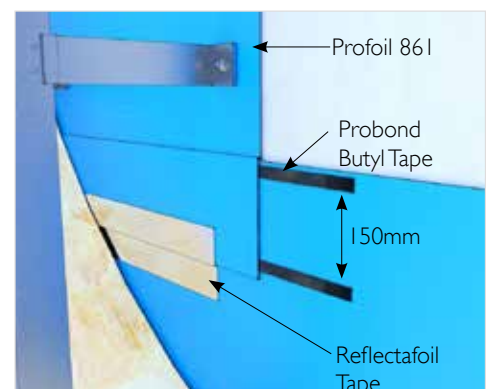

Fig. 4: Profoil detail: Overlaps are sealed with two runs of Probond Butyl Tape and Reflectafoil Tape over the edges.

Vapour Control Layers

PROCHECK SERIES, PROFOIL 861 & REFLECTATHERM SERIES

NOTES ON INSTALLING REFLECTIVE VCLs:

- Reflectatherm Plus and Reflectatherm Premier are installed with the reflective side facing the interior of the building.
- A min. 19mm airspace is required between the VCL and the plasterboard to create a low-emissivity cavity. This space can be used as a service void.
- The effects of reflected sunlight/UV rays should be considered during installation and appropriate PPE (eye/skin protection) worn as necessary.

INSTALLATION: REFLECTATHERM PLUS

1. Apply single runs of Probond Butyl Tape at equal centres (max. 600mm) to substrate/studs/fixing rails to provide a temporary fixing point (Fig.1).
2. Install the VCL horizontally or vertically in an even manner ensuring the membrane is flat against the substrate and without wrinkles.
3. Vertical and horizontal overlaps should be min. 150mm. The VCL should be installed to ensure horizontal overlaps are shingled.
4. Mechanical fixings (staples) may be used to permanently attach the VCL to the underlying substrate/stud/fixing rail by firing the fixing through the run of Probond Butyl Tape thereby sealing the fixing-puncture.
5. Seal overlaps and perimeter edges with a single run of Reflectafoil Tape. A double run of Probond Butyl Tape between VCL overlaps is not required.
6. The VCL can be lapped directly to the subfloor, tied into a VCL along the ceiling or to the airtight layer between floors in multi-storey dwellings. If in doubt, please send a detail to the Technical Department for assistance.

INSTALLATION: REFLECTATHERM PREMIER

1. Apply single runs of Probond Butyl Tape at equal centres (max. 600mm) to substrate/studs/fixing rails to provide a temporary fixing point (Fig.1).
2. Working from the bottom of the wall to the top, install the membrane in a horizontal orientation with the integrated tape running along the bottom edge (Fig.7). Ensure the Integrated Tape laps line up, without undue stress or wrinkles in the lap line, before removing release liner. Apply sufficient hand pressure to ensure Integrated Tape is fully bonded to the membrane/substrate.
3. Vertical and horizontal overlaps should be min. 150mm. Install the membrane in an even manner ensuring it is flat against the substrate and without wrinkles.
4. Mechanical fixings (staples) may be used to permanently attach the VCL to the underlying substrate/stud/fixing rail by firing the fixing through the run of Probond Butyl Tape thereby sealing the fixing-puncture.
5. Seal vertical overlaps, top and side perimeter edges with a single run of Reflectafoil Tape. A double run of Probond Butyl Tape between overlaps is not required.
6. Reflectatherm Premier can be lapped directly to the subfloor, tied into a VCL along the ceiling or to the airtight layer between floors in multi-storey dwellings. If in doubt, please send a detail to the Technical Department for assistance.



Fig.5: Procheck Adapt: Integrated Tape overlap detail



Fig.6: Reflectatherm Plus

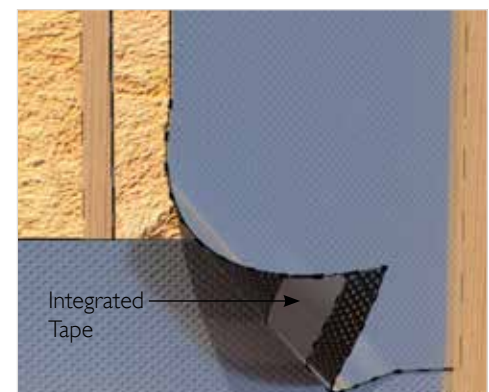

Fig.7: Reflectatherm Premier: Integrated Tape overlap detail



Download a brochure from
our website...

www.proctorgroup.com

contact@proctorgroup.com | +44 (0) 1250 872261

Revised November 2018